

Partnerships for Progress in Transportation

2013 LOUISIANA TRANSPORTATION CONFERENCE

February 17-20 | River Center | Baton Rouge



LTC
2013



CONFERENCE HOSTS



THANK YOU TO OUR CONFERENCE SPONSORS

Platinum Sponsor:



Gold Sponsors:



Silver Sponsors:

Cardno TBE

Fugro

Bronze Sponsors:

ECM Consultants, Inc.

Neel-Schaffer, Inc.



Special thanks goes to GEC, Inc., for coordinating the hospitality/vendor exhibits.

TABLE OF CONTENTS

River Center Maps	2
Conference Information	3
Tabletop Displays.....	4
Program At-a-Glance.....	6
Session Descriptions	8
Monday (1:00 p.m.–2:45 p.m.)	8
Monday (3:15 p.m.–5:00 p.m.)	10
Tuesday (8:00 a.m.–9:45 a.m.).....	12
Tuesday (10:15 a.m.–12:00 p.m.)	14
Tuesday (1:00 p.m.–2:45 p.m.).....	16
Tuesday (3:15 p.m.–5:00 p.m.).....	18
Wednesday (8:00 a.m.–9:45 a.m.).....	20
Wednesday (10:00 a.m.–11:45 a.m.).....	22
Speaker Index	25
PDH Documentation Form	27

New! You can download a mobile version of conference agenda to your smartphone.

Scan below to launch a mobile version of the program on your iPhone.



Scan below to launch a mobile version of the program on an Android device.



You can also type the following address in your phone's browser and choose "Install":
<http://m.appcatch.com/AppInfo.php?AppID=81896>

RIVER CENTER MAPS

Second Floor / Level 2

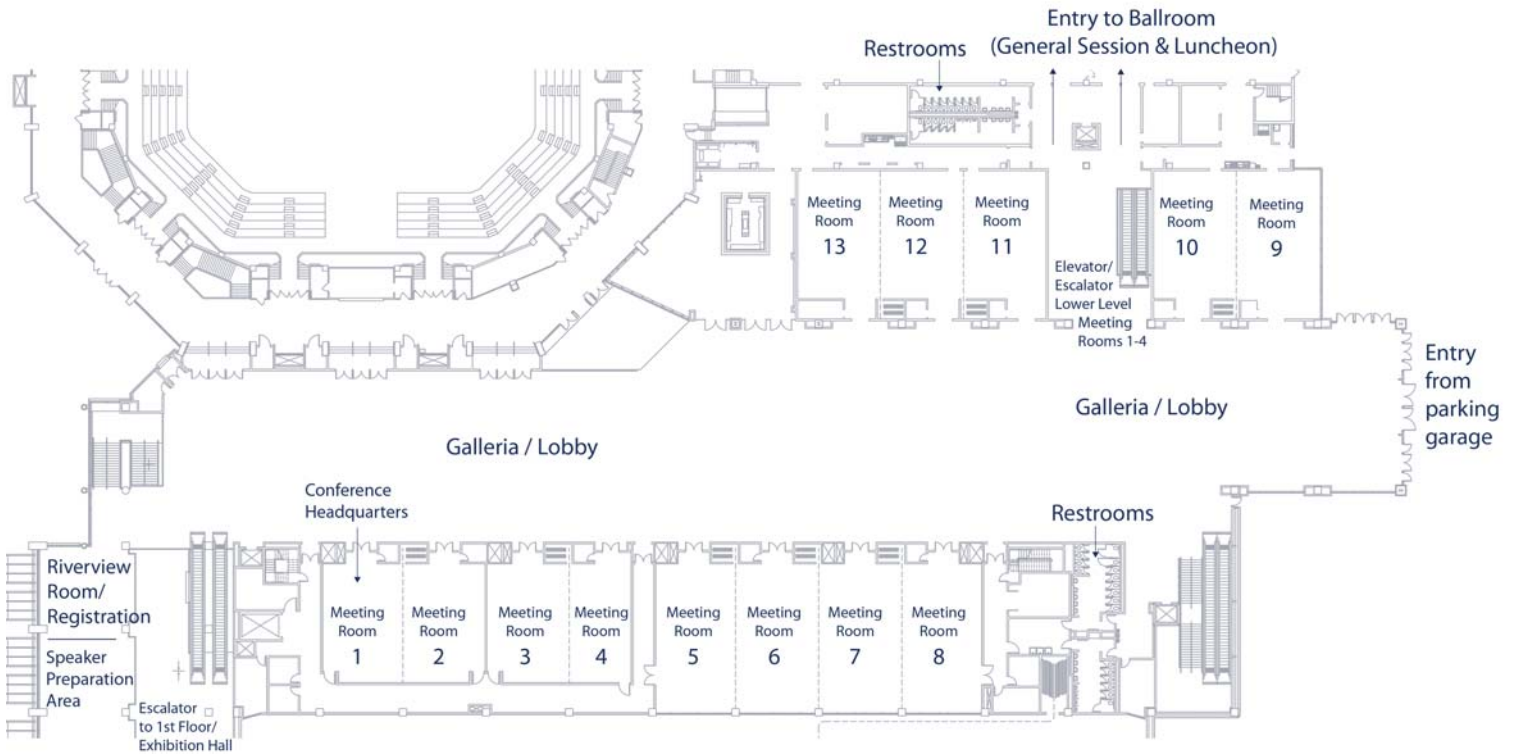

First Floor / Lower Level Meeting Rooms 1-4

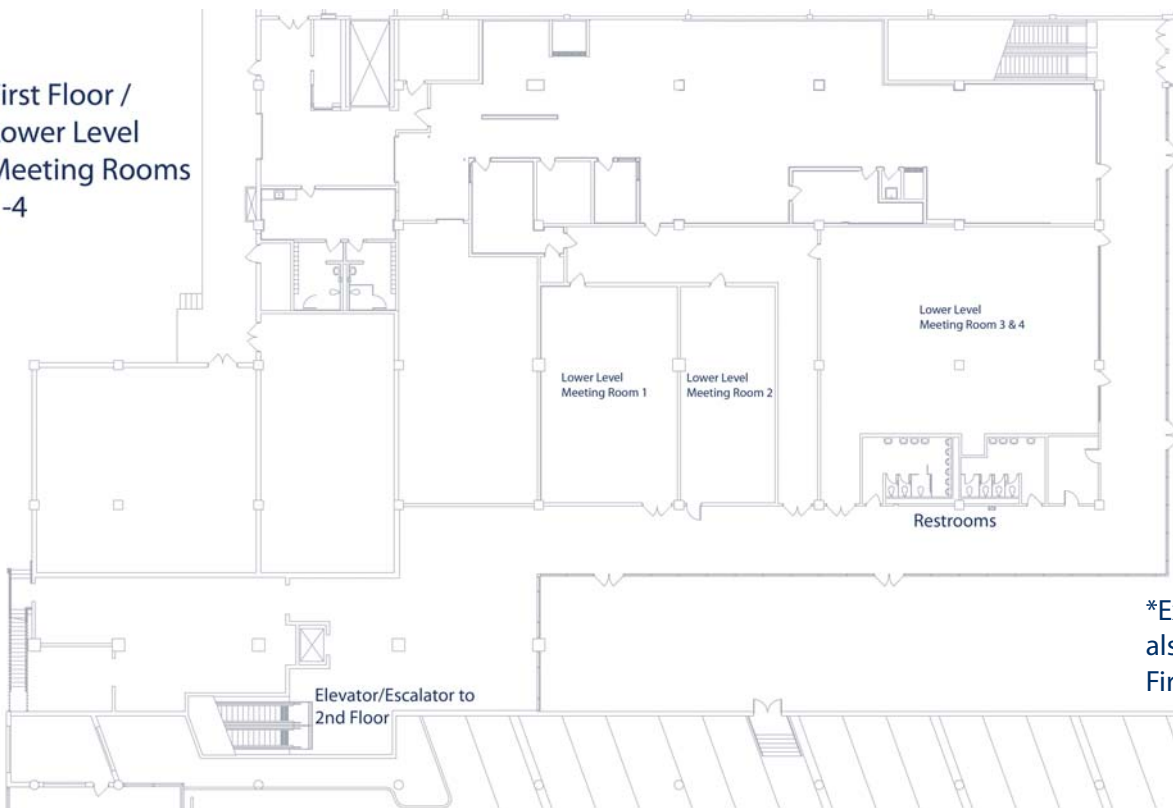

*Exhibition Hall is also located on the First Floor/Lower Level

CONFERENCE INFORMATION

Conference Headquarters

The 2013 Louisiana Transportation Conference Headquarters is located in Meeting Room 1 on the second floor (Level 2). The Conference Headquarters will be open Monday and Tuesday, from 7:00 a.m. – 5:00 p.m., and Wednesday, 7:00 a.m. – 2:00 p.m. If you have special needs during the conference, visit the Conference Headquarters and every effort will be made to accommodate your request.

Parking Procedures—PLEASE READ CAREFULLY

General:

- Park in either the East or West garage.
- Garage entrances are on St. Louis Street, north of St. Louis/Government St. intersection.
- You may enter/exit garage as often as necessary by following the procedures below.

Procedures for Driver:

- 1—Take ticket from machine each time you enter garage.
 - 2—Report to Parking Validation (adjacent to Registration Booth in River Center Lobby) to turn in ticket and receive a garage exit pass anytime before departure from conference.
 - A pass is only good for that day.
 - Each time you exit the garage and return the same day, you must repeat the procedure.
- The Following Step Is Very Important:**
- You must inform Parking Validation if this is your second (or subsequent) time to get a pass that day—no penalty, they just need to know for proper payment to East Baton Rouge Parish (EBR) authorities.
- 3—Same procedures are to be followed each day/each entry.
 - 4—Different colored passes are provided each day.
 - 5—If you fail to exchange parking ticket for pass, you will be responsible for paying the fee—no reimbursement after the fact.
 - 6—Parking validation will end at 11:45 a.m. on Wednesday, Feb. 20. If you do not exchange your ticket for a parking pass before the deadline, you will be responsible for paying the fee.

Badge/Name Tag

Please remember to wear your 2013 Louisiana Transportation Conference badge/name tag at all times as this is your admission to all events.

Professional Development Hours (PDHs) for Engineers

The program provides abstract information and a schedule of 72 sessions, all of which qualify for professional development hours. The last pages of the program contain a register to help keep track of the sessions that are attended and number of PDHs that are accumulated. There is a total of 19 PDHs available through this conference, including the biennially required hour in professional ethics. The ethics session will be offered twice (on Sunday at 4:30 p.m. and on Wednesday at 2:00 p.m. following the awards luncheon.)

Industry Exhibits

Exhibits on transportation technologies/products will be displayed during the following times in the River Center Exhibition Hall (ground level):

Monday 5:00 p.m. to 9:00 p.m., Industry Reception

Tuesday 7:00 a.m. to 5:00 p.m.

Wednesday 7:00 a.m. to 10:45 a.m.

Speaker Preparation

A laptop will be available in the registration area for speakers to use in preparation for presentations.

Wednesday's Conference Luncheon

Seating for the Conference Luncheon starts at 11:45 a.m. in the Ballroom of the River Center. Lunch will begin at 12 pm and will include awards presentations.

Conference Evaluation & Presentations

A conference evaluation survey will be sent to you electronically after the conference. Please take a few minutes to respond to the survey so that we can gain your valuable input as we plan the next Louisiana Transportation Conference. After the conference, the presentations will be made available to all registered delegates, upon completion of the evaluation.

TABLETOP DISPLAYS

Tuesday, February 19, 9:45 am - 4:00 pm, Exhibition Hall

FHWA Louisiana Division

FHWA will present the latest information on the new federal transportation law, Moving Ahead for Progress in the 21st Century (MAP-21), plus technologies and initiatives to make Every Day Count!

Compliance Section - Disadvantaged Business Enterprise (DBE) Certification and Small Business Element (SBE) Unit (New Program)

This display will feature informational brochures and pamphlets on the process for applying for certification as a DBE and/or SBE, including the applications for those programs. It will also feature business cards of persons involved in the programs.

Highway Safety (Section 82)

Come learn about DZD—Destination Zero Deaths. Did you know that Louisiana has a Strategic Highway Safety Plan and the goal is ZERO fatalities? DOTD has partnered with the Louisiana Highway Safety Commission and Louisiana State Police to develop a plan to focus on reducing highway fatalities. Some may say ZERO fatalities is unattainable. We say, if everyone creates a personal goal to arrive safely at their destinations, then ZERO fatalities can become a reality. Come visit our display to learn how you can get involved.

DOTD Human Resources (Section 16)

Human Resources will display materials about engineering careers with the Department. DOTD is a progressive, innovative transportation agency that encompasses a broad range of major activities, including planning, design, construction, maintenance, and operations. The Department aims to provide the resources needed to attract, develop, and retain DOTD's most valuable asset—its employees. A career with DOTD offers:

- Growth opportunity through experience in diverse disciplines.
- Competitive pay with excellent benefits, such as insurance and paid leave.
- Challenging opportunities to work with experienced professionals.
- Support for professional development through continuing education.
- A chance to make a difference in the transportation world!

Intermodal Transportation (Section 66)

This display will feature information from the marine and rail section, the public transportation section, and the port section.

Aviation (Section 88)

The Aviation Section display will feature and promote grant programs available to airports as well as our aviation education and community outreach program. This portion of the tabletop will focus on the development and implementation of the nation's first successful non-primary entitlement fund transfer program to fund projects at Louisiana airports, initiated by the DOTD Aviation Section.

The display will also feature the Louisiana Aviation Art Contest, which is designed to foster interest in aviation for the next generation of pilots. A historical video overview of the New Orleans Lakefront Airport will exhibit the beauty and architectural side of aviation in New Orleans. Finally, the flight simulator will be available for all attendees to experience the joy and passion of aviation.

This section's focus is to improve aviation infrastructure to ensure a safe, modern, and well-managed system of airports, which provides convenient and efficient access to the state for tourism, commerce, industrial interest, recreation, and economic development.

TABLETOP DISPLAYS

Tuesday, February 19, 9:45 am - 4:00 pm, Exhibition Hall

Public Transportation (Section 81)

This display will feature information on the following programs: Rural Public Transportation, LA Swift Intercity Bus, Elderly and Disabled Transportation, Job Access/Reverse Commute, New Freedom, Metropolitan Planning Program, and the Statewide Training Program.

Louisiana Local Technical Assistance Program

Housed at the Louisiana Transportation Research Center (LTRC), the Local Technical Assistance Program (LTAP) is one of 57 such centers networked throughout the United States. LTAP stimulates the progressive transfer of highway technology through training, work force development and technical assistance. A cooperative effort of DOTD, FHWA and LSU, LTAP leverages the expertise and resources of these organizations for the benefit of local transportation and public works agencies.

Louisiana Transportation Research Center - Transportation Training and Education Center (Section 33)

This display will feature information on the Leadership Development Program that began in February 2012. The program was instituted by Secretary LeBas for the purpose of developing our current and future leaders that will extend throughout the Department of Transportation.

PROGRAM AT-A-GLANCE

Session titles in green pertain to the conference theme—Partnerships for Progress in Transportation

Sunday, February 17

2:00 p.m.–5:00 p.m.

Conference Registration, River Center Riverview Room

4:30 p.m.–5:30 p.m.

Ethics Session, River Center Meeting Rooms 5, 6, 7, 8

Monday, February 18

7:00 a.m.–5:00 p.m.

Conference Registration, River Center Riverview Room

7:30 a.m.–8:30 a.m.

Breakfast, River Center Galleria

7:30 a.m.–8:30 a.m.

Secretary's Breakfast, Belle of Baton Rouge, Room Iberville C—
BY INVITATION ONLY

8:45 a.m.–11:30 a.m.

General Session, River Center Ballroom

11:30 a.m.–1:00 p.m. | Lunch (on your own)

1:00 p.m.–2:45 p.m.

Concurrent Sessions, River Center

1: *Pavement Markers in Practice Innovation of the Emulsion Technology* (Room 2)

2: *Freight Transportation* (Room 3-4)

3: *LA Strategic Highway Safety Plan Implementation* (Room 5-6)

4: *Bridge Design* (Room 7-8)

5: *Asset Management* (Room 9)

6: *Engineer's Professional Liability (Workshop)* (Room 10)

7: *Warm Mix Asphalt* (Room 11)

8: *Emerging Geotechnical Technologies* (Room 12)

9: *Contract Services 1* (Room 13)

2:45 p.m.–3:15 p.m. | Break, Galleria

3:15 p.m.–5:00 p.m.

Concurrent Sessions, River Center

10: *Sustainability of Pavement Materials* (Room 2)

11: *Passenger Transportation* (Room 3-4)

12: *Strategies to Reach Destination Zero Deaths* (Room 5-6)

13: *Bridge Rehabilitation and Preservation* (Room 7-8)

14: *Emergent Policy Updates* (Room 9)

15: *Oil of OverLAY: Age Defying Secrets* (Room 10)

16: *Workzone Safety* (Room 11)

17: *The Observational Method in Geotechnical Practice* (Room 12)

18: *Building the Digital Geodatabase of Louisiana – A Partnership Across All Levels of Government and the Private Sector* (Room 13)

5:00 p.m.–9:00 p.m.

Industry Exhibits/Reception, River Center Exhibition Hall

Tuesday, February 19

7:00 a.m.–5:00 p.m.

Conference Registration, River Center Riverview Room

7:00 a.m.–8:30 a.m.

Breakfast, River Center Exhibition Hall

7:00 a.m.–3:15 p.m.

Industry Exhibits, River Center Exhibition Hall

8:00 a.m.–9:45 a.m.

Concurrent Sessions, River Center

19: *Student Projects* (Room 2)

20: *Getting You Home Safely—The DOTD Local Road Safety Program* (Room 3-4)

21: *Highway Safety Analytical Tools* (Room 5-6)

22: *Bridge Design and Construction* (Room 7-8)

23: *Quality and Continuous Improvement Process* (Room 9)

24: *Traffic Engineering* (Room 10)

25: *Concrete Construction 1* (Room 11)

26: *Minimum Standards for Land Surveyors (Workshop)* (Room 12)

27: *New 2013 Specification Book - General, Incidental, and Materials* (Room 13)

9:45 a.m.–4:00 p.m.

Tabletop Displays, Exhibition Hall

9:45 a.m.–10:15 a.m. | Break, Exhibition Hall

10:15 a.m.–12:00 p.m.

Concurrent Sessions, River Center

28: *Materials and Testing—Application of GPC, XRF, XRD* (Room 2)

29: *DOTD Local Public Agency Programs—Partnering to Improve the Quality of Life for Louisiana's Citizens* (Room 3-4)

30: *Highway Safety Boot Camp Part 1 (Workshop)* (Room 5-6)

31: *Bridge Maintenance and FHWA Metric* (Room 7-8)

32: *Transportation Performance Management: Setting Target for Improvement and Achieving Success* (Room 9)

33: *Future Transportation Workforce Initiative (Workshop)* (Room 10)

34: *Concrete Construction 2* (Room 11)

PROGRAM AT-A-GLANCE

Session titles in green pertain to the conference theme—Partnerships for Progress in Transportation

35: *Location-Based Decision Support—GIS for Managers and Administrators (Workshop) (Room 12)*

36: *New 2013 Specification Book—Earthwork, Base Courses, and Asphaltic Pavements (Room 13)*

12:00 p.m.–1:00 p.m.

Lunch, Exhibition Hall (buffet lunch provided)

1:00 p.m.–2:45 p.m.

Concurrent Sessions, River Center

37: *University Transportation Center—Safety and Policy Research (Room 2)*

38: *Railroad Engineering (Room 3-4)*

39: *Highway Safety Boot Camp Part 2 (Workshop) (Room 5-6)*

40: *Bridge Design and Geotechnical Solutions (Room 7-8)*

41: *Louisiana Compliance Programs (Room 9)*

42: *Missouri DOT's Practical Design Policy (Room 10)*

43: *Asphalt Construction 1 (Room 11)*

44: *Management Systems & Traffic Monitoring (Room 12)*

45: *New 2013 Specification Book—Concrete and Structures (Room 13)*

2:45 p.m.–3:15 p.m. | Break, Exhibition Hall

3:15 p.m.–5:00 p.m.

Concurrent Sessions, River Center

46: *University Transportation Center—Multimodal Research (Room 2)*

47: *Planning (Room 3-4)*

48: *Increasing Crash Data Completeness, Accuracy, and Accessibility – Creating a Data Warehouse To Produce a Single Version of the Truth (Room 5-6)*

49: *Movable Bridges and Roadway Lighting (Room 7-8)*

50: *Right of Way Knowledge Improves Project Delivery (Room 9)*

51: *Multilane Roundabouts and Practical Experience (Room 10)*

52: *Asphalt Construction 2 (Room 11)*

53: *Road Inventory & Mapping (Room 12)*

54: *Contract Services 2 (Room 13)*

Wednesday, February 20

7:00 a.m.–8:30 a.m.

Breakfast, River Center Exhibition Hall

8:00 a.m.–9:45 a.m.

Concurrent Sessions, River Center

55: *Implementation of Geotech Research (Room 2)*

56: *Every Day Counts—Louisiana's Success and Current Efforts (Room 3-4)*

57: *Tort Liability: Is Ignorance Bliss? (Room 5-6)*

58: *Bridge Rehabilitation, Bridge Design, and Bridge Rating (Room 7-8)*

59: *The Business Side of DOTD (Room 9)*

60: *Intelligent Transportation System—What are we doing? (Room 10)*

61: *LaGov Implementation (Room 11)*

62: *Agile Assets (Room 12)*

63: *Project Management (Room 13)*

9:45 a.m.–10:00 a.m. | Break, Exhibition Hall

10:00 a.m.–11:45 a.m.

Concurrent Sessions, River Center

64: *Latest Developments in Pavement Characteristics (Room 2)*

65: *Mega Projects (Room 3-4)*

66: *Effective Communication Strategies (Workshop) (Room 5-6)*

67: *Mississippi River Crossings at Vicksburg (I-20 and Railroad) (Room 7-8)*

68: *Public Works (Room 9)*

69: *Where the Rubber Meets the Road—DOTD District Issues (Room 10)*

70: *Technology Updates (Room 11)*

71: *Bridge Maintenance and Roadside (Room 12)*

72: *Environmental (Room 13)*

12:00 p.m.–2:00 p.m.

Awards Luncheon, River Center Ballroom

2:00 p.m.–3:00 p.m.

Ethics Session, River Center Meeting Rooms 11, 12, 13

SESSION DESCRIPTIONS

The following pages contain concurrent session titles, a session description, titles of presentations, and names of presenters. A copy of the presentations will be available on the LTRC Web site after the conference. Sessions related to the conference theme, *Partnerships for Progress in Transportation*, are highlighted throughout the program.

The Ethics Session will be offered on Sunday (4:30-5:30 p.m.) and Wednesday (2:00-3:00 p.m.) in the River Center (see pages 6-7 for locations). Dr. Norma Jean Mattei (University of New Orleans) will be the speaker at both sessions.

[MONDAY 1:00 p.m.–2:45 p.m.]

Session 1: Pavement Markers in Practice Innovation of the Emulsion Technology

Moderator: Richie Charoenpap
Meeting Room 2

This session will discuss the water born pavement marker. The first part of the session will discuss the reflective reading on a variety of surfaces over time. What is the expected usable life of the pavement marker? This will help the Department determine the frequency of restriping of the road to ensure public safety. The second part of the session will discuss innovation in the field of emulsion technology. The presenter will look at the technological improvements that make quick dry, good retro-retention, water washout resistance, multi-year durability, and good cold temperature application possible with properly formulated waterborne paint.

Reflectivity of the Louisiana Chip Seal Pavement

Phil Macaluso, DOTD

Waterborne Traffic Paint Technology, Performance and Testing

Cindy Randazzo, Dow Coating Materials

Session 2: Freight Transportation

Moderator: Phil Jones
Meeting Room 3-4

A discussion of freight transportation programs and their contribution to the continuous improvement of Louisiana's transportation network will take place. Programs include the Marine Transportation System, the Port Priority Program, the Rail Program, and GIS database information maintained by the Intermodal Transportation Division.

Marine Transportation System

Kathryn Carlson, DOTD

Economic Impact of the Ports of Louisiana on the State and Regional Economics

Jim Richardson, LSU

Proposed Rail Program

Dean Goodell, DOTD

Intermodal Transportation GIS Data

Leo Boles, DOTD

Session 3: Louisiana Strategic Highway Safety Plan Implementation

Moderator: April Renard
Meeting Room 5-6



This session will focus on Louisiana's Strategic Highway Safety Plan (SHSP), which has gained an increased focus from the new transportation bill, MAP-21. The SHSP is Louisiana's roadmap to Destination Zero Deaths. The SHSP is a data-driven, multidisciplinary plan that targets areas where the most improvement can be made: impaired driving, occupant protection, infrastructure and operations, and crashes involving young drivers. This session will also highlight the importance of local involvement and will describe the roles, responsibilities, challenges, and opportunities associated with regional safety planning and implementation.

MAP-21 – Opportunities and Challenges

Betsy Tramonte, FHWA Louisiana

SHSP Implementation Workshop: Safety Is Everybody's Business

Susan Herbel, Cambridge Systematics

Regional Safety Teams – Join the Journey

April Renard, DOTD

Session 4: Bridge Design

Moderator: Hossein Ghara
Meeting Room 7-8

This session provides updates on the development of the new DOTD Bridge Design and Evaluation Manual and other related studies that help form bridge design policies in Louisiana. The studies include NCHRP 12-83 project on Calibration of LRFD Concrete Bridge Design Specifications for Serviceability, the WIM study to evaluate the increasing live load in Louisiana, and the LTRC project on developing wave and storm surge atlases.

LADOTD Bridge Design Manual Update

Zhengzheng “Jenny” Fu, DOTD

Louisiana WIM Study

Bala Sivakumar and James Gregg, HNTB

Development of Wave and Surge Atlases for the Design and Protection of Coastal Bridges in South Louisiana

Phil Dompe, Ocean Engineering Associates, Inc.

Calibration of the Service and Fatigue Limit States in AASHTO LRFD Bridge Design Specifications

Wagdy Wassef, Modjeski and Masters, Inc.

Session 5: Asset Management

Moderator: Kirt Clement

Meeting Room 9

MAP-21, the federal highway authorization bill, mandates that state DOTs implement asset management plans. This session will focus on the requirements of the new law, asset management principles and initiatives, and the Louisiana DOTD initiatives to implement an asset management plan that meets the requirements of MAP-21. Attendees will gain knowledge on the link of asset management and asset valuation, and the heightened need to maintain or upgrade those assets.

Asset Management in Reauthorization - National Initiatives

Stephen Gaj, FHWA

DOTD Asset Management Policy, Steering Committee, and Initiatives

Michael Bridges, DOTD

Asset Valuation - Leveraging the Big Picture

Gordon Proctor, Gordon Proctor & Associates, Inc.

Session 6: Engineer’s Professional Liability (Workshop)

Moderator: Brian Buckel

Meeting Room 10

The program will provide an overview of professional liability and how it works. The program will discuss the common issues and concerns surrounding professional liability, the contract language that can create risk beyond the scope of the coverage, and actions or inactions that might jeopardize the coverage.

Engineer’s Professional Liability: What is it? How does it work? What does it Cover?

Wyatt Sanders

Session 7: Warm Mix Asphalt

Moderator: Chris Abadie

Meeting Room 11

With lower mixing and compaction temperatures, warm mix asphalt reduces the carbon footprint of asphalt production and place-

ment. These lower temperatures also provide an atmosphere that is worker friendly, and cooler with less odor. This session is meant to provide the audience with a general overview of warm mix and will describe the engineering attributes of this product as compared to conventional asphalt mixtures.

FHWA Perspective on Warm Mix Asphalt

Matt Corrigan, FHWA

Going Beyond Foaming

Ramon Bonaquist, Advanced Asphalt Technologies, LLC

Performance Issues

Randy West, NCAT

Session 8: Emerging Geotechnical Technologies

Moderator: Steve Meunier

Meeting Room 12

This session will present three emerging technologies and the positive effects they are having in our current practice of Geotechnical Engineering at DOTD and other DOTs across the country. Each of these presenters is a leader and pioneer in their own right, constantly stretching the boundaries of their respective technologies to further the advance of geotechnical engineering for everyday practitioners.

LADOTD’s New Geotechnical GIS Database

Scott Deaton, Dataforensics

Pile Driving Analyzer (PDA) and CAPWAP Proven Pile Testing Technology: Principles and Recent Advances

Frank Rausche, GRL Engineers, Inc.

Embedded Data Collection Technology for Piles

Sastry Putcha and Richard Hecht, Smart Structures

Session 9: Contract Services 1

Moderator: Randy Sanders

Meeting Room 13

DOTD greatly relies on Internet and computer resources for conducting business on its construction bidding activities. Topics to be presented in this session will familiarize the participants on how to utilize such services provided to inquire more about the plans and proposals that are available on-line. Additionally, discussion on Bid Express, our online bidding service, will be presented covering the features provided that are currently utilized by DOTD.

Falcon

Pat Wollerson, DOTD

Bid Analysis and Construction Items Price Estimation

Charles Nickel, DOTD

Bid Express Features

Joe Rowland, Info Tech, Inc.

[MONDAY 3:15 p.m.–5:00 p.m.]

Session 10: Sustainability of Pavement Materials

Moderator: Louay Mohammad

Meeting Room 2

Sustainability in transportation can be defined many ways and the definition will always include a safe, efficient, and environmentally friendly infrastructure. This session will further define sustainability of pavements and discuss its importance for a longer lasting infrastructure. An overview will be given to show how sustainability applies to highway infrastructure and the environment, followed by highlights and demonstrations of advancements in sustainable materials and how these materials are being incorporated into pavements.

Overview of Sustainability as it Applies to Infrastructure

Imad Al-Qadi, University of Illinois

Bio Binders and Bio Polymers

Chris Williams, Iowa State University

Durability and Performance Of Titanium Dioxide In Photocatalytic Pavements

Marwa Hassan, LSU

Session 11: Passenger Transportation

Moderator: Phil Jones

Meeting Room 3-4



A discussion of passenger transportation programs and their contribution to the continuous improvement of Louisiana's transportation network. Programs include Public Transportation Programs, New Orleans Streetcar System expansion, and the Aviation Priority Program.

Aviation Program

Brad Brandt, DOTD

Public Transportation Programs

Harold Beck, DOTD

Streetcars

Kevin Lawson, DOTD

Session 12: Strategies to Reach Destination

Zero Deaths

Moderator: Autumn Goodfellow-Thompson

Meeting Room 5-6



Presentations will be provided by the LA SHSP Emphasis Area Team Leaders. This session will focus on Impaired Driving, Occupant Protections and Young Drivers. Presenters will discuss accomplishments, setbacks and future goals as we work toward the ultimate goal of Destination Zero Deaths.

DWI No Refusal Process

Captain Carl Saizan, LA State Police Troop B

Impaired Driving: Strategies and Objectives

Norma Broussard

Occupant Protection in Louisiana

Dortha Cummins, LA Highway Safety Commission, and Marie Walsh, LTAP

Young Drivers: 2013

Bridget Gardner, Interim LSU Public Hospital

Session 13: Bridge Rehabilitation and Preservation

Moderator: Ray Mumphrey

Meeting Room 7-8

Bridge rehabilitation and preservation plays an important role in maintaining a safe infrastructure network due to the aging of the structures and the limited funding. This session presents the SHRP research in nondestructive testing (NDT) and highlights the successful projects in the area of bridge rehabilitation and preservation.

Applications and Performance of NDT Technologies in Condition Assessment of Concrete Bridge Decks

Nenad Gucunski, Rutgers University

Louisville Bridge Rehabilitation

Kelly Kemp, DOTD

Design and Construction of Recent Bridge Pier Protection

Zolan Prucz, M & M

Rehabilitation Design and Construction for the US 190 Mississippi River Bridge Cleaning, Painting, and Repair Project

Durk Krone, TRC Engineers

Session 14: Emergent Policy Updates

Moderator: Michael Bridges

Meeting Room 9

This session is designed to share information on emergent policy issues and topics being addressed in DOTD. At the time of this program development, the listed topics were scheduled to be presented. Please note that this session is dynamic and the sponsor may elect to modify or add to the presented topics. Please refer to the easel outside the meeting room for the presentations to be covered in the session.

CCCD - Devolution or Evolution

Rhett Desselle, DOTD

Annexation of Highway Rights-of-Way

Eric Kalivoda, DOTD

Right Sizing the Transportation System

Eric Kalivoda, DOTD

DOTD Frontage Road Policy

Eric Kalivoda, DOTD

Session 15: Oil of OverLAY:

Age Defying Secrets

Moderator: Mark Chenevert

Meeting Room 10



Since the 1970s, it has been well noted that our nation needed to focus attention on preserving existing assets. We could not afford to continuously increase capacity without considering how to maintain the aging system. Federal funds were then made available for re-surfacing, restoration, and rehabilitation of roads and bridges. How do we keep pace with our aging assets? What tools are available to help us choose projects and measure our progress? This session will provide a national perspective of preservation, while defining how North Carolina has implemented measurements for performance and how DOTD Districts use available pavement management information to select projects and treatments.

National Perspective on Pavement Preservation

Steve Mueller, FHWA Resource Center

How District 05 uses PMS Data for Project Selection

Mel Hicks, DOTD

Session 16: Workzone Safety

Moderator: Josh Harrouch

Meeting Room 11



Work zone safety has become a focal point of the transportation industry. Every year, as our population grows and more and more vehicles are on our highways, maintaining or repairing our aging infrastructure in a safe and efficient manner continues to challenge transportation professionals. This session will provide an update on the FHWA perspective on the implementation of the mandate for the transportation management plan (TMP). It will also outline real world experience on the TMP development process. The session will also identify the work zone inspection process and how a work zone was implemented on the I-12 design build project.

Update on Federal Mandate on Transportation Management Plan from FHWA Perspective

John Broemmelsiek, FHWA

Experience on Process of Developing Transportation Management Plan for Specific Project

Kay Courtier, DOTD

Workzone Inspection Process

Barry Lacy, DOTD

Workzone for I-12 Design Build Project

Dean Tekell, LTAP

Session 17: The Observational Method in Geotechnical Practice

Moderator: Chris Nickel

Meeting Room 12

This session will demonstrate how the "Observation Method" is being applied to solve entirely different problems within the practice of geotechnical engineering. Each of these projects is presented with all of the inherent challenges, the intended performance expectations and the solutions which were ultimately chosen for each site.

I-20 Mississippi River Bridge at Vicksburg: Geotechnical Solutions

Robert Werner, Ardaman & Associates, Inc.

Ground Improvements for MSEW in Downtown Seattle

King Chin, GeoEngineers

O-Cell Capacity Determination for Driven Piles

Paul Bullock, University of Florida

Session 18: Building the Digital Geodatabase of Louisiana— A Partnership Across All Levels of Government and the Private Sector

Moderator: James E. Mitchell

Meeting Room 13

DOTD has implemented an ambitious "mapping" program to build the digital geospatial database of Louisiana. Mapping has been an important function for DOTD since its inception, with roots that date back to Act 159 of 1928. Hand-drawn maps are a thing of the past and GIS technology has changed the world from one where maps made the data to one where data make the maps. This session will present how DOTD is fulfilling its responsibilities under La. R. S. 48:36, "Topographic Mapping." Presentations will discuss how DOTD is patterning to build a statewide, seamless geospatial database to support topographic mapping.

The Louisiana Quadrangle Map Series; The Data Makes the Maps

Sean Deinert and Sean Hodges, GDM International Services

Building the Geodatabase of Louisiana; Integrating Data in a Dynamic Database

Jay Clark, GDM International Services

[TUESDAY 8:00 a.m.—9:45 a.m.]

Session 19: Student Projects

Moderator: V. J. Gopu

Meeting Room 2

Teams of senior civil engineering students from LSU, SU, UNO, ULL, and LA Tech will present their senior design projects that are supported by LTRC through the Support Program for Civil Engineering Students.

Session 20: Getting You Home Safely—The DOTD Local Road Safety Program

Moderator: Marie Walsh

Meeting Room 3-4

Over the past several years, nearly 25% of highway-related fatalities in Louisiana have occurred on roads owned by the parishes and municipalities. In order to help improve these statistics, DOTD allocates \$3 to \$5 million annually to the implementation of low-cost safety countermeasures on the state's local road network through the Local Road Safety Program (LRSP). This session will present an overview of this program, with an emphasis on recent LRSP initiatives, the utilization of crash data in project identification and prioritization, the LRSP project development process, and LRSP project successes and challenges.

Overview of Local Road Safety Program & Recent Initiatives

Marie Walsh, LTAP

Utilization of Crash Data in Project Identification & Prioritization

Jason Taylor, LTAP

LRSP Project Development Process

Rick Holm, LTAP

LRSP Project Successes & Challenges

Nick Verret, Natchitoches Parish Government, and David Barrow, City of Central

Session 21: Highway Safety Analytical Tools

Moderator: Jim Chapman

Meeting Room 5-6

The highway safety community now has the ability to utilize a science-based technical approach that takes the guesswork out of safety analysis. Tools are available to conduct quantitative safety analysis, allowing for safety to be evaluated alongside other transportation performance measures such as traffic operations, environmental impacts, and construction costs. This session will explore some of the recent tools and impacts of safety countermeasures.

Developing State Specific SPFs

Jake Kononov and Bryan Allery, DiExSys, LLC

Using ISHDM

April Renard, DOTD

Safety Impacts of Various Countermeasures

Xiaoduan Sun, ULL

Session 22: Bridge Design and Construction

Moderator: Brian Buckel

Meeting Room 7-8

This session presents the challenges faced and successful solutions implemented in two major bridge construction projects: Fort Buhlow bridge project and I-10 KCS railroad overpass.

Fort Buhlow Bridge Project (Design)

Rob Dugas, GEC

Construction of the Cofferdams/Piers at Fort Buhlow Bridge Project

John Gagnard, Pan American Engineers-Alexandria, Inc.

CFRP Strengthening and Load Testing of the Concrete Deck of I-10 KCS Railroad Overpass

Mohsen Shahawy, LPA/SDR Engineering

I-10 Design Build (Siegen-Highland) KCS Bridge Concrete and Steel Girder Erection

Patrick Ledet, Neil Hickok, and Kenny Solis, Boh Brothers

Session 23: Quality and Continuous Improvement Process (QCIP)

Moderator: Denny Silvio

Meeting Room 9

DOTD's Quality and Continuous Improvement Group will present a three-part session on ways to maximize your potential for success. In this session, you will learn tips on how to effectively facilitate a meeting; how to conduct an organizational self-evaluation with improvement action plans; and how to create realistic and useful performance measures to gauge your progress.

Facilitation Techniques

Joe Wills, DOTD

Implementing an Internal Self-Assessment Program

Mark St. Cyr and Sherry Dupre, DOTD

Strategic Planning and Key Performance Measures

Wade Lester, DOTD

Session 24: Traffic Engineering

Moderator: Kimberly McDaniel

Meeting Room 10



Traffic engineering has become a critical discipline to the transportation industry. The cost of increasing capacity has become more difficult to support economically and the challenge of better managing the operation of our current roadway networks has become critically important. Louisiana, like many other states, is taking steps to improve traffic management and this session will outline innovative intersection improvements that have been implemented in the city of Lafayette as well as a J-turn intersection solution in Baton Rouge. DOTD is also currently conducting studies to improve mobility and safety on 3 major corridors in Louisiana, and this session will outline those processes. The session will also include a presentation on speed studies conducted on two major interstate routes and the results of those studies as they pertain to the operation and safety of the interstate system.

Innovative Detection, Data Collection, Data Mining and Other Real World Applications – Lafayette Traffic Signal System

Warren Abadie and Tony Tramel, Lafayette Consolidated Government

J-Turn Project in Baton Rouge - Traffic Analysis

Laurence Lambert, Stantec

Current Corridor Studies

Bob Schmidt, AECOM

Speed Studies

Akhilendra Chauhan, ARCADIS

Session 25: Concrete Construction 1

Moderator: Bill Temple

Meeting Room 11

This session will explore various topics related to concrete construction and testing. Roller compacted concrete will be discussed with respect to material and construction methods. Innovative testing methods being explored by DOTD will be identified and briefly outlined. Concrete overlays will be discussed in terms of low volume roadways and alternative construction methods, including split slab construction and concrete inlays. Last, a comparison of the costs of asphalt versus concrete alternatives will be detailed.

Roller Compacted Concrete

Chris Carwie, A.G. Peltz Group, LLC

Innovative Testing

Tyson Rupnow and Patrick Icenogle, LTRC

Getting the Most Out of Concrete

Brian Killingsworth, NRMCA

Overlay Low Volume Roads

Mike Ayers, Global Pavement Consultants, Inc.

Session 26: Minimum Standards for Land Surveyors (Workshop)

Moderator: Eric Lanier

Meeting Room 12

This session will serve as a review of the statutory requirements for land boundary surveys in the state of Louisiana.

Minimum Standards for Land Surveyors

Stephen Estopinal, SJB Group

Session 27: New 2013 Specification Book - General, Incidental, and Materials

Moderator: John Wells

Meeting Room 13

The various section committees have been rewriting the DOTD Standard Specifications for over three years now. Substantial changes have been made in all areas of the standards, with some sections having been completely rewritten, and others updated to reflect current practices. In this session, revisions on Part I (General Provisions), Part VII (Incidental Construction), and Part X (Materials) will be discussed.

New Standard Specifications Book General Changes

John Wells, DOTD

Part 1 Review of General Provisions Specification Changes

Ed Wedge, DOTD

Part 7 Review of Incidental Specification Changes

John Wells, DOTD

Part 10 Review of Materials Specification Changes

Luanna Cambas, DOTD

[TUESDAY 10:15 a.m.–12:00 p.m.]

Session 28: Materials and Testing- Application of GPC, XRF, XRD

Moderator: *Richie Charoenpap*
Meeting Room 2

This session will discuss the testing and acceptance of the materials using chemical testing equipment and innovation. First, we will explain the testing and evaluation of New Products. We will discuss Evaluation methods, record keeping, and usage of the new products list (Specialty Products Table.) Second, we will discuss testing of polymer asphalt binder by Gel Permeation Chromatography technology and Materials Lab experiences. How can GPC be applied in testing of other construction materials? Third, we will discuss the application of non-destructive elemental and micro-structural analysis of construction Materials such as cement, fly ash, metals, glass, and paint pigments etc. utilizing X-Ray Fluorescence and X-Ray Diffraction technology.

New Product Evaluation

Theresa Taylor, DOTD

Asphalt GPC testing

Golden Hwaung and Michael Grubb, DOTD

Non-Destructive Elemental and Microstructural Analysis of Construction Materials

Stephen Williams, PANalytical Inc.

Session 29: DOTD Local Public Agency Programs—Partnering to Improve the Quality of Life for Louisiana's Citizens

Moderator: *Nick Verret*
Meeting Room 3-4



State and federal funds are available through DOTD for local government agencies to implement transportation-related projects. This session will provide an overview of the Department's LPA programs, with a special emphasis on the concept of "responsible charge" on these projects. DOTD's new LPA Qualification Core Training initiative will also be addressed. Rounding out this session will be a brief discussion of the "complete streets" concept and an overview of the new "Guide for the Development of Bicycle Facilities, Fourth Edition."

Changes to the AASHTO Bike Guide

Brian Parsons, DOTD

Overview of LPA Programs and Qualification Core Training Program

Ann Wills, DOTD

Federal Money, MAP 21, FHWA/DOTD Relationship with LPA

Mary Stringfellow, FHWA

Responsible Charge & Reporting

Anna Hanks and Laura Riggs, DOTD

Session 30: Highway Safety Boot Camp Part 1 (Workshop)

Moderator: *Karla Courtade*
Meeting Room 5-6



Are transportation planners able to meaningfully integrate safety into the planning and programming activities or do capacity, environmental impacts, and political priorities dominate the decision-making process? Since 1998, when federal legislation first addressed safety as a planning requirement, planners have struggled to answer the question: how do we meaningfully integrate safety into our planning products and programs? Establishing safety as a goal is the easy part, but what comes next? Early on, this was a particular challenge because most safety planning was reactive, which doesn't fit well when planning for a 20+ year horizon. However, the world of safety has changed dramatically in the last decade and proactive, long-range planning is feasible. Further, we know more about the benefits of reducing crash frequency or severity in the context of livability and community public health. This two-part interactive workshop is designed to provide a framework and tools for addressing safety in the long range planning process and other planning exercises. Part 1 presents the research, reviews the transportation safety planning framework, and addresses questions, recommendations, and other comments. Part 2 facilitates an interactive workshop designed to produce an action plan for future reference.

Basics of Highway Safety

Susan Herbel, Cambridge Systematics

Session 31: Bridge Maintenance and FHWA Metric

Moderator: *David Miller*
Meeting Room 7-8

This session presents an overview of the emergency projects that have been performed by the DOTD Bridge Maintenance Section, along with two unique repair projects. Compliance with FHWA Metric No. 15 concerning bridge files will also be discussed.

I-10 New Orleans East Post Tensioning

Steven Sibley, DOTD

Bridge Maintenance Emergency Projects

Haylye Brown, DOTD

Compliance with FHWA Metric No. 15—Bridge Files

Artur D'Andrea, DOTD

Reliability-Based Bridge Load Posting—The LRFR Approach

Lubin Gao, FHWA

Session 32: Transportation Performance Management: Setting Target for Improvement and Achieving Success

Moderator: Hector Santiago
Meeting Room 9



Transportation Performance Management (TPM) is defined as “a strategic approach that uses system information to make investment and policy decisions to achieve national performance goals.” This session is designed to promote awareness and share expectations with DOTD, MPOs, and other partners on how the Federal Highway’s Programs will be overseen in the form of TPM. The goals of this session are to: (1) share MAP-21 performance elements and our approach to implementation, (2) advance FHWA performance-based principles and practices, (3) promote LADOTD ongoing initiatives moving to TPM, and (4) share successful stories and best practices of using TPM.

FHWA Transportation Performance Management (TPM) – Featuring MAP-21 performance elements and FHWA Approach to Implementation

Peter Stephanos, FHWA

LADOTD Performance Management Initiatives for MAP-21

Michael Bridges, DOTD

Successful Implementation of Transportation Performance Management

Kirt Clement, DOTD

Session 33: Future Transportation Workforce Initiative (Workshop)

Moderator: Mary Leah Coco
Meeting Room 10

When you retire from the “team”, there may be no one on the bench to take your place! Over 11,000 transportation workers will be needed in Louisiana by 2018. Unfortunately there are not enough younger workers in the “pipeline” to replace retiring baby-boomers and this is compounded by a lack of interest among young people, particularly minorities and females, in transportation careers. This will result in high competition for skilled-trades workers and knowledge workers. Learn how the FHWA and LTRC are sponsoring a STEM-based outreach program to raise transportation awareness and interest at local high schools and K-8 schools.

Future Transportation Workforce Initiative

Glynn Cavin, LTRC, Mary Leah Coco, LTRC, Linda Clifton, and Krisanna Machtmes

Session 34: Concrete Construction 2

Moderator: Tyson Rupnow
Meeting Room 11

This session will explore pervious concrete materials and construction techniques. The discussion will include reasons to choose pervious pavements over conventional pavements. A discussion on pavement ride quality and the effects of construction processes on the IRI will be detailed. The benefits of concrete with internal curing

capabilities will be detailed. The session will conclude with an in-depth look at sustainability and performance of Portland-limestone cements.

Pervious Concrete

Darrell Elliot, Buzzi Unicem USA

Pavement Ride

Mike Ayers, Global Pavement Consultants, Inc.

Improving the Durability and Sustainability of Concrete with Internal Curing

Jeff Speck and Steve Rowe, Big River

Improvement of Concrete Sustainability and Performance Using Portland-Limestone Cements

Tim Cost, Holcim

Session 35: Location-Based Decision Support — GIS for Managers and Administrators (Workshop)

Moderator: James E. Mitchell
Meeting Room 12



This workshop will inform managers and administrators about how location-based decision support is provided by DOTD’s enterprise GIS to support their mission. It includes an introduction to basic GIS concepts and terminology. Numerous examples will demonstrate how DOTD staff use GIS technology to solve every-day problems. Participants will learn how they and their employees can take advantage of DOTD’s enterprise GIS. Additional topics include training available at DOTD, GIS data viewers and desktop options, accessing non-DOTD GIS data via web services, GIS web applications, DOTD’s GPS Management Plan, and future directions for GIS at DOTD.

GIS for DOTD Managers and Administrators Workshop

Jennifer Harrison, TeachMeGIS, Doug Albert, DOTD, Kurt Johnson, DOTD, and James E. Mitchell, DOTD

Session 36: New 2013 Specification Book—Earthwork, Base Courses, and Asphaltic Pavements

Moderator: John Wells
Meeting Room 13

The various section committees have been rewriting the DOTD Standard Specifications for over three years now. Substantial changes have been made in all areas of the standards, with some sections having been completely rewritten, and others updated to reflect current practices. In this session, revisions on Part II (Earthwork), Part III (Base Courses), Part IV (Surface Courses), and Part V (Asphaltic Pavements) will be discussed.

New Standard Specifications Book General Changes

John Wells, DOTD

Part 2, 3, 4: Review of Earthwork and Base Course Specifications

Mark Morvant, LTRC

Part 5: Review of Asphalt Pavement Specification Changes

Chris Abadie, DOTD

[TUESDAY 1:00 p.m.–2:45 p.m.]

Session 37: University Transportation Center—Safety and Policy Research

Moderator: Skip Paul
Meeting Room 2



This session will present a sample of ongoing research associated with the Louisiana Transportation Research Center's partnership with two University Transportation Centers (UTC): the National Center for Intermodal Transportation for Economic Competitiveness (NCITEC) housed at Mississippi State University and the Southwest Region University Transportation Center (SWUTC) housed at Texas A&M. UTCs are funded by the Research and Innovative Technology Administration (RITA) of the USDOT and are internationally recognized centers of excellence, fully integrated within institutions of higher learning, that serve as a vital source of leaders who are prepared to meet the nation's need for safe, efficient and environmentally sound movement of people and goods.

Improving Freight Crash Incident Management

Stephen Glascock, DOTD

Development of Minimum Requirements for Local Growth Management Policies

Tara Tolford, UNO

Development of a Tool for Documenting, Tracking, Recording and Analyzing Improvements to Intersection Sites and Roadway Departures in Curve Locations

Helmut Schneider, LSU

Calibration of Louisiana Highway Safety Manual

Brian Wolshon, LSU

Session 38: Railroad Engineering

Moderator: Phil Jones
Meeting Room 3-4



Rail industry consultants will present a review of railroad engineering and an update of current public-private rail projects in Louisiana. Experts will discuss basic design, construction, and maintenance of railroad networks, signaling system, and rail yards. Project consultants will provide information on the status of the New Orleans Rail Gateway Program, the New Orleans & Gulf Coast Railroad relocation project, and the Baton Rouge – New Orleans Passenger Rail.

Railroad Engineering 101

David Wilcock, Michael Baker Jr., Inc.

New Orleans Rail Gateway Program

Chris Gesing, Michael Baker Jr., Inc.

Rail Initiatives in Louisiana

Kevin Keller, HDR Engineering, Inc.

Session 39: Highway Safety Boot Camp Part 2 (Workshop)

Moderator: Dan Magri
Meeting Room 5-6



Are transportation planners able to meaningfully integrate safety into the planning and programming activities or do capacity, environmental impacts, and political priorities dominate the decision-making process? Since 1998, when federal legislation first addressed safety as a planning requirement, planners have struggled to answer the question: how do we meaningfully integrate safety into our planning products and programs? Establishing safety as a goal is the easy part, but what comes next? Early on, this was a particular challenge because most safety planning was reactive, which doesn't fit well when planning for a 20+ year horizon. However, the world of safety has changed dramatically in the last decade and proactive, long range planning is feasible. Further we know more about the benefits of reducing crash frequency or severity in the context of livability and community public health. This two-part interactive workshop is designed to provide a framework and tools for addressing safety in the long-range planning process and other planning exercises. Part 1 presents the research, reviews the transportation safety planning framework, and addresses questions, recommendations, and other comments. Part 2 facilitates an interactive workshop designed to produce an action plan for future reference.

Basics of Highway Safety

Susan Herbel, Cambridge Systematics

Session 40: Bridge Design and Geotechnical Solutions

Moderator: Jenny Fu
Meeting Rooms 7-8

The second Strategic Highway Research Program (SHRP 2) was authorized by Congress to address some of the most pressing needs related to the nation's highway system. This session includes two projects in the SHRP 2 program that address the design of bridges for service life and the geotechnical solutions for soil improvement, rapid embankment construction, and stabilization of the pavement working platform. The session will also include a case study of rapid embankment construction over soft compressible soils using light-weight aggregate and a research project on the management of pile driving vibration.

General and Comprehensive Framework for Design of Bridges for Service Life

Atorod Azizinamini, Florida International University

Web-Based Toolbox for Geotechnical Engineers

Ryan R. Berg, Ryan R. Berg and Associates

Case Study: Rapid Embankment Construction of US 17 Bypass Interchange Over Soft Compressible Soils Using Lightweight Aggregate, Myrtle Beach, South Carolina

Ed Tavera, GeoStellar Engineering, LLC, and Jeff Speck, Big River

Pile Driving Vibration Management

Gavin Gautreau, LTRC

Session 41: Louisiana Compliance Programs

Moderator: Stephanie Ducote

Meeting Room 9

The session provides a brief history of the ADA and outlines the requirements of Title II of the Americans with Disabilities Act as it applies specifically to public entities and their programs, services, facilities and rights-of-ways. It provides an overview of the new 2010 ADA and Proposed Right-of-Way Guidelines. It illustrates the development and identifies the main components of the required "Self Evaluation and ADA Title II Transition Plan." The session is aimed at creating awareness of the ADA and Title II requirements as it applies to all that is owned, controlled and/or maintained, including programs and services by public entities.

DOTD Compliance Programs Staff will provide a PowerPoint presentation regarding the new Small Business Element (SBE) Program as required under 49 CFR 26. Explanation on who is eligible to apply under the SBE Program, what information must be completed and submitted to the Compliance Programs Office, and which projects DOTD will target for SBEs. Additionally, information will be provided for a better understanding of the difference in DBE and SBE.

ADA Self-Evaluation/Transition Plan

Richard Londono, ADAAG Consulting Services, LLC

Implementation of Small Business Element Program

Remy Graves and Juanita Linton, DOTD

Session 42: Missouri DOT's Practical Design Policy

Moderator: Chad Winchester

Meeting Room 10

Missouri DOT implemented "Practical Design" to produce projects with the best value for the least cost. MoDOT's goal of Practical Design is to build "good" projects, not "great" projects, to achieve a great overall system. Practical Design challenges traditional standards to develop efficient solutions to solve today's project needs. Innovation and creativity are necessary to accomplish Practical Design. MoDOT employees will present their Practical Design Policy. A second presentation will discuss the policy's effects on tort liability issues.

Implementation of Practical Design in Missouri

Kathy Harvey, Missouri Department of Transportation

Practical Design Tort Liability

Jay Smith, Missouri Department of Transportation

Session 43: Asphalt Construction 1

Moderator: Bill King

Meeting Room 11

This session will provide a general discussion of construction and related topics, including characterization of materials used in asphalt concrete paving mixtures.

History of Asphalt Pavement Design

Dave Newcomb, Texas Transportation Institute

Why the Multiple Stress Creep Recovery (MSCR) Test Should be Implemented

Danny Gierhart, Asphalt Institute

Louisiana's Experience with Multiple Stress Creep Recovery

Md. Sharear Kabir, DOTD

Session 44: Management Systems & Traffic Monitoring

Moderator: Jason Chapman

Meeting Room 12

This session is intended to share information about DOTD's initiatives in the area of Management Systems and Traffic Monitoring. It will focus on the data distribution efforts and advancements in Pavement and Bridge Management as well as the collection and distribution of data in Traffic Monitoring.

Pavement Management

Chris Fillastre and Ashley Horne, DOTD

Bridge Management

Scott Choate, DOTD

Traffic Monitoring

Joshua Albritton, DOTD

Session 45: New 2013 Specification Book—Concrete and Structures

Moderator: John Wells

Meeting Room 13

The various section committees have been rewriting the DOTD Standard Specifications for over three years now. Substantial changes have been made in all areas of the Standards, with some sections having been completely rewritten, and others updated to reflect current practices. In this session, revisions on Part VI (Rigid Pavement), Part VIII (Structures), and Part IX (Portland Cement Concrete) will be discussed.

New Standard Specifications Book General Changes

John Wells, DOTD

Part 6, 9 Review of Concrete Pavement Specification Changes

John Eggers, DOTD

Part 8 Review of Structures Specification Changes

Ray Mumphrey, DOTD

Session 46: University Transportation Center—Multimodal Research

Moderator: Skip Paul

Meeting Room 2



This session is a continuation of Session 37 and will present a sample of ongoing research associated with the Louisiana Transportation Research Center's partnership with 2 University Transportation Centers (UTC): the National Center for Intermodal Transportation for Economic Competitiveness (NCITEC) housed at Mississippi State University and the Southwest Region University Transportation Center (SWUTC) housed at Texas A&M. UTCs are funded by the Research and Innovative Technology Administration (RITA) of the USDOT and are internationally recognized centers of excellence, fully integrated within institutions of higher learning, that serve as a vital source of leaders who are prepared to meet the nation's need for safe, efficient and environmentally sound movement of people and goods.

Development of Performance Measurement for Freight Management

Peter Kelle, LSU

Economic Analysis of Short Line Railroads

Jared Llorens, LSU

Use of Containers to Carry Bulk & Breakbulk Commodities and Its Impact on Gulf Region Ports and International Trade

Jim Amdal

Session 47: Planning

Moderator: Dan Broussard

Meeting Room 3-4

Long-Range Transportation Planning looks at the transportation system's future conditions, needs and opportunities to guide decisions we make today. These plans project the transportation system needs and requirements for future years and help shape local, regional, and state strategies for addressing economic growth, safety, congestion, air quality, and public mobility. This session will include an overview of The Department of Transportation and Development's current plan update.

The recent passage of the new federal transportation law, MAP-21, requires states to consider freight performance measures, freight planning and advisory councils to assist in prioritizing investments that assist in improving or reducing delays associated with commercial traffic. Come learn about MAP-21 and how it will affect Louisiana. Learn about the performance measures required in MAP-21 and how they will shape the planning program at the federal, state and local level. The research needs in implementing these programs for multistate corridor planning will also be discussed.

Summary of new Transportation Law – MAP 21

Mary Stringfellow, FHWA

Regional Prioritization of Freight Networks

Bruce Lambert, Institute for Trade and Transportation Studies

Louisiana Statewide Transportation Plan

Donald Vary, CDM Smith

Performance Measures in Transportation Planning

Mary Stringfellow, FHWA

Session 48: Increasing Crash Data Completeness, Accuracy, and Accessibility—Creating a Data Warehouse To Produce a Single Version of the Truth

Moderator: Terri Monaghan

Meeting Rooms 5-6



The Highway Safety Research Group at Louisiana State University, funded by the Louisiana Department of Transportation and Development (LADOTD), collects and analyzes traffic crash data for the state of Louisiana. Over the past few years, a major focus was placed on decreasing the time it takes to report crash data to the state. With the success of data collection efforts, the HSRG is now focusing on providing tools and resources to help agencies at all levels throughout the state better understand and utilize their crash data. This session will present several tools for utilizing crash data to improve traffic safety. Presentations will cover several steps including issues relating to creating a data warehouse, cubes and dimensions for specific safety issues; ad hoc simple low cost analysis tools; and using business intelligence to create dashboards and reports.

Why Collect Crash Data?

Ron Whittaker, DOTD

Accessing Crash Data

Cory Hutchinson and Mark Verret, HSRG/LSU

Session 49: Movable Bridges and Roadway Lighting

Moderator: Stewart Hingle

Meeting Room 7-8

In this session, the presentations cover various type of work for movable bridges, including the Stage 0 and 1 study for a movable bridge replacement project, rehabilitation of a swing span bridge, and instrumentation design for a vertical lift bridge. An overview of the roadway lighting program in Louisiana will also be presented.

Stage "0" and Environmental State "1" Bridge Study for the Chef Menteur Bridge Replacement

Lynn Maloney-Mujica, Arcadis

Houma Navigation Canal Swing-Span Bridge Rehabilitation

Bruce Peterson, Modjeski and Masters, Inc.

Danziger Bridge Vertical Lift Bridge Instrumentation

Ching Tsai, DOTD

Overview of Roadway Lighting in Louisiana

Michael Armentor, DOTD

Session 50: Right of Way Knowledge Improves Project Delivery

Moderator: Hubert Graves

Meeting Room 9



Successful project delivery depends upon effectively balancing the three-legged stool of right of way production: Cost, Schedule, and Quality. DOTD personnel, local public agency officials, and the consultant community will benefit from the information provided at this session. This session is designed to promote awareness of the importance of clearing right of way on schedule, minimizing acquisition costs, and preserving federal aid participation.

The Right of Way Production Procedure—A Hot Tamale

Hubert Graves, DOTD

Fifty Ways to Lose Your Money—Preservation of Federal Money in Right of Way Acquisition

James Hall, FHWA

The High Cost of What You Don't Buy—The Complexity of Partial Takings

Donna Stinson, DOTD

Session 51: Multilane Roundabouts and Practical Experience

Moderator: Ryan Richard

Meeting Room 10

Many roundabouts have been constructed in Louisiana with many more in development. Multi-lane roundabouts are the next step, to handle ever increasing traffic volumes. This session will focus on the design and application of multi-lane roundabouts and will also present some practical experiences in Louisiana.

Multi-lane Roundabout Design

Howard McCulloch, NE ROUNDABOUTS

Acadiana's Roundabout Experience

Dax Douet and Jacob Benfield, FENSTERMAKER

US 171 at LA 8 Roundabout - Before and After Safety and Operations

Marcus Connella, DOTD

Session 52: Asphalt Construction 2

Moderator: Bill King

Meeting Room 11

This session will be a general discussion of construction and research related issues related to sustainable materials used in asphalt concrete paving mixtures.

Sustainability in Asphalt Pavement Design and Construction

Dave Newcomb, Texas Transportation Institute

Research Update: Testing and Analysis of LWT and SCB Properties of Asphaltic Concrete Mixtures

Samuel Cooper, III, LTRC

Emulsions - Tack Coat to Chip Seal

Danny Gierhart, Asphalt Institute

Session 53: Road Inventory & Mapping

Moderator: Jason Chapman

Meeting Room 12

This session will give an overview of DOTD's efforts to update and maintain the inventory data for Louisiana roadways for both the state highway system and local roads. It will also focus on the mapping of highways and inventory data items using the latest GIS tools and datasets.

Highway Inventory

Delicia Justice and Brandon Wood, DOTD

Mapping

Darryl Mack, DOTD

Local Road Inventory

Brian Reigh and Nathan Baylot, DOTD

Session 54: Contract Services 2

Moderator: Jason Dunlap

Meeting Room 13

Discussions on various DOTD Contract Services Activities will continue. The implementation of CRLMS (Civil Rights and Labor Management System) in Trns*port Version 2.02 will be discussed. Other discussions will include on how bid collusion activities are investigated by federal agencies. New procedures developed by DOTD on engineering consultants' ratings and how to appropriately respond to advertisement for solicitation of engineering services will be discussed in this session.

Civil Rights Labor Management Systems

Pamela Barry, Info Tech, Inc.

Bid Collusion

Ryan Lefort and Glenda White, US DOT

Consultants Rating and Proposal Advertisements

Alan Dale, DOTD

[WEDNESDAY 8:00 a.m.–9:45 a.m.]

Session 55: Implementation of Geotech Research

Moderator: Zhong Wu
Meeting Room 2

Earthwork is an essential part of roadway construction. This session will cover several implementation research works recently finished at the Louisiana Transportation Research Center, which include the intelligent compaction on base courses and subgrade of pavements, the design and construction of geosynthetics reinforced web subgrade of highways, and typical design values of Louisiana pavement base courses, etc. The session will also talk about the design of drilled shaft using LRFD methodology in Louisiana.

Intelligent Compaction in Louisiana

Gavin Gautreau, LTRC

Design Values of Resilient Modulus of Stabilized and Non-Stabilized Base

Khalil Hanifa, LTRC

Geosynthetic Stabilization for Soft Subgrade

Xiaochao Tang, LTRC

Calibration of Resistance Factors of Drilled Shafts for LRFD in Louisiana

Murad Abu Farsakh, LTRC

Session 56: Every Day Counts—Louisiana's Success and Current Efforts

Moderator: Mary Stringfellow
Meeting Room 3-4

Every Day Counts (EDC) is an FHWA national effort designed to identify and deploy innovation aimed at shortening project delivery, enhancing the safety of our roads, and protecting the environment. FHWA and DOTD have worked together to provide an active role in implementing the various EDC initiatives. This session showcases some of the innovations adopted in Louisiana and how they have provided savings in time and money. Come join us and make Every Day Count!

Why Should Every Day Count for You? How Every Day Has Counted in Louisiana—Our Successes so Far!

Ann Wills, DOTD

Innovative Bridge Applications in Louisiana—Prefabricated Bridge Elements

Paul Vaught, III, DOTD

Innovative Bridge Applications in Louisiana—Geosynthetic Reinforced Soil Integrated Bridge System (GRS IBS)

Steve Meunier, DOTD

Innovative Contracting Methods—Understanding the Benefits of “Construction Manager/General Contractor” on Highway Construction Projects

John Haynes, FHWA

Session 57: Tort Liability: Is Ignorance Bliss?

Moderator: Dan Magri
Meeting Room 5-6



Does not knowing about a hazardous or potentially hazardous condition increase or decrease an agency's liability? What positive actions can you take to better manage the Department's risk? These and other questions will be answered in an interactive session where a panel of attorneys will respond to legal issues facing the Department.

Tort Liability: Is Ignorance Bliss?

Carol Hunter, Brandon Brown, and Barry Toups, LA Dept. of Justice

Session 58: Bridge Rehabilitation, Bridge Design and Bridge Rating

Moderator: Paul Fossier
Meeting Room 7-8

This session includes a presentation on stay cable replacement of the Luling Bridge, where the cable replacement design and its implementation are the first attempted in North America. The bridge rating of a steel truss bridge using 3-D FEM analysis will also be presented. This session also includes presentations on two relatively new structure types to be implemented in Louisiana: segmental concrete girders and full depth precast decks.

Stay Cable Replacement of the Luling Bridge

Armin Mehrabi, Bridge Engineering Solutions

3-D Finite Element Analysis and Load Rating of I-10 Calcasieu River Bridge, Lake Charles

Mohsen Shahawy, LPA/SDR Engineering

I-49 North Segment K Project – Segmental Concrete Girder Design

R. Craig Finley, Jr., Finley Engineering Group, Inc., and Durk Krone, TRC

AccelBridge - Practical Solutions for Full Depth Precast Decks

Eddie He, AccelBridge

Session 59: The Business Side of DOTD

Moderator: Nita Chambers

Meeting Room 9

There are many myths and misconceptions regarding the business side of DOTD that affect many consultants and project managers. This session will cover overview and myths associated with consultant overhead rates and direct charges, the project manager's role in asset accounting, and indirect costs on federal projects.

Consultant Overhead Rates and Direct Charges

John Lyon, DOTD

Capitalized Asset or Maintenance Activity Classification

Alex Levy, DOTD

The Misconceptions of Indirect Cost Funding

Beverly Hodges, DOTD

Session 60: Intelligent Transportation System— What are we doing?

Moderator: Stephen Glascock

Meeting Room 10

This session covers a variety of responsibilities and services provided by the ITS section, including tolling systems, Motorist Assistance Patrol, as well as support for other DOTD sections with equipment specifications, design assistance, and traveler information.

Electronic Tolling, the Technology in the Road, the Vehicle and Behind the Scenes

Steve DeBella, HNTB

Motorist Assistance Patrol, When to Include in a TMP and Use in Construction Zones

Elizabeth Delaney, DOTD

Traffic Control for Incident Management

John Broemmelsiek, FHWA

ITS Services for Internal DOTD Support and Public Information

Carryn Ferrier, DOTD

Intelligent Parking System

Von Lopez-Jacobs, Gannett Fleming, Inc.

Session 61: LaGov Implementation

Moderator: Tom Sands

Meeting Room 11

LaGov went live more than two years ago. This session will share some of the experiences in modifying processes and documentation, advances in reporting, and what the users should expect to see in the foreseeable future.

Show Me the Money - Contracts Payments and Closure Process

Mark St. Cyr, DOTD

Better Business through Better Reporting

Beth Adams and Diana Schoenfeld, State of Louisiana - DOA/OIS

What's Next? - LaGov Enhancements

Marc Jones, DOTD

Session 62: Agile Assets

Moderator: Bill Drake

Meeting Room 12

A discussion of the history of the Department's development, implementation, and use of handheld devices for the tracking, recording, and reporting of maintenance field activities. Louisiana is one of a few states that are using handheld devices with our Agile Assets software. We have been recognized as a leader in this area. This session will give a history of Agile Assets and what we have done right in the implementation of the handheld devices. The panel discussion will give the audience a chance to ask questions that may help them with questions they may have.

Use of Mobile Devices with Agile Assets in Louisiana

Vince Latino, DOTD

The Good, the Bad, and the Ugly of Mobile Devices

Vince Latino, Leslie Mix, Deidre Hill, and Missy Sowards, DOTD

Session 63: Project Management

Moderator: Jeff Brown

Meeting Room 13



The delivery of a major project is a team effort that involves members and stakeholders within and outside the organization. This includes federal, state, and local governmental entities, consultants, contractors, utility companies and railroads. This session will be a discussion of project management practices and principals used to deliver major transportation and related projects. An overall view of team productivity will be presented along with project specific discussions on the L'Auberge Casino project and the Cove Lane Interchange Project.

Productivity—Making the Most of Your Team's Time

Scott Hoffeld, Arcadis

L'Auberge Casino Project

Vyron Bernard, Stantec

I-210 Interchange Improvements—Making Every Day Count

Tim Nickel, DOTD

[WEDNESDAY 10:00 a.m.–11:45 a.m.]

Session 64: Latest Developments in Pavement

Characteristics

Moderator: Murad Abu-Farsakh

Meeting Room 2

This session presents the results of recently finished LTRC research projects on Louisiana's pavement in the areas of surface friction, serviceability deterioration, and highway-speed in-situ pavement structural evaluation as well as their potential implementation in LA DOTD with respect to pavement design, rehab, and management, etc.

Evaluation of Friction Characteristics of Wearing Course Mixtures in Louisiana

Zhong Wu, LTRC

Pavement Structure Evaluation using Rolling Wheel Deflectometer Data

Mostafa Elseifi, LSU

Integrating Rolling Wheel Deflectometer Deflection Measurements into Pavement Management Systems using Multivariate Statistical Methods and Fuzzy Logic

Mostafa Elseifi, LSU

Rideability Prediction for HMA Overlay Treatment of Flexible and Composite Pavements for Louisiana

Jamal Khattak, ULL

Session 65: Mega Projects

Moderator: Robert Boagni

Meeting Room 3-4

Louisiana's highway system is the cornerstone mode with which all other modes of transportation interact. Not only does the highway system affect personal mobility, it also provides the connectivity with ports, rail, and aviation. Highways are crucial to commerce and directly impact Louisiana's economy.

The Louisiana Statewide Transportation plan identified and prioritized complex high-cost congestion relief projects often referred to as the State's Mega Projects. In addition The TIMED (Transportation Infrastructure Model for Economic Development) program included widening 536 miles of state highways to four lanes on 11 project corridors and widening and/or new construction on three major bridges.

This session will provide an update on both I-49 North and I-49 South. Also being covered are the last two TIMED projects, Florida Avenue and LA 3241. In addition, there will be an update on the status of the LA 143 to US 165 Connector/Ouachita River Bridge.

Florida Avenue

Jacob Loeske, Buchart-Horn, Inc.

LA3241 and I-12 to Bush

Jeffrey Burst, DOTD

I-49 North

Joe Umeozulu, DOTD

I-49 South

Ed Wedge, DOTD

Ouachita River Bridge / LA143 to US165

Scott Hoffeld, Arcadis

Session 66: Effective Communication Strategies (Workshop)

Moderator: Karla Courtade

Meeting Room 5-6

This workshop will explore the role of media in traffic safety and highlight how participants have used the media to support their traffic safety efforts. To help improve media relations, the workshop will review the essentials of media relations, i.e., what the media wants, and the tools to gain media attention such as news advisories, press releases, follow up calls, email, etc. The role of social media will also be discussed such as Facebook, YouTube, and Twitter, etc., along with ideas on how participants can increase attention to their issue or event by using these tools. The workshop will conclude with an interactive feature where participants will have an opportunity to develop a story idea and convince the media to cover their event.

On the Same Page

Pam Beer

Session 67: Mississippi River Crossings at Vicksburg (I-20 and Railroad)

Moderator: Artur D'Andrea

Meeting Room 7-8



The successful operation of any east-west land based transportation corridor depends on the reliability of the bridges crossing the Mississippi River. The east-west corridor at I-20 in Vicksburg, Mississippi contains two vital river crossings, the railroad crossing and Interstate 20 river crossing. The geological instability of the river in the Vicksburg area has created operational challenges to the owners of these bridges. The presentations will describe the geology of the area, the movements of the landmasses, the historical damages to the bridges, and past retrofit projects. The presentations will also include discussion on the future projects aimed at the retrofit of the structure, the reinforcement supporting landmasses, and monitoring devices and traffic warning systems.

Truss Retrofit to Mitigate Substructure Displacement at I-20 Mississippi Bridge at Vicksburg

Zolan Prucz, M & M

Challenges Maintaining a Vital East-West Rail Corridor at Vicksburg Mississippi: Measures Taken and Repairs Made to the Railroad Truss

Rudy McLellan, GEC, Inc.

Geotechnical Investigation at and near I-20 Mississippi Bridge at Vicksburg

Robert J. Werner, Ardaman & Associates, Inc.

Implementation of Warning System for I-20 Mississippi Bridge at Vicksburg

Kevin Magee, Mississippi DOT

Session 68: Public Works

Moderator: Doug Taylor

Meeting Room 9

This session is designed to share information on new technologies used in the Levee Safety and Dam Safety groups at DOTD. The Levee Safety group is using GPS and GIS technologies to inspect and document levee conditions throughout the state. The Dam Safety group is using emerging technologies for spillway repair, which reduces the amount of time and money needed to make routine repairs to dams. Additionally, the Statewide Flood Control group will discuss the requirements and procedures to have projects incorporated into the statewide program.

Using GPS and GIS in Levee Inspections

Buck DeFee, HNTB and Doug Taylor, DOTD

Rehabilitation of the Cane River Spillway

Randy Denmon, Denmon Engineering, and Brad Sticker, DOTD

Statewide Flood Control Program

Skyler Waaso, DOTD

Session 69: Where the Rubber Meets the Road— DOTD District Issues

Moderator: Murphy Ledoux

Meeting Room 10

This session will examine some of the diverse challenges faced by the DOTD districts. The first presentation will deal with a District 62 project that addressed access management concerns through the construction of “J-turn” median openings. Next will be an overview of ongoing research to quantify the key factors that create roadway flooding. Wrapping up this session will be a discussion of the challenges to the existing infrastructure encountered by District 04 as a result of the natural gas exploration and production in the Haynesville shale strata found in that part of the state.

Use of J-Turns for Access Management in District 62

Scott Boyle, DOTD

Quantifying the Key Factors That Create Roadway Flooding

Joshua Kent, LSU

Haynesville Shale Exploration & Production— Infrastructure Challenges

John Sanders, DOTD (Retired)

Session 70: Technology Updates

Moderator: Tom Sands

Meeting Room 11

In the past two years, the DOTD IT section has undergone significant changes in its organizational structure, the services that are delivered, and the technologies deployed. The presentations in this session will share a few of the initiatives that are affecting the technology needs of DOTD’s employees, stakeholders, and clients.

New e-Business Solutions at DOTD

Brendan Rush and David Orr, DOTD

IT Customer Centric Reorganization - What’s In It for You

Brad Doucet, DOTD

Sharepoint - How Can It Make My Job Easier

Jeff Till, DOTD

The DOTD Data Network - Current & Future

John Graham and Erik Smith, DOTD

Session 71: Bridge Maintenance and Roadside

Moderator: David Miller

Meeting Room 12

Transportation infrastructure and water management are inextricably linked in low-lying lands. Dutch Dialogues and the Water Management Strategy for Greater New Orleans are an attempt to change the paradigm from reliance on pipes and pumping alone to building with nature and living with water to manage subsidence, rejuvenate our landscape, and leverage the value of our public investments.

Infrastructure and Water Management

David Waggoner, III, Waggoner & Ball Architects

Session 72: Environmental

Moderator: Robert Lott

Meeting Room 13



The National Environmental Policy Act (NEPA), along with other environmental laws mandates that federal agencies take a hard look at the effects their actions may have on the environment. Federal actions requiring this type of evaluation include funding, permitting, and approvals. Evaluating the effects of transportation projects on both the natural and human environments requires an interdisciplinary approach to deal with the variety of issues that arise. This session illustrates the diversity of issues typically encountered when evaluating transportation projects. Topics include agency coordination, permitting, historic bridges, and environmental justice.

Coastal Use Permitting

Karl Morgan and David Fruge, LA DNR Office of Coastal Management

Louisiana Historic Bridge Inventory Project Update

Amy Squitieri, Mead & Hunt

Environmental Justice on ICC project

Kerry Oriol, Providence, and Kent Rogers, NLCOG

NOTES

SPEAKER INDEX

A

Abadie, Chris— 15
Abadie, Warren—13
Abu Farsakh, Murad— 20
Adams, Beth— 21
Albert, Doug— 15
Albritton, Joshua— 17
Allery, Bryan— 12
Al-Qadi, Imad— 10
Amdal, James— 18
Armentor, Michael— 18
Ayers, Mike— 15
Azizinaminni, Atorod— 16

B

Barrow, David—12
Barry, Pamela— 19
Baylot, Nathan— 19
Beck, Harold— 10
Beer, Pam— 22
Benfield, Jacob—19
Berg, Ryan R.— 16
Bernard, Vyron— 18
Boles, Leo— 8
Bonaquist, Ramon— 9
Boyle, Scott— 23
Brandt, Brad— 10
Bridges, Michael— 9, 15
Broemmelsiek, John— 11, 21
Broussard, Norma— 10
Brown, Brandon— 20
Brown, Haylye— 14
Bryan Allery— 12
Bullock, Paul— 11
Burst, Jeffrey— 22

C

Cambas, Luanna— 13
Carlson, Kathryn— 8
Carwie, Chris— 13
Cavin, Glynn— 15
Chauhan, Akhilendra— 13
Chin, King— 11
Choate, Scott— 17
Clark, Jay— 11
Clement, Kirt— 15
Clifton, Linda— 15
Coco, Mary Leah— 15
Connella, Marcus— 19

Cooper III, Samuel— 19
Corrigan, Matt— 9
Cost, Tim— 15
Courtier, Kay— 11
Cummins, Dortha— 10

D

Dale, Alan— 19
D'Andrea, Artur— 14
Deaton, Scott— 9
DeBella, Steve— 21
DeFee, Buck— 23
Deinert, Sean— 11
Delaney, Elizabeth— 21
Denmon, Randy— 23
Desselle, Rhett— 10
Dompe, Phil— 9
Doucet, Brad— 23
Douet, Dax— 19
Dugas, Rob— 12
Dupre, Sherry— 12

E

Eggers, John— 17
Elliot, Darrell— 15
Elseifi, Mostafa— 22
Estopinal, Stephen— 13

F

Ferrier, Carryn— 21
Fillastre, Chris— 17
Finley, R. Craig— 20
Fruge, David— 24
Fu, Zhengzheng “Jenny”— 9

G

Gagnard, John— 12
Gaj, Stephen— 9
Gao, Lubin— 14
Gardner, Bridget— 10
Gautreau, Gavin— 17, 20
Gesing, Chris— 16
Gierhart, Danny— 17, 19
Glascock, Stephen— 16
Goodell, Dean— 8
Graham, John— 23
Graves, Hubert— 19
Graves, Remy— 17
Gregg, James—9
Grubb, Michael— 14
Gucunski, Nenad— 10

H

Hall, James— 19
Hanifa, Khalil— 20
Hanks, Anna— 14
Harrison, Jennifer— 15
Harvey, Kathy— 17
Hassan, Marwa— 10
Haynes, John— 20
He, Eddie— 20
Hecht, Richard— 9
Herbel, Susan— 8, 14, 16
Hickok, Neil— 12
Hicks, Mel— 11
Hill, Deidre— 21
Hodges, Beverly— 21
Hodges, Sean—11
Hoffeld, Scott— 22
Hoffelt, Scott— 21
Holm, Rick— 12
Horne, Ashley— 17
Hunter, Carol— 20
Hutchinson, Cory— 18
Hwaung, Golden— 14

I

Icenogle, Patrick— 13

J

Johnson, Kurt— 15
Jones, Marc— 21
Justice, Delicia— 19

K

Kabir, Md. Sharear— 17
Kalivoda, Eric— 10
Kelle, Peter— 18
Keller, Kevin— 16
Kemp, Kelly— 10
Kent, Joshua— 23
Khattak, Jamal— 22
Killingsworth, Brian— 13
Kononov, Jake— 12
Krone, Durk— 10, 20

L

Lacy, Barry— 11
Lambert, Bruce— 18
Lambert, Laurence— 13
Latino, Vince— 21
Lawson, Kevin— 10
Ledet, Patrick— 12

Lefort, Ryan— 19
Lester, Wade— 12
Levy, Alex— 21
Linton, Juanita— 17
Llorens, Jared— 18
Loeske, Jacob— 22
Londono, Richard— 17
Lopez-Jacobs, Von— 21
Lyon, John— 21

M

Macaluso, Phil— 8
Machtmes, Krisanna— 15
Mack, Darryl— 19
Magee, Kevin— 23
Maloney-Mujica, Lynn— 18
McCulloch, Howard— 19
McLellan, Rudy— 23
Mehrabi, Armin— 20
Meunier, Steve— 20
Mitchell, James E.— 15
Mix, Leslie— 21
Morgan, Karl— 24
Morvant, Mark— 15
Mueller, Steve— 11
Mumphrey, Ray— 17

N

Newcomb, Dave— 17, 19
Nickel, Charles— 9
Nickel, Tim— 21

O

Oriol, Kerry— 24
Orr, David— 23

P

Parsons, Brian— 14
Peterson, Bruce— 18
Proctor, Gordon— 9
Prucz, Zolan— 10, 23
Putcha, Sastry— 9

R

Randazzo, Cindy— 8
Rausche, Frank— 9
Reigh, Brian— 19
Renard, April— 8, 12
Richardson, Jim— 8
Riggs, Laura— 14
Rogers, Kent— 24
Rowe, Steve— 15
Rowland, Joe— 9
Rupnow, Tyson— 13
Rush, Brendan— 23

S

Saizan, Captain Carl— 10
Sanders, John— 23
Sanders, Wyatt— 9
Schmidt, Bob— 13
Schneider, Helmut— 16
Schoenfield, Diana— 21
Shahawy, Mohsen— 12, 20
Sibley, Steven— 14
Sivakumar, Bala— 9
Smith, Erik— 23
Smith, Jay— 17
Solis, Kenny— 12
Sowards, Missy— 21
Speck, Jeff— 15, 17
Squitieri, Amy— 24
St. Cyr, Mark— 12, 21
Stephanos, Peter— 15
Sticker, Brad— 23
Stinson, Donna— 19
Stringfellow, Mary— 14, 18
Sun, Xiaoduan— 12

T

Tang, Xiaochao— 20
Tavera, Ed— 17
Taylor, Doug— 23
Taylor, Jason— 12
Taylor, Theresa— 14
Tekell, Dean— 11
Till, Jeff— 23
Tolford, Tara— 16
Toups, Barry— 20
Tramonte, Betsey— 8
Tramel, Tony— 13
Tsai, Ching— 18

U

Umeozulu, Joe— 22

V

Vary, Donald— 18
Vaught, Paul— 20
Verret, Mark— 18
Verret, Nick— 12

W

Waaso, Skyler— 23
Waggoner, David— 23
Walsh, Marie— 10, 12
Wassef, Wagdy— 9
Wedge, Ed— 13, 22
Wells, John— 13, 15, 17
Werner, Robert— 11, 23

West, Randy— 9
White, Glenda— 19
Whittaker, Ron— 18
Wilcock, David— 16
Williams, Chris— 10
Williams, Stephen— 14
Wills, Ann— 14, 20
Wills, Joe— 12
Wollerson, Pat— 9
Wolshon, Brian— 16
Wood, Brandon— 19
Wu, Zhong— 22

2013 Louisiana Transportation Conference Documentation of Professional Development Hours

Print Name

Date and Time	Session Title	PDHs
Monday, 2/18/2013 8:45 a.m.–11:30 a.m. 2.0 PDHs available*	General Session	
	Session 1: Pavement Markers in Practice Innovation of the Emulsion Technology	
Monday, 2/18/2013 1:00 p.m.–2:45 p.m. 2.0 PDHs available*	Session 2: Freight Transportation	
	Session 3: Louisiana Strategic Highway Safety Plan Implementation	
	Session 4: Bridge Design	
	Session 5: Asset Management	
	Session 6: Engineer’s Professional Liability (Workshop)	
	Session 7: Warm Mix Asphalt	
	Session 8: Emerging Geotechnical Technologies	
	Session 9: Contract Services 1	
	Session 10: Sustainability of Pavement Materials	
Monday, 2/18/2013 3:15 p.m.–5:00 p.m. 2.0 PDHs available*	Session 11: Passenger Transportation	
	Session 12: Strategies to Reach Destination Zero Deaths	
	Session 13: Bridge Rehabilitation and Preservation	
	Session 14: Emergent Policy Updates	
	Session 15: Oil of OverLAY: Age Defying Secrets	
	Session 16: Workzone Safety	
	Session 17: The Observational Method in Geotechnical Practice	
	Session 18: Building the Digital Geodatabase of Louisiana—A Partnership Across All Levels of Government and the Private Sector	

Date and Time	Session Title	PDHs
Tuesday, 2/19/2013 8:00 a.m.–9:45 a.m. 2.0 PDHs available*	Session 19: Student Projects	
	Session 20: Getting You Home Safely—The DOTD Local Road Safety Program	
	Session 21: Highway Safety Analytical Tools	
	Session 22: Bridge Design and Construction	
	Session 23: Quality and Continuous Improvement Process (QCIP)	
	Session 24: Traffic Engineering	
	Session 25: Concrete Construction 1	
	Session 26: Minimum Standards for Land Surveyors (Workshop)	
	Session 27: New 2013 Specification Book—General, Incidental, and Materials	
	Session 28: Materials and Testing—Application of GPC, XRF, XRD	
Tuesday, 2/19/2013 10:15 a.m.–12:00 p.m. 2.0 PDHs available*	Session 29: DOTD Local Public Agency Programs—Partnering to Improve the Quality of Life for Louisiana’s Citizens	
	Session 30: Highway Safety Boot Camp Part 1 (Workshop)	
	Session 31: Bridge Maintenance and FHWA Metric	
	Session 32: Transportation Performance Management: Setting Target for Improvement and Achieving Success	
	Session 33: Future Transportation Workforce Initiative (Workshop)	
	Session 34: Concrete Construction 2	
	Session 35: Location-Based Decision Support – GIS for Managers and Administrators (Workshop)	
	Session 36: New 2013 Specification Book—Earthwork, Base Courses, and Asphaltic Pavements	

*2.0 PDH maximum assigned for each session based on anticipated contact time. If contact time is less than scheduled, PDHs are to be adjusted accordingly (50 minutes of contact time = 1 PDH).

Date and Time	Session Title	PDHs
Tuesday, 2/19/2013 1:00 p.m.–2:45 p.m. 2.0 PDHs available*	Session 37: University Transportation Center—Safety and Policy Research	
	Session 38: Railroad Engineering	
	Session 39: Highway Safety Boot Camp Part 2 (Workshop)	
	Session 40: Bridge Design and Geotechnical Solutions	
	Session 41: Louisiana Compliance Programs	
	Session 42: Missouri DOT's Practical Design Policy	
	Session 43: Asphalt Construction 1	
	Session 44: Management Systems & Traffic Monitoring	
	Session 45: New 2013 Specification Book - Concrete and Structures	
	Tuesday, 2/19/2013 3:15 p.m.–5:00 p.m. 2.0 PDHs available*	Session 46: University Transportation Center—Multimodal Research
Session 47: Planning		
Session 48: Increasing Crash Data Completeness, Accuracy, and Accessibility—Creating a Data Warehouse To Produce a Single Version of the Truth		
Session 49: Movable Bridges and Roadway Lighting		
Session 50: Right of Way Knowledge Improves Project Delivery		
Session 51: Multilane Roundabouts and Practical Experience		
Session 52: Asphalt Construction 2		
Session 53: Road Inventory & Mapping		
Session 54: Contract Services 2		

Date and Time	Session Title	PDHs
Wednesday, 2/20/2013 8:00 a.m.–9:45 a.m. 2.0 PDHs available*	Session 55: Implementation of Geotech Research	
	Session 56: Every Day Counts—Louisiana's Success and Current Efforts	
	Session 57: Tort Liability: Is Ignorance Bliss?	
	Session 58: Bridge Rehabilitation, Bridge Design and Bridge Rating	
	Session 59: The Business Side of DOTD	
	Session 60: Intelligent Transportation System—What are we doing?	
	Session 61: LaGov Implementation	
	Session 62: Agile Assets	
	Session 63: Project Management	
	Wednesday, 2/20/2013 10:00 a.m.–11:45 a.m. 2.0 PDHs available*	Session 64: Latest Developments in Pavement Characteristics
Session 65: Mega Projects		
Session 66: Effective Communication Strategies (Workshop)		
Session 67: Mississippi River Crossings at Vicksburg (I-20 and Railroad)		
Session 68: Public Works		
Session 69: Where the Rubber Meets the Road—DOTD District Issues		
Session 70: Technology Updates		
Session 71: Bridge Maintenance and Roadside		
Session 72: Environmental		
TOTAL PDHs EARNED		

Date and Time	Session Title	PDHs
Sunday, 2/17/2013, 4:30 p.m.–5:30 p.m. or Wednesday, 2/20/2013, 2:00 p.m.–3:00 p.m. 1.0 PDH available	Ethics	
TOTAL PDHs EARNED IN ETHICS		

*2.0 PDH maximum assigned for each session based on anticipated contact time. If contact time is less than scheduled, PDHs are to be adjusted accordingly (50 minutes of contact time = 1PDH).

Total PDHs earned through attendance at the 2013 Louisiana Transportation Conference _____

PDHs earned in professional ethics at the 2013 Louisiana Transportation Conference _____

I hereby attest that I have attended the sessions documented on this form and that the cumulative PDHs total above is accurate.

Signature of Attendee

CONFERENCE COMMITTEES

PLANNING COMMITTEE

Sam Cooper, Committee Chair
Mark Morvant, Committee Vice-Chair
Harold "Skip" Paul
Richard Savoie
Vincent Russo
Wes Bolinger
Leslie Mix
Ken Naquin
Ricky Moon
Phil Meyers
Dennis Decker
Dan Mobley
Committee Chairs

CONFERENCE MANAGEMENT

Sam Cooper, Conference Chairman
Mark Morvant, Conference Vice-Chairman
Glynn Cavin, Conference Management Chairman
Bridget LeBlanc
Angela Benn
MaryLeah Coco
Allison Landry
David Jumper
Jenny Speights
Melissa Lee
Theresa Rankin

REGISTRATION COMMITTEE

Cindy Twiner, Committee Chair
Jenny Speights
Cassandra Gray

INFORMATION TECHNOLOGY/AUDIO VISUAL

David Jumper, Committee Chair
Warren Huffty

COMMUNICATIONS/TRANSPORTATION COMMITTEE

Rusty Smith, Committee Co-Chair
Philip Macaluso, Committee Co-Chair
Joe Drago

PROGRAM COMMITTEE

Doc Zhang, Committee Chair
Noel Ardoin
Simone Ardoin
Jason Chapman
Richie Charoenpap
Kirt Clement
Jody Colvin
Elizabeth Delaney
Bill Drake
Jenny Fu
Stephen Glascock
Dean Goodell
Joshua Harrouch
Patrick Icenogle
Bill King
Eric Lanier
Lisa Leonard
Dan Magri
Kimberly McDaniel
Steve Meunier
David Miller
Jim Mitchell
Dan Mobley
Masood Rasoulian
Robin Romeo
Hector Santiago
Danny Smith
Mark St. Cyr
Steve Strength
Doug Taylor
Bill Temple
Nick Verret
Don Weathers
Ed Wedge
John Wells
Chad Winchester
Kirk Zeringue

HOSPITALITY/VENDOR DISPLAY COMMITTEE

John Starring, Committee Chair
Kaitlyn M. Boudreaux
Roger Melancon
Craig Melancon
Jenny Speights
Suzanne McCain

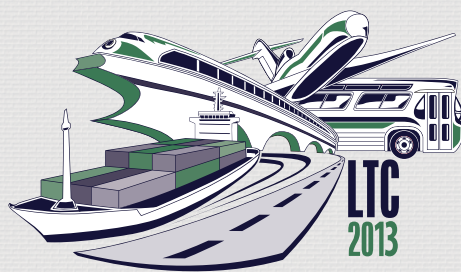

Partnerships for Progress
in Transportation

www.ltrc.lsu.edu/ltc_13