

# Transportation: Making Connections That Matter



**LOUISIANA TRANSPORTATION CONFERENCE**

February 28 - March 2, 2016  
River Center, Baton Rouge

## CONFERENCE HOSTS



## THANK YOU TO OUR CONFERENCE SPONSORS

### Platinum



### Gold



### Silver

**Neel-Schaffer, Inc.**  
**Lazenby & Associates, Inc.**  
**Arcadis**  
**Fugro**  
**T. Baker Smith, LLC**  
**Burk-Kleinpeter, Inc.**

### Bronze

**Cardno**  
**Calumet Specialty Products Partners, L.P.**  
**Gresham Smith & Partners**  
**Ohio Gratings, Inc.**  
**CB&I**  
**Hatch Mott MacDonald**



Special thanks goes to GEC, Inc.,  
for coordinating the  
hospitality/vendor exhibits.

Special thanks to the following companies for  
sponsoring the Sunday evening Opening Reception:

Ergon Asphalt and Emulsions  
Highway Graphics, LLC

Lion Oil Company  
Vulcan Materials Company

# TABLE OF CONTENTS

<b>River Center Maps.....</b>	<b>2</b>
<b>Conference Information .....</b>	<b>3</b>
<b>Tabletop Displays.....</b>	<b>4</b>
<b>Graduate Student Poster Presentations .....</b>	<b>5</b>
<b>Program At-a-Glance.....</b>	<b>6</b>
<b>Session Descriptions .....</b>	<b>8</b>
Monday (1:00 p.m.–2:45 p.m.) .....	8
Monday (3:15 p.m.–5:00 p.m.) .....	10
Tuesday (8:00 a.m.–9:45 a.m.).....	13
Tuesday (10:45 a.m.–12:30 p.m.).....	15
Tuesday (1:30 p.m.–3:15 p.m.).....	17
Tuesday (3:45 p.m.–5:30 p.m.).....	19
Wednesday (8:00 a.m.–9:45 a.m.).....	21
Wednesday (10:00 a.m.–11:45 a.m.) .....	24
<b>Speaker Index .....</b>	<b>29</b>
<b>PDH Documentation Form .....</b>	<b>31</b>

Special Note: Several presentations will address various parts of the 2016 (New) LA DOTD Standard Specifications for Roads and Bridges. Below are Parts of the new book being covered, and the corresponding Session. These will also be marked in the Session Descriptions (noted by the  symbol).

Part I: General Provisions	Session 58
Part II: Earthwork	Session 70
Part III: Base Courses	Session 70
Part IV: Surface Courses	Session 70
Part V: Asphaltic Pavements	Session 70
Part VI: Rigid Pavement	Session 70
Part VII: Incidental Construction	Session 70
Part VIII: Structures	Session 21
Part IX: Portland Cement Concrete	Session 70
Part X: Materials	Session 70

# RIVER CENTER MAPS

## Second Floor / Level 2

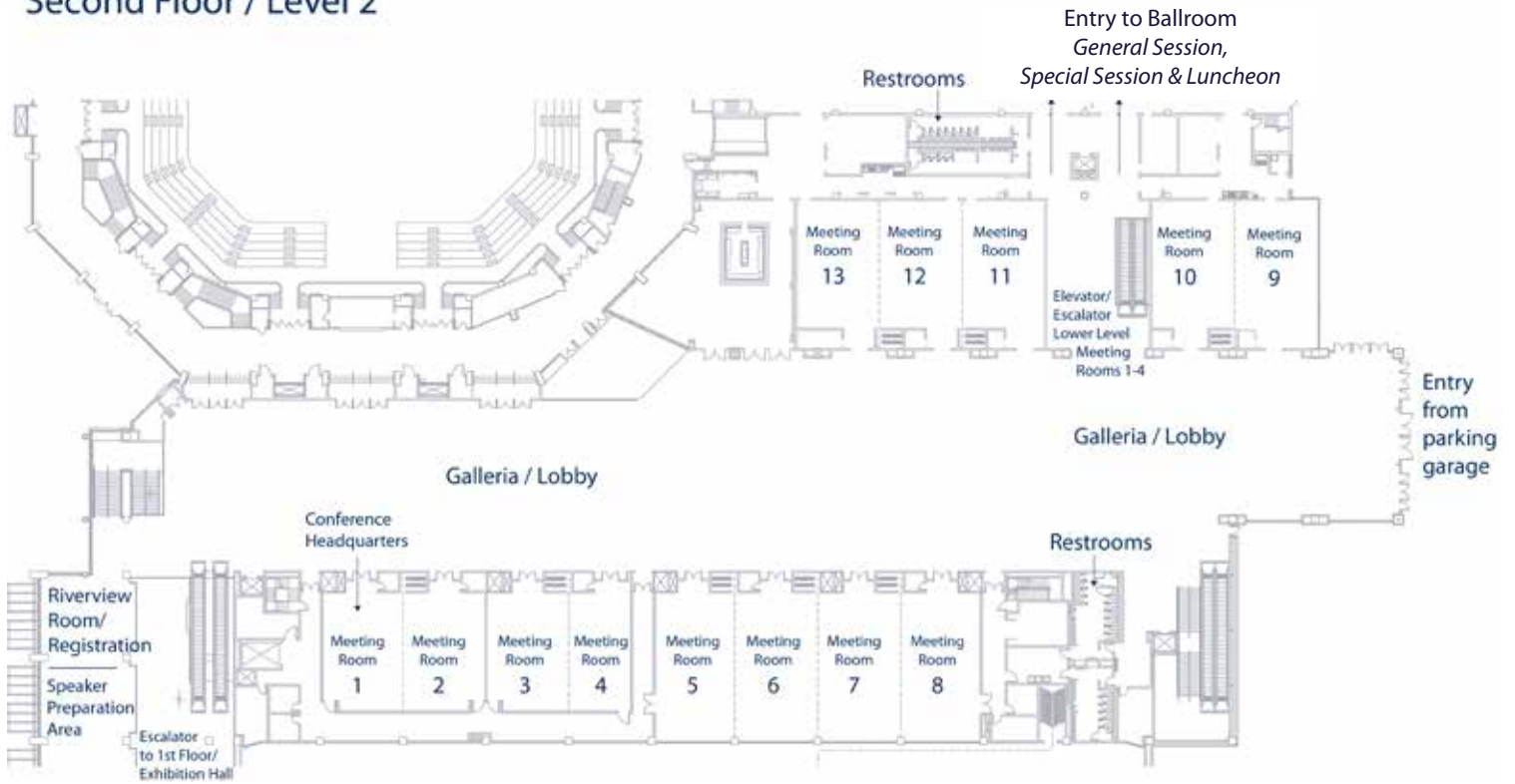

## First Floor / Lower Level Meeting Rooms 1-4

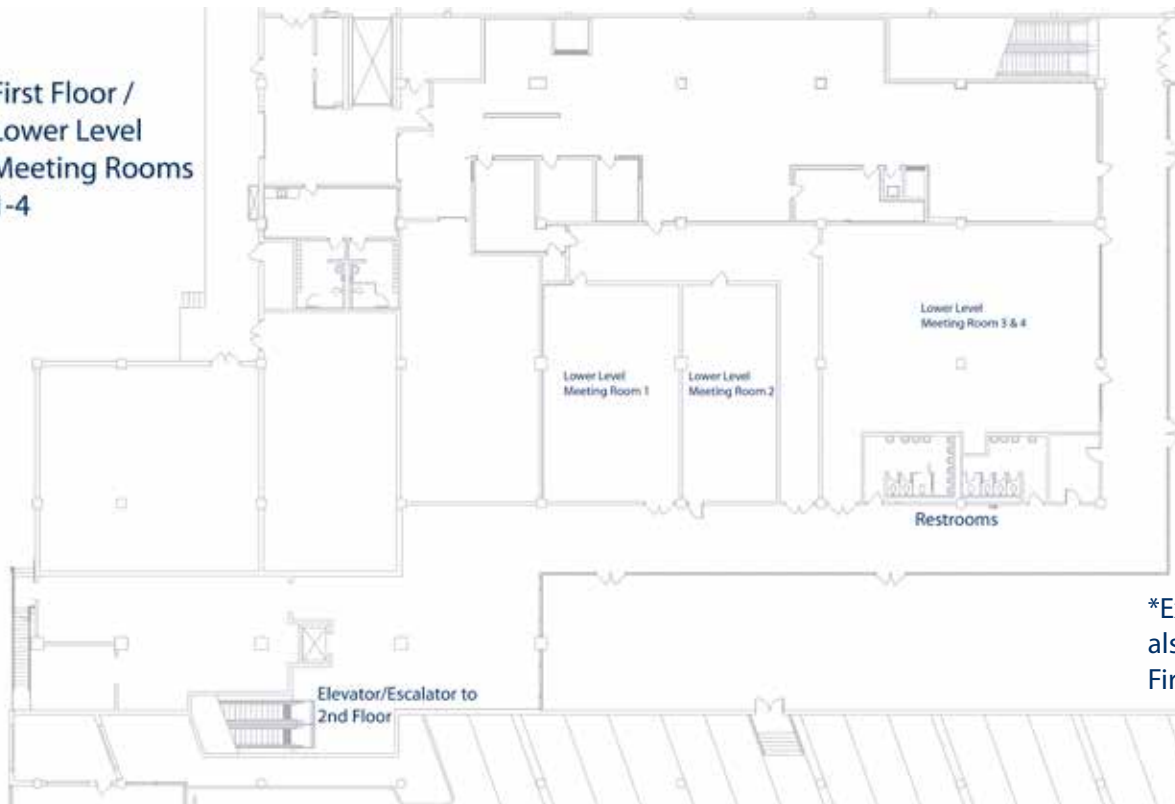

\*Exhibition Hall is also located on the First Floor/Lower Level

# CONFERENCE INFORMATION

## Conference Headquarters

The 2016 Louisiana Transportation Conference Headquarters is located in Meeting Room 1 on the second floor (Level 2). The Conference Headquarters will be open Monday and Tuesday, from 7:00 a.m. – 5:00 p.m., and Wednesday, 7:00 a.m. – 2:00 p.m. If you have special needs during the conference, visit the Conference Headquarters and every effort will be made to accommodate your request.

## Parking Procedures—PLEASE READ CAREFULLY

### General:

- Park in either the East or West garage.
- Garage entrances are on St. Louis Street, north of St. Louis/Government St. intersection.
- You may enter/exit garage as often as necessary by following the procedures below.

### Procedures for Driver:

- 1—Take ticket from machine each time you enter garage.
- 2—Report to Parking Validation (adjacent to Registration Booth in River Center Lobby) to turn in ticket and receive a garage exit pass anytime before departure from conference.

- A pass is only good for that day.
- Each time you exit the garage and return the same day, you must repeat the procedure.

### The Following Step Is Very Important:

- You must inform Parking Validation if this is your second (or subsequent) time to get a pass that day—no penalty, they just need to know for proper payment to East Baton Rouge Parish (EBR) authorities.

- 3—Same procedures are to be followed each day/each entry.
- 4—Different colored passes are provided each day.
- 5—If you fail to exchange parking ticket for pass, you will be responsible for paying the fee—no reimbursement after the fact.
- 6—Parking validation will end at 11:45 a.m. on Wednesday, March 2. If you do not exchange your ticket for a parking pass before the deadline, you will be responsible for paying the fee.

## Badge/Name Tag

Please remember to wear your 2016 Louisiana Transportation Conference badge/name tag at all times as this is your admission to all events.

## Professional Development Hours (PDHs) for Engineers and Land Surveyors

The program provides abstract information and a schedule of sessions, including the biennial engineer/land surveyor license requirement for ethics/boundary surveys. The ethics session will be offered twice (on Sunday at 4:30 p.m. and on Wednesday at 2:00 p.m. following the awards luncheon), presented by **Christopher Knotts**. Standards of Practice for Boundary Surveys in Louisiana will also be offered twice (on Sunday at 3:30 p.m. and on Wednesday at 2:00 p.m. after the awards luncheon), presented by **Stephen Estopinal**.

Pages 31-32 of this program provide a detachable register to help keep track of the sessions that are attended and number of PDHs that are accumulated. *Please note that PDHs are not given for the Personal Development Sessions.*

## Industry Exhibits

Exhibits on transportation technologies/products will be displayed during the following times in the River Center Exhibition Hall (ground level):

**Monday** 5:00 p.m. to 9:00 p.m., Industry Reception

**Tuesday** 7:00 a.m. to 5:30 p.m.

**Wednesday** 7:00 a.m. to 10:00 a.m.

## Speaker Preparation

A laptop will be available in the registration area for speakers to use in preparation for presentations.

## Wednesday's Conference Luncheon

Seating for the Conference Luncheon starts at 11:45 a.m. in the Ballroom of the River Center. Lunch will begin at 12 pm and will include awards presentations.

## Conference Evaluation & Presentations

A conference evaluation survey will be sent to you electronically after the conference. Please take a few minutes to respond to the survey so that we can gain your valuable input as we plan the next Louisiana Transportation Conference. After the conference, the presentations will be made available to all registered delegates, upon completion of the evaluation.

# TABLETOP DISPLAYS

Tuesday, March 1, 10:30 am - 4:00 pm, Exhibition Hall Lobby Area

## *Louisiana Local Technical Assistance Program*

As part of the Louisiana Transportation Research Center, the Louisiana Local Technical Assistance Program (LTAP) has provided training and technical assistance to Louisiana's local transportation and public works agencies since 1987. Thousands of local agency employees have participated in LTAP training opportunities focused on managing and improving the local road and bridge systems. LTAP has also partnered with DOTD and FHWA to implement a comprehensive Local Public Agency (LPA) Core Training Program and is working with the DOTD Bridge Sections to coordinate new performance metric requirements with local bridge owners.

## *FHWA Louisiana Division*

The FHWA Louisiana Division Office will have information on various programs and initiatives of FHWA including:

- FHWA's Stewardship and Oversight Agreement with LADOTD
- Federal-aid programs and requirements for Local Public Agencies (LPAs)
- Transportation Performance Management
- Every Day Counts (EDC) Initiatives
- SHRP-2 Initiatives

## *Louisiana Transportation Research Center*

This display will introduce the people and projects of LTRC. Participants are encouraged to view new research projects, meet the new faces of LTRC, and reconnect with familiar faces. Areas of LTRC research will be on display including pavement, accelerated pavement testing, geotechnical, asphalt materials, concrete materials, special studies, intelligent transportation systems, and the safety center.

## *Louisiana Center for Transportation Safety (LCTS)*

The LCTS invites you to visit our booth to discuss how to get local road safety improvement projects funded through the Local Road Safety Program. Eligible safety projects are aimed at reducing fatalities and injuries on locally owned and maintained roads, which support Louisiana's vision of reaching Destination Zero Deaths.

Also, speak with us on how we can assist you with highway safety workforce development, training, research and technical assistance. We work closely with LADOTD and key highway safety agencies to provide support in road safety initiatives across the state.

## *Ports/Marine & Rail Sections*

This display will provide visual information and handouts regarding projects and issues of concern to the port, waterway, and rail industries.

## *Aviation Section*

Learn more about grant programs available to airports as well as our aviation education and community outreach program. One portion of the tabletop will focus on the development and implementation of the nation's first successful non-primary entitlement fund transfer program to fund projects at Louisiana airports, initiated by the LADOTD Aviation section.

The Louisiana Aviation Art Contest will also be featured. It is designed to foster interest in aviation for the next generation of pilots. A historical video overview of the New Orleans Lakefront Airport will be provided to exhibit the beauty and architectural side of aviation in New Orleans. Finally, we will have our flight simulator on display for all attendees to experience the joy and passion of aviation.

Our focus is to improve our aviation infrastructure to insure a safe, modern and well managed system of airports which provides convenient and efficient access to the state for tourism, commerce, industrial interest, recreation, and economic development.

## *Public Transportation Section*

A laptop will be provided to show data collected and samples of documents published by the Public Transportation Section, brochures, pictures, and pamphlets featuring some of our Public Transportation Systems.

## *Toastmasters*

Do you want to increase your leadership and communication skills? If so, Toastmasters is the place for you. You'll find our supportive, learn-by-doing environment allows you to achieve your goals at your own pace. Come see what Toastmasters is all about.

## *Bridge Design*

LADOTD Bridge Design will provide information relative to featured and completed bridge projects. The section's current objectives, functions, and organizational layout will also be highlighted.



# TABLETOP DISPLAYS

Tuesday, March 1, 10:30 am - 4:00 pm, Exhibition Hall Lobby Area

## *Compliance Programs - DBE Certification Section*

The Disadvantaged Business Enterprise (DBE) program and the Small Business Element (SBE) program was created to remedy past and current discrimination against DBE/SBE firms. The intention is to level the playing field for socially and economically disadvantaged individuals and small businesses wanting to do business with the LADOTD on U.S. Department of Transportation federally assisted projects.

The Compliance Programs Section, Certification Unit, certifies businesses capable of performing services and/or products which can be credited towards DBE/SBE goals. The certification process ensures that only qualified small business firms that are independently owned and controlled by one or more socially and economically disadvantaged individuals are certified for this program. The first step in the certification process is to complete and submit a DBE/SBE application. Both of these applications, along with other information, will be available.

## *Louisiana Operation Lifesaver*

Louisiana Operation Lifesaver is a nonprofit, public education program established to end collisions, death, and injuries at highway-rail intersections and on railroad rights-of-way.

To meet its lifesaving goals, Operation Lifesaver promotes public awareness of the highway-rail grade crossing environment and encourages compliance with the traffic laws relating to crossing signs and signals, as well as the private property laws related to rail trespassing.

Operation Lifesaver is sponsored cooperatively by the LA Highway Safety Commission, LADOTD, Louisiana State Police, and Louisiana railroads.

# GRADUATE STUDENT POSTER PRESENTATIONS

Tuesday, March 1, 1:00 pm - 3:45 pm, Galleria/Lobby

## **Development of Alternative Composite Concrete Bridge Systems**

Dinesha Kuruppuarachchi and Fatmir Menkulasi,  
Louisiana Tech University

## **An Improved Structural Capacity Model for Flexible Pavement Based on Rolling Wheel Deflectometer (RWD) Deflection Measures**

Omar Elbagalati, Mostafa Elseifi, Kevin Gaspard,  
and Zhonjie Zhang, LSU and LTRC

## **Identifying High Crash Risk Roadways through Jerk Cluster Analysis**

Seyedeh Maryam Mousavi, LSU

## **Influence of Soil Properties on Pile Set-up Behavior**

Md. Naful Haque and Murad Y. Abu-Farsakh, LSU and LTRC

## **Glow in the Dark Concrete Surface Coatings – Luminescence and Abrasion Resistance**

Meredith Guidry and Aniko Nowakowski,  
St. Joseph's Academy (Baton Rouge)\*

*\*High school student participants*

## **Quantifying Resiliency of Marine Transportation System Using NAIS Data**

Elena N. Farhadi, LSU

## **Queue Estimation at Signalized Intersections Using Basic Safety Messages in Connected Vehicle Environments**

Osama A. Osman, Peter R. Bakhit, and Sherif S. Ishak, LSU

## **Driver Compliance and Safety Effects of the "Three-foot Laws"**

Nelida Herrera, Scott Parr, and Brian Wolshon, LSU

## **Finite Element Analysis of Pile Installation and Pile Setup in Louisiana Soils by Development of an Elastoplastic Model**

Firouz Rosti and Murad Abu-Farsakh, LSU and LTRC

# PROGRAM AT-A-GLANCE

Session titles in green pertain to the conference theme—*Making Connections that Matter*

Sessions pertaining to the 2016 (New) LADOTD Standard Specifications for Roads and Bridges are noted with the  symbol

## Sunday, February 28

### 2:00 p.m.–5:00 p.m.

Conference Registration, *River Center Riverview Room*

### 3:30 p.m.–5:30 p.m.

Standards of Practice for Boundary Surveys in Louisiana,  
*River Center Meeting Rooms 9, 10*

### 4:30 p.m.–5:30 p.m.

Ethics Session, *River Center Meeting Rooms 5, 6, 7, 8*

## Monday, February 29

### 7:00 a.m.–5:00 p.m.

Conference Registration, *River Center Riverview Room*

### 7:00 a.m.–8:30 a.m.

Continental Breakfast, *River Center Galleria*

### 7:30 a.m.–8:30 a.m.

Secretary's Breakfast, *Belle of Baton Rouge, Room Iberville C*  
**BY INVITATION ONLY**

### 8:45 a.m.–11:30 a.m.

General Session, *River Center Ballroom*

### 11:30 a.m.–1:00 p.m. | Lunch (on your own)

### 1:00 p.m.–2:45 p.m.

Concurrent Sessions, *River Center*

1: *FHWA Demonstration Incentive Grants (Room 2)*

2: *Records Management and Decision Support Services (Room 3-4)*

3: *Bridge Design and Plan Development (Room 5-6)*

4: *Emergency Operations (Room 7-8)*

5: *Big Data, Big Decisions: Strategic Planning to Save Lives (Room 9)*

6: *Bridge Inspection and Repair Methods (Room 10)*

7: *Concrete Pavements (Part 1) (Room 11)*

8: *Intelligent Transportation Systems Program (Room 12)*

9: *Innovative Design: Connecting Our Communities, Connecting Our Future (Room 13)*

*Personal Development: Properly Diagramming a Performance Problem (Lower Level Meeting Room 1)*

### 2:45 p.m.–3:15 p.m. | Break, River Center Galleria

### 3:15 p.m.–5:00 p.m.

Concurrent Sessions, *River Center*

10: *University Transportation Centers (Part 1) (Room 2)*

11: *Funding Louisiana's Roads and Bridges (Room 3-4)*

12: *Movable Bridges (Room 5-6)*

13: *Overview of Public Works Section (Room 7-8)*

14: *Quantifying Safety in the Project Development Process (Room 9)*

15: *Managing Our Shapes: 3D Modeling (Room 10)*

16: *Concrete Pavements (Part 2) (Room 11)*

17: *Autonomous Vehicles (Room 12)*

18: *Railroad Engineering 101 (Room 13)*

*Personal Development: Presentation Skills 101 (Lower Level Meeting Room 1)*

### 5:00 p.m.–9:00 p.m.

Industry Exhibits/Reception, *River Center Exhibition Hall*

## Tuesday, March 1

### 7:00 a.m.–5:00 p.m.

Conference Registration, *River Center Riverview Room*

### 7:00 a.m.–8:30 a.m.

Continental Breakfast, *River Center Exhibition Hall*

### 7:00 a.m.–5:30 p.m.

Industry Exhibits, *River Center Exhibition Hall*

### 8:00 a.m.–9:45 a.m.

Concurrent Sessions, *River Center*

19: *Student Presentations (Room 2)*

20: *Audit (Room 3-4)*

21: *New Specifications and Details (Room 5-6)* 

22: *Risk Management (Room 7-8)*

23: *Right Sizing - The Who, What, Where, & How (Room 9)*

24: *Geotech 1 - Down and Dirty (Complex Project Updates) (Room 10)*

25: *Asphalt Construction (Part 1) (Room 11)*

26: *Accessing and Mapping DOTD Data Using ArcGIS Online (Workshop) (Room 12)*

27: *Passenger Transportation (Room 13)*

*Personal Development: An Inside-Out Approach to Handling Conflict (Lower Level Meeting Room 1)*

### 9:45 a.m.–10:00 a.m. | Break, River Center Exhibition Hall

### 10:00 a.m.–10:30 a.m.

Special Session, *River Center Ballroom*

### 10:30 a.m.–10:45 a.m. | Break, River Center Exhibition Hall

### 10:30 a.m.–4:00 p.m.

Tabletop Displays, *Exhibition Hall Lobby Area*

### 10:45 a.m.–12:30 p.m.

Concurrent Sessions, *River Center*

28: *University Transportation Centers (Part 2) (Room 2)*

29: *Work Zone Safety (Room 3-4)*

30: *Bridge Design and Construction (Room 5-6)*



# PROGRAM AT-A-GLANCE

Session titles in green pertain to the conference theme—*Making Connections that Matter*  
Sessions pertaining to the 2016 (New) LADOTD Standard Specifications for Roads and Bridges are noted with the  symbol

31: *Alternative Delivery (Room 7-8)*

32: *Implementing Complete Streets (Room 9)*

33: *Geotech 2 - Down and Dirty (Design, Construction, and Helpful Tools) (Room 10)*

34: *Asphalt Construction (Part 2) (Room 11)*

35: *Use and Direction of GPS Technology at DOTD (Room 12)*

36: *Freight Transportation (Room 13)*

*Personal Development: They're Leaving! What Do We Do Now? (The Next Workplace Culture) (Lower Level Meeting Room 1)*

**12:30 p.m.–1:30 p.m.**

Lunch, River Center Exhibition Hall (lunch provided)

**1:00 p.m.–3:45 p.m.**

Graduate Student Poster Presentations, River Center Galleria/Lobby

**1:30 p.m.–3:15 p.m.**

Concurrent Sessions, River Center

37: *Materials Research (Room 2)*

38: *QCIP (Room 3-4)*

39: *Bridge Painting and More (Room 5-6)*

40: *New FHWA Transportation Performance Management Rules (Room 7-8)*

41: *A Legal Perspective (Panel Discussion) (Room 9)*

42: *Expediting the Right of Way Acquisition Process (Room 10)*

43: *Traffic Engineering (Room 11)*

44: *Location-based Decision Support: GIS for Managers and Administrators (Workshop) (Room 12)*

45: *Maintenance Operations (Room 13)*

*Personal Development: Properly Diagramming a Performance Problem (Lower Level Meeting Room 1)*

**3:15 p.m.–3:45 p.m. | Break, River Center Exhibition Hall**

**3:45 p.m.–5:30 p.m.**

Concurrent Sessions, River Center

46: *Pavement and Geotech Research (Room 2)*

47: *Anthology of Federal-Aid Programs: A Curated Selection of FHWA Requirements (Room 3-4)*

48: *Asset Management (Room 5-6)*

49: *Construction Roundtable (Room 7-8)*

50: *Bridge Maintenance (Room 9)*

51: *Property Management – The Ins and Outs of the Property Disposal Process (Room 10)*

52: *Environmental Compliance (Room 11)*

53: *Breaking the Code: Meaningful Interpretation of Crash Data (Room 12)*

54: *Laser Scanning the I-49 Connector (Room 13)*

*Personal Development: Presentation Skills 101 (Lower Level Meeting Room 1)*

## Wednesday, March 2

**7:00 a.m.–8:30 a.m.**

Continental Breakfast, River Center Exhibition Hall

**7:00 a.m.–10:00 a.m.**

Industry Exhibits, River Center Exhibition Hall

**8:00 a.m.–9:45 a.m.**

Concurrent Sessions, River Center

55: *Materials (Room 2)*

56: *New FHWA Risk-Based Stewardship and Oversight (S&O) Programs (Room 3-4)*

57: *Bridge Evaluation and Rehabilitation (Room 5-6)*

58: *Construction Laws (Room 7-8)* 

59: *Improving Safety Data Through Data Governance (Room 9)*

60: *Enterprise GIS (Room 10)*

61: *Legal Issues Impacting Districts (Room 11)*

62: *Planning For Louisiana's Future (Room 12)*

63: *Railroad Coordination – Coordinating Roadway Projects with the Railroads (Room 13)*

*Personal Development: An Inside-Out Approach to Handling Conflict (Lower Level Meeting Room 1)*

**9:45 a.m.–10:00 a.m. | Break, River Center Exhibition Hall**

**10:00 a.m.–11:45 a.m.**

Concurrent Sessions, River Center

64: *LTAP (Room 2)*

65: *Compliance (Room 3-4)*

66: *Bridge Rehabilitation (Room 5-6)*

67: *Consultant Contracts (Room 7-8)*

68: *Road Diets - A Proven Safety Countermeasure (Room 9)*

69: *Environmental (Room 10)*

70: *New Specification Implementation (Room 11)* 

71: *Advanced Data Collection Techniques for Transportation Applications (Room 12)*

72: *Precast Concrete Pavements (Room 13)*

*Personal Development: They're Leaving! What Do We Do Now? (The Next Workplace Culture) (Lower Level Meeting Room 1)*

**12:00 p.m.–2:00 p.m.**

Awards Luncheon, River Center Ballroom

**2:00 p.m.–3:00 p.m.**

Ethics Session, River Center Meeting Rooms 5, 6, 7, 8

**2:00 p.m.–4:00 p.m.**

Standards of Practice for Boundary Surveys in Louisiana, River Center Meeting Rooms 9, 10

# SESSION DESCRIPTIONS

The following pages contain concurrent session titles, a session description, titles of presentations, and names of presenters. A copy of the presentations will be available on the LTRC Web site after the conference. Sessions related to the conference theme, *Making Connections that Matter*, are highlighted throughout the program. Sessions pertaining to the 2015 (New) LA DOTD Standard Specifications for Roads and Bridges are also marked with a special symbol

**[MONDAY 1:00 p.m.–2:45 p.m.]**

## **Session 1: FHWA Demonstration Incentive Grants**

*Moderator: Jerry Pitts*

*Meeting Room 2*

LADOTD was awarded an FHWA Demonstration Incentive Grant (formerly Highways for Life, or HfL) to be used on the LA 511 widening project in Caddo Parish. FHWA grant monies were used to enhance implementation of innovative technologies that advance HfL goals with a special emphasis on highway safety and congestion reduction. This session will present the innovative features included in that project and discuss the before and after performance of those features (including user satisfaction). LADOTD was also awarded an HfL grant for a project in Vermillion Parish that utilized a geosynthetic reinforced soil abutment and that project will be covered in this session as well.

### **LA 511 State Perspective**

*Michael Rister, LADOTD*

### **LA 511 Research Perspective**

*Nazimuddin Wasiuddin, Louisiana Tech University*

### **Geosynthetic Reinforced Soil Abutment**

*Seth Woods, LADOTD*

## **Session 2: Record Management and Decision Support Services**

*Moderator: Don Johnson*

*Meeting Room 3-4*

The records management presentation will focus on an introduction to DOTD's Records Management program and its mission to build successful strategies that make records easier to organize, store, protect, and access throughout the Department. The decision support presentation will focus on the wide range of services available through DOTD's Decision Support group in its mission to provide better utilization of the LAGov system and tools available for meeting specific needs.

## **Records Management Improvement**

*Laurie Blandino, LADOTD*

## **Decision Support**

*Clyde Ashley, Michael Root, and Tiffany Breaux, LADOTD*

## **Session 3: Bridge Design and Plan Development**

*Moderator: Paul Fossier*

*Meeting Room 5-6*

This session consists of presentations that provide information about DOTD's new Bridge Design and Evaluation Manual, new bridge deck continuity details, and latest developments with the new live load model.

### **LA DOTD Bridge Design and Evaluation Manual (BDEM)**

*Zhengzheng "Jenny" Fu, LADOTD*

### **Field Monitoring of Link Slab Continuity Detail Under Different Bridge Configurations**

*Ayman Okeil, Louisiana State University*

### **LA Design and Rating Vehicle based on WIM (Weigh-in-Motion) Study**

*Bala Sivakumar, HNTB*

## **Session 4: Emergency Operations**

*Moderator: Richard Swan*

*Meeting Room 7-8*

Every state has a different approach on how to respond to disasters and emergencies, and there are significant differences in their emergency management capabilities. This session is for the states that assign an emergency response role to its state transportation agency. The presentations will address emergency preparedness and response topics that are common to all.

The burden of planning for and responding to natural disasters is shared by scores of agencies at all levels of government. The first response to an emergency falls to local government, which is most familiar with local conditions. Its responsibilities include planning and prior arrangements for evacuation, shelter and first response by police, fire and medical personnel. When local resources are overtaxed, the state steps in with logistical help, equipment, and manpower. The governor of an affected state must first execute the state's emergency response plan before requesting federal assistance under the Stafford Act. There are significant responsibilities for a state transportation agency if it has been included in the state's emergency response plan. Even relatively minor events can overwhelm an agency if it has not conducted adequate planning, coordination, and training in this regard.

## Emergency Operations SITREP

*Bill Icenogle, LADOTD*

## State Highway Agency Responsibility for FHWA Emergency Relief

*Yvonne Murphy, LADOTD*

## Disaster Cost Recovery: “Clean as you Go”

*Yvonne Murphy, LADOTD*

## Continuity of Operations: “If You Fail to Plan, Plan on Failing”

*Skip Breeden, LADOTD*

## Not Enough Resources, Equipment or Personnel for Disaster Response? Prioritize Your Routes!

*Richard Swan, LADOTD*

## Disaster Readiness is a LOT More Than Just Responding to an Event

*Richard Swan, LADOTD*

## Session 5: Big Data, Big Decisions: Strategic Planning to Save Lives

*Moderator: Dan Magri*

*Meeting Room 9*

Louisiana has set an aggressive vision for reducing death and injury on the roadways - Destination Zero Deaths. Great progress has been made since the development and implementation of the original 2006 Strategic Highway Safety Plan (SHSP) and its subsequent update in 2010. The SHSP identifies specific emphasis areas based on the safety data with a focus on fatal and serious/moderate injury crashes. By concentrating on the emphasis areas, we plan to make the biggest impact.

LADOTD and its safety partners are currently planning an update to the 2010 SHSP. This session will cover the process underway for updating the SHSP and what it could mean for planners and engineers across the state. Also, this session will include presentations on active SHSP initiatives from a statewide and regional level.

### SHSP Overview and Update

*Susan Herbel, Cambridge Systematics*

### SHSP + HSIP = 0

*April Renard, LADOTD*

### Districtwide Roadway Departure Safety Study

*Nicholas Fruge, LADOTD*

### DIY Parish Safety Plan

*Ashley Moran, Acadiana Planning Commission*

## Session 6: Bridge Inspection and Repair Methods

*Moderator: Rhett Desselle*

*Meeting Room 10*

Timber bridges are used extensively in secondary roads due to their relative ease of construction, lower cost and lack of need for major construction equipment. Detailed results of inspections conducted on a select group of bridges will be presented, along with lessons learned and the benefits of utilizing advanced assessment tools.

Recent and upcoming changes to how the Federal Highway Administration reviews states for compliance with the National Bridge Inspection Standards may impact how local owners view and handle their bridge structures. Sonar imaging technology and the use of unmanned aerial vehicles (UAVs) have evolved as effective means for capturing images in high-risk environments. Each supplemental inspection method can potentially be a cost-effective and efficient alternative to traditional inspection methods under hazardous environmental conditions.

### Timber Bridge Repair Details and Best Practices

*V.J. Gopu, LTRC*

### National Bridge Inspection Standards (NBIS)

*Steve Sibley, LADOTD*

### Supplementing Technology for Structural Inspections

*Charles Malveaux, Environmental Robotics Institute, and Chace Hulon, Moffatt & Nichol*

## Session 7: Concrete Pavements (Part 1)

*Moderator: Tyson Rupnow*

*Meeting Room 11*

Concrete pavements have demonstrated the ability to carry repeated heavy loads over long periods of time and in a variety of applications. This session highlights the application of Roller Compacted Concrete as a pavement for highway transportation. RCC has traditionally been used in industrial applications to carry very heavy loads such as at container and loading yards. Now an increasing number of state highway agencies are utilizing RCC as a highway base and/or surface in locations where other materials have not performed well. Research at the DOTD Pavement Research Facility has provided early indications that a relatively thin pavement can carry many applications of extremely heavy loads.

The application of thin concrete overlays has a long history in a number of locations across Louisiana. Several of these include routes in north Louisiana with heavy logging traffic; as a surface at a static weight scale, and more recently two city streets in downtown New Orleans. A national perspective on thin concrete overlays will also be presented in the session. Concrete Pavements (Part 2) will follow this session on Monday afternoon.

## **RCC Industry Overview**

*Chris Carwie, AG Peltz*

### **Concrete Overlays in New Orleans**

*James Kapisis, New Orleans DPW*

### **Thin Concrete Overlays**

*Mike Ayers, American Concrete Pavement Association*

## **Session 8: Intelligent Transportation Systems Program**

*Moderator: Stephen Glascock*

*Meeting Room 12*

DOTD's ITS program was started in 2006 with the forming of the ITS Section in the Office of Operations. Since that time, roadside technology has been deployed, real-time traffic and traveler information systems have been implemented, and Traffic Management Centers have been activated, all in an effort to improve the state's ability to manage traffic, incidents, and emergencies. Advancements in the areas of systems, communications, and traffic operations techniques have transformed certain ITS products into a core business function of DOTD. This session offers an overview of these functions within the ITS Section and how positive change has improved DOTD's ITS-delivery capabilities.

### **Trends in Traveler Information – Where is LADOTD**

*Carryn Sollie, LADOTD*

### **Building and Maintaining the ITS Network**

*Erik Smith, LADOTD*

### **Improving ITS Operations**

*Elizabeth Delaney, LADOTD*

## **Session 9: Innovative Design: Connecting Our Communities, Connecting our Future**

*Moderator: David Smith*

*Meeting Room 13*

An overview of Washington DOT's Alaskan Way Viaduct Replacement Program will be presented, focused on the tunnel portion and its unique risk management and project delivery processes.

The Florida Automated Vehicles (FAV) initiative is paving the way for implementation of autonomous technology on that state's roadways. Florida DOT has gained knowledge and understanding of how this technology will affect roadway design criteria, offering unprecedented opportunities for reducing congestion and improving safety.

### **Alaskan Way Viaduct Replacement Program**

*David Sowers, Washington State DOT*

### **Florida Automated Vehicles in Design**

*Brian Blanchard, Florida DOT*

## **Personal Development: Properly Diagramming a Performance Problem**

*Lower Level Meeting Room 1*

This session focuses on how to identify performance issues: related to motivation or related to ability. Most managers know what to do with each issue, yet the key is properly identifying which factor is causing a performance problem. (This is not about self-motivation; it's not a "feel-good" session.)

*Ted Ball, LTRC*

**[MONDAY 3:15 p.m.–5:00 p.m.]**

## **Session 10: University Transportation Centers (Part 1)**

*Moderator: V.J. Gopu*

*Meeting Room 2*

This session will present a sample of completed research associated with the DOTD/LTRC's partnership with the National Center for Intermodal Transportation for Economic Competitiveness (NCITEC). The NCITEC is a University Transportation Center (UTC) housed at Mississippi State University. UTCs are funded by the Research and Innovative Technology Administration of the USDOT and are internationally recognized centers of excellence, fully integrated within institutions of higher learning, that serve as a vital source of leaders who are prepared to meet the nation's need for safe, efficient and environmentally sound movement of people and goods. Additional work will be presented on Tuesday morning at the University Transportation Centers (Part 2) session.

### **Characterization of Expansive Soils in Northern Louisiana**

*Jay Wang, Louisiana Tech University*

### **Drugged Driving in Louisiana**

*Helmut Schneider, Louisiana State University*

### **Simulation Model for Intermodal Freight Transportation in Louisiana**

*Peter Kelle, Louisiana State University*

## Session 11: Funding Louisiana's Roads and Bridges

*Moderator: Don Johnson*

*Meeting Room 3-4*

---

The first presentation will focus on the need for additional transportation funding through the Federal Highway Trust Fund. The presentation will also review some recently-approved state initiatives from around the country to deal with infrastructure needs in the absence of a long-term transportation bill.

The second presentation will focus more specifically on Louisiana's primary revenue stream, the Transportation Trust Fund (TTF), and will provide an overview of recent legislation that could have an impact on transportation funding within the state.

### **Federal Highway Trust Fund**

*Jennifer Brickett, AASHTO Project Finance Institute*

### **LA Transportation Trust Fund**

*Susan Stockstill, LADOTD*

## Session 12: Movable Bridges

*Moderator: Stewart Hingle*

*Meeting Room 5-6*

---

This session will consist of presentations about a unique movable bridge design, intricate bearing replacement, and an innovative portable measuring device.

### **Unique Swing Span Design for the St. Ann Bridge in Houma, LA**

*Lee Hupperich, Huval & Associates*

### **Replacement of the Counterweight Trunnions on the Lea Joyner Bridge**

*Michael Sileno, Hardesty and Hanover*

### **4th Street Bridge - Precision Survey of Rolling Lift Machinery**

*Lee Lentz and Geoffrey Forest, Modjeski and Masters*

## Session 13: Overview of Public Works Section

*Moderator: Chris Knotts*

*Meeting Room 7-8*

---

This session contains presentations that will cover the criteria, procedures and activities of three DOTD Public Works programs.

### **Levee Safety Program**

*Doug Taylor and Curt Boniol, LADOTD*

### **Dam Safety Program**

*Ed Knight, LADOTD*

### **Statewide Flood Control Program**

*Billy Williamson, LADOTD*

## Session 14: Quantifying Safety in the Project Development Process

*Moderator: April Renard*

*Meeting Room 9*

---

The Highway Safety Manual (HSM) was published in 2010 and it has changed the way planners and engineers consider safety in the project development process. This session will highlight specific projects where transportation professionals will share their experiences using the HSM in various phases of the project development process.

### **Integrating Safety into the Project Development Process**

*Beth Wemple, Cambridge Systematics*

### **Applying the Highway Safety Manual at the Corridor Level**

*Akhilendra Chauhan and Thomas Montz, Arcadis*

### **US 167 / Johnston Street Reconfigurations**

*Nick Ferlito, Neel-Schaffer & Plan Acadiana and Melanie Bordelon, Acadiana Planning Commission*

### **HSM & Design Exceptions**

*Codi Neyland and Phillip Sturdivant, LADOTD*

## Session 15: Managing our Shapes: 3D Modeling

*Moderator: Ryan Richard*

*Meeting Room 10*

---

DOTD currently utilizes the traditional two-dimensional or "2D" design process. As part of the bidding process, these 2D "paper" plans are provided electronically to the contracting community via the electronic bidding process. On a case-by-case basis, DOTD has occasionally given contractors various electronic design files for use at their own risk. A recent survey of the local contracting community has indicated an interest in the latest 3D technology for use in GPS machine control. In order to utilize the latest machine control guidance, contractors are currently creating their own 3D models by reverse engineering 2D plans, an effective but inefficient process. To date, DOTD has not formalized a process or changed any policies and procedures for providing and using the models, so this is a timely topic.

Lead states in this technology will discuss their 3D Workflow process and policy, highlighting where they started, any pitfalls along the way, required changes to their delivery and bidding process, the types of files they release at bidding, how the contractor uses these, how the DOT inspectors use them, etc. Finally, one of our LA contractors will describe their process and what they would like to see as part of the DOTD's plan delivery/bidding process.



## **MoDOT's 3D Design and Implementation**

*Ashley Buechter, Missouri DOT*

## **3D Design and Automated Machine Guidance in Iowa**

*Brian Smith, Iowa DOT*

## **Louisiana Contractor Perspective**

*J.J. Hickey, Gilchrist Construction*

## **Session 16: Concrete Pavements (Part 2)**

*Moderator: John Eggers*

*Meeting Room 11*

This session is a continuation of Concrete Pavements (Part 1), presented earlier on Monday afternoon. Concrete is a dynamic product which is continually being improved as new technologies are developed. The session will present advanced internal curing techniques which are designed to reduce shrinkage cracking in bridge decks and in addition will cover proper jointing of concrete to enhance performance. New precast concrete solutions are being implemented across the country for addressing the economics of replacing small structures which have reached end of life. Precast concrete has been demonstrated to be faster and less expensive solution and as such it fits nicely with the philosophy of the "Every Day Counts" program.

### **Internal Curing of Concrete**

*Jeff Speck, Trinity Lightweight*

### **Jointing in PCC Construction**

*Brian Killingsworth, National Ready Mixed Concrete Association*

### **Precast Concrete Solutions**

*Walter Catlett, American Concrete Pavement Association*

## **Session 17: Autonomous Vehicles**

*Moderator: Stephen Glascock*

*Meeting Room 12*

Autonomous vehicle technologies are rapidly advancing. Many vehicles today have automated features such as lane departure warning, collision avoidance, adaptive cruise control, etc. Well-known examples of autonomous vehicles are light-rail systems at airports, theme parks, and drone aircraft. Several private companies and academia have been testing fully autonomous (i.e., driverless) highway vehicles for several years. Google cars are perhaps the most widely publicized. Potential benefits of autonomous vehicles are quite dramatic, with anticipated improvements in safety, traffic flow, and the economy.

The role of state and local transportation agencies regarding autonomous vehicles is not clear. To this end, DOTD has organized an Autonomous Vehicle Technology Team (AVTT) comprised of 30 individuals from various disciplines within the Department. The AVTT will focus its efforts on developing a knowledge base of autonomous vehicles, establishing the Department's role and advising other stakeholders of their roles in the technology, formulating policy, and identifying promising applications for use within DOTD. This session includes a summary of efforts of the AVTT thus far and future planned activities.

### **Highway Technology & Infrastructure**

*Erik Smith, LADOTD*

### **Multimodal Technology & Infrastructure**

*Scott Choate, LADOTD*

### **Legal & Policy Framework**

*Brandon Brown, LADOTD*

### **Departmental Applications**

*Vince Latino, LADOTD*

## **Session 18: Railroad Engineering 101**

*Moderator: Dean Goodell*

*Meeting Room 13*

One of the major challenges facing passenger rail today is the upgrade and rebuilding of passenger stations. Design considerations for passenger boarding must comply with the Americans with Disabilities Act (ADA). Level boarding is accomplished by constructing full-length high-level platforms at stations. Where passenger and freight service operate together, high-level platforms create physical conflicts for freight operations. Platforms with lift edges are the most cost-effective and efficient solution to clearance issues with high-level platforms in the shared-corridor environment. A railroad operations design presentation will explain the fundamentals of how railroads integrate economics, marketing, infrastructure, rolling stock, and regulatory compliance to deliver efficient freight and passenger transportation. The presentation will cover how railroads use their track and signal infrastructure, how railroads plan for new infrastructure, and railroad concerns related to capacity, cost, and reliability of infrastructure plans.

A passenger rail initiatives presentation will provide results of recent studies for the introduction of passenger rail service between Baton Rouge and New Orleans and between Shreveport and Vicksburg.

### **Powered Lift Edge for Rail Platforms**

*Edward LaGuardia, Michael Baker International*

### **Railroad Operations Design**

*Mark Hemphill, HDR, Inc.*

### **Passenger Rail Initiatives in Louisiana**

*John Basilica, HNTB*



## Personal Development: Presentation Skills 101

Lower Level Meeting Room 1

This session hits the key areas of presentations given by non-presenters: engaging the audience, best practices in using visuals, and some presenters blunders to avoid.

*Ted Ball, LA DOTD*

**[TUESDAY 8:00 a.m.–9:45 a.m.]**

## Session 19: Student Projects

*Moderator: V. J. Gopu*

*Meeting Room 2*

Teams of civil engineering students from Louisiana universities will present their senior design projects. These projects receive support from DOTD through its Support Program for Civil Engineering Studies.

## Session 20: Audit

*Moderator: Mark St. Cyr*

*Meeting Room 3-4*

DOTD's Audit Section will pair with the Local Public Agency Director to deliver presentations that provide key insight into audit requirements for the various types of Consultant Engineering Contracts. Additionally, key guidance will be provided for Local Public Agencies on requirements for handling Federal pass-through funds. This session will take you inside the mind of the audit staff and allow you to understand what to expect as an auditee or as a subrecipient.

### Auditing Consultant Engineering Contracts

*Randy Jarreau, LADOTD*

### Auditing Local Public Agencies to Ensure Compliance with OMB Super-Circular

*Ann Wills and Art Landry, LADOTD*

## Session 21: New Specifications and Details

*Moderator: Zhengzheng "Jenny" Fu*

*Meeting Room 5-6*

**2016  
SPECS**

This session will present an overview of changes to the structures section of the new Standard Specifications for Roads & Bridges, an overview of new details and criteria for crash testing guard rail and bridge railing, and an overview of new approach slab design and special details.

## New Structures Specifications - Part VIII of the New LA DOTD Standard Specifications

*Ray Mumphrey, LADOTD*

## New MASH Criteria, Crash Testing, and Guard Rail and Bridge Rail Design and Details

*Paul Fossier, LADOTD*

## New Approach Slab Design and Special Details

*Adam Lancaster, LADOTD*

## Session 22: Risk Management

*Moderator: Charles Nickel*

*Meeting Room 7-8*

Risk impacts every aspect of project development. Just as a Cost Estimate is more than just a number and Value Engineering is more than just saving money, Risk Management is more than just identifying threats. Risk Management is also about identifying and actively taking advantage of opportunities, benefiting other areas of project development. There are definite benefits to using various risk management tools and strategies for communicating costs and maximizing value of a project.

### Risk Management and Cost Estimating

*Charles Nickel, LADOTD*

### The Basics of Risk Management

*Greg Sepeda, Sigma Consulting Group, Inc.*

### FHWA Cost Risk Methodology

*Michael Smith, FHWA*

## Session 23: Right Sizing - The Who, What, Where, & How

*Moderator: Dawn Sholmire*

*Meeting Room 9*

Louisiana presently owns over 27 percent of its public road mileage. The national average is approximately 19 percent. An opportunity exists to significantly reduce the size of Louisiana's state highway system, rectify inequities in the distribution of state highway miles among parishes, and empower local governments through the right-sizing of the state highway system.

The Road Transfer Program is a means to compensate parishes and municipalities for accepting ownership of certain roads currently owned by the State. Participation is voluntary. The program entails initial repairs to the road being transferred (if needed), and credit for the present worth of estimated maintenance costs over 40 years. The funding can be applied to the highway capital project(s) of choice by the receiving local government.

This session will cover the philosophy of the program and how it works. There will be an open forum discussion with experts from Planning, Legal, and Real Estate to answer questions.

### **The Who, What and Where of Right-sizing**

*Eric Kalivoda, LADOTD*

### **The How of Right-sizing**

*Robert Reed, LADOTD*

### **Roundtable Discussion on Right-sizing**

*Hubert Graves, Geoffrey Rodriguez, Darhlene Major, Eric Kalivoda, and Robert Reed, LADOTD*

## **Session 24: Geotech 1 - Down and Dirty (Complex Project Updates)**

*Moderator: Jeff Lambert*

*Meeting Room 10*

This session will highlight some of the complex geotechnical aspects encountered on three DOTD projects that are ongoing or recently completed. Topics to be addressed are slope stability, scour issues in the Mississippi River, MSE Walls, settlement, piles, load transfer platforms, etc.

### **I-20 Mississippi River Bridge Movement**

*Robert Werner, Ardaman & Associates*

### **Cove Lane Project**

*Larry Sant, GeoEngineers*

### **I-49 South Design Build Project at Alberston's Parkway**

*Stephen Greaber, Terracon Consultants*

## **Session 25: Asphalt Construction (Part 1)**

*Moderator: Bill King*

*Meeting Room 11*

This session includes: an update on structural coefficient research and associated implementation, new pavement thickness design software from industry, and the need for a balanced mix design approach. Asphalt Construction (Part 2) will follow this session on Tuesday morning.

### **Structural Coefficient Research at NCAT and ALDOT Implementation**

*David Timm, Auburn University*

### **Pavement Thickness Design with Pave Express**

*Danny Gierhart, Asphalt Institute*

### **The Need for Balanced Mix Design Approach**

*Dave Newcomb, TTI-Texas A&M*

## **Session 26: Accessing and Mapping DOTD Data Using ArcGIS Online (Workshop)**

*Moderator: Jim Mitchell*

*Meeting Room 12*

This workshop introduces ArcGIS Online (AGO), a simple to use, web-based system that runs in your web browser, and provides access to DOTD and external GIS resources. It is ideal for making quick maps with background imagery or map services. In AGO, users maintain their own content or can search for content within DOTD or across the Internet. Web maps can be shared with specific users, groups, or across the Internet. AGO also provides basic GIS processing.

*Jennifer Harrison, Inner Corridor Technologies, and Jim Mitchell, LADOTD*

## **Session 27: Passenger Transportation**

*Moderator: Phil Jones*

*Meeting Room 13*

The Airport System Plan was recently completed. This presentation will discuss future development and expansion of the state's general aviation and commercial airports.

Public transportation in Louisiana is provided through an amalgamation of funding streams, providers, users, jurisdictions, equipment, fuel and maintenance operations. The future of public transportation in the Acadiana region, both urban and rural, is being studied for comprehensive analysis and evaluation of alternatives for local consideration. There is a major emphasis on public/private cooperation, support, and consolidation to sustain and expand future transit services in the region.

The New Orleans streetcars presentation will cover the history of the streetcar system and restoration activity since 1983 when the Regional Transit Authority (RTA) was established. The presentation will mainly focus on the most recent streetcar expansion projects: the Loyola and Rampart lines. The presenter will describe the challenges faced during construction of the Loyola line and how this experience influenced the final design and execution of the Rampart line (currently under construction). The presentation will also contain information about the RTA's streetcar expansion program and future projects.

### **Airport System Plan**

*Brad Brandt, LADOTD*

### **Transit Plan for the Acadiana Region**

*Mike Hollier, Lafayette MPO*

### **New Orleans Streetcars: History & Recent/Future Expansions**

*Martin Pospisil, New Orleans Regional Transit Authority*

## Personal Development: An Inside Out Approach to Handling Conflict

*Lower Level Meeting Room 1*

This session looks at the root causes of interpersonal conflict with an eye toward the behaviors that effectively manage conflict *and* ineffectively manage conflict. We will look at behaviors under our control and behaviors that are never under our control.

*Ted Ball, LTRC*

**[TUESDAY 10:00 a.m.–10:30 a.m.]**

### Special Session with United States

#### Secretary of Transportation Anthony Foxx

*River Center Ballroom*

**[TUESDAY 10:45 a.m.–12:30 p.m.]**

### Session 28: University Transportation Centers (Part 2)

*Moderator: V.J. Gopu*

*Meeting Room 2*

This session is a continuation of University Transportation Centers (Part 1), as presented on Monday afternoon. The session will present a sample of completed research associated with DOTD/LTRC's partnership with the National Center for Intermodal Transportation for Economic Competitiveness (NCITEC). The NCITEC is a University Transportation Center (UTC) housed at Mississippi State University. UTCs are funded by the Research and Innovative Technology Administration of the USDOT and are internationally recognized centers of excellence, fully integrated within institutions of higher learning, that serve as a vital source of leaders who are prepared to meet the nation's need for safe, efficient and environmentally sound movement of people and goods.

#### Traffic Counting Using Existing Video Detection Cameras

*Sherif Ishak, Louisiana State University, and Julius Codjoe, LTRC*

#### Travel Time Estimation Using Bluetooth

*Ravindra Gudishala, LTRC, and Chester Wilmot, Louisiana State University*

#### Development of an Optimal Ramp Metering Control Strategy for I-12

*Sherif Ishak and Osama Osman, Louisiana State University*

### Session 29: Work Zone Safety

*Moderator: Barry Lacy*

*Meeting Room 3-4*

One presentation will discuss the legal aspects of temporary traffic control (TTC) on highway work zones. Upon completion, participants will understand tort liability in highway work zones, the civil lawsuit process, how to minimize exposure to tort liability and how to survive depositions. A case study will be used as an example.

A separate presentation will focus on the need for state, local, and contractor personnel to observe, adjust, and enhance traffic control zones long after the temporary traffic control plan, traffic management plans, and traffic control systems have been designated and approved, and why having a good set of plans is simply not good enough. Drawing on the seven fundamentals of MUTCD Part 6B, this presentation will cover the inside scoop on deliberations of the Work Zone Safety Task Force and highlight a number of concerns from regular work zone field reviews.

A final presentation will focus on work zone changes that have been made in the past couple of years, including observations about why the public continues to disrespect the orange.

### Legal Aspects of Temporary Traffic Control in Highway Work Zones

*Juan Morales, J.M. Morales & Associates, P.C.*

### Actively Managing your Work Zones: The 6B Solution

*Steve Strength, Louisiana Local Technical Assistance Program*

### Work Zone Changes Since We Last Met

*Barry Lacy, LADOTD*

### Session 30: Bridge Design and Construction

*Moderator: Artur D'Andrea*

*Meeting Room 5-6*

This session consists of presentations of information regarding a south Louisiana "mega" project, an interstate overpass substructure replacement, and a new river crossing.

#### LA 1 Phase 2

*James Gregg, HNTB*

#### I-10 WB Over Julia Street - Straddle Bent Cap Replacement and Girder Connection Rehabilitation

*Victor Sanchez, LADOTD*

#### Ouachita River Bridge at Harrisonburg

*Kelly Kemp, LADOTD*

### Session 31: Alternative Delivery

*Moderator: Bob Boagni*

*Meeting Room 7-8*

Louisiana's success with the Design-Build project delivery method was recognized by the Design-Build Institute of America (DBIA) when presenting its 2011 Design-Build Owner of the Year award and its 2012 Design Excellence award to DOTD for the John James Audubon (JJA) project. DOTD is beginning to use the Construction Manager at Risk (CMAR) project delivery method, and is finalizing an economic feasibility study for the state's first Public-Private Partnership (P3).

Enabling legislation for the Construction Manager at Risk (CMAR) project delivery method was passed in 2014. The approach used to develop DOTD guidelines for use of the CMAR method, as well as a status update for DOTD's CMAR program, will be presented.

The US 90/LA 318 Interchange is the first Design Build project for DOTD to include right of way acquisition in its scope. The project also included an approved Alternative Technical Concept requiring a Supplemental Environmental Assessment. An overview of DOTD's experience will be presented.

### **The State of DOTD's Alternative Delivery Program**

*Jeffrey Burst, LADOTD*

### **Construction Management at Risk (CMAR): Another Tool in the DOTD Alternative Delivery Toolbox**

*John Basilica, HNTB*

### **US 90/LA 318 Interchange Design-Build**

*Tim Nickel, LADOTD*

## **Session 32: Implementing Complete Streets**

*Moderator: Ann Wills*

*Meeting Room 9*

By 2045, 70 million more Americans are expected to utilize our nation's transportation network. The majority of that growth is anticipated for the southern states. Complete Streets is not a new concept, but perhaps a buzz word for encouraging multimodality. Multimodality is quickly becoming an increasingly important strategy for managing impacts the expected population growth will have on Louisiana's transportation network. This session will include presentations on how to educate the public on complete street concepts, proactively plan for projects, and implement complete street strategies within existing construction projects.

### **Developing a Pedestrian & Bicycle Master Plan at the Local Level**

*Yuwen Hou, Rapides Area Planning Commission*

### **Pedestrian & Bicycle Public Outreach Program**

*Emilie Bahr and Dan Jatres, New Orleans Regional Planning Commission*

### **Case Studies of Complete Street Projects**

*Louis Haywood, New Orleans DPW*

## **Session 33: Geotech 2 - Down and Dirty (Design, Construction, and Helpful Tools)**

*Moderator: Jeff Lambert*

*Meeting Room 10*

This session includes two presentations that will highlight methods utilized by DOTD engineers to design and verify deep foundation installations throughout the state. A separate presentation will provide insight into a new FHWA website that can be used to get ideas and options on how to design or repair geotechnical issues.

### **LADOTD Drilled Shaft Design and Construction Practice**

*Matt Melton and Chris Nickel, LADOTD*

### **LA DOTD Drilled Shaft Design and Construction Verification using LRFD**

*Jesse Rauser, LADOTD*

### **Geotech Tools**

*Silas Nichols, National Geotechnical Program, FHWA Office of Infrastructure*

## **Session 34: Asphalt Construction (Part 2)**

*Moderator: Bill King*

*Meeting Room 11*

This session is a continuation of Asphalt Construction (Part 1), presented earlier on Tuesday morning. This session includes: new specifications in Louisiana, new research from NCAT, and a new approach to QC/QA.

### **Thin Lift Asphalt Overlays**

*Danny Gierhart, Asphalt Institute*

### **Perpetual Pavement Research at the NCAT Test Track**

*David Timm, Auburn University*

### **Independent Assurance / Accreditation / and Proficiency Sample Programs**

*Jason Davis, LADOTD*

## **Session 35: Use and Direction of GPS Technology at DOTD (Workshop)**

*Moderator: Kurt Johnson*

*Meeting Room 12*

Global Positioning Systems (GPS) have become an integral tool for collecting, documenting, and managing modern-day transportation assets. Today's GPS technology offers an efficient and cost-effective means to collect accurate and reliable location information that are easily incorporated into enterprise data systems. There, GIS technology can display the information, analyze it, and combine it with other enterprise data. As the cost of GPS technology continues to drop, its ROI increases, with easier use and higher accuracy. This session will provide updates on the state of GPS technology and current efforts to standardize the data collection process.

### **Current Status and Use of GPS Technology at LADOTD**

*Kurt Johnson, LADOTD*

### **Overview of Trimble Products and Software**

*Thell Gillis, NEI*

### **Accuracy Standards**

*Robert Dingess, Geospatial Transportation Mapping Assoc. (GTMA)*

## **Session 36: Freight Transportation**

*Moderator: Phil Jones*

*Meeting Room 13*

The New Orleans Port Director will speak about the ongoing Expansion of the Napoleon Ave. Container Terminal which includes new Gantry cranes, yard improvements, expansion of the container lay-down area, and relocation of the intermodal rail yard, also discussing funding sources for the project.

The LA-23 rail relocation presentation will show the alternative routes and the features being studied for the relocation of the New Orleans Gulf Coast Railroad track from its current location along LA-23 through downtown Gretna to a location around the city.

The Houma Navigation Canal Deepening Study presentation will address the project history, purpose, scope, constraints, activities (past, present, future), and schedule. A review of Louisiana's Freight System Plan will be presented.

### **Napoleon Street Wharf Project**

*Gary LaGrange, Port of New Orleans*

### **LA-23 Rail Relocation Project**

*Kevin Keller, HDR, Inc.*

### **Houma Navigation Canal Project**

*Cade Carter, GEC*

### **Louisiana's Freight Plan**

*Donald Vary, CDM Smith*

## **Personal Development: They're Leaving! What Do We Do Now? (The Next Workplace Culture)**

*Lower Level Meeting Room 1*

The baby-boomer workforce is retiring. Here's a look at the effects of losing specialized knowledge, workplace contributions, and expertise as they walk out of the door.

*Ted Ball, LTRC*

## **[TUESDAY 1:30 p.m.–3:15 p.m.]**

### **Graduate Student Poster Presentations**

*Galleria/Lobby (1:00 p.m.–3:45 p.m.)*

Please see page 5 for a listing of the poster presentations.

### **Session 37: Materials Research**

*Moderator: Tyson Rupnow*

*Meeting Room 2*

This session will focus on selected LTRC materials research results. From the asphalt materials research group, the results for development of a simplified performance-based specification for asphalt pavements will be discussed. Laboratory results from the concrete materials research group's internal curing project will be discussed with details from two separate field projects. Lastly, research regarding the potential for using DSR-based tests as replacements for elastic recovery and force ductility will be presented.

### **Development of a Simplified Performance-Based Specification for Asphalt Pavements**

*Louay Mohammad, LTRC*

### **Internal Curing: Research Results and Two LADOTD Case Studies**

*Zachary Collier, LTRC*

### **Replacement of Elastic Recovery (AASHTO T301) and Force Ductility (AASHTO 300) Tests by DSR-Based Tests**

*Nazimuddin Wasiuddin, Louisiana Tech University*

### **Session 38: QCIP**

*Moderator: Denny Silvio*

*Meeting Room 3-4*

Please join DOTD's Quality and Continuous Improvement Program (QCIP) as we help you explore efficiency and change within your work group. This three-part session will begin with instructions on facilitating an effective meeting. Next, we will conduct a practical demonstration of a useful analytical tool-SWOT analysis. Finally, we will examine a major departmental initiative, Operation 57, including how it was conceived and implemented, results, and lessons learned.

### **Conducting a SWOT Analysis and Implementing Recommendations**

*Indira Parrales and Lisa Leonard, LADOTD*

### **Facilitating an Effective Meeting**

*Wade Lester and Kristi Folse, LADOTD*

### **Operation 57 - Quality Self Assessment Program**

*Sherry Morton and Denny Silvio, LADOTD*

### **Session 39: Bridge Painting and More**

*Moderator: Alden "Casey" Allen*

*Meeting Room 5-6*

Work undertaken during the recently-completed cleaning, painting, and repair project on the 75-year old US 190 Mississippi River Bridge in Baton Rouge will be presented. Corrosion had taken a significant toll on the structure. This presentation will showcase the former condition of the bridge components, the various types of repairs undertaken, and the challenges faced conducting the work while the bridge remained in service for both vehicular and railroad traffic.

In 2012, DOTD began major bridge renovations which included full removal of existing lead-based coating systems and application of new high-performance zinc-based coating systems. Each project presented unique challenges to all involved: DOTD, contractors, and project inspection personnel. These challenges will be a focal point of this presentation.

Segment K of the I-49 North project runs from I-220 to Martin Luther King Drive in Shreveport. The project includes a dual superstructure design: post-tensioned segmental concrete and trapezoidal steel box girders. This presentation will highlight construction to date, including photos.

### **US 190 Mississippi River Bridge - Cleaning, Repair, & Painting**

*Larry Toups and Mike Beitzel, Modjeski and Masters*

### **Louisiana Bridge Painting - What Inspectors Look For, Issues, & Resolutions**

*Tim Thomas, LADOTD, and John Crowe, Greenman-Pedersen, Inc.*

### **I-49 North, Segment K (I-220 to Martin Luther King Drive)**

### **Interchange Project**

*Mike Paul and Durk Krone, TRC Engineers*



## Session 40: New FHWA Transportation Performance Management Rules

*Moderator: Brandon Buckner*

*Meeting Rooms 7-8*

FHWA defines Transportation Performance Management as a strategic approach that uses system information for making investment and policy decisions to achieve national performance goals. In accordance with the requirement outlined in MAP-21, FHWA has published rules providing more information about specific performance management requirements for achieving national performance goals in the areas of: Safety, Infrastructure Condition, Congestion Reduction, System Reliability, Freight Movement and Economic Vitality, Environmental Sustainability, and Reduced Project Delivery Delays. This session provides an overview of the rules and associated timeframes.

### Regulation Proposal/Requirements of Performance Measures

*Francine Shaw Whitson, Office of Transportation Performance Management, FHWA*

### Implementation Timeline

*Alexis Kuklenski, FHWA*

### Roles and Responsibilities: "What Do States Need to Know?"

*Todd Jeter, FHWA*

### Panel Discussion

*Francine Shaw Whitson, Alexis Kuklenski, and Todd Jeter*

## Session 41: A Legal Perspective (Panel Discussion)

*Moderator: Dan Magri*

*Meeting Room 9*

This session is a panel discussion on recent case studies related to highway safety.

*Carol Hunter and Diane Cosenza, Louisiana Department of Justice, and Brandon Brown, LADOTD*

## Session 42: Expediting the Right of Way Acquisition Process

*Moderator: Heather Corsentino*

*Meeting Room 10*

Right of way acquisition is very often the critical path for project delivery. Join us for a discussion of the right of way acquisition process that DOTD follows when obtaining the property rights needed to construct the state's transportation facilities. We will present tools that are currently available to jump start or expedite right of way acquisition, with an emphasis on providing the engineering project manager and other stakeholders with the information they need to ensure timely project delivery.

### Pre-acquisition Activities

*Ashley Long, LADOTD*

### Appraisal Activities

*James Lipscomb, LADOTD*

### Acquisition Activities

*Ronald Powell, LADOTD*

### Relocation Activities

*Stephanie Black, LADOTD*

## Session 43: Traffic Engineering

*Moderator: Brandon Boucher*

*Meeting Room 11*

DOTD is updating its design guidelines based on the 2011 AASHTO Green Book, context sensitive solutions, and its complete streets policy. The related presentation will focus on the guideline-revision process as well as the direction DOTD will take regarding selection and documentation of geometric and roadway design criteria for future projects.

DOTD has constructed many new roundabouts in Louisiana since year 2000. In terms of safety and operational benefits, the roundabout continues to show its merit as a valuable tool for intersection control. DOTD has recently updated design guidance for roundabouts with a new EDSM and Roundabout Design Chapter in the DOTD Road Design manual. The related presentation will provide an overview of DOTD's updated design guidance for roundabout projects.

Access Management is beneficial for roadway safety and capacity. DOTD has implemented policies to improve access management on the state roadway network. Various examples will be discussed to show how access management techniques have affected Louisiana's roadway network.

Recent changes to hardware, software, and policies are changing traffic signal design. This presentation will provide an overview of the changes, including ATMS.now, the 980 ATC controller, DOTD's traffic signal cabinet, the updated Traffic Signal EDSM, and the updated Traffic Signal Manual.

### An Update on the New DOTD Roadway Design Guidelines

*Gary Leblanc, LADOTD*

### An Update on Roundabouts at DOTD

*Joshua Harrouch, LADOTD*

### How LA DOTD Implementing Access Management

*Ryan Hoyt, LADOTD*

### LADOTD's Traffic Signal Design

*André Fillastre, LADOTD*



## Session 44: Location-based Decision Support; GIS for Managers and Administrators (Workshop)

Moderator: Jim Mitchell

Meeting Room 12

---

This workshop introduces managers and administrators (as well as, employees and contractors) to the GIS resources and capabilities available at DOTD. It features demonstrations of GIS data available at DOTD and how the data are being used to perform the work of the Department.

*Kurt Johnson and Jim Mitchell, LADOTD, and Jennifer Harrison, Inner Corridor Technologies*

## Session 45: Maintenance Operations

Moderator: Vince Latino

Meeting Room 13

---

This session will have presentations on U.S. Coast Guard Issues, Safety and Loss Prevention Initiatives, and Katrina/Rita - 10 Years Later.

### USCG Issues

*David Frank, U.S. Coast Guard*

### Loss Prevention Initiatives

*Haley Antee, LADOTD*

### Katrina/Rita 10 Years Later

*Rodney Mallett, LADOTD*

## Personal Development: Properly Diagramming a Performance Problem

*Lower Level Meeting Room 1*

---

This session focuses on how to identify performance issues: related to motivation or related to ability. Most managers know what to do with each issue, yet the key is properly identifying which factor is causing a performance problem. (This is not about self-motivation; it's not a "feel-good" session.)

*Ted Ball, LTRC*

[TUESDAY 3:45 p.m.–5:30 p.m.]

## Session 46: Pavement and Geotech Research

Moderator: Tyson Rupnow

Meeting Room 2

---

This session will focus on selected LTRC accelerated loading, geotechnical, and pavement research projects. Three projects will be discussed in detail.

Exciting results from an accelerated loading study of a thin roller compacted concrete pavement over soil cement will be discussed; results and implementation status of geotechnical research regarding pile setup in the LRFD design of driven piles will be detailed; and an improved structural capacity model for flexible pavement, based on rolling wheel deflectometer measurements, will be presented.

### Performance of Thin RCC Pavement over Soil Cement under Accelerated Loading

*Zhong Wu, LTRC*

### Implementation of Pile Setup in the LRFD Design of Driven Piles in Louisiana

*Md. Nafiul Haque and Murad Abu-Farsakh, LSU and LTRC*

### An Improved Structural Capacity Model for Flexible Pavement Based on Rolling Wheel Deflectometer (RWD) Deflection Measurements

*Mostafa Elseifi, LSU*

## Session 47: Anthology of Federal-aid Programs: A Curated Selection of FHWA Requirements

Moderator: Chandra Bondzie

Meeting Room 3-4

---

The Federal-aid program has many requirements. This session will assist with navigating through specific requirements in the program areas of Interstate Access Justification, Outdoor Advertisement, and the SHRP 2 Implementation Program.

### Interstate Access Justification

*John Broemmelsiek, FHWA*

### "I saw the sign....." An overview of the Outdoor Advertising Program and the Highway Beautification Act

*Charles Harkless, FHWA*

### Implementation Status of FHWA's SHRP 2 Program in Louisiana

*Mark Stinson, FHWA*

## Session 48: Asset Management

*Moderator: Jason Chapman*

*Meeting Rooms 5-6*

The FHWA has issued Notice of Proposed Rules, with respect to MAP-21 requirements, for both Performance Measures and Transportation Asset Management Plans. These rules will become final sometime this Spring and both Louisiana DOTD and the major MPOs of Louisiana will be affected. At this session, attendees will get a preview of how Louisiana measures up against the proposed measures and how these rules will impact MPOs. An insight will be provided into the data requirements and management systems in place that store and analyze asset condition information. The role that the Pavement Management System plays in DOTD decision making and current efforts to update the Bridge Management System to the latest AASHTOWare software will be discussed.

### **How do we Measure? A Review of MAP-21 Performance Measures**

*Mark Suarez, LADOTD*

### **Role of PMS in DOTD Decision Making**

*Chris Fillastre, LADOTD*

### **Beyond Duct Tape & WD-40: Upgrading DOTD BMS**

*Scott Choate, LADOTD*

## Session 49: Construction Roundtable

*Moderator: Barry Lacy*

*Meeting Room 7-8*

This session will be a dual forum. The first part will be a Q & A with representatives from DOTD and from industry (AGC, LAPA, & CAAL). The second part will be a Project Engineer/Area Engineer meeting with DOTD HQ construction engineers.

### **Panel Discussion**

*Ken Naquin, Louisiana AGC*

*Bill Temple, CAAL*

*Janice Williams, LADOTD*

*Charles Wale, Huey Stockstill, LLC*

*Mike Vosburg, LADOTD*

### **Project Engineer / Area Engineer Meeting with HQ Construction**

## Session 50: Bridge Maintenance

*Moderator: Matt Jantz*

*Meeting Room 9*

This session contains: discussion of new bridge design standards that are being used on bridge replacement projects, including expedited processes, bridge maintenance equipment, emergency projects, and replacement projects; discussion regarding the DOTD bridge inspection program, non-destructive evaluation projects, acoustic imaging, inspection equipment, and other inspection activities; and introduction of the newly mandated FHWA National Tunnel Inspection Standard, with discussion of the in-depth inspections for three state-tunnel inspections and resulting rehabilitation projects.

### **Statewide Bridge Maintenance Projects**

*David Miller, LADOTD*

### **Bridge Inspection Activities**

*Steve Sibley, LADOTD*

### **Tunnel Inspection Program**

*Haylye Brown, LADOTD*

## Session 51: Property Management – The Ins and Outs of the Property Disposal Process

*Moderator: Hubert Graves*

*Meeting Room 10*

Real property interests determined to be in excess of the state's transportation needs must be processed for sale or conveyance to a public or private entity in accordance with federal regulations and the state laws. Join us for a discussion on the laws, policies, and procedures DOTD follows in the determination and disposal of excess real property.

### **Laws and Regulations Surrounding Real Property Disposals**

*Charles McBride, LADOTD*

### **Overview of LDOTD's Property Management Section Including the Types of Properties Handled**

*Brandi Newman, LADOTD*

### **Methods of Disposal, Plans for Improving Efficiency, Questions and Answers**

*Rhett Desselle II, LADOTD*

## Session 52: Environmental Compliance

*Moderator: Joubert Harris*

*Meeting Room 11*

---

As we build and maintain the various transportation infrastructures across the state, we are constantly reminded of the importance and need for a symbiotic relationship with the environment. This session will focus on new and current environmental regulations that the transportation industry and its partners must abide by to achieve mutual goals which are beneficial to all stakeholders. It will also provide avenues for successful achievements, as well as, illustrate the resulting impacts of reckless environmental compliance.

### **Construction and Maintenance of Highway Infrastructures in the Spotlight of Environmental Consciousness**

*Celena Cage, Louisiana Department of Environmental Quality*

### **The Chemistry of an Oil Spill: Understanding the Environmental Impacts from the Deepwater Horizon Accident**

*Edward Overton, Louisiana State University*

### **Settling the Dust With Environmental Compliance: Cement Slurry**

*Khalil Hanifa and Gavin Gautreau, LTRC*

## Session 53: Breaking the Code: Meaningful Interpretation of Crash Data

*Moderator: Bryan Costello*

*Meeting Room 12*

---

DOTD and the Highway Safety Research Group are diligently working on creating user-friendly safety data analysis tools that will further transparency and decision support. Learn how our safety data influences the SHSP's initiatives and campaigns, the methods to determine crash locations, how to utilize the new state specific calibration factors, and how safety performance functions provide improved network screening capabilities.

### **Strategic Highway Safety Plan (SHSP) Dashboards**

*Cory Hutchinson, LSU/Highway Safety Research Group*

### **Crash Data Location Lessons Learned**

*Jeff Dickey, LSU/Highway Safety Research Group*

### **State Specific Calibration Factors & Safety Performance Functions (SPFs)**

*Jose Rodriguez, LADOTD*

## Session 54: Laser Scanning the I-49 Connector

*Moderator: Bart Rumsey*

*Meeting Room 13*

---

The I-49 Connector is a highly congested corridor and warrants an out-of-the-box approach to minimize surveyor interaction with the motoring public and the inconvenience of lane closures. The LA DOTD is utilizing terrestrial based laser scanning technology integrated into traditional topographic survey workflows to collect topographic data for approximately 20 miles of roadway surfaces located within the project limits. Learn the basic workflows, benefits, challenges, and intangibles associated with using these advanced technologies for transportation projects.

### **Introduction of the I-49 Connector Project**

*Stanley J. Ard, LADOTD*

### **Terrestrial Based Laser Scanning the I-49 Connector for Extracting Topographic Features**

*Joey Coco and Jonathan Coco, Forte & Tablada*

## Personal Development: Presentation Skills 101

*Lower Level Meeting Room 1*

---

This session hits the key areas of presentations given by non-presenters: engaging the audience, best practices in using visuals, and some presenters blunders to avoid.

*Ted Ball, LTRC*

## [WEDNESDAY 8:00 a.m.–9:45 a.m.]

## Session 55: Materials

*Moderator: Richie Charoenpap*

*Meeting Room 2*

---

DOTD installed a polymer high friction epoxy overlay on the I-10 Mississippi River Bridge and part of US 190. This product type is being utilized in many other locations to improve road surface friction for safety. Tennessee DOT (TDOT) is working with Florida DOT (FDOT) and the National Transportation Product Evaluation Program (NTPEP) to evaluate the product. In this session, TDOT and FDOT will discuss best practices in specifying, testing, evaluating, and installing polymer/epoxy materials, based on their experience. In the last presentation, the polymer resin patching material that DOTD installed on I-12 and Jefferson Hwy will be discussed. This patching product has performed very well on these high traffic volume sections of roadway. The partial depth product allows for a more efficient means of patching smaller failures as opposed to full depth replacement.

### **Polymer High Friction Overlay Tennessee's Experiences**

*Danny Lane, Tennessee DOT*

### **Epoxy Anchor System Testing and Florida's Experiences**

*Paul Vinik, Florida DOT*

### **Polymer Concrete Patching Materials Project**

*Todd Donmyer, LADOTD*

## **Session 56: New FHWA Risk-Based Stewardship and Oversight (S&O) Programs**

*Moderator: Todd Jeter*

*Meeting Room 3-4*

FHWA has implemented a new approach to integrating risk management into its performance planning process to identify S&O initiatives at both the national and division level for programs and for projects. Presentations in this session will explain the new FHWA/DOTD S&O Agreement, the Compliance Assessment Program (CAP), and the Projects of Division/Corporate Interests (PoDI/PoCI).

### **New FHWA and LADOTD Stewardship and Oversight Agreement**

*Mary Stringfellow, FHWA*

### **New Project Oversight Program: CAP and PoCI/PoDI**

*Mark Stinson, FHWA*

### **LPAs Stewardship and Oversight Responsibilities**

*Scott Nelson, FHWA*

## **Session 57: Bridge Evaluation and Rehabilitation**

*Moderator: Ray Mumphrey*

*Meeting Room 5-6*

This session will consist of presentations on historic bridges, assessment of timber bridges, and rehabilitation of a prestressed girder bridge.

### **Historic Preservation of Priority and Candidate Bridges**

*Amy Squitieri, Mead and Hunt, Inc.*

### **Condition Assessment of Timber Bridges in Severe and High Decay Hazard Zones**

*V.J. Gopu, LTRC*

### **Bayou Ramos Bridge Rehabilitation and Instrumentation**

*Dana Feng and Ching Tsai, LADOTD*

## **Session 58: Construction Laws**

*Moderator: Randy Sanders*

*Meeting Room 7-8*

**2016  
SPECS**

Public bid laws for transportation related construction projects are regulated through various Louisiana revised statutes. Laws that govern the bid process for DOTD construction projects will be discussed along with other publicly funded projects that are bid by other state agencies. Pertinent chapters of the newly developed standard specifications will also be discussed.

It's the letter no one wants to receive: "You Have Been Sued". Learn what design professionals should and should not have in project files, when it comes to defending (or avoiding) a lawsuit. Practical suggestions about e-mail etiquette, project correspondence, photo retention, site inspections and the like will be discussed, with examples of good and bad project documentation.

### **Public Bid Laws for DOTD Constructions**

*Timothy Strohschein, LADOTD*

### **When Lawyers Call: How to Document your Projects**

*Scott Hedlund, Deutsch Kerrigan, Counselors at Law*

## **Session 59: Improving Safety Data Through Data Governance**

*Moderator: Jim Mitchell*

*Meeting Room 9*

As performance-based management becomes more prominent in the business processes of state DOTs, data governance will become more important. Data governance supports users across the enterprise with policies that guide data quality and access. This session will hear from the Louisiana Chief Data Officer (CDO), about statewide efforts; Iowa DOT's implementation of their program; the Geospatial Transportation Information Management Assoc. regarding data accuracy; and Dataforensics, on making geotechnical data work across many sources.

### **Data Governance: The Road to Data Quality and Data Sharing**

*Robert Manuel, Division of Administration / Office of Technology Services*

### **Data Governance Maturity and Implementation**

*Eric Abrams, Iowa Department of Transportation*

### **Improving Safety Data Through Data Governance**

*Robert Dingess, Geospatial Transportation Mapping Assoc. (GTMA)*

### **Facilitating Geotechnical Data Processes via Data Interchange**

*Scott Deaton, Dataforensics*

## Session 60: Enterprise GIS

*Moderator: Jason Chapman*

*Meeting Room 10*

With the advent of Google Earth, Google Maps, Bing Maps, and several in-vehicle navigation systems, many agencies understand the need for extending their digital road network or Enterprise Linear Reference Systems (LRS) to provide similar types of services to the public. To facilitate this effort, agencies must invest in a platform to integrate data across business systems. Louisiana DOTD has chosen Roads and Highways, Esri's ArcGIS for Desktop extension, as the tool to accomplish this effort. Please join us for presentations that will demonstrate the various capabilities of the solution that will finally integrate the various data silos and enable the extension of our data for both internal use and public distribution.

### **Manage Your Road Network - Esri Roads & Highways**

*Gary Waters, Esri*

### **A Success Story - Implementing Roads & Highways**

*David Ward, Arcadis*

### **Louisiana's Enterprise GIS Implementation**

*Darryl Mack, LADOTD*

## Session 61: Legal Issues Impacting Districts

*Moderator: Michael DeSelle*

*Meeting Room 11*

Topics in this session include time management, effective supervision, and a practical approach to handling employee disciplinary matters in the field. Steps for potential action and documentation will be offered.

Participants will have an opportunity to ask specific questions concerning any legal issues that impact the districts and their field offices.

### **Practical Employee Strategies in the Field**

*Elena Branzaru, LADOTD*

### **Disciplinary Procedures, Guidelines and Myths**

*Candace Rustad, LADOTD*

### **Open Question and Answer**

*Elena Branzaru and Candace Rustad, LADOTD*

## Session 62: Planning For Louisiana's Future

*Moderator: Dan Broussard*

*Meeting Room 12*

Everyone in Louisiana relies on transportation. Whether it is to move products to market, fly into a city to attend a conference, travel to work, or ride a bike to a park, transportation is involved. In the next 30 years, Louisiana's economic health and quality of life may be at risk because of transportation funding challenges. Costs of providing infrastructure and services are up, but revenue is down. Maintaining what already exists continues to take a larger portion of available funds, leaving limited opportunities for addressing other significant transportation needs. This situation calls for a comprehensive look at how Louisiana can best address its transportation needs in the long-term and current economic climate.

### **Houma/Thibodaux Long Range Transportation Plan**

*Joshua Manning and Leo Marretta, Houma/Thibodaux MPO*

### **2014 Louisiana Long Range Transportation Plan**

*Donald Vary, CDM Smith*

### **Louisiana Mega Projects**

*Dennis Decker, LADOTD*

## Session 63: Railroad Coordination – Coordinating Roadway Projects with the Railroads

*Moderator: Jared Ray*

*Meeting Room 13*

The proximity of a railroad brings unique requirements to the design, plan development, and construction of roadway projects. It is essential to begin early coordination and include the railroad when developing the project scope. This session will discuss best practices for the development of plans and construction of projects which involve a railroad. This session will also include a railroad safety presentation, examples of what to look for during design, typical time lines for railroad coordination, and construction requirements when a railroad is involved.

### **Operation Lifesaver**

*Claude Maher, Louisiana Operation Lifesaver*

### **Useful Tools (FRA APS & RIMS)**

*Bill Shrewsbury, LADOTD*

### **How to - Design**

*Shawn Luke, LADOTD*

### **How to - Project Management**

*Carlton Bell, LADOTD*

### **How to - Construction**

*Gretchen Ferguson, LADOTD*

## Personal Development: An Inside Out Approach to Handling Conflict

Lower Level Meeting Room 1

This session looks at the root causes of interpersonal conflict with an eye toward the behaviors that effectively manage conflict *and* ineffectively manage conflict. We will look at behaviors under our control and behaviors that are never under our control.

*Ted Ball, LA DOTD*

**[WEDNESDAY 10:00 a.m.–11:45 a.m.]**

### Session 64: LTAP

*Moderator: Laura Riggs*

Meeting Room 2

Louisiana's local agencies own and operate over 44,000 miles of roadways in Louisiana and approximately 5,000 bridges. DOTD has stepped up efforts to provide assistance to local transportation agencies and to improve the efficiency of LPA program management and project delivery. This session will provide an update of the major LPA initiatives including the LPA Core Training Program; Off-System Bridge System compliance with FHWA 23 Metrics; and the Louisiana Local Road Safety Program. Initiatives of the FHWA Everyday Counts Program will also be discussed, with focus on how local agencies may be affected, including the State Innovation Council, Stakeholder Partnering, and Geosynthetic Reinforced Soil-Integrated Bridge System.

#### LPA Program Overview

*Ann Wills, LADOTD*

#### LPA Training Initiatives

*Marie Walsh, Louisiana Local Technical Assistance Program*

#### Every Day Counts (EDC) and other Initiatives for Locals

*Mary Stringfellow, FHWA*

#### Update on the Local Road Safety Program

*April Renard, LADOTD*

#### Off System Bridge Compliance Program Update

*David Miller, LADOTD*

## Session 65: Compliance

*Moderator: Stephanie Ducote*

Meeting Room 3-4

This session will include a presentation that explains the Louisiana Unified Certification Program, with details regarding who should apply and how to apply for Disadvantaged Business Enterprise (DBE) and Small Business Enterprise (SBE) certification. A discussion of the process for setting a DBE goal on a DOTD Consultant Contract will also be provided.

The session will also include a quick overview of DOTD's ADA Transition Plan database, with focus on its five-year program, including background, budget, and program guidelines.

The session will also provide information about different forms of discrimination, with information regarding the filing of complaints with the Department of State Civil Service and Equal Employment Opportunity Commission.

### DBE/SBE Certification

*Remy Graves, LADOTD*

### ADA Database/Program

*Toby Picard, Marianne Mayard, Katie Copeland, LADOTD*

### Title 7 and Forms of Discrimination

*Stephanie Ducote, Kathy Horsfall, and Jennifer VanMetre, LADOTD*

## Session 66: Bridge Rehabilitation

*Moderator: Chris Guidry*

Meeting Room 5-6

This session will provide information about the rehabilitation of truss bridges over the Mississippi River and over the Red River.

### US 190 Mississippi River Bridge Structural Repairs

*John Richard, TRC*

### US 84 Mississippi River Bridge Pin and Link Replacement

*James Gregg, HNTB*

### Jimmie Davis Bridge Deck and Hanger Replacement and Painting

*Steve Boudreaux, Stantec*



## Session 67: Consultant Contracts

*Moderator: Kathy Ward*

*Meeting Room 7-8*

DOTD and the American Council of Engineering Consultants' transportation committee in Louisiana are conducting a joint effort to review the laws, policies, and procedures governing consultant selection and administration for engineering and related services at DOTD. The purpose of the review is to develop recommendations for greater efficiency, effectiveness, openness, and fairness. A status update will be provided.

DOTD's Consultant Contract Services (CCS) Manual outlines the department's policies and procedures for procuring and administering consultant contracts for engineering and related services. It was recently revised in order to comply with the new Code of Federal Regulations, as well as some new DOTD policies. The manual is intended for use by the consultant community desiring to provide engineering and related services to DOTD, as well as the DOTD staff requiring those services. This session will present major changes that have been made to the manual; a Q&A session will follow.

### **ACEC/L -DOTD Initiatives on Consultants Contracts**

*Bob Boagni, GEC, and Ed Wedge, LADOTD*

### **Revised CCS Manual**

*Ed Wedge, LADOTD*

## Session 68: Road Diets - A Proven Safety Countermeasure

*Moderator: Adriane McRae*

*Meeting Room 9*

Improved safety and congestion relief on public roadways are high-priority national goals. Innovative reconfigurations such as road diets can help achieve these goals for motorists and non-motorists on mixed-use streets by reducing vehicle speeds and reallocating space for alternative modes. Road diets can reduce collisions, increase mobility and access, and improve a community's quality of life. So what exactly is a road diet and when should you consider putting your road on a diet? This session will try and answer these questions for planners and designers. Speakers will discuss specific project examples of how road diets are being implemented in other parts of the country as well as within our state.

### **EDC-3 Innovation: Road Diets**

*Dongho Chang, City of Seattle Department of Transportation*

### **District 62 Road Diet Case Study**

*Cristine Gowland, DOTD*

### **Government Street Road Diet**

*Cindy Hall and Stephen Mensah, Stantec*

## Session 69: Environmental

*Moderator: Noel Ardoin*

*Meeting Room 10*

This session is an example of environmental diversity. Our first speaker will address the built environment with a presentation on DOTD's historic bridge inventory. The state's pre-1970 bridges have been inventoried, categorized, and documented for their historic integrity and a programmatic agreement concerning the treatment of historic bridges is complete. Our second speaker will touch on the natural environment. DOTD's liaison with the US Army Corps of Engineers will explain the latest requirements for wetland mitigation and how that mitigation is determined by the Corps. Finally, our last speaker will present e-NEPA, FHWA's latest tool for collaboration during the NEPA process. DOTD is testing this tool on a few of its projects.

### **Historic Bridge Inventory and Programmatic Agreement**

*Amy Squitieri, Mead and Hunt, Inc.*

### **Calculating Compensatory Mitigation in the New Orleans District**

*Stephen Pfeffer, US Army Corps of Engineers, New Orleans District Regulatory Branch*

### **e-NEPA: Collaboration Tool**

*Andrew Brunner and Kreig Larson, Office of Project Development & Environmental Review, FHWA*

## Session 70: New Specification Implementation

*Moderator: Chris Abadie*

*Meeting Room 11*

2016  
SPECS

A summary of DOTD's latest proposed specifications will enhance audience knowledge of the new Standard Specifications for Roads and Bridges. These presentations will provide a snapshot report of the new specifications, some explanation of how these specifications differ from those prior, and the reason for the changes. When possible, a summary of projects that have been constructed to-date, highlighting any issues that had to be addressed, will also be included in the presentations.

### **Materials: Part X**

*Luanna Cambas, LADOTD*

### **Earthwork, Base Courses, Surface Courses: Parts II, III, IV**

*Chris Abadie, LADOTD*

### **Rigid Pavement, Concrete: Parts VI, IX**

*B.J. Eckholdt, Lafarge*

### **Asphaltic Pavements: Part V**

*Chris Abadie, LADOTD*

## Session 71: Advanced Data Collection Techniques for Transportation Applications

*Moderator: Eric Lanier*

*Meeting Room 12*

---

In this session, we will explore ways that 3D Terrestrial Laser Scanning can be applied to various types of transportation projects, providing the audience with a basic understanding of the process, describing methods that increase safety during data collection, and reviewing DOTD projects where the technology has been successfully applied.

We will also discuss the basics of aerial photogrammetry by light-weight unmanned aerial vehicles (UAVs), including a brief history and overview of UAV systems, potential pitfalls to avoid, and discussion of the requirements for legal commercial use of UAVs.

### 3D Terrestrial Laser Scanning Applications for Transportation Projects

*Brad Holleman, SJB Group*

#### Understanding Aerial Surveys Through Accessible UAV's

*David Snyder, Trimble Navigation, and William Poche, Navigation Electronics, Inc.*

## Session 72: Precast Concrete Pavements

*Moderator: Mark Chenevert*

*Meeting Room 13*

---

Precast concrete pavement (PCP) systems are becoming more common for rapid rehabilitation of high volume roadways in urban/suburban areas where daytime lane closure may be difficult and challenging. The use of PCP technology can significantly reduce traffic impacts along these roadways and provide longer lasting performance. Experts in the field of PCP will present the latest information on this technology. Be a part of this session and learn from states that are implementing the technology in their highway projects.

### Overview of Precast Concrete Pavement Applications (FHWA Initiatives)

*Samuel S. Tyson, Federal Highway Administration Office of Asset Management, Pavements and Construction*

#### Precast Concrete Pavement State of Practice

*Shiraz Tayabji, Applied Research Associates*

#### Georgia DOT Precast Concrete Implementation Experience

*Erik Rohde, Georgia DOT*

## Personal Development: They're Leaving! What Do We Do Now? (The Next Workplace Culture)

*Lower Level Meeting Room 1*

---

The baby-boomer workforce is retiring. Here's a look at the effects of losing specialized knowledge, workplace contributions, and expertise as they walk out of the door.

*Ted Ball, LTRC*

# NOTES

# NOTES

# SPEAKER INDEX

Abadie, Chris—25	Collier, Zachary—17	Harkless, Charles—19
Abrams, Eric—22	Copeland, Katie—24	Harrison, Jennifer—14, 19
Abu-farsakh, Murad—19	Cosenza, Diane—18	Harrouch, Joshua—18
Antee, Haley—19	Crowe, John—17	Haywood, Louis—16
Ard, Stanley J.—21	Davis, Jason—16	Hedlund, Scott—22
Ashley, Clyde—8	Deaton, Scott—22	Hemphill, Mark—12
Ayers, Mike—10	Decker, Dennis—23	Herbel, Susan—9
Bahr, Emilie—16	Delaney, Elizabeth—10	Hickey, J.J.—12
Basilica, John—12, 16	Desselle II, Rhett—20	Holleman, Brad—26
Beitzel, Mike—17	Dickey, Jeff—21	Hollier, Mike—14
Bell, Carlton—23	Dingess, Robert—16, 22	Horsfall, Kathy—24
Black, Stephanie—18	Donmyer, Todd—22	Hou, Yuwen—16
Blanchard, Brian—10	Ducote, Stephanie—24	Hoyt, Ryan—18
Blandino, Laurie—8	Eckholdt, B.J.—25	Hulon, Chace—9
Boagni, Bob—25	Elseifi, Mostafa—19	Hunter, Carol—18
Boniol, Curt—11	Estopinal, Stephen—3	Hupperich, Lee—11
Bordelon, Melanie—11	Feng, Dana—22	Hutchinson, Cory—21
Boudreaux, Steve—24	Ferguson, Gretchen—23	Icenogle, Bill—9
Brandt, Brad—14	Ferlito, Nick—11	Ishak, Sherif—15
Branzaru, Elena—23	Fillastre, Andre’—18	Jarreau, Randy—13
Breaux, Tiffany—8	Fillastre, Chris—20	Jatres, Dan—16
Breeden, Skip—9	Folse, Kristi—17	Jeter, Todd—18
Brickett, Jennifer—11	Forest, Geoffrey—11	Johnson, Kurt—16, 19
Broemmelsiek, John—19	Fossier, Paul—13	Kalivoda, Eric—14
Brown, Haylye—20	Frank, David—19	Kapisis, James—10
Brown, Brandon—12	Fruge, Nicholas—9	Kelle, Peter—10
Brunner, Andrew—25	Fu, Zhengzheng “Jenny”—8	Keller, Kevin—17
Buechter, Ashley—12	Gautreau, Gavin—21	Kemp, Kelly—15
Burst, Jeffrey—16	Gierhart, Danny—14, 16	Killingsworth, Brian—12
Cage, Celena—21	Gillis, Thell—16	Knight, Ed—11
Cambas, Luanna—25	Gopu, V.J.—9, 22	Knotts, Christopher—3
Carter, Cade—17	Gowland, Cristine—25	Krone, Durk—17
Carwie, Chris—10	Graves, Remy—24	Kuklenski, Alexis—18
Catlett, Walter—12	Graves, Hubert—14	Lacy, Barry—15
Chang, Dongho—25	Greaber, Stephen—14	LaGrange, Gary—17
Chauhan, Akhilendra—11	Gregg, James—15, 24	LaGuardia, Edward—12
Choate, Scott—12, 20	Gudishala, Ravindra—15	Lancaster, Adam—13
Coco, Joey—21	Hall, Cindy—25	Landry, Art—13
Coco, Jonathan—21	Hanifa, Khalil—21	Lane, Danny—22
Codjoe, Julius—15	Haque, Md. Nafiul—19	Larson, Kreig—25

Latino, Vince—12	Pfeffer, Stephen—25	Temple, Bill—20
Leblanc, Gary—18	Picard, Toby—24	Thomas, Tim—17
Lentz, Lee—11	Poche, William—26	Timm, David—14, 16
Leonard, Lisa—17	Pospisil, Martin—14	Toups, Larry—17
Lester, Wade—17	Powell, Ronald—18	Tsai, Ching—22
Lipscomb, James—18	Rauser, Jesse—16	Tyson, Samuel S.—26
Long, Ashley—18	Reed, Robert—14	VanMetre, Jennifer—24
Luke, Shawn—23	Renard, April—9, 24	Vary, Donald—17, 23
Mack, Darryl—23	Richard, John—24	Vinik, Paul—22
Maher, Claude—23	Rister, Michael—8	Vosburg, Mike—20
Major, Darhlene—14	Rodriguez, Jose—21	Wale, Charles—20
Mallett, Rodney—19	Rodriguez, Geoffrey—14	Walsh, Marie—24
Malveaux, Charles—9	Rohde, Erik—26	Wang, Jay—10
Manning, Joshua—23	Root, Michael—8	Ward, David—23
Manuel, Robert—22	Rustad, Candace—23	Wasiuddin, Nazimuddin—8, 17
Marretta, Leo—23	Sanchez, Victor—15	Waters, Gary—23
Mayard, Marianne—24	Sant, Larry—14	Wedge, Ed—25
McBride, Charles—20	Schneider, Helmut—10	Wemple, Beth—11
Melton, Matt—16	Sepeda, Greg—13	Werner, Robert—14
Mensah, Stephen—25	Shaw Whitson, Francine—18	Williams, Janice—20
Miller, David—20, 24	Shrewsbury, Bill—23	Williamson, Billy—11
Mitchell, Jim—14, 19	Sibley, Steve—9, 20	Wills, Ann—13, 24
Mohammad, Louay—17	Sileno, Michael—11	Wilmot, Chester—15
Montz, Thomas—11	Silvio, Denny—17	Woods, Seth—8
Morales, Juan—15	Sivakumar, Bala—8	Wu, Zhong—19
Moran, Ashley—9	Smith, Brian—12	
Morton, Sherry—17	Smith, Erik—10, 12	
Mumphrey, Ray—13	Smith, Michael—13	
Murphy, Yvonne—9	Snyder, David—26	
Naquin, Ken—20	Sollie, Carryn—10	
Nelson, Scott—22	Sowers, David—10	
Newcomb, Dave—14	Speck, Jeff—12	
Newman, Brandi—20	Squitieri, Amy—22, 25	
Neyland, Codi—11	Stinson, Mark—19, 22	
Nichols, Silas—16	Stockstill, Susan—11	
Nickel, Charles—13	Strength, Steve—15	
Nickel, Chris—16	Stringfellow, Mary—22, 24	
Nickel, Tim—15	Strohschein, Timothy—22	
Okeil, Ayman—8	Sturdivant, Phillip—11	
Osman, Osama—15	Suarez, Mark—20	
Overton, Edward—21	Swan, Richard—9	
Parrales, Indira—17	Tayabji, Shiraz—26	
Paul, Mike—17	Taylor, Doug—11	



## 2016 Louisiana Transportation Conference Documentation of Professional Development Hours

### Print Name

Date and Time	Session Title	PDHs
Sunday, 2/28/2016 3:30-5:30 p.m., or Wednesday, 3/2/2106, 2-4 p.m. 2.0 PDHs available*	Standards of Practice for Boundary Surveys in Louisiana	
Monday, 2/29/2016 8:45 a.m.–11:30 a.m. 2.0 PDHs available*	General Session	
Monday, 2/29/2016 1:00 p.m.–2:45 p.m. 2.0 PDHs available*	Session 1: FHWA Demonstration	
	Session 2: Record Management and Decision Support Services	
	Session 3: Bridge Design Plan and Development	
	Session 4: Emergency Operations	
	Session 5: Big Data, Big Decisions: Strategic Planning to Save Lives	
	Session 6: Bridge Inspection and Repair Methods	
	Session 7: Concrete Pavements (Part 1)	
	Session 8: Intelligent Transportation Systems Program	
Monday, 2/29/2016 3:15 p.m.–5:00 p.m. 2.0 PDHs available*	Session 9: Innovative Design: Connecting Our Communities, Connecting our Future	
	Session 10: University Transportation Centers (Part 1)	
	Session 11: Funding Louisiana's Roads and Bridges	
	Session 12: Movable Bridges	
	Session 13: Overview of Public Works Section	
	Session 14: Quantifying Safety in the Project Development Process	
	Session 15: Managing our Shapes: 3D Modeling	
	Session 16: Concrete Pavements (Part 2)	
	Session 17: Autonomous Vehicles	
	Session 18: Railroad Engineering 101	

Date and Time	Session Title	PDHs
Tuesday, 3/1/2016 8:00 a.m.–9:45 a.m. 2.0 PDHs available*	Session 19: Student Projects	
	Session 20: Audit	
	Session 21: New Specifications and Details	
	Session 22: Risk Management	
	Session 23: Right Sizing - The Who, What, Where, & How	
	Session 24: Geotech 1 - Down and Dirty (Complex Project Updates)	
	Session 25: Asphalt Construction (Part 1)	
	Session 26: Accessing and Mapping DOTD Data Using ArcGIS Online (Workshop)	
Tuesday, 3/1/16 10:45 a.m.–12:30 p.m. 2.0 PDHs available*	Session 27: Passenger Transportation	
	Session 28: University Transportation Centers (Part 2)	
	Session 29: Work Zone Safety	
	Session 30: Bridge Design and Construction	
	Session 31: Alternative Delivery	
	Session 32: Implementing Complete Streets	
	Session 33: Geotech 2 - Down and Dirty (Design, Construction, and Helpful Tools)	
	Session 34: Asphalt Construction (Part 2)	
	Session 35: Use and Direction of GPS Technology at DOTD	
	Session 36: Freight Transportation	

\*2.0 PDH maximum assigned for each session based on anticipated contact time. If contact time is less than scheduled, PDHs are to be adjusted accordingly (50 minutes of contact time = 1PDH).

Date and Time	Session Title	PDHs
Tuesday, 3/1/2016 1:30 p.m.–3:15 p.m. 2.0 PDHs available*	Session 37: Materials Research	
	Session 38: QCIP	
	Session 39: Bridge Painting and More	
	Session 40: New FHWA Transportation Performance Management Rules	
	Session 41: A Legal Perspective (Panel Discussion)	
	Session 42: Expediting the Right of Way Acquisition Process	
	Session 43: Traffic Engineering	
	Session 44: Location-based Decision Support; GIS for Managers and Administrators (Workshop)	
	Session 45: Maintenance Operations	
Tuesday, 3/1/2016 3:45 p.m.–5:30 p.m. 2.0 PDHs available*	Session 46: Pavement and Geotech Research	
	Session 47: Anthology of Federal-aid Programs: A Curated Selection of FHWA Requirements	
	Session 48: Asset Management	
	Session 49: Construction Roundtable	
	Session 50: Bridge Maintenance	
	Session 51: Property Management: The Ins and Outs of the Property Disposal Process	
	Session 52: Environmental Compliance	
	Session 53: Breaking the Code: Meaningful Interpretation of Crash Data	
	Session 54: Laser Scanning the I-49 Connector	

\*2.0 PDH maximum assigned for each session based on anticipated contact time. If contact time is less than scheduled, PDHs are to be adjusted accordingly (50 minutes of contact time = 1PDH).

Date and Time	Session Title	PDHs
Wednesday, 3/2/2016 8:00 a.m.–9:45 a.m. 2.0 PDHs available*	Session 55: Materials	
	Session 56: New FHWA Risk-Based Stewardship and Oversight (S&O) Programs	
	Session 57: Bridge Evaluation and Rehabilitation	
	Session 58: Construction Laws	
	Session 59: Improving Safety Data Through Data Governance	
	Session 60: Enterprise GIS	
	Session 61: Legal Issues Impacting Districts	
	Session 62: Planning For Louisiana's Future	
	Session 63: Railroad Coordination: Coordinating Roadway Projects with the Railroads	
Wednesday, 3/2/2016 10:00 a.m.–11:45 a.m. 2.0 PDHs available*	Session 64: LTAP	
	Session 65: Compliance	
	Session 66: Bridge Rehabilitation	
	Session 67: Consultants Contracts	
	Session 68: Road Diets - A Proven Safety Countermeasure	
	Session 69: Environmental	
	Session 70: New Specification Implementation	
	Session 71: Advanced Data Collection Techniques for Transportation Applications	
	Session 72: Precast Concrete Pavements	
<b>TOTAL PDHs EARNED</b>		

Date and Time	Session Title	PDHs
Sunday, 2/28/2016, 4:30 p.m.-5:30 p.m. or Wednesday, 3/2/2016, 2:00 p.m.-3:00 p.m. 1.0 PDH available	Ethics	
<b>TOTAL PDHs EARNED IN ETHICS</b>		

Total PDHs earned through attendance at the 2016 Louisiana Transportation Conference \_\_\_\_\_

PDHs earned in Professional Ethics at the 2016 Louisiana Transportation Conference \_\_\_\_\_

PDHs earned in Standards of Practice for Boundary Surveys in Louisiana at the 2016 Louisiana Transportation Conference \_\_\_\_\_

I hereby attest that I have attended the sessions documented on this form and that the cumulative PDHs total above is accurate.

\_\_\_\_\_  
Signature of Attendee

# CONFERENCE COMMITTEES

## PLANNING COMMITTEE

Sam Cooper, Chair  
 Tyson Rupnow, Vice Chair  
 Myles Brumfield  
 Nita Chambers  
 Dennis Decker  
 Michael Demouy (AGC)  
 Kirk Gallien  
 Todd Jeter (FHWA)  
 Dan Mobley (ACECL)  
 Ken Naquin (AGC)  
 Harold "Skip" Paul  
 Erich Ponti (LAPA)  
 Bill Temple (CAAL)  
 Don Weathers (LAPA)  
 Shawn Wilson  
 Janice Williams

## CONFERENCE MANAGEMENT COMMITTEE

Mary Leah Coco, Chair  
 Kristina Blanchard  
 Michael Boudreaux, Program Committee Chair  
 Brian Buckel, Trade Show/Exhibitor Committee Chair  
 Sam Cooper  
 Brad Doucet, IT/Audiovisual Committee Chair  
 Patrick Icenogle, Program Committee Co-Chair  
 Allison Landry  
 Bridget LeBlanc  
 Melissa Lee  
 Philip Macaluso, Communications Committee Chair  
 Mark Morvant  
 Harold "Skip" Paul  
 Rex Ransome  
 Rebecca Rizzutto  
 Jenny Speights, Publications Committee Chair  
 Cindy Twiner, Registration Committee Chair  
 Emily Wolfe

## AUDIOVISUAL (AV)/INFORMATION TECHNOLOGY (IT) COMMITTEE

Brad Doucet, Committee Chair  
 Paul Hendricks  
 Warren Huffty  
 Kim Lanceslin  
 Adele Lee  
 Patrick Mahaffey  
 Garrett Wheat

## REGISTRATION/PUBLICATIONS COMMITTEE

Cindy Twiner, Registration Committee Chair  
 Jenny Speights, Publications Committee Chair  
 Angela Benn  
 Jenny Gilbert  
 Cassandra Gray  
 Chris Melton  
 Kelvin Stone  
 Emily Wolfe

## COMMUNICATIONS COMMITTEE

Philip Macaluso, Chair  
 Joe Drago  
 Frank "Gil" Lea

## PROGRAM COMMITTEE

Michael Boudreaux, Chair  
 Patrick Icenogle, Co-Chair  
 Chris Abadie  
 Noel Ardoin  
 Simone Ardoin  
 Andrew Barry  
 Jamie Boullion  
 Jeffrey Burst  
 Jason Chapman  
 Richie Charoenpap  
 Mark Chenevert  
 Heather Corsentino  
 Bill Drake  
 Kristie Folse  
 Steve Glascock  
 Dean Goodell  
 Dr. VJ Gopu  
 Hubert Graves  
 Joubert Harris  
 Joshua Harrouch  
 Don Johnson  
 Matthew Jones  
 Kelly Kemp  
 Christopher Knotts  
 Barry Lacy  
 Jeff Lambert

Murphy Ledoux  
 Ashley Long  
 Robert Lott  
 Dan Magri  
 Adriane McRae  
 David Miller  
 Jim Mitchell  
 Erich Ponti (LAPA)  
 Masood Rasoulion  
 Robin Romeo  
 Bart Rumsey  
 Tyson Rupnow  
 Hector Santiago, FHWA LA Division  
 Dawn Sholmire  
 Steven Sibley  
 Mark St. Cyr  
 Steve Strength  
 Mary Stringfellow  
 Richard Swan  
 William "Bill" Temple (CAAL)  
 Don Weathers (LAPA)  
 Kirk Zeringue

## TRADE SHOW/EXHIBITOR COMMITTEE

Brian Buckel, Chair  
 Kaitlyn Boudreaux  
 Barry Lee Moore  
 Ronald Madden  
 Craig Melancon  
 John Starring

