

# Grants

## Don't reinvent the wheel

By AJ Walker  
LMA Membership Services Coordinator

Grant writing can be tough. However, when it comes to developing grant applications, it can be a lot easier if you don't start from scratch.

Let's say that you are interested in a grant, but you've never written an application or applied for this particular type of grant before. Let's also assume that your municipality doesn't have the money to pay a professional grant writer. Instead of wrecking your brain and stressing out the one who gets assigned to develop the application, use your resources to make the situation easier and manageable. The first thing is to find out who the agency's point of contact is for that particular grant. Once you know that, give them a call

### #GrantSpotlight

This month in our #grantspotlight, we feature the Local Road Safety Program (LRSP), which is a life-saving, cost disbursement grant for local governments.

Louisiana is on a long-term journey towards Destination Zero Deaths on all public roads. The statewide Strategic Highway Safety Plan (SHSP) provides an opportunity for all Louisiana communities to actively participate in saving lives and reaching the zero goal. The LRSP enables local governments to access federal funds for low cost safety improvement projects on locally owned and maintained roads.

Any municipality can and ALL municipalities are encouraged to apply for this funding to improve safety and save lives. Applications are accepted

year around and evaluated quarterly after each cutoff date (March 31, June 30, September 30 and December 31). A project is reviewed for its applicability toward the goal of increasing safety on the local road system. The maximum award is \$500,000 and there is a 5-10% local cost share.

Over 120 projects have been funded since the program's inception in 2006.

Some of those 120 projects include the installation of enhanced traffic signs, pavement markings, guardrails, intersection improvements, safety studies and curve delineations.

For more information on this program or assistance with data analysis and applications, please contact Rudynah Capone, LRSP Manager, at [rudynah.capone@la.gov](mailto:rudynah.capone@la.gov), or (225) 767-9718.



The Local Road Safety Program provides assistance in crash data analysis and field assessments during the project development process. Photo shows the LRSP Team working with local stakeholders and LADOTD in a recently held Road Safety Assessment (RSA) at a horizontal curve on a high-crash local road in St. Tammany Parish.

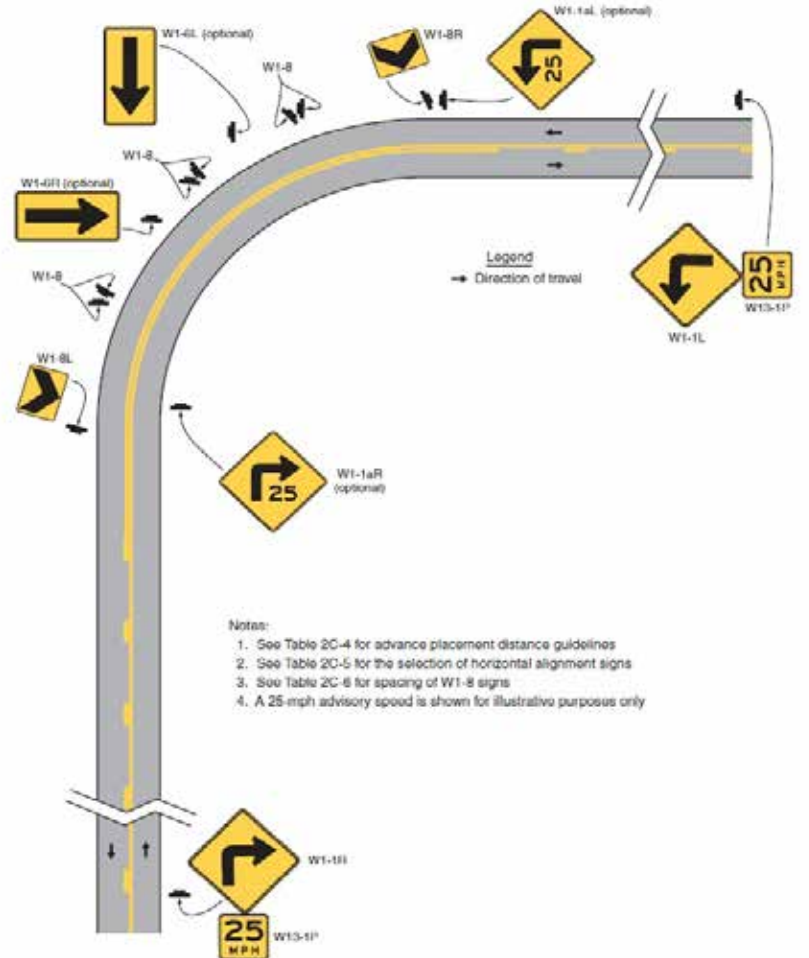

Above diagram shows a standard LRSP plan for a horizontal curve which is based off of the MUTCD 2009 Edition.

and ask for examples of recently approved/funded applications from communities that are similar to yours. After that, I would suggest calling the entity whose application you received for a model and not only ask them for permission to follow their same format, but also ask them why they did it like that, things they would do differently and other information that they could share that would increase your chance of being awarded with that grant.

The game of basketball was created a long time ago. From Wilt Chamberlain to Walt Frazier to Magic Johnson to Michael Jordan to LeBron James; they all played in the National Basketball Association at different times. Although they had different styles and brought their own uniqueness, they all picked up and not only learned the game from their predecessor, but they also got tips on how to become better from their predecessor for the betterment of their individual game.

Learn from a predecessor that has previously been funded on how to do it, but do it better. Anthony J. D'Angelo sums up my story the best when he said, "Don't reinvent the wheel, just realign it."

## Available Grants Timeline

Grant	Category	Summary	Deadline	Funding	More Information
Local Road Safety Program (LRSP)	Infrastructure	This grant allows municipalities to improve infrastructure by providing evidence that the project would result in a reduction in serious injury and fatality crashes.	Rolling	Up to \$500,000/project	For more information, please visit: <a href="http://www.ltrc.lsu.edu/lrap/lrsp.html">http://www.ltrc.lsu.edu/lrap/lrsp.html</a>
Let's Play Imagination Playground Grant	Parks & Recreation		Rolling	\$15,000 - \$30,000	For more information, please visit: <a href="http://kaboom.org/grants/creative_play">http://kaboom.org/grants/creative_play</a>
Community Facilities Grant Program	Economic Development	This program provides grants to assist in the development of essential community facilities in rural areas and towns of up to 20,000 in population.	12/31/15	Varies	For more information on this 25% cost share grant, please visit: <a href="http://efficientgov.com/grant-details/?gid=14925">http://efficientgov.com/grant-details/?gid=14925</a>
Veterans Cemetery Grants	Community Development	This program seeks to provide the service of Veterans cemetery within 75 miles if 90% of Veterans across the country. It's intended to complement the service provided by the Department of Veterans Affairs operated by the National Cemetery Administration.	7/1/15	\$46,000,000 total grant funds	For more information, please visit: <a href="http://efficientgov.com/grant-details/?gid=36879">http://efficientgov.com/grant-details/?gid=36879</a>
Historic Preservation Fund Grant	Historic Preservation	Projects must support the survey, inventory and designation of historic properties that are associated with communities that are currently underrepresented in the National register of Historic Places and among National Historic Landmarks.	6/15/15	\$25,000 - \$75,000/project	For more information, please contact Hampton Tucker at <a href="mailto:hampton_tucker@nps.gov">hampton_tucker@nps.gov</a> or visit: <a href="http://www.grants.gov/web/grants/view-opportunity.html?oppld=275597">http://www.grants.gov/web/grants/view-opportunity.html?oppld=275597</a>
Recreational Trails Program	Parks and Recreation		7/1/15	\$1,517,643 total grant funds	For more information on this 80% match program, please visit: <a href="http://www.crt.state.la.us/louisiana-state-parks/grant-opportunities-for-outdoor-recreation/recreational-trails/index">http://www.crt.state.la.us/louisiana-state-parks/grant-opportunities-for-outdoor-recreation/recreational-trails/index</a>