

# *Transportation Innovation: The Foundation of our Future*



## **LOUISIANA TRANSPORTATION CONFERENCE**

**March 1-4, 2020**

**Raising Cane's River Center, Baton Rouge**

**[www.ltrc.lsu.edu/ltc\\_20](http://www.ltrc.lsu.edu/ltc_20)**

**VISION**

## CONFERENCE HOSTS



## THANK YOU TO OUR CONFERENCE SPONSORS

### Platinum



### Gold



C. H. Fenstermaker & Associates, L.L.C.



T. BAKER SMITH  
A CENTURY OF SOLUTIONS

### Silver



NEEL-SCHAFFER  
Solutions you can build upon



### Bronze



Special thanks goes to  
GEC, Inc., for assistance  
with the industry exhibits.



Special thanks to the following companies for sponsoring the Sunday evening Speaker Reception:

Ergon Asphalt and Emulsions ~ Highway Graphics, LLC ~ Highway Safety Systems, LLC  
Material Resources, Inc. ~ Diamond B Construction Co., LLC ~ Madden Contracting

<b>River Center Maps</b> .....	<b>2</b>
<b>Conference Information</b> .....	<b>3</b>
<b>Downtown Restaurant Map</b> .....	<b>4</b>
<b>DOTD Business Conference</b> .....	<b>5</b>
<b>Tabletop Displays</b> .....	<b>6</b>
<b>LTC Mobile and Social Media</b> .....	<b>6</b>
<b>Graduate Student Poster Presentations</b> .....	<b>7</b>
<b>Program At-a-Glance</b> .....	<b>8</b>

<b>Session Descriptions</b> .....	<b>10</b>
<b>Monday (1:00 p.m.–2:45 p.m.)</b> .....	<b>10</b>
<b>Monday (3:15 p.m.–5:00 p.m.)</b> .....	<b>12</b>
<b>Tuesday (8:00 a.m.–9:45 a.m.)</b> .....	<b>14</b>
<b>Tuesday (10:15 a.m.–12:00 p.m.)</b> .....	<b>16</b>
<b>Tuesday (1:00 p.m.–2:45 p.m.)</b> .....	<b>18</b>
<b>Tuesday (3:15 p.m.–4:15 p.m.)</b> .....	<b>21</b>
<b>Wednesday (8:00 a.m.–9:45 a.m.)</b> .....	<b>23</b>
<b>Wednesday (10:15 a.m.–12:00 p.m.)</b> .....	<b>25</b>
<b>Speaker Index</b> .....	<b>27</b>
<b>PDH Documentation Form</b> .....	<b>31</b>

## Shuttle Service

Shuttle transportation will be provided between the conference hotels and the USS Kidd for the Speaker Reception on Sunday, March 1, 2020. Please look for conference signage at the conference hotels for designated shuttle pick-up and drop off locations. Shuttle transportation will also be provided between the Raising Cane’s River Center and each of the conference hotels all days of the conference. The designated shuttle pick-up and drop-off location at the Raising Cane’s River Center is the Exhibition Hall Lobby Area. Conference signs will include transportation times and a map of the shuttle route (also printed on back inside cover of the program). Although a schedule has been arranged, shuttle times may vary slightly due to city traffic, peak periods of transport, and unexpected events. However, our goal is to provide service to the Raising Cane’s River Center and each conference hotel as quickly as possible.

*\*Please see inside back cover for a map of the shuttle route.\**

### Sunday, March 1, 2020 – Speaker’s Reception

- Shuttle bus service to pick-up from the conference hotels beginning at 5:00 p.m. to drop off at the USS Kidd.
- Speaker Reception begins at 5:30 p.m. and ends at 9:00 p.m.
- The shuttle bus service will run every 15 minutes from 5:00 p.m. until 9:15 p.m. (last shuttle bus service for the day/evening)

### Monday, March 2, 2020

#### AM Shuttle Bus Service:

- 6:30 a.m. until 9:00 a.m.
- The shuttle bus service will run every 15 minutes until 9:00 am (last shuttle bus service for the morning)

#### PM Shuttle Bus Service:

- Exhibitor reception begins at 5:00 pm and ends at 8:00 pm.
- Shuttle bus service leaves the RCRC to drop off at hotels at 5:15 pm and will run until 8:15 p.m.
- The shuttle bus service will run every 15 minutes until 8:15 p.m. (last shuttle bus service for the day/evening)

### Tuesday, March 3, 2020

#### AM Shuttle Bus Service:

- 6:30 a.m. until 9:00 a.m.
- The shuttle bus service will run every 15 minutes until 9:00 am (last shuttle bus service for the morning)

#### PM Shuttle Bus Service:

- Technical sessions end at 4:15 pm
- Shuttle bus service leaves the RCRC to drop off at hotels at 4:15 p.m. and will run until 5:30 p.m.
- The shuttle bus service will run every 15 minutes until 5:30 p.m. (last shuttle bus service for the day/evening)

### Wednesday, March 4, 2020

#### AM Shuttle Bus Service:

- 6:30 a.m. until 9:00 a.m.
- The shuttle bus service will run every 15 minutes until 9:00 am (last shuttle bus service for the morning)

#### PM Shuttle Bus Service:

- Conference ends at 12:00 p.m.
- Shuttle bus service leaves the RCRC to drop off at hotels at 12:00 p.m. and will run until 1:00 p.m. The shuttle bus service will run every 15 minutes until 1:00 p.m.

# Raising Cane's River Center Maps

## Second Floor / Level 2

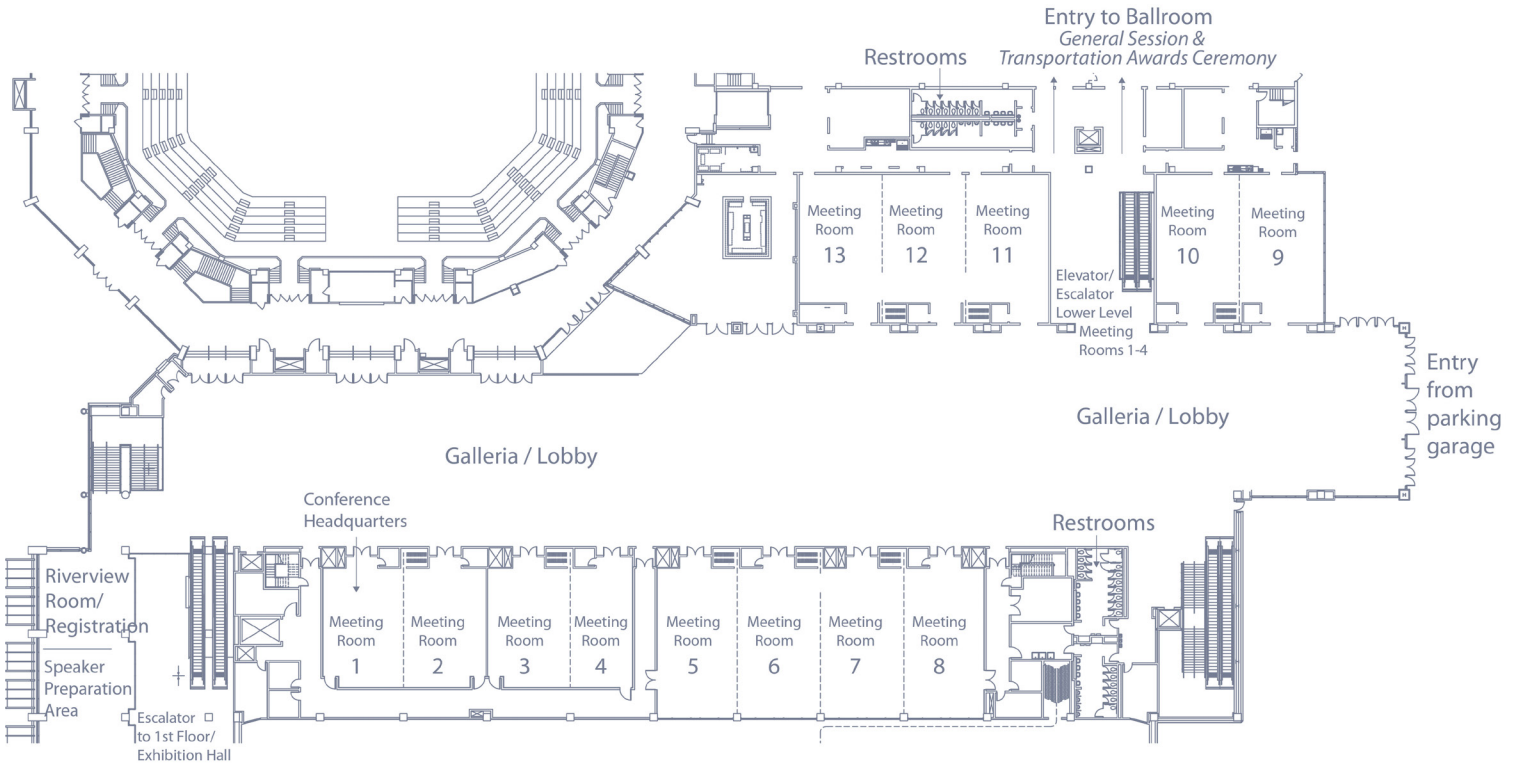

## First Floor / Lower Level Meeting Rooms 1-4

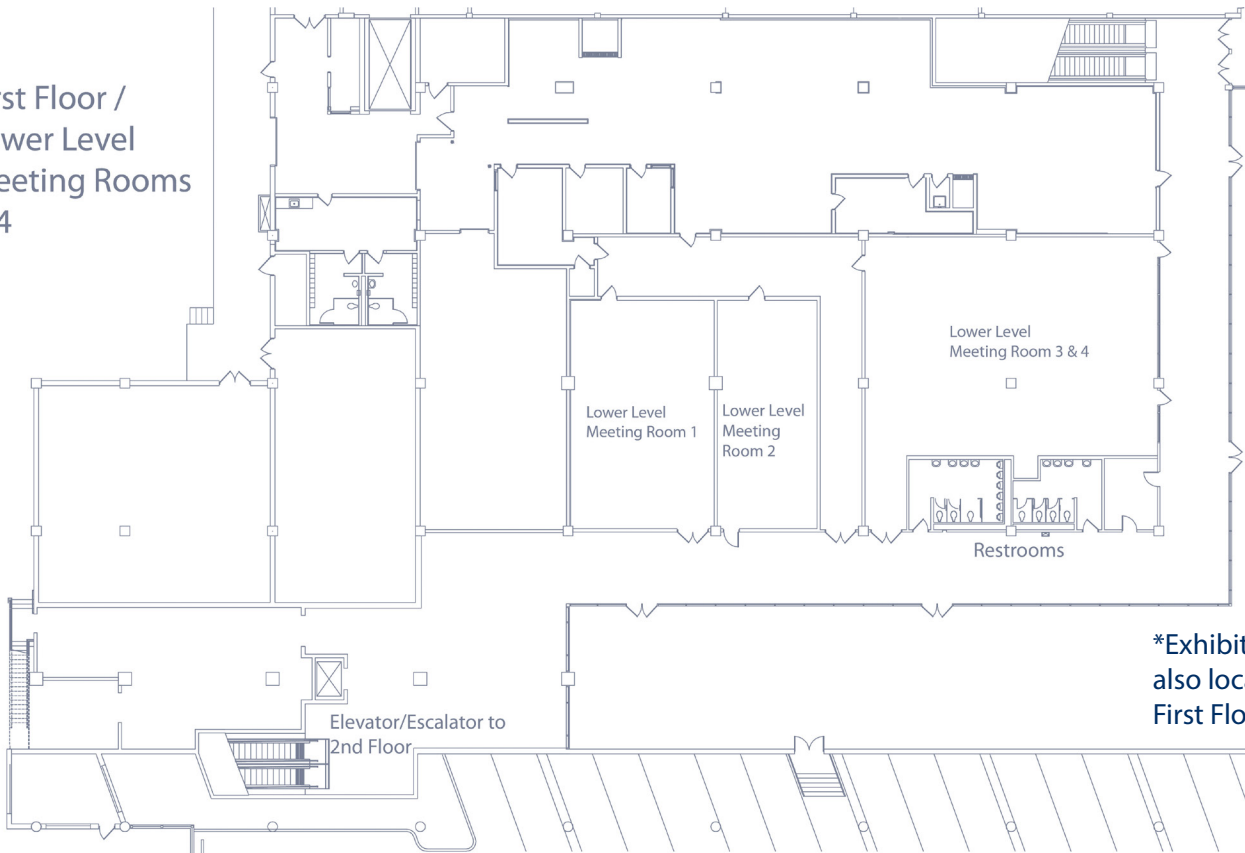

\*Exhibition Hall is also located on the First Floor/Lower Level

# Conference Information

---

## Conference Headquarters

The 2020 Louisiana Transportation Conference Headquarters is located in Meeting Room 1 on the second floor (Level 2). The Conference Headquarters will be open Sunday, 2 p.m. – 6 p.m.; Monday and Tuesday, 7 a.m. – 6 p.m.; and Wednesday, 7 a.m. – 4 p.m. If you have special needs during the conference, visit the Conference Headquarters and every effort will be made to accommodate your request.

## Downtown Dining Options

Please note that Monday and Wednesday lunches are on your own. Tuesday lunch will be provided in the Exhibition Hall.

A map of restaurants within walking distance is provided on page 4 courtesy of Visit Baton Rouge.

## Parking Procedures

- Park in either the East or West garage. Garage entrances are on St. Louis Street, north of St. Louis/Government St. intersection.
- You may enter/exit garage as often as necessary by following the procedures below.

### Procedures for Driver:

- 1—Take ticket from machine each time you enter garage.
- 2—Report to Parking Validation (Riverview Room, registration area, Level 2) to turn in ticket and receive a garage exit pass any time before departure from conference.
  - A pass is only good for that day.
  - Each time you exit the garage and return the same day, you must repeat this procedure.
- 3—Same procedures are to be followed each day/each entry.
- 4—Different colored passes are provided each day.
- 5—If you fail to exchange parking ticket for pass, you will be responsible for paying the fee—no reimbursement after the fact.
- 6—After the morning break on Wednesday (9:45-10:15 a.m.), Parking Validation will relocate from the registration area to the area outside of the ballroom on Level 2. Conference staff will be available from 10:15 a.m.–12 p.m. and again from 1:30 p.m.–2 p.m. If you have not validated your parking ticket by this time, you are responsible for the parking fee.

## Badge/Name Tag

Please remember to wear your 2020 Louisiana Transportation Conference badge/name tag at all times, as this is your admission to all events.

## PDHs for Engineers & Land Surveyors

The program provides abstract information and a schedule of sessions, including the annual engineer/land surveyor license requirement for ethics/boundary surveys. The ethics session will be offered twice (on Sunday at 4:30 p.m. and on Wednesday at 1:30 p.m.). Standards of Practice for Boundary Surveys in Louisiana will also be offered twice (on Sunday at 3:30 p.m. and on Wednesday at 2:30 p.m.).

Pages 31-32 of this program provide a detachable register to keep track of the sessions that are attended and number of PDHs that are accumulated. *Please note that LTC Conference Management does not verify PDHs; this is up to the attendee to document.*

## Industry Exhibits

Exhibits on transportation technologies/products will be displayed during the following times in the River Center Exhibition Hall (ground level):

**Monday** 2:45 p.m., Exhibit hall will open for afternoon break  
5:00 p.m. to 8:00 p.m., Industry Reception

**Tuesday** 7:00 a.m. to 3:15 p.m.

## Speaker Preparation

A laptop will be available in the registration area for speakers to use in preparation for presentations.

## Transportation Excellence Awards

An awards ceremony will be held during the General Session on Monday (8:30 a.m. - 11:30 a.m.) in the River Center Ballroom.

## Conference Evaluation & Presentations

A conference evaluation survey will be sent to you electronically after the conference. Please take a few minutes to respond to the survey, so we can gain your valuable input as we plan the next Louisiana Transportation Conference. After the conference, the presentations will be made available to all registered delegates, upon completion of the evaluation.



# DOWNTOWN BATON ROUGE RESTAURANT LIST

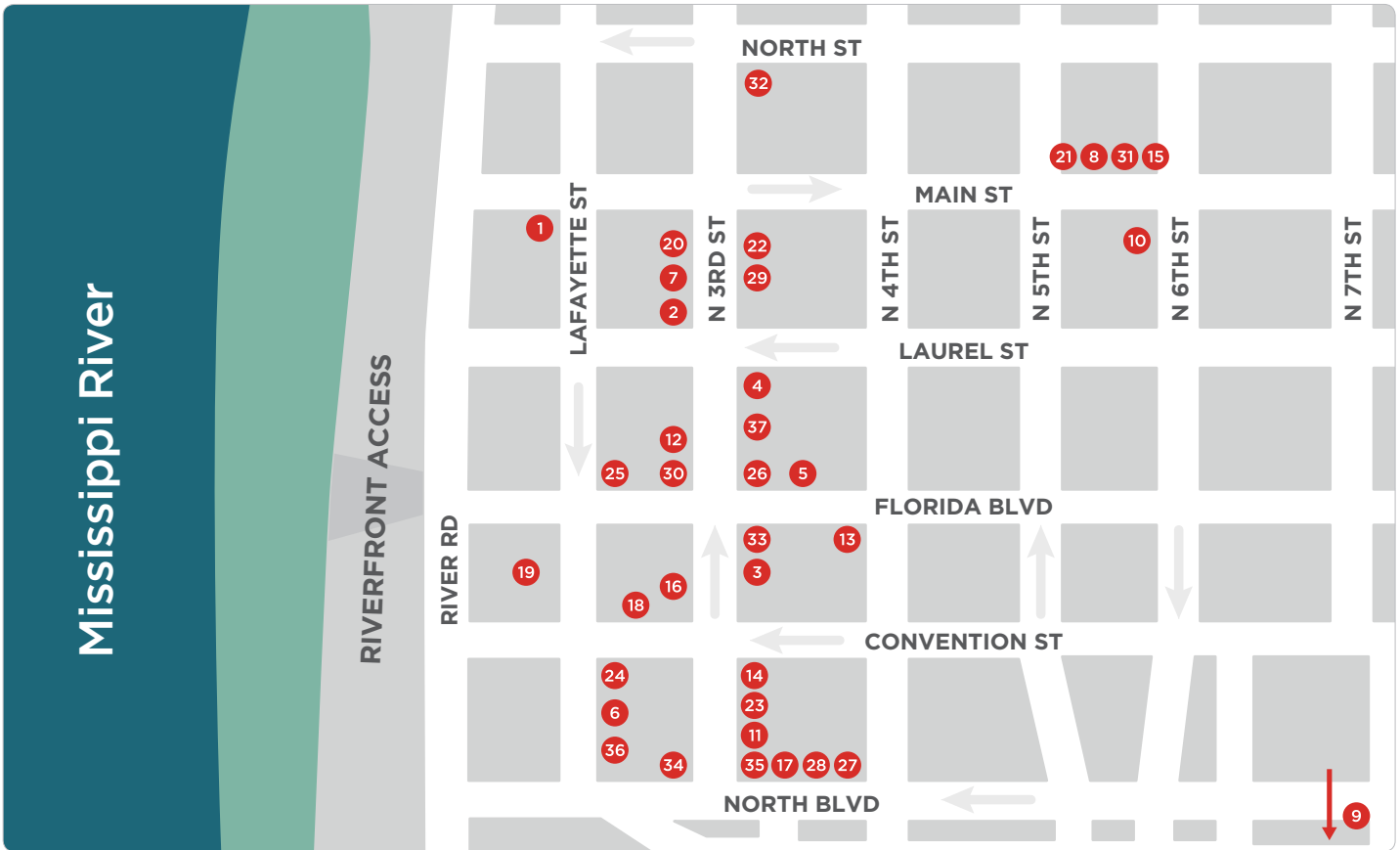

- 1 Azteca's Mexican Cuisine**  
453 Lafayette St.  
225.224.6164
- 2 Bengal Tap Room**  
421 Third St.  
225.778.5479
- 3 The Bistro**  
260 Third St.  
225.831.4646
- 4 Blend**  
304 Laurel St.  
225.757.5645
- 5 Café Mimi**  
329 Florida St.  
225.343.2626
- 6 Capital City Grill**  
100 Lafayette St.  
225.381.8140
- 7 Cecelia Creole Bistro**  
421 N Third St.  
225.615.7833
- 8 Chow Main**  
501 Main St.  
225.330.4813
- 9 Christina's**  
320 St. Charles St.  
225.336.9512
- 10 Cocha**  
445 N 6th St.  
225.615.8826
- 11 Downtown Seafood**  
130 Third St.  
225.346.3006
- 12 Faye's Subs and Salads**  
311 Third St.  
225.343.0283
- 13 Fresh Bowls**  
340 Florida St.  
225.337.3453
- 14 The Gregory**  
150 Third St.  
225.408.1800
- 15 Jambalaya Shoppe**  
549 Main St.  
225.387.3022
- 16 Jimmy John's**  
201 Third St.  
225.379.8500
- 17 Jolie Pearl Oyster Bar**  
315 North Blvd.  
225.615.7172
- 18 King Bar and Bistro**  
200 Convention Str.  
225.343.1515
- 19 Kingfish Grill**  
201 Lafayette St.  
225.344.5866
- 20 The Little Village**  
447 Third St.  
225.218.6685
- 21 Main Street Market**  
Chef Celese's Bistro  
Fresh Junkie  
Go Ya Ya's Crêperie  
Paul Wong's Chinese & Sushi  
501 Main St.  
225.267.5060
- 22 Matherne's**  
440 N Third St.  
225.343.0600
- 23 Milford's on 3rd**  
150 Third St.  
225.408.2600
- 24 PJ's Coffee Shop**  
100 Lafayette St.  
225.381.005
- 25 Poor Boy Lloyd's**  
201 Florida St.  
225.387.2271
- 26 Raising Cane's**  
302 Third St.  
225.332.4887
- 27 Roly Poly**  
327 North Blvd.  
225.412.4234
- 28 Sadaf Café**  
321 North Blvd.  
225.344.0090
- 29 Salad Station**  
333 Laurel St.  
225.930.8088
- 30 Schlitz and Giggles**  
301 Third St.  
225.218.4271
- 31 Serops Express**  
535 Main St.  
225.338.1211
- 32 Smoothie King**  
301 Main St.  
225.341.3101
- 33 Starbucks**  
260 Third St.  
225.831.4646
- 34 Stroubes Seafood and Steaks**  
107 Third St.  
225.448.2830
- 35 Subway**  
301 North Blvd.  
225.343.9444
- 36 Tsunami**  
100 Lafayette St.  
225.346.5100
- 37 T&T Cafe**  
320 Third St.  
225.300.3881



# DOTD Business Conference

---

The DOTD Business Conference will be held in conjunction with the LTC on **Tuesday, March 3.**

The Business Conference activities will all take place in Lower Level Meeting Rooms 3 & 4.

## 8:00 a.m. - 9:45 a.m.

*Welcome and Introductions*, Undersecretary Barry Keeling (Opening Remarks) / Don Johnson (Moderator)

*Enterprise Support Services*, Brad Doucet

- Records Management Improvements
- Decision Support Services

*Human Resources*, Susan Pellegrin

- DOTD Policy Updates
- DOTD S.A.M.E. Plan Update

## 9:45 a.m. - 10:15 a.m. Break

## 10:15 a.m. - 12:00 p.m.

*Information Technology*, Mark Meng

- OTS General Consolidation Updates
- Migration to OTS Lines of Service
- Upgrade to Windows 10

*Audit*, Mark St. Cyr

- Audit Issues/Opportunities – LLA
- Inventory Results
- Current Year Audit Plan

## 12:00 p.m. - 1:00 p.m. Lunch

## 1:00 p.m. - 2:45 p.m.

*Budget*, Barbara Aguiard

- Navigating the Carry Forward Process
- Completing the Budget Request Forms
- Funding for Future Request

*Procurement*, Julie Kennison

- Equipment Repairs, Adrian Stallone
- Forms Update, Tiffany Lambert
- Safety Contracts Update, Angel Smith

*Financial Services*, Lesha Woods

- Year-End Close Procedures  
~June 30  
~August 14

## 2:45 p.m. - 3:15 p.m. Break

## 3:15 p.m. - 5:00 p.m.

*Panel Discussion*

- Financial Services
- Budget
- Audit
- Procurement
- Human Resources
- Office of Technology Services
- Enterprise Support Services

*Wrap-Up and Adjournment*



**The Louisiana Department of Transportation and Development  
congratulates the Transportation Research Board on 100 years of service.**

**Please visit the TRB Centennial Roaming Exhibit  
during the industry exhibit hours.**

# Tabletop Displays

Visit the following groups on Tuesday, March 3, from 9:45 a.m. - 4:00 p.m. in the Exhibition Hall Lobby Area.

## Office of Multimodal Commerce

The Office of Multimodal Commerce display will feature staff members from each division answering questions and distributing educational materials.

## Louisiana Local Technical Assistance Program

The Louisiana Local Technical Assistance Program (LTAP) provides training and technical assistance to local public works and transportation agencies across the State. LTAP also administers the Local Road Safety Program and can assist you with crash data analysis, project applications, and field reviews. LTAP is part of the national network of LTAP centers that serve local agencies with training resources, technical information, and innovative solutions that can help you solve your infrastructure issues. Come by our booth and let's discuss your staff training and technical needs for 2020 and beyond!

## Compliance Programs

The Compliance Programs Office will provide information relative to the federal programs we administer: Disadvantaged Business Enterprise Program, Small Business Enterprise Program, Title VI, Labor Compliance, and On-the Job Training.

## Road Design

Visit DOTD's Road Design Section display to see the latest innovations in roadway design, sample in-house design projects, and meet some of the section's design staff.

## Highway Safety

Louisiana is driving towards Destination Zero Deaths, with the Strategic Highway Safety Plan (SHSP) as its vehicle to reduce motor vehicle-related fatalities and serious injuries. Stop by our booth today for a few hands-on activities and to learn more about the amazing efforts that are happening in our state.

# Let's Stay Connected!

## River Center Wi-Fi

LTC Attendees may access wi-fi with the following credentials:  
Network name: LTC\_Guest  
Password: latc2020

## LTC Social Media

Follow Louisiana Transportation Research Center on Facebook ([www.facebook.com/LTRCUpdates](http://www.facebook.com/LTRCUpdates)) or Twitter (@LTRC\_Updates). We will be using #LTC2020 for real-time conference news and photos.

## LTC Mobile

Visit our mobile-friendly site [www.ltrc.lsu.edu/ltc\\_20](http://www.ltrc.lsu.edu/ltc_20) on your device to easily access the conference schedule, exhibitor lists, sponsors, and other information via the collapsible menu.

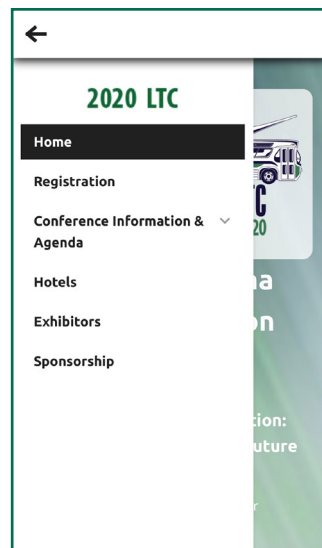



# Poster Presentations

Visit the following graduate student projects in the Galleria on Tuesday, March 3, 1:00-4:15 p.m.

## **Variability and Uncertainty in Data and Results of Hamburg Wheel-Tracking Testing of Asphalt Mixtures**

*Ilerioluwa Giwa and Husam Sadek, Louisiana State University*

## **Evaluating the Performance of Asphalt Mixtures Containing High RAP Content with the Use of Different WMA Technologies**

*Farah Zaremotekhas, Husam Sadek, Marwa Hassan, and Charles Berryman, Louisiana State University*

*Mohammad I. Hossain, Bradley University*

## **An Approach to Counting Vehicles from Pre-recorded Video Using Computer Algorithms**

*Mishuk Majumder and Chester G. Wilmot, Louisiana State University*

## **Laws and Safety Impacts of Operating Golf Carts on Public Roads**

*Hilda Ofori-Addo and Elisabeta Mitran, University of Louisiana at Lafayette*

## **Climatic Influence on Structural Behavior of Pavement on Expansive Subgrade Soils**

*Debojit Sarker and Jay X. Wang, Louisiana Tech University*

## **Capacity and Performance Analysis of Louisiana Roundabouts**

*Sam-Mark Ansah A., University of Louisiana at Lafayette*

## **Evaluation of Asphalt Mixtures Resistance to Cement-Treated Base Reflective Cracking in the Laboratory**

*Ipshit I. Idris, Husam Sadek, Marwa Hassan, and Charles Berryman, Louisiana State University*

*Mohammad I. Hossain, Bradley University*

## **Field Performance Evaluation of Low Cement Content Soil-Cement Base for Reflective Crack Mitigation**

*Mohammad Reza-Ul-Karim Bhuyan and Mohammad Jamal Khattak, University of Louisiana at Lafayette*

## **Sustainable Lignin to Enhance Asphalt Binder Oxidative Aging Properties and Mix Properties**

*Shams Arafata, Narendra Kumarb, Nazimuddin M. Wasiuddin, Ekugbere O. Owheb, and Joan G. Lynamb, Louisiana Tech University*

## **Development of Roller Compacted Geopolymer Concrete Using Recycled Concrete Aggregate**

*Sk Syfur Rahman and Mohammad Jamal Khattak, University of Louisiana at Lafayette*

## **Trend Analysis of Lane Departure Crashes in Louisiana State, USA**

*Ahmed Hossain and Xiaoduan Sun, University of Louisiana at Lafayette*

## **Contextual Adjustment of the ITE Trip Generation Rates Using Wi-Fi and Bluetooth Technologies**

*Saba Doulabi and Chester Wilmot, Louisiana State University*

*Peter Stopher, Arizona State University*

*Angela Antipova, University of Memphis*

## **Development of a Real-Time Drainage Monitoring System Case Study**

*Murat Tanil, Norma Jean Mattei, and Gianna Cothren, University of New Orleans*

## **Estimating Roadway Departure Probability Using Pre-Crash Contributing Factors on Louisiana Rural Two-lane Highways**

*M. Ashifur Rahman, Xiaoduan Sun, and Sushmita Khanal, University of Louisiana at Lafayette*

*Subasish Das, Texas Transportation Institute*

## **Young Driver Crash Contributing Factors: A Comparative Analysis of Three Age Groups**

*Md. Mahmud Hossain, M. Ashifur Rahman, Xiaoduan Sun, and Elisabeta Mitran, University of Louisiana at Lafayette*

## **Overheight Smart Impact Detection/Alert System**

*Suvash Chapain, Aly Mousaad Aly, George Voyiadjis, Jin-Woo Choi, Pedro Chacon, and Hamzeh Gol Zaroudi, Louisiana State University*

## **Safety Performance Functions for Rural Two-Way Stop-Controlled Intersections**

*Ming Sun, Xiaoduan Sun, M. Ashifur Rahman, and Mousumy Akter, University of Louisiana at Lafayette*

## **Generation and Evaluation of Synthetic CPT Data Using Various Spatial Interpolation Techniques**

*Md. Habibur Rahman and Murad Y. Abu-Farsakh, Louisiana State University*

# Program At-A-Glance

## Sunday, March 1

### 2:00 p.m.–5:00 p.m.

Conference Registration, *River Center Riverview Room*

### 3:30 p.m.–4:30 p.m.

Standards of Practice for Boundary Surveys in Louisiana,  
*River Center Meeting Rooms 9, 10*

### 4:30 p.m.–5:30 p.m.

Professionalism and Ethics for Engineers and Land Surveyors,  
*River Center Meeting Rooms 11, 12, 13*

## Monday, March 2

### 7:00 a.m.–5:00 p.m.

Conference Registration, *River Center Riverview Room*

### 7:00 a.m.–8:15 a.m.

Continental Breakfast, *River Center Galleria*

### 7:00 a.m.–8:15 a.m.

Secretary's Breakfast, *River Center Meeting Rooms 7 & 8*  
**BY INVITATION ONLY**

### 8:30 a.m.–11:30 a.m.

General Session and Transportation Awards Ceremony,  
*River Center Ballroom*

### 11:30 a.m.–1:00 p.m. | Lunch (on your own)

### 1:00 p.m.–2:45 p.m.

Concurrent Sessions, *River Center*

1: *Tolling: Where Are We Going?* (Room 2)

2: *3D Design and Project Delivery* (Room 3-4)

3: *Concrete 1* (Room 5-6)

4: *Bridge Design Policies and Procedures* (Room 7-8)

5: *Amite River Numerical Model* (Room 9)

6: *Live from Baton Rouge, It's the Materials Lab* (Room 10)

7: *The Wondrous World of Highway Safety* (Room 11)

8: *FHWA Innovation Highlights* (Room 12)

9: *Management Systems Updates* (Room 13)

10: *District Emergency Projects* (Lower Level Meeting Room 1)

### 2:45 p.m.–3:15 p.m. | Break, River Center Exhibition Hall

Exhibits open at 2:45 p.m.

### 3:15 p.m.–5:00 p.m.

Concurrent Sessions, *River Center*

11: *Innovative Ways of Multimodal Commerce* (Room 2)

12: *Design Developments* (Room 3-4)

13: *Concrete 2* (Room 5-6)

14: *Bridge Load Rating and Evaluation* (Room 7-8)

15: *Pavement Technologies and Safety* (Room 9)

16: *Innovative Materials Testing* (Room 10)

17: *Innovations Showcase* (Room 11)

18: *Environmental* (Room 12)

19: *DOTD's System of Engagement (SoE)* (Room 13)

20: *Designing for Pedestrians and Bicyclists with Safety in Mind* (Lower Level Meeting Room 1)

### 5:00 p.m.–8:00 p.m.

Industry Exhibits/Reception, *River Center Exhibition Hall*

## Tuesday, March 3

### 7:00 a.m.–5:00 p.m.

Conference Registration, *River Center Riverview Room*

### 7:00 a.m.–8:00 a.m.

Continental Breakfast, *River Center Exhibition Hall*

### 7:00 a.m.–3:15 p.m.

Industry Exhibits, *River Center Exhibition Hall*

### 8:00 a.m.–9:45 a.m.

Concurrent Sessions, *River Center*

21: *Student Presentations / Awards* (Room 2)

22: *NexGen 911: The Crossroads of Transportation and Telecommunications in Our Near Future* (Room 3-4)

23: *Alternative Delivery Methods: Mega Projects* (Room 5-6)

24: *Bridge Funding Programs and Project Selection* (Room 7-8)

25: *Advanced Geotechnical Exploration Methods (A-GaME)* (Room 9)

26: *E-Construction Initiative (Materials)* (Room 10)

27: *Expanding the Safety Analysis Tool Box* (Room 11)

28: *Technology is the Future of ITS and the Future is NOW* (Room 12)

29: *The Centroid for Enterprise GIS* (Room 13)

30: *ROW Permits, Joint Use Agreements, Utility Relocations, and Innovations in SUE* (Lower Level Meeting Room 1)

### 9:45 a.m.–10:15 a.m. | Break, River Center Exhibition Hall

### 9:45 a.m.–4:00 p.m.

Tabletop Displays, *River Center Exhibition Hall Lobby Area*

### 10:15 a.m.–12:00 p.m.

Concurrent Sessions, *River Center*

31: *Local Public Agencies* (Room 2)

32: *Dispatches from the Front Line of Alternative Delivery and the Future of Transportation Funding* (Room 3-4)

33: *Smart Travel Choices Using Real-Time Traffic Information* (Room 5-6)

34: *Nationwide Bridge Projects, Best Practices, and Research* (Room 7-8)

35: *Geotechnical State of Practice and Research* (Room 9)

36: *E-Construction Initiative (Construction)* (Room 10)

37: *Advancements in Safety Analysis* (Room 11)

38: *Sunshine Bridge Incident: the Impact on Local Emergency Response* (Room 12)

39: *Maintaining Data Sources for Enterprise GIS (Room 13)*

40: *Innovations in Railroad Crossing Safety (Lower Level Meeting Room 1)*

**12:00 p.m.–1:00 p.m.**

Lunch, *River Center Exhibition Hall (lunch provided)*

**1:00 p.m.–4:15 p.m.**

Graduate Student Poster Presentations, *River Center Galleria*

**1:00 p.m.–2:45 p.m.**

Concurrent Sessions, *River Center*

41: *Innovative Infrastructure Funding Solutions (Room 2)*

42: *Swamp Tank: Up to Our Ears in Alligators (Room 3-4)*

43: *Partnering Between DOTD and the Consultant Community (Panel Discussion) (Room 5-6)*

44: *Bridge Rehab and Construction/Operations Support (Room 7-8)*

45: *Construction (Room 9)*

46: *Pavement Preservation Programs (Room 10)*

47: *DOTD Cost Recovery Issues and Emergency Response (Room 11)*

48: *ITS Operations – Traffic Incident Management (Room 12)*

49: *Understanding the Economic Benefits of Public Investment in Transportation Infrastructure (Room 13)*

50: *ADA and Title VI (Lower Level Meeting Room 1)*

**2:45 p.m.–3:15 p.m. | Break, River Center Exhibition Hall**

**3:15 p.m.–4:15 p.m.**

Concurrent Sessions, *River Center*

51: *Compliance (Panel Discussion) (Room 2)*

52: *Swamp Tank: Digging Out of the Swamp (Room 3-4)*

53: *Right of Way (Room 5-6)*

54: *Bridge Projects (Widening and Replacement) (Room 7-8)*

55: *I-10 Baton Rouge Corridor Improvements (Room 9)*

56: *EDC Initiative: Collaborative Hydraulics: Advancing to the Next Generation of Engineering (Room 10)*

57: *Off the Pavement (Room 11)*

58: *National Public Transportation Safety Program (Panel Discussion) (Room 12)*

59: *Addressing Distracted Driving (Room 13)*

60: *Multimodal Economic Development (Lower Level Meeting Room 1)*

**Wednesday, March 4**

**7:00 a.m.–8:00 a.m.**

Continental Breakfast, *River Center Galleria*

**8:00 a.m.–9:45 a.m.**

Concurrent Sessions, *River Center*

61: *The Future of Multimodal Transportation (Room 2)*

62: *Roadway Design, Coordination, and Project Delivery (Room 3-4)*

63: *Consultant Contract and Construction Contract Updates (Room 5-6)*

64: *Movable Bridges/Lighting Program (Room 7-8)*

65: *Pavement Research and Implementation (Room 9)*

66: *Bridge Maintenance (Room 10)*

67: *Sunshine Bridge – District Operations Response (Room 11)*

68: *Improving Safety in Workzones (Room 12)*

69: *Louisiana Asphalt Pavement Association 1 – Pavement Preservation (Room 13)*

70: *Funding Sustainability and the TTF (Lower Level Meeting Room 1)*

**9:45 a.m.–10:15 a.m. | Break, River Center Galleria**

**10:15 a.m.–12:00 p.m.**

Concurrent Sessions, *River Center*

71: *Metropolitan Planning Organizations (Room 2)*

72: *Innovative Intersection Design (Room 3-4)*

73: *Traffic Engineering Policies and Procedures (Room 5-6)*

74: *Sunshine Bridge Emergency Repair (Room 7-8)*

75: *LTAP Cornucopia! Going Local (Room 9)*

76: *Contract Administration of Local Public Agency Projects (Room 10)*

77: *From Private to Public Sectors, LiDAR Scanning is Revolutionizing the Land Surveying Industry! (Room 11)*

78: *Legal Panel Discussion (Room 12)*

79: *Louisiana Asphalt Pavement Association 2 – PAVExpress (Room 13)*

80: *New Records Management Processes (Lower Level Meeting Room 1)*

**12:00 p.m.–1:30 p.m. | Lunch (on your own)**

**1:30 p.m.–2:30 p.m.**

Professionalism and Ethics for Engineers and Land Surveyors, *River Center Meeting Rooms 11, 12, 13*

**2:30 p.m.–3:30 p.m.**

Standards of Practice for Boundary Surveys in Louisiana, *River Center Meeting Rooms 9, 10*

# Session Descriptions

---

The following pages contain concurrent session titles, a session description, titles of presentations, and names of presenters. A copy of the presentations will be available on the LTRC website after the conference.

**[MONDAY 1:00 p.m.–2:45 p.m.]**

## Session 1: Tolling: Where Are We Going?

*Moderator: Scott Rundell*

*Meeting Room 2*

The state of Louisiana is always looking to viable alternatives for improving traffic and to generate necessary funding dollars for road and bridges. Tolling is now being considered for new road and bridge construction projects moving forward in the state. However, tolling encompasses more than a way to fund a road or bridge. It is connected mobility that can be incorporated into many aspects of transportation. Join us as we change the image of tolling and unlock the potential of connected mobility.

### Unlocking the Potential of Connected Mobility

*Jeff Adler, KAPSH*

### Changing the Image of Tolling

*Neal Belitsky, American Roads*

## Session 2: 3D Design and Project Delivery

*Moderator: Ryan Felder*

*Meeting Rooms 3-4*

Advancing technology is changing the way transportation projects are designed and delivered. OpenRoads is the future for DOTD, which will lead to models that are more accurate for 3D Design and Construction. This session will give you a glimpse into the latest 3D Design, 3D Deliverables, and how DOTD is transitioning to 3D Design and Digital Plans Delivery. Industry representatives will give an overview on DOTD's transition to the latest software and CADD platforms. Utah DOT will highlight their 3D design and delivery process. During this session, they will deliver part 1 of their presentation, which will explore the approaches to design methodology, file publishing, legal documents and For Information Only (FIO) documents and the challenges/successes UDOT has had. A brief look at moving from innovative contracting (CMGC - Construction Manager/General Contractor aka CMAR) on projects of increasing complexity with plan sets FIO to bid build with plan sets FIO to projects that were awarded without cutting sheets.

## Bentley OpenRoads

*Mo Harmon, Bentley*

### Transitioning to the New CADD Platform

*Mark Ditko, Knowledge-Based Consulting*

### 3D Design Model as the Legal Document (Part 1)

*George Lukes, Utah DOT*

## Session 3: Concrete 1

*Moderator: Mitchell Wyble*

*Meeting Rooms 5-6*

Roller compacted concrete (RCC) is a zero slump mix designed to carry the heaviest loads, and as such it has become a favorite pavement type at loading yards and truck stops. LTRC conducted accelerated loading tests to determine just how much load RCC is capable of carrying when placed in thinner sections. Following the favorable experiment, the Lafayette Consolidated Government initiated construction of RCC on three streets in an industrial area of Lafayette. The results of the construction and testing are presented in this session. Cement is the ingredient that makes concrete strong but substituting other materials for some of the cement can actually improve the performance of the concrete. What are these materials and how to responsibly use them? After building seven bonded concrete overlays around the state, Louisiana is searching for a rational design method that takes into consideration existing conditions. The presentation describes how engineers built three thicknesses of bonded concrete overlay over asphalt and loaded them to failure to obtain the needed design information.

### RCC Use for Medium and Low-Volume Roadways: Results from LTRC's Pavement Research Facility

*Tyson Rupnow, DOTD/LTRC*

### Roller Compacted Concrete Implementation in Lafayette, LA

*David VanFleet, RollCon, LLC*

### Benefits of Substitute Cementitious Materials

*Craig Wallace, Boral Resources*

### Thin Concrete Overlay Bonded to Asphalt Under Accelerated Loading

*Zhong Wu, LTRC/LSU*

## Session 4: Bridge Design Policies and Procedures

*Moderator: Anthony Bamugo*

*Meeting Rooms 7-8*

Over the past few years, significant changes, revisions, and new versions of various Bridge Design standards and policies have been released. Within this session, presentations will be made that describe and explain these changes and how they might affect future projects.

## Domestic Scans: Joints and Bearings

Kelly Kemp, DOTD

## Domestic Scans: Hydro Demolition

Paul Vaught, DOTD

## Domestic Scans: Bridge Scour

Stephanie Doolittle, DOTD

## Cleaning and Painting Existing Bridges

Kelly Kemp, DOTD

## MASH Implementation

Kurt Brauner, DOTD

## Evaluating DOTD's New Deck Continuity Detail for Girder Bridges

Ayman Okeil, LSU

## Session 5: Amite River Numerical Model

Moderator: Jerri Daniels

Meeting Room 9

In August 2016, the Amite River Basin was subjected to record flooding as a result of a major rainfall event that affected a large portion of Louisiana. Recognizing the need to better understand causes of flooding throughout the state, DOTD championed the need for updated modelling of the hydrology and hydraulics of the state. The Amite River Basin was chosen for the development of a pilot model of the entire watershed. Dewberry Engineers, Inc. developed and calibrated a state-of-the-art combined 1D/2D model of the watershed using the US Army Corps of Engineers HEC suite of products. This session will present the model and describe its potential use in the evaluation of proposed projects.

### Hydraulic Model

Sam Crampton, Dewberry

### Potential Project Evaluation

Jerri Daniels, Dewberry

## Session 6: Live from Baton Rouge, It's the Materials Lab

Moderator: Jason Davis

Meeting Room 10

The Materials Lab has had many procedural changes over the last couple of years from sampling methods and testing procedures to rating systems and environmental controls. Many of these changes will be highlighted in this session.

### Cementitious

Justin Morris, DOTD | Brandon Johnson, DOTD

### Aggregates

Michael Grubb, DOTD | Khalil Hanifa, DOTD

### Paint

Francisco Gudiel, DOTD

### Chemical

David Caillet, DOTD

### Asphalt Binder

Daniel Huggins, DOTD

### Environmental

Joubert Harris, DOTD

## Session 7: The Wondrous World of Highway Safety

Moderator: Adriane McRae

Meeting Room 11

The wondrous world of highway safety always begins with data. How do we process and analyze the data? What do we do with the data? What can we produce with the data? How does this drive our SHSP and HSIP? Join us for this session as we help answer these intriguing questions.

### 2018 Crash Data Overview by SHSP Emphasis Area

David Whitchurch, LSU/Center for Analytics & Research in Transportation Safety

### Districtwide Safety Investment Plans

Ben Boudreaux, DOTD and Case Fulcher, Neel-Schaffer

### Louisiana Roadway Departure Implementation Plan

Trey Jesclard, DOTD and Betsey Tramonte, FHWA

## Session 8: FHWA Innovation Highlights

Moderator: Laura Phillips

Meeting Room 12

The Federal Highway Administration partners with the DOTD to champion innovations in roadway planning, design, construction, and management. The first four speakers will highlight innovative practices from FHWA's Every Day Counts program: (1) a place-based transportation project development initiative using multimodal improvements and revitalization efforts to connect or reconnect communities; (2) improved geotechnical site characterizations that mitigate risk; (3) the DOTD pilot project employing Headlight, a paperless technology to manage inspection documents; and (4) the DOTD pilot project studying active performance management of traffic signals using high-resolution data. The final speaker will introduce the USDOT's latest policy on automated vehicles, released in 2018.

### Community Connections

James Garland, FHWA

### Advanced Geotechnical Exploration Methods

Chris Nickel, DOTD

### e-Construction: Electronic Inspection Documentation

Matt Jones, DOTD

### Automated Traffic Signal Performance Measures

Jody Colvin, DOTD

### Preparing for the Future of Transportation: Automated Vehicles 4.0

John Broemmelsiek, FHWA

## Session 9: Management Systems Updates

Moderator: Jason Chapman

Meeting Room 13

Provisions enacted in the Moving Ahead for Progress in the 21st Century Act (MAP-21) require state DOTs to develop and implement a risk-based asset management plan, to achieve and sustain a state of good repair over the life cycle of the assets, and to improve or preserve the condition of the National Highway System (NHS). This

session will review DOTD's process used to develop the Transportation Asset Management Plan (TAMP) and its certification by FHWA. Discover procedures developed for the submission of pavement distress measures when roughness values are not available, by making use of existing data to calculate a Present Serviceability Rating (PSR). DOTD bridge management is in the process of configuring a Scour Mitigation Program by evaluating Scour Critical Ratings and Assessments.

### Calculating PSR for HPMS from Federal Distress Measures

*Chris Fillastre, DOTD*

### Optimizing for a Scour Mitigation Program

*Ray Elhami, DOTD*

### Overview of DOTD TAMP Certification

*Randy Goodman, DOTD*

## Session 10: District Emergency Projects

*Moderator: Josh Stutes*

*Lower Level Meeting Room 1*

DOTD's infrastructure is aging, and it doesn't always give any warning signs when structures are about to fail. Structural and subsurface failures often result in immediate impacts to traffic and must be addressed with a sense of emergency. The scope of work needed to address these types of projects typically requires more resources than district maintenance crews can offer. This work requires quickly designed sets of plans and expedited bidding procedures in order to get the repair started as quickly as possible.

### US 190 Pump Station Rehab

*M. Todd Donmyer, DOTD*

### Various Remedies for Cross Drain Failures

*Sarah Brocato and Codi Neyland, DOTD*

### Emergency Replacement of Precast Bridges

*Josh Bedgood, DOTD*

### LA 1 Intracoastal Canal Bridge Hit

*Chad Roubique, DOTD*

**[MONDAY 3:15 p.m.–5:00 p.m.]**

## Session 11: Innovative Ways of Multimodal Commerce

*Moderator: Tina Wilson*

*Meeting Room 2*

Ingenious! Avant-Garde! Multimodal Commerce leads the way with dredges, relocation, trucks, and airports.

- Not taking "NO" for the answer. The new specialty-built dredge design is a game changer. This presentation will address this new design and updates in the dredging industry.
- Alternative routes and their features are being studied for the relocation of the New Orleans Gulf Coast Railroad track from its

current location along LA-23 through downtown Gretna to a location around the city.

- Chassis is the key! This session will address the implications of the Standard International Chassis on global and domestic trade in key economic sectors and an aging transportation infrastructure.
- Hear how airports connect to their communities as economic drivers and key components within the transportation system.

### Thinking Outside the Box

*Mac Wade, Port of Morgan City*

### LA-23 Rail Relocation Project

*Kevin Keller, HDR, Inc.*

### Chassis: The Unsung Linchpin in the Global Supply Chain

*Bethany Stich, University of New Orleans*

### Airports Connecting to the Community

*Kevin Melton, Chennault International Airport*

## Session 12: Design Developments

*Moderator: Brian May*

*Meeting Room 3-4*

UDOT has awarded multiple projects without cutting sheets. During part 2 of their presentation, UDOT will highlight several project examples, which were awarded with the model as the Legal Document (MALD). Although plan sets were provided as For Information Only (FIO), DOT field crews and contractors ultimately relied on rovers and mobile devices in the field. This presentation will very briefly look at the design progression but will focus on the tools used in the field and how those tools have evolved. Closing out the session, Missouri DOT's Assistant Chief Counsel returns to Louisiana to discuss practical design considerations, from the Middle Ages to our modern highways. Practical design is about accountability, and is the natural evolution for highway departments and public servants. Accountability leads to better decisions that can be justified, explained, and documented. Those types of decisions decrease, not increase tort liability.

### 3D Design Model as the Legal Document (Part 2)

*George Lukes, Utah DOT*

### Accountability, Public Policy, and Tort Liability

*Jay Smith, Missouri DOT*

## Session 13: Concrete 2

*Moderator: Chris Abadie*

*Meeting Room 5-6*

Internal curing of bridge decks is intended to eliminate shrinkage cracking that has been characteristic of this type of construction. The presentation will cover whether internal curing has worked in Louisiana, what are the best ways to utilize this technology, and what are some case studies that show the benefits?

Reinforced concrete has traditionally utilized reinforcement bars and wire mesh. Increasingly various types of fibers are being used as a replacement for bars and mesh. Once introduced into the concrete,

the fibers provide a 360 degree level of coverage to protect against cracking no matter the point of origin. The presentation describes different types of fibers and how best to use them.

Bendable concrete is a concept for a high flexural strength concrete that can significantly bend before breaking under load. The presentation describes how it is designed, how it is mixed and placed, and how practical it can be in terms of performance and cost.

### **Internal Curing of Bridge Decks (component highlighting Lafayette projects)**

*Jeff Speck, Arcosa Lightweight*

#### **Fiber Reinforcement**

*Brian Wright, Sika Corporation*

#### **Bendable Concrete (ECC)**

*Gabriel Arce, LSU*

## **Session 14: Bridge Load Rating and Evaluation**

*Moderator: Ryan Owens*

*Meeting Room 7-8*

---

As the nation's infrastructure ages and highway transportation demands continue to increase, it is imperative that states monitor and evaluate the condition and structural capacity of existing highway structures. This session features presentations on new methods and technologies being developed and implemented to better assess the existing bridge inventory.

### **National Bridge Inspection Program (NBIP) Metric #13 - Load Rating**

*Dana Feng, DOTD*

#### **LaGeaux Overweight Truck Permitting**

*William Metcalf and Qiming Chen, DOTD*

#### **Culvert Load Ratings**

*Qiming Chen, DOTD; Amir Botros, SDR; and Joey Coco, Forte and Tablada*

#### **Critical Findings and Advanced Load Rating: Refined Analysis**

*Stacey Carr, Modjeski and Masters*

#### **Critical Findings and Advanced Load Rating: Load Testing**

*John Liang, SDR*

## **Session 15: Pavement Technologies and Safety**

*Moderator: James Ball*

*Meeting Room 9*

---

This session is designed to share information on new methods and technologies that are used to improve pavement designs.

### **Research and Implementation of Pavement ME in Louisiana**

*Xingwei Chen, DOTD and Zhong Wu, LTRC/LSU*

#### **Pavement Management 2020: Technology and Trends**

*Carl Rascoe, Rutgers University (Retired)*

#### **HFST and Friction Testing on Curves as Part of Our Ongoing EDC Roadway Departure Initiative**

*Andy Mergenmeier, FHWA*

## **Session 16: Innovative Materials Testing**

*Moderator: Richie Charoenpap*

*Meeting Room 10*

---

Material testing has been done for ages; however, with newer innovations and equipment, engineers and technicians are able to test materials more quickly and efficiently. This session will highlight (1) maturity testing—non-destructive estimation of concrete compression strength, (2) Non-Nuclear Density Gauge—insitu density testing on asphalt pavements, and (3) Gel Permeation Chromatography—a new look at asphalt molecular structure for characterization

### **Concrete Maturity**

*Mark Cheek, The Beta Group*

#### **Non-Nuclear Density Testing on Asphalt**

*Saman Salari, DOTD*

#### **Gel Permeation Chromatography**

*Jason Davis, DOTD*

## **Session 17: Innovations Showcase**

*Moderator: Kevin Reed*

*Meeting Room 11*

---

This session will include six different presentations for innovative ideas that districts or sections are using to accomplish goals with limited resources.

### **Contraflow Gates**

*Section 45, Phillip Macaluso*

#### **Contraflow Signs**

*Section 45, Phillip Macaluso*

#### **SCEWD**

*District 07, Jeff Brunet*

#### **Bridge Data Mobility**

*District 58, Lee Wallace*

#### **Guardrail Blade**

*District 61, Brian Ogle*

## **Session 18: Environmental**

*Moderator: Michelle Hanks*

*Meeting Room 12*

---

This session will present a variety of environmental topics. The session begins with a presentation from FHWA's resource center on FHWA's Everyday Counts initiative for Community Connections. Next, an evaluation of the effectiveness of common practices in preventing migratory bird nesting on transportation structures will be discussed. Lastly, DOTD will provide an overview of the recent successful transfer of the historic Oaklawn bridge.

**[TUESDAY 8:00 a.m.–9:45 a.m.]**

**FHWA–Community Connections**

*James Garland, FHWA*

**Evaluating Migratory Bird Exclusion Practices on Transportation Structures**

*Jason Morrell, Arcadis*

**Historic Bridge Marketing with Case Study of Oaklawn Bridge**

*Carey Coxe, DOTD, and Jan Grenfell, Retired DOTD*

**Session 19: DOTD’s System of Engagement (SoE)**

*Moderator: Brad Doucet*

*Meeting Room 13*

DOTD is transforming the way data is managed, maintained, and shared throughout the organization. The System of Engagement (SoE) built on a web-GIS framework and fueled by business system data, will provide DOTD with a single enterprise destination where DOTD workers and partners can consume, analyze, and contribute to enterprise data. Suites of interconnected apps, organized by business function and as easy to use as the apps on our smart phones, will improve decision making and save time in the search for data and insight.

**Introduction to System of Engagement**

*Stacia Taggart, Esri*

**Maps and Apps Developed for SoE**

*Julia Guard, Esri*

**Demonstration of Applications**

*Matthew Erbes, Esri*

**Session 20: Designing for Pedestrians and Bicyclists with Safety in Mind**

*Moderator: Jessica Deville*

*Lower Level Meeting Room 1*

The National Highway Traffic Safety Administration (NHTSA) announced that 2018 highway crash fatality data showed a 2.4% decrease in total roadway fatalities nationwide compared to the previous year. Over the same period, fatalities among pedestrians increased 3.4% and pedalcyclist fatalities increased 6.3%. In Louisiana in 2018, over 25% of roadway fatalities were pedestrians or cyclists after an alarming 40% increase in fatalities among these users from 2017. Despite this, Louisiana has been slow to implement the potentially life-saving countermeasures that improve non-motorized users’ visibility and provide safe crossings. This session aims to bring greater awareness to these countermeasures by reviewing best practices and ongoing initiatives to safely accommodate our most vulnerable road users.

**Virginia’s Implementation of Pedestrian Safety Improvements**

*Mark Cole, Virginia DOT*

**Guidance for Signalization at Pedestrian Crossings**

*Jody Colvin, DOTD*

**Moving New Orleans Bikes**

*Jennifer Ruley, New Orleans DPW*

**Session 21: Student Presentations and Awards**

*Moderator: V.J. Gopu*

*Meeting Room 2*

Teams of civil engineering students from Louisiana universities will present their senior design projects. These projects receive support from DOTD through its Support Program for Civil Engineering Studies.

**Session 22: NexGen 911: The Crossroads of Transportation and Telecommunications in Our Near Future**

*Moderator: Jim Mitchell*

*Meeting Room 3-4*

Advances in telecommunications technology, “NexGen,” promises to bring the power of location to the 911, emergency response community. However, significant technical and technological issues remain to be solved, before cellphone calls can be accurately located and that information transferred to police, fire, or EMS. This session will provide an update on the current status of NexGen implementation in Louisiana. It will also address the importance that statewide mapping of roadways and jurisdictional boundaries will play in connecting emergency callers to first-responders.

*Joe Thompson, Lafayette and Kyle Gonterwitz, Kansas DOT*

**Session 23: Alternative Delivery Methods: Mega Projects**

*Moderator: Sherri LeBas*

*Meeting Room 5-6*

DOTD is continuing to look into innovative ways to design, fund, and construct in a timely manner, infrastructure improvements for the public. DOTD will present an overview of their Alternative Delivery Methods currently being used such as Design Build (D-B), Public Private Partnerships (P3), and Construction Management at Risk (CMAR). In addition, DOTD will provide information on some of their current challenging “Mega” projects and how they are being delivered.

*Timothy Nickel, Christina Brignac, Anna Hanks, Joachim (Joe) Umeozulu, and Jacob Fusilier, DOTD*

**Session 24: Bridge Funding Programs and Project Selection**

*Moderator: Amanda Ranck*

*Meeting Room 7-8*

As the need to repair and replace bridges grows, the process by which DOTD chooses to spend its funding becomes critical. This session will discuss the current state of Louisiana’s bridge inventory and the methods used to prioritize its improvement.



## State of the Bridge Inventory and Current On-System Priorities

Paul Vaught, DOTD

### Off System Bridge Program

Barbara Ostuno, DOTD

### Rural Bridge Special Funding Appropriations

Valerie Tourres, DOTD

### Bridge Scour Program

Stephanie Doolittle, DOTD

## Session 25: Advanced Geotechnical Exploration Methods (A-GaME)

Moderator: James Chatagnier

Meeting Room 9

A high percentage of major infrastructure projects suffer impacts to schedule or cost due to geotechnical issues. Many of these issues relate to risks identified directly to the scope and quality of site characterization work. Effective site characterization is critical for recognizing potential problems that may affect design and construction and for ensuring safe, well-performing, cost-effective projects. This session will examine several proven, effective, and underutilized technologies that are available, that can be used to assess risk and variability. These technologies include cone penetration testing, seismic and electrical geophysics, measurement while drilling, and optical and acoustic televiewers.

### A-GaME - Application of Its Methods

Phil Sirls, Collier Geophysics

### Tools for Enhanced, Effective Site Characterization

Derrick Dasenbrock, MNDOT

### A Discussion of a Hi-tech Investigation of US 331 Choctawhatchee Bay for a Design Build Proposal

William "Bubba" Knight, Fugro

## Session 26: E-Construction Initiative (Materials)

Moderator: Brian Owens

Meeting Room 10

The E-Construction Initiative is the DOTD Construction and Materials sections' push toward automated processes. The materials portion of this topic deals with sample tracking and materials management. Web-based applications allow district labs and plants to quickly share data, easily manage sampling plans and mix designs, and track samples across the state. Some of these features will be highlighted in this session such as: DOTD Sample Tracking, LaPave Online mix design management, and Pavia Materials sampling plan.

### Sample Tracking

David Orr, DOTD

### Online Mix Design Management

Patrick Icenogle, DOTD

### Enhanced Sampling Plan

Amar Raghavendra, DOTD

## Session 27: Expanding the Safety Analysis Tool Box

Moderator: Trey Jesclard

Meeting Room 11

Transportation safety is an ever-evolving field with increasingly sophisticated analysis methods to ensure resources are being directed at life-saving solutions. As Louisiana continues to embrace the methodology of the *Highway Safety Manual* (HSM), we look to improve the analysis tools and methods available to help stakeholders prioritize highway safety investments. Here, we take a deep dive into big data to show you the latest and greatest tools for optimizing site locations and countermeasure selection using crash data. Then, we'll peek into the world of asset and performance management to discuss how innovations in roadway and intelligent transportation systems data are looking to further expand the transportation safety universe.

### Roadway Safety Analysis Tool

Mark Verret and Jason Hines, LSU/Center for Analytics & Research in Transportation Safety

### Safety Benefit Cost Tool

Case Fulcher, Neel-Schaffer

### Using the NPMRDS (and others) to Add Context: A Case Study of I-12 in Covington

Kirk Zeringue, LTRC

### Collecting & Managing Local Road Safety Data

Ashley Moran, Acadiana Planning Commission

## Session 28: Technology is the Future of ITS and the Future is NOW

Moderator: Erik Smith

Meeting Room 12

This session will showcase the emergence of 5G small-cell wireless technology, provide an update to the DOTD CAV Strategic Plan, and provide and update to the use of technology in ITS Maintenance program.

### Small Cell Wireless (5G) Technology

Ahmad Sharif Amer, Verizon Wireless

### DOTD CAV & Smart Mobility Updates: CAV Strategic Plan, Policy Formulation for LA AV Laws, CAV Technology Team Activities

Akhil Chauhan, Arcadis

### Use of Technology in the ITS Maintenance Program

Jeff Jones, Arcadis

## Session 29: The Centroid for Enterprise GIS

Moderator: Darryl Mack

Meeting Room 13

---

This session discusses DOTD's continuing progress toward the goal of an Enterprise GIS system by incorporating a multitude of reliable data sources into a centralized data warehouse for public access and department use. Discussion includes the challenges of obtaining source of record data and strategies for integrating information from data siloes within DOTD and external data from businesses and other governmental agencies. To make sure the collected data is of the highest quality, DOTD strives to improve accuracy through rigorous QA/QC processes. See how GIS distribution occurs and discover how new tools and methods are being used for supporting the System of Engagement (SoE) and future efforts.

### Distributing GIS Data, Web Maps, Printable Maps & Web Apps using Portal

Jason Carr and Derek Waggenspack, DOTD

### Maintaining GIS Features and Attributes For "Maps & Apps"

Chris Cannaday, David Druen, and Monica Crout, DOTD

### Locating the Correct Source of GIS Data

Jason Carr and Ana Young, DOTD

---

## Session 30: ROW Permits, Joint Use Agreements, Utility Relocations, and Innovations in SUE

Moderator: Jacques Cancienne

Lower Level Meeting Room 1

---

This diverse session will cover topics from right-of-way permits and joint use agreements to utility relocation and subsurface utility engineering. The presentations will discuss the permit and JUA processes including changes to existing permit forms and innovative solutions to the growing technology industry and changes to the utility relocation agreement process and the importance of implementing flexibility during design to avoid utility conflicts. It will focus on using SUE in a different fashion to increase the value of the service for the project owner, including evaluating project limits to reduce SUE costs while achieving the utility information required, applying SUE to utility coordination efforts, using SUE to prepare a more accurate relocation estimate, and evaluating deliverables to ensure a full understanding of the project's underground utilities.

### R/W Permit Process And Approaching Challenges

Joy Johnson, DOTD

### Joint Use Agreement Process

Jason Lacombe, DOTD

### Utility Relocation Process

JoAnn Kurts, DOTD

### Innovations in Subsurface Utility Engineering

TJ Stokes, SJB Group

---

[TUESDAY 10:15 a.m.–12:00 p.m.]

## Session 31: Local Public Agencies

Moderator: Amanda Ranck

Meeting Room 2

---

The successful delivery of transportation projects is only achieved through the effective partnership between DOTD and local public agencies (LPA). We share a mission to improve the lives of our stakeholders. These presentations will discuss the programs and options available to the LPAs for state- and federal-funded transportation projects

### Transportation Planning for Local Public Agencies – A Guided Process

Jason Duet, DOTD

### Available Programs for Local Public Agencies

Mary Stringfellow, FHWA

### Proposed Locally Owned Road Rehabilitation Program

Tanya Moore, DOTD

---

## Session 32: Dispatches from the Front Line of Alternative Delivery and the Future of Transportation Funding

Moderator: Doreen Brasseaux

Meeting Room 3-4

---

With the expanded use and completion of several alternative delivery models for infrastructure projects, this panel will explore the experience from both state and national engineering firms as well as consider the state's experience with the first P3 infrastructure projects. The next panel will discuss the project funding outlook for state and federal infrastructure projects for 2020 and beyond.

### Alternative Delivery Viewpoint: Louisiana DOTD P3: Belle Chasse

Bob Schmidt, Huval and Associates

Shawn Wilson, DOTD

Mike Schutt, Plenary International

Ann Therese Schmid, Nossaman LLP

### Alternative Delivery Viewpoint: Louisiana CMAR Case Study—GNO Causeway Bridge Widening

Bob Schmidt, Huval and Associates

Carlton Dufrechou, Greater New Orleans Expressway Commission

Ed Scheurmann, Boh Bros.

Jan Evans, Volkert

David Huval, Jr., Civil & Environmental Consultants, Inc.

### Federal and State Funding

Matt Reiffer, ACEC

Josh Hollins

---

## Session 33: Smart Travel Choices Using Real-Time

### Traffic Information

*Moderator: Rosalinda Deville*

*Meeting Room 5-6*

Real-time traffic information can influence a commuter's decision to plan ahead or choose a different route. Providing citizens with accurate information on traffic conditions can encourage journeys at times of low congestion; this will allow the people to consider alternate paths to their destination and minimize travel time. Technology advancement in the transportation sector has grown exponentially and is predicted to grow at a rapid rate. This session will focus on DOTD's Intelligent Transportation Systems (ITS) current and future initiatives to facilitate smart travel.

### Discover 511, Louisiana's New Advanced Travel Information System

*Rachel Anderson, Kapsch*

### Urban Mobility using Active Queue Warning System

*Paul Hsu, Arcadis*

### Single Access Point for Video Sharing using VDMS

*Kendra McCoy, Gresham Smith*

## Session 34: Nationwide Bridge Projects, Best Practices, and Research

*Moderator: Kurt Brauner*

*Meeting Room 7-8*

This session will feature unique bridge structures, new details, and relevant research from around the country.

### Design and Construction of the New Ship Channel

### Cable-Stayed Bridge

*Wade Bonzon, FIGG Bridge Engineers, Inc.*

### Bayonne Bridge Navigation Clearance Program: Design and Construction of Approach Structures and Rehabilitation of Main Span

*Roger Haight, WSP, NY / NJ Port Authority*

### TxDOT Bridge Standards: Means and Methods

*Taya Retterer, TXDOT*

### Stainless Steel Strands in Prestressed Concrete Girders

*Vickie Young, Florida DOT*

## Session 35: Geotechnical State of Practice and Research Implementations

*Moderator: Kevin Mai*

*Meeting Room 9*

This session will showcase web-based tools that are utilized to better visualize geotechnical data. A demonstration will be given on visualizing several of the LTRC GIS implementations. Topics will include coastal Louisiana geologic faults, historical geotechnical boring log location searches and NCHRP Soil types across roadways. Tips on how to discover LTRC and DOTD specific web services and web applications will be provided. Also, a case study will be presented on how recycled plastic can be utilized to stabilize embankment slope failures.

## GIS Implementations of LTRC Research

*Adele Lee, LTRC*

### An Innovative Web-Based Tool for Geotechnical Data Visualization and Interpretation

*Xin Peng and Ching Tsai, Ardaman & Associates*

### Slope Stabilization Using Recycled Plastic Pins

*Sadik Khan, Jackson State University*

## Session 36: E-Construction Initiative (Construction)

*Moderator: Matthew Jones*

*Meeting Room 10*

The E-Construction Initiative is the DOTD Construction and Materials sections' push toward automated processes. The construction portion of this topic deals primarily with the virtual fieldbook application. Engineers and technicians now have iPads in the field allowing for enhanced data management, better observations, and faster communication to Headquarters and the contractor. Some of these features will be highlighted in this session such as: Pavia Headlight application for observations and Primavera application for critical path management.

### DOTD's Experience with Virtual Fieldbook

*Les Fletcher, DOTD*

### Statewide Implementation of HeadLight Fieldbook

*Terri Helus, HeadLight*

### Critical Path Management

*Dallas Ballmer, DOTD*

## Session 37: Advancements in Safety Analysis

*Moderator: Laura Riggs*

*Meeting Room 11*

Transportation safety is leaning into the new way of using data-driven safety analysis (DDSA) to not only inform project development and planning but to guide programmatic and policy decision-making. Here, we traverse how differences in analysis methods and data mining techniques can lead to similar conclusions, how systemic analysis can be used to prevent the next crash, how predictive analysis using injury data can lead to better crash outcomes and why adopting technology could be a lifesaver. Lastly, what do we do when this data isn't reliable? The latest effort to improve crash data: updating Louisiana's Crash Report. Buckle up for this ride through the underbelly of safety analysis.

### Louisiana Non-Motorized User Crash Data Assessment

*Jessica DeVille, DOTD*

### Impacts of Bike Lane Implementation and Ride Sharing in an Urban Community

*Juan Duchesne, Tulane School of Medicine/University Medical Center*

### Ride Sharing in an Urban Community

*Rebecca Schroll, Tulane School of Medicine/University Medical Center*

### Louisiana Crash Report Update

*Ralph Mitchell, DOTD*

## Session 38: Sunshine Bridge Incident: The Impact on Local Emergency Response

Moderator: Skip Breeden

Meeting Room 12

---

### ESF-1 & ESF-3 Response

Skip Breeden, DOTD

### St. James Parish Government

Eric Deroche, St. James Parish

### Local Impact of Closure

Deano Moran and Riley Berthelot, West Baton Rouge Parish

### Impact of Closure on Schools

Chad Lynch, Ascension Parish Schools

### State and Local Public Awareness

DOTD Representative

## Session 39: Maintaining Data Sources for Enterprise GIS

Moderator: Jason Chapman

Meeting Room 13

---

This session will focus on efforts to collect and maintain data from disparate sources that can be used by state and local governments as well as federal reporting requirements. Presentations will cover the maintenance procedures incorporated by DOTD for highway inventory data. Discover how TxDOT is using alternative methods for collecting traffic data using portable WIM technology. Learn how efforts by The Acadiana Planning Commission to collect existing local roadway data from a diverse group of shareholders will be integrated with DOTD's collected data within the Enterprise GIS.

### Maintenance of Road Inventory Data

Chad Parker, DOTD

### Portable WIM Technology—An Alternative Means for Measuring Traffic Data

Tom Scullion, TTI

### Innovative Techniques for Managing and Updating Local Road Data

Ashley Moran, Acadiana Planning Commission

## Session 40: Innovations in Railroad Crossing Safety

Moderator: Bill Shrewberry

Lower Level Meeting Room 1

---

If you have a project crossing a railroad track or are looking for a way to keep drivers from stopping on the tracks, this session is for you. We will discuss the railroad coordination effort essential to a project's success and provide suggestions to streamline the process and a few lessons learned. We will also present the innovative pavement-marking project performed by LTRC and DOTD to discourage drivers from stopping on the tracks. The session will also include safety tips and information on how to prevent railroad collisions and what to do if a vehicle is stuck on the track.

## Evaluating the Effectiveness of Signs and Striping at Railroad Crossings

Julius Codjoe, DOTD

## Road Design Section: Railroad Coordination & Solutions

Jared Ray and Shawn Luke, DOTD

## LA Operation Lifesaver: Operation Lifesaver

Claude Maher, Louisiana Operation Lifesaver

[TUESDAY 1:00 p.m.–2:45 p.m.]

## Session 41: Innovative Infrastructure Funding Solutions

Moderator: Kim Marousek

Meeting Room 2

---

Local governments lack sufficient funding for infrastructure. Often, where development activity is robust, it creates a demand that outstrips the capacity of existing infrastructure. When growth has stagnated, underutilized and vacant properties fail to generate revenue needed for infrastructure maintenance.

This session will discuss national best practices to fund infrastructure equitably from those who benefit from infrastructure the most, while creating favorable development incentives. By increasing awareness and understanding of these funding options, local governments will have additional tools in their fiscal toolbox to maintain existing infrastructure, defray the cost of growth and guide growth to places where it can be accommodated most efficiently and effectively.

### Value Capture: Overview

Rick Rybeck, Just Economics LLC

### Value Capture: Implementation at a Local Level

Steve Villavaso, Villavaso and Associates

### Local Value Capture Example

Jerome Fournier, Ascension Parish

## Session 42: Swamp Tank: Up to Our Ears in Alligators

Moderator: Tyson Rupnow

Meeting Room 3-4

---

This session will be a fast-paced session focusing on recently completed or ongoing LTRC materials, pavements, and geotechnical research. Presentations are required to be in the format of a Shark Tank pitch with each presentation being no more than 6-minutes in length. Presentations will highlight the Departmental need for the research, provide a high level overview of the results, and conclude with recommendations from the project.

### Roadway Damage Caused by Inundation

Kevin Gaspard, LTRC

### Evaluation of Direct CPT Methods for Estimating the Ultimate Pile Capacity of Driven Piles

Murad Abu-Farsakh, LTRC

## **Maintenance of Roadway Edge Drop-Off Utilizing Readily Available Materials**

*Gavin Gautreau, LTRC*

## **Influence of Internal Curing and Coarse Aggregate Type on Concrete's Surface Resistivity**

*William Saunders, LTRC*

## **Use of Reclaimed Fly Ash in Portland Cement Concrete**

*Jose Milla, LTRC*

## **In-Line Crushed RAP vs. Pre-Screened Crushed RAP**

*Corey Mayeux, LTRC*

## **Development of 4.75-mm NMA mixtures for Louisiana Roads**

*Saman Salari, LTRC*

## **Live Load Rating of Cast-in-Place Concrete Box Culverts in Louisiana**

*Walid Alaywan, LTRC*

## **Quality Control/Assurance on Base Course and Embankment with Dynamic Cone Penetrometer**

*Nicholas Ferguson, LTRC*

## **Performance and In-Situ Bond Strength Characterization of BCOA Pavements Under Accelerated Loading**

*Moinul Mahdi, LTRC*

## **Pavement Damage Cost Recovery Correlated with Shale Oil/Gas Recovery Operations in Louisiana**

*Zhong Wu, LTRC*

## **Effect of Laboratory Aging on Asphalt Binders and Intermediate-Temperature Cracking of Asphalt Mixtures**

*Louay Mohammad, LTRC*

## **Exploration of Drone and Remote Sensing Technologies in Highway Embankment Monitoring and Management**

*Doc Zhang, LTRC*

## **Evaluation of Crumb Rubber Modification of Louisiana Mixtures**

*Samuel Cooper, III, LTRC*

## **Session 43: Partnering Between DOTD and the Consultant Community**

*Moderator: Edward Wedge, III*

*Meeting Room 5-6*

Presentations in this session will cover the structured process that DOTD has established for partnering with the consultant community, sometimes referred to as "Phase II," and discuss major changes to policies and processes related to consultant contracts that have come about since the inception of this process in August 2018. The presentations will be followed by a roundtable-style question and answer session, in which a panel comprised of DOTD staff involved in the partnering process and the President of ACEC-L will answer questions from the audience about the process or any of the policies covered in the presentations.

### **A Structured Partnering Process**

*Chris Knotts, DOTD*

### **What Have We Done So Far? Major Changes Under Phase II**

*Geoffrey Rodriguez, DOTD*

### **Panel Q&A**

*Chad Winchester, Mark Chenevert, and Darlene Major, DOTD, and Doreen Brasseaux, ACEC*

## **Session 44: Bridge Rehab & Construction/Operations Support**

*Moderator: Artur D'Andrea*

*Meeting Room 7-8*

Due to site constraints or traffic restrictions, some bridges must be improved in place. This session features presentations on various projects that rehabilitated, strengthened, or repaired deficient bridge structures.

### **US 80 Texas Street Bridge Rehabilitation**

*Hatem Seliem, SDR*

### **Prien Lake Bridge Construction Support**

*Mark Buccì, DOTD*

### **Rehabilitation of the I-20 Mississippi River Bridge at Vicksburg**

*Patrick Martens, Bridge Preservation and Inspection Services, and Gregory Taravella, Modjeski and Masters*

### **Intermediate Repair of the LA 1 Bridge over the Intracoastal Canal**

*Chad Roubique, DOTD*

### **Bridge Design Emergency Repair Projects**

*Chris Guidry, DOTD*

## **Session 45: Construction**

*Moderator: Kris Wascom*

*Meeting Room 9*

Maintenance of reinforced concrete structures repeatedly consumes a significant portion of transportation agency funds. In marine environments, bridge substructures can spall and crack due to corrosion of reinforcement, leading to structural deficiencies. In colder climates, corrosion is exacerbated by the use of de-icing salts requiring agencies to frequently repair superstructure components. Designing structures using alternative reinforcing materials and/or denser concrete can be specified to help mitigate corrosion. After construction, however, cathodic protection is the most effective tool at preventing the corrosion of steel reinforcement. This session will present the advantages and disadvantages of alternative materials, as well as basic techniques and theory involved with implementing galvanic and impressed current cathodic protection systems.

### **Cathodic Protection of Piles**

*Paul Vinik, GPI*

### **Fiber Reinforced Concrete**

*Brian Wright, Sika - Fibermesh*

### **Surface Resistivity**

*Jose Milla, LTRC*

## Session 46: Pavement Preservation Programs

*Moderator: Joe Brown*

*Meeting Room 10*

---

This session will offer insight into the Pavement Preservation Programs by providing a brief explanation of each program and eligible pavement preservation treatments, design decisions made through the PRR process, and how they contribute to roadway safety, including expected crash reduction comparisons between different geometric options and for various safety countermeasures, as well as a continuation of the precast concrete panel presentation from the 2018 conference. While Part 1 from the 2018 conference discussed the pre-construction activities, Part 2 focuses on the construction activities including lessons learned and possible future uses.

### Safety-Based Design Decisions in PRR projects

*Nick Fruge, DOTD*

#### Pre-Cast Panels - Part 2 (I-20 EB Entrance Ramp at LA 169)

*Phillip Sturdivant, DOTD*

#### Pavement Preservation Programs

*D'Ion Spurlock, DOTD*

## Session 47: DOTD Cost Recovery Issues and Emergency Response

*Moderator: Yvonne Murphy*

*Meeting Room 11*

---

Disaster Recovery for roads and bridges is a complex and complicated process. Multiple agencies and various rules and regulations that must be followed. DOTD, FHWA, FEMA, GOHSEP, LTRC, and LMA joined forces to develop a training course and guide for local governments to use while trying to navigate the disaster recovery process. This training discusses federal programs, policies, and information on what to do before and after an event to participate in the federal reimbursement programs for eligible repairs to eligible roads and bridges.

### FEMA and FHWA Cost Recovery for Damaged Infrastructure

*Yvonne Murphy, DOTD*

#### Local and State - Cost Recovery, Damage Assessments, FEMA

*Daniel Crothers, GOHSEP/FEMA*

#### Local and State - Cost Recovery, Damage Assessments, FHWA

*Mary Stringfellow, FHWA*

#### Next Gen 911

*DOTD Representative*

## Session 48: ITS Operations - Traffic Incident Management

*Moderator: Lucy Kimbeng*

*Meeting Room 12*

---

TIM is a planned and coordinated multi-disciplinary process to monitor, detect, respond to, and clear traffic incidents as safely and quickly as possible, in order to restore traffic operations to normal conditions. Motorist Assistance Patrol (MAP), Traffic Management Center (TMC), and other response agencies work together to manage major traffic incidents on the Interstate and other major highways. This session will discuss the activities and coordination involved in managing a traffic incident, a weather-related event, and other emergency situations, and how managed lanes impact TIM.

### Motorist Assistance Patrol Operations

*Scott Evans, SERCO*

### Traffic Management Center Operations

*Michael Muffoletto, KAPSCH*

### Hard Shoulder Running, I-12 Managed Lane

*Thomas Montz, ARCADIS*

## Session 49: Understanding the Economic Benefits of Public Investment in Transportation Infrastructure

*Moderator: Connie Betts*

*Meeting Room 13*

---

The concept of economic benefits is often used as a justification for making transportation infrastructure investments. However, there is no widely accepted, established set of criteria to quantify these benefits making it difficult to incorporate into standard practices for project prioritization. In this session, presenters will show different approaches to addressing this issue.

### Evaluating the Economic Benefits of Implementing Transportation Projects in Louisiana

*Naquan Ishman, Decision Lens*

### Economic Effects of Restricted Crossing U-Turn Intersections in Louisiana

*Helmut Schneider, Center for Analytics & Research in Transportation Safety (CARTS)*

### Assessing the Economic Benefits of the TIMED Program

*Peter Stopher, Arizona State University*

## Session 50: ADA and Title VI

*Moderator: Paula Roddy*

*Lower Level Meeting Room 1*

The Americans with Disabilities Act (ADA) became law in 1990. The ADA is a civil rights law that prohibits discrimination against individuals with disabilities in all areas of public life, including jobs, schools, transportation, and all public and private places that are open to the general public. This session will introduce the newly established DOTD State Transition Plan, which is the action plan developed from the results of the DOTD statewide self-evaluation. This plan itemizes structural barriers and details the necessary steps and timetable to complete required modifications identified in the self-evaluation for the state-owned roads in Louisiana. The session will also update the Government Street revitalization program. There will also be ADA presentations by persons living with physical and visual restrictions and the pedestrian barriers they face in their activities of daily living.

### Transition Plan

*Cynthia Douglas, DOTD*

### Government Street Project

*Paula Merrick Roddy, DOTD*

### The Visually Impaired-Navigating Life

*Blanche Z. Faulk, Stacey Cox, and Laronda Doakes, Louisiana School for the Visually Impaired*

### LA Workforce Commission

*Joe Wills, LAWC, and Ann Wills*

**[TUESDAY 3:15 p.m.–4:15 p.m.]**

## Session 51: Compliance

*Moderator: Paula Roddy*

*Meeting Room 2*

This session will present transportation highway construction specific topics and each person on the panel will offer information that details their role in the construction process. DOTD staff will provide detailed information for contractors, subcontractors, and others associated with highway construction projects on all federal requirements during each phase of the project from the issuance of the notice to proceed through the final acceptance stage. Best practices will be presented as well as ramifications of non-compliance with federal requirements.

### DBE

*Rhonda Wallace, DOTD-Compliance*

### SBE

*Euphemia Smith, DOTD-Compliance*

### DBE Contract Administration

*Keycha Alexander Green, DOTD-Compliance*

### Contract Compliance/1391s

*Juanita Linton, DOTD-Compliance*

## Contractor Payroll/Estimates

*Angela Benn, DOTD-Compliance*

## OJT (On-the-Job Training)

*Joyce Brignac, DOTD-Compliance*

## Session 52: Swamp Tank: Digging Out of the Swamp

*Moderator: Tyson Rupnow*

*Meeting Room 3-4*

This session will be a fast-paced session focusing on recently completed or ongoing LTRC planning, intelligent transportation systems, and safety research. Presentations are required to be in the format of a Shark Tank pitch with each presentation being no more than 6-minutes in length. Presentations will highlight the Departmental need for the research, provide a high level overview of the results, and conclude with recommendations from the project.

### Evaluating Pedestrian Crossings on High Speed Urban Arterials

*Elisabeta Mitran, LTRC*

### Determining Louisiana's Roundabout Capacity

*Julius Codjoe, LTRC*

### Evaluating DOTD's Existing Queue Estimation Procedures

*Raju Thapa, LTRC*

### NPMRDS-based Technical Assistance Projects

*Kirk Zeringue, LTRC*

### Trip Generation Modification Factors for Louisiana

*Chester Wilmot, LTRC*

### Developing a Competency Model for Highway Safety Engineers: A Delphi Method

*Garrett Wheat, LTRC*

### An Assessment of DOTD's Consultant Plan Development and Performance Rating Process

*Kirk Zeringue, LTRC*

### Hurricane Evacuation Modeling Package

*Ravindra Gudishala, Arcadis*

## Session 53: Right-of-Way

*Moderator: Jamie Boullion*

*Meeting Room 5-6*

An in-depth discussion of the high costs of partial acquisitions, including several real-world examples.

### Consideration of Right-of-Way Costs in the Design Phase

*Donna Stinson, DOTD*

## Session 54: Bridge Projects (Widening and Replacement)

*Moderator: Chris Guidry*

*Meeting Room 7-8*

While DOTD constructs numerous projects every year, some incorporate special features or present new challenges. This session will discuss new or ongoing projects that used unique construction techniques, products, and/or designs.

## **I-10 Widening Projects near Lafayette: I-49 Jct. to the Atchafalaya Floodway Bridge**

*Andrew Windmann, DOTD*

## **I-110 Terrace Ave. Ramp**

*Mary Jean McAdams, DOTD*

## **LA 1 Port Allen Intracoastal Waterway Bridge**

*Mike Paul, TRC, and Cullen Ledet, Modjeski and Masters*

---

## **Session 55: I-10 Baton Rouge Corridor Improvements**

*Moderator: Corey Landry*

*Meeting Room 9*

The nine-mile corridor of Interstate 10 stretching from the LA 415 interchange on the west bank of the Mississippi River to Essen Lane on the east bank was constructed in the early 1960s using lighter design loads than today's standards with a design ADT of 80,000 vpd. Currently, the interstate is heavily congested with a peak period ADT ranging between 130,000 and 160,000 vpd. I-10 in Baton Rouge is also notoriously known as the "one lane" coming off the Mississippi River bridge in the eastbound direction. Brian will provide an overview of the project improvements and a status of the on-going environmental assessment. Carey will be discussing compliance with Section 106 of the National Historic Preservation Act and the resulting Programmatic Agreement developed for the project.

*Brian Kendrick and Carey Coxe, DOTD*

---

## **Session 56: EDC Initiative: Collaborative Hydraulics: Advancing to the Next Generation of Engineering (CHANGE)**

*Moderator: Billy Williamson*

*Meeting Room 10*

The next generation of hydraulic engineering tools, particularly two-dimensional (2D) modeling and graphical visualization features, allows users to create better representations of the often complex interaction between transportation assets and the riverine or coastal environments. These representations provide the planning and design team with better data with which project quality can be improved.

---

## **Advancements in Bridge Hydraulic and Scour Analyses with 2D Hydraulic Modeling**

*Scott Hogan, FHWA*

---

## **Session 57: Off the Pavement**

*Moderator: Shane Caldwell*

*Meeting Room 11*

This session will cover a mix of topics different from the typical hard sciences and design.

## **Changing DOTD Safety Standards**

*Chris McMorris, DOTD*

## **Understanding Preventative Pruning**

*Herb Piller, DOTD*

## **What's in Your Backyard?**

*Sharon Calcote, LA Dept. of Culture, Recreation & Tourism*

---

## **Session 58: National Public Transportation Safety Program (PTASP)**

*Moderators: JD Allen and Ben Magallon*

*Meeting Room 12*

49 CFR 670 establishes substantive and procedural rules to support the Federal Transit Administrator in carrying out the Public Transportation Safety Program (Safety Program), first authorized in the Moving Ahead for Progress in the 21st Century Act (MAP-21) (Pub. L. 112-141 (2012)), and codified at 49 U.S.C. 5329. On December 4, 2015, the president signed into law the Fixing America's Surface Transportation (FAST) Act (Pub. L. 114-94 (2015)). The FAST Act made two amendments to the Safety Program that affect the final rule-making and include parts 625/630, 672, 673, and 674 (Transit Asset Management, the Safety Certification Training Program, State Safety Oversight, and Public Transportation Agency Safety Plans).

---

## **Panel Discussion**

*JD Allen and Ben Magallon*

---

## **Session 59: Addressing Distracted Driving**

*Moderator: Dortha Cummins*

*Meeting Room 13*

Distracted driving is a complex issue that affects Louisiana's roadway users every day. This session defines "distraction," explains what it means to Louisiana, and why every driver should be concerned about distraction.

---

## **Distracted Driving**

*Dortha Cummins and Jessica Bedwell, LA Highway Safety Commission*

---

## **Session 60: Multimodal Economic Development**

*Moderator: Molly Bourgoynne*

*Lower Level Meeting Room 1*

This presentation will provide information on the process to have a land site certified through the Louisiana Department of Economic Development (LED.) It benefits and provides success stories on how these sites were developed at seaports, airports, rail terminals, and other sites with transportation infrastructure. The goal will be to tie economic development to multimodal transportation.

---

## **Louisiana Economic Development: Building a Vibrant Economy**

*Taylor Gravois, CSRS, and Brad Lambert, LA Economic Development*



## [WEDNESDAY 8:00 a.m.–9:45 a.m.]

### Session 61: The Future of Multimodal Transportation

*Moderator: Lionel J. Moore*

*Meeting Room 2*

AIR! LAND! WATER! The future is now! From trade, trucking, and UAS, see where Multimodal Commerce is going.

- The use of unmanned aerial systems is becoming more prevalent as technology improves. This presentation will review DOTD's current operations, future operations, and lessons learned.
- Learn about FTOT, a scenario-testing tool that knits together data and analytics related to multimodal networks, intermodal facilities, flow analysis, and flow optimization.
- Louisiana trade opportunities are numerous. This presentation will address how Louisiana is taking advantage of all the opportunities.
- Today, almost every advertised product is followed by some reference to free or same day delivery. Many experts refer to this as the "Amazon Effect" whereby consumers now expect goods to arrive at their doorsteps faster than traditional supply chains will allow. This session looks into the make-up of last mile logistics industry and its critical role in the future of transportation.

#### Use of UAS Technology for DOTs

*Josh Duplantis, DOTD*

#### Multimodal Freight Data and Investment Trade Off Analysis

*Eric Phil, FHWA*

#### Inland Port and Terminal Capitalization Projects

*Aimee Anders, AMPE*

#### Saving the Best for Last: A Look into the Complicated World of Last Mile Logistics

*Jason Burns, Sr., QCS Logistics/InPacity*

### Session 62: Roadway Design, Coordination, and Project Delivery

*Moderator: Ryan Reviere*

*Meeting Room 3-4*

The DOTD Road Design Section not only provides in-house roadway design for the delivery of projects, but also must be able to coordinate with other DOTD sections, consulting engineering professionals, as well as other governmental entities in order to deliver transportation projects. This session will showcase two in-house design projects that utilize access management principles in order to move traffic safely through heavily travelled highways. The third project demonstrates how coordination was key to delivering plans for Louisiana's first Diverging Diamond Interchange (DDI). The Pecue Lane at I-10 Interchange in Baton Rouge is a multi-phased project that faced many unique design challenges and required coordination from several entities and design professionals.

#### LA 70 at LA 22 Improvements

*Patrick Toney, DOTD*

#### LA 42 Improvements

*Robert Isemann, DOTD*

#### Pecue Lane at I-10 Diverging Diamond Interchange

*Anna Hanks, DOTD, and John Raymond, Shread-Kuyrkendall*

### Session 63: Consultant Contract and Construction Contract Updates

*Moderator: Mark Chenevert*

*Meeting Room 5-6*

Consultants, contractors, and project managers, if you want info regarding contracts, this session is for you.

#### Consultant Contract Updates

*Darlene Major and Mike Gorbaty, DOTD*

#### Consultant Invoicing Process Updates

*Darlene Major and Kathy Ward, DOTD*

#### Consultant ICR and Labor Rate Submittal Requirements

*Darlene Major and Mark St. Cyr, DOTD*

#### Construction Contract Cost Estimation and Value Engineering

*Charles Nickel, DOTD*

#### Setting Construction Contract DBE/SBE Goals

*Randy Sanders and Paula Roddy, DOTD*

### Session 64: Movable Bridges / Lighting Program

*Moderator: Richard Foster*

*Meeting Room 7-8*

The repair and replacement of movable bridges often requires unique solutions and details. In addition to movable bridges, DOTD also provides and maintains various lighting projects throughout the state. This session will discuss the current state of DOTD's movable bridge and lighting programs as well as several related projects that featured innovative designs.

#### Movable Bridge Inventory and Programming

*Stewart Hingle, DOTD*

#### DOTD Facilities - Overview and Challenges

*TJ Dunlevy, DOTD*

#### Smart Lighting in Louisiana

*Cindy Brewbaker, Telensa*

#### US 11 Bascule Span: Mechanical Rehabilitation

*Geoffrey Forest, Modjeski and Masters*

#### US 11 Bascule Span: Electrical Rehabilitation

*John Gerhart, Modjeski and Masters*

## Session 65: Pavement Research and Implementation

Moderator: Mark Ordogne

Meeting Room 9

---

Pavements on expansive subgrade soils can be problematic. Research has been done to determine the potential impacts to the structure and how to better analyze these conditions. This session will also include methods to determine the SBS content in asphalt.

### Development & Implementation of an Analytical Method to Evaluate the Potential of Pavement on Expansive Soils

Jay Wang, Louisiana Tech University

### Climatic Influence on Structural Behavior of Pavement on Expansive Subgrade Soils

Debojit Sarker, Louisiana Tech University

### Field Implementation of Handheld FT-IR Spectrometer for Quantifying SBS/SB Content in Polymer-Modified Asphalt Binder

Nazimuddin Wasiuddin, Louisiana Tech University

## Session 66: Bridge Maintenance

Moderator: Haylye Brown

Meeting Room 10

---

This session covers a variety of information about bridge and structure inspections, including non-destructive methodologies, underwater inspections, and a detailed look at the inspection of the Luling Bridge.

### Inspection of Luling Bridge

Patrick Roth, HNTB

### NDE Methodologies

Shane Boone, BDI, Inc

### Underwater Bridge Inspection

Heath Pope, CONSOR

## Session 67: Sunshine Bridge – District Operations Response

Moderator: Aaron Elisar

Meeting Room 11

---

On October 12, 2018, a crane barge collided with the Sunshine Bridge damaging a critical lower cord member. The damage left the bridge in critical condition resulting in eastbound traffic being diverted onto the westbound lanes creating commuter traffic congestion for the surrounding region. A structural rehab project for the bridge was already in progress, which significantly expedited the process of acquiring a contractor and CE&I consultant to perform and inspect the emergency repairs. Emergency Operations responses were critical to ensure the timely dissemination of information regarding the status of the structure.

## Sunshine Bridge Emergency Response

Skip Breeden, DOTD

### Traffic Impacts Due to Sunshine Bridge Emergency Repair

Chris Ewing, DOTD

### Construction of the Sunshine Bridge Emergency Repair

Tim Thomas, GPI

## Session 68: Improving Safety In Workzones

Moderator: Michael Demouy

Meeting Room 12

---

### Automated Queue Warning Systems/ITS in Work Zones

Eric Anderson, Integrity Traffic Services of Texas

### Making Night Work Zones Safer

Paul Albrecht, Barriere

### The Role of Law Enforcement Officers in LA Work Zones

Ron Whittaker and Jeff Faust, DOTD

## Session 69: Louisiana Asphalt Pavement Association 1 - Pavement Preservation

Moderator: Erich Ponti

Meeting Room 13

---

This session reviews different pavement preservation topics and highlights the PPRA website.

### Pavement Preservation Tools and Resources

Danny Gierhart, Asphalt Institute

## Session 70: Funding Sustainability and the TTF

Moderator: Don Johnson

Lower Level Meeting Room 1

---

This session will discuss DOTD's main funding source for transportation projects, the Transportation Trust Fund, and its ability to sustain the state's vastly growing infrastructure needs. We will examine any pending legislation and the impact it would have on the agency's ability to reduce the number of outstanding projects while maintaining its existing roads. We will also explore what other states have done to increase their available funding including that nasty 5 letter word, TAXES.

Barbara Aguiard, DOTD

## [WEDNESDAY 10:15 a.m.–12:00 p.m.]

### Session 71: Metropolitan Planning Organizations

*Moderator: Dawn Sholmire*

*Meeting Room 2*

Louisiana currently has 11 Metropolitan Planning Organizations (MPOs). A MPO is a federally mandated and federally funded transportation policy-making organization that is made up of representatives from local government and governmental transportation authorities. They were created to ensure regional cooperation in transportation planning and to ensure that existing and future expenditures of governmental funds for transportation projects and programs are based on a continuing, cooperative, and comprehensive (“3 C”) planning process. This session will discuss the role and responsibilities of a Metropolitan Planning Organization as well as current initiatives/activities in the Alexandria, New Orleans, and Acadiana MPO areas.

#### The Roles of an MPO

*Matt Johns, Rapides Area Planning Commission*

#### MPO Initiatives

*Jeff Roesel, Greater New Orleans Regional Planning Commission*

#### University Avenue Corridor

*Melanie Bordelon, Acadiana Planning Commission*

### Session 72: Innovative Intersection Design

*Moderator: Toby Picard*

*Meeting Room 3-4*

Innovative intersection designs modify vehicle, pedestrian, and bicycle movements at conventional intersections to provide transportation agencies and local communities with new options to reduce delay, increase efficiency, and provide safer travel for all road users. This session will overview the multiple types of innovative intersections being implemented throughout the United States. Additionally, one type of innovative intersection, the roundabout, has become very popular in many areas. However, there are still some challenges in the U.S. with accommodating pedestrians and bicyclists at roundabouts and with the safety and navigation of users on multi-lane roundabouts. This session will also discuss the turbo roundabout, as one solution to the challenges experienced on multi-lane roundabouts, and will discuss strategies used to successfully incorporate pedestrian and bicycle accommodations within a roundabout.

#### Design Elements of the Turbo-Roundabout

*Brian Moore and Jaap Tigelaar, Arcadis*

#### Principles for Designing Multimodal Friendly Roundabouts

*Mike Sewell, Gresham Smith*

#### Alternative Intersections State of the Practice

*Jonathan Reid, Arcadis*

### Session 73: Traffic Engineering Policies and Procedures

*Moderator: Ryan Hoyt*

*Meeting Room 5-6*

Chicken or egg? The posted speed limit vs. design speed. Do you pick a design speed from the posted speed or do you post a speed based on the design speed? How does target speed fit into this discussion? There are a lot of ongoing discussions and research on target speed, context of roadway, and posted speed limit. This discussion will tie all of these concepts together and explain how this fits into DOTD projects.

#### What Does Roadway Contexts Mean?

*Joshua Harrouch, DOTD*

#### What is Access Management?

*John Broemmelsiek, FHWA*

#### Who Sets the Speed Limits?

*Jody Colvin, DOTD*

### Session 74: Sunshine Bridge Emergency Repair

*Moderator: Chris Guidry*

*Meeting Room 7-8*

On October 12, 2018, the Sunshine Bridge on LA 70 in Donaldsonville, Louisiana was struck by a barge with a crane resulting in significant damage to the main steel truss span. This session will discuss in detail the design methods and technologies used to assess the damage, repair the span, and reopen the bridge.

#### Sunshine Bridge Collision: Emergency Assessment and Repairs

*Jenny Fu, DOTD*

*Jason Miles, Modjeski and Masters*

*Jonathan C. McGormley, WJE*

*Joey Coco, Forte & Tablada*

*Brian Rando, Huval and Associates*

### Session 75: LTAP Cornucopia - Going Local!

*Moderator: Steven Strength*

*Meeting Room 9*

This “round robin” session will highlight some new features of LTAP programs of interest to local agencies, districts, MPO’s and other field practitioners.

#### Local Road Safety Program Updates

*Leo Marretta, LA LTAP*

#### Training Tools and the Roads Scholar Program

*Olivia Phelps, LA LTAP*

#### Work Zone Safety Issues in Local Agencies

*Steven Strength, LA LTAP*

## **Session 76: Contract Administration of Local Public Agency Projects**

*Moderator: Mike Vosburg*

*Meeting Room 10*

This session reviews and gives direction on policies and procedures required to administer a Local Public Agency (LPA) project. This session is an overview of what is usually 2-3 days of training needed to become a LPA project engineer and administer a construction contract for a local agency that involves federal funds. This session will discuss administration and documentation requirements of construction projects in order for the local agency to receive reimbursement of federal funds on these type projects. Topics include: general contract administration, sitemanager, estimates, audit, project documentation, work zone signing, etc.

### **SiteManager Construction**

*Matthew Jones, DOTD*

### **SiteManager Materials**

*Jason Davis, DOTD*

### **Estimates & Funding**

*Venice Grisby, DOTD*

### **Contract Administration**

*Brian Owens, DOTD*

### **Work Zones**

*Barry Lacy, DOTD*

### **Project Final Closeout**

*Chris Durbin, DOTD*

## **Session 77: From Private to Public Sectors, LiDAR Scanning is Revolutionizing the Land Surveying Industry!**

*Moderator: Barrett Smith*

*Meeting Room 11*

In the world of transportation planning and design, there is a constant struggle to obtain precise details and measurements in an increasingly shorter amount of time. LiDAR scanning (the use of lasers for light distance and ranging) is becoming the new normal versus traditional surveying methods. DOTD will provide a program overview of the process, area of the state acquired by DOTD, challenges, workflows for IMU correction, calibration, and classification of LiDAR data. SJB Group will present highway projects that have utilized mobile and terrestrial LiDAR scanning. These projects will showcase the different applications, accuracies, and advantages of LiDAR scanning for the measurement and modeling of highway structures.

### **DOTD's LiDAR Program: From Conception in 2016 to Producing 3DEP QL1 LiDAR Data in 2020**

*Kurt Johnson, Dustin Smith, and Jeremy Penton, DOTD*

### **Mobile LiDAR Scanning**

*Bradley Holleman, SJB Group*

## **Session 78: Legal Panel Discussion**

*Moderator: Dan Magri*

*Meeting Room 12*

As transportation professionals actively engaged in the planning, design, construction, and maintenance of public facilities, we are often asked to provide assistance to legal staff for litigation cases. The goal of this session is to have an open dialogue with DOTD legal staff and the Louisiana Attorney General's office on best business practices related to legal matters. Topics of interest typically include recent legislation that may affect the Department, guidelines for public information requests, and types of documents covered under 23 USC 409.

### **Roundtable Discussion**

*Laura Putnam and Corinne Blache, LA Attorney General's Office, and Lesia Warren, DOTD*

## **Session 79: Louisiana Asphalt Pavement Association 2 - PAVExpress**

*Moderator: Erich Ponti*

*Meeting Room 13*

This session discusses in detail exactly what inputs are required and how to run PAVExpress. This session will present results of 30 iterations of a design example and discuss what to consider.

### **PAVExpress: Getting Comfortable with the Design Tool**

*Danny Gierhart, Asphalt Institute*

### **PAVExpress Design Example: What to Consider**

*Danny Gierhart, Asphalt Institute*

## **Session 80: New Records Management Processes**

*Moderator: Brad D. Doucet*

*Lower Level Meeting Room 1*

Over the past few years, DOTD has worked to improve and expand the effectiveness and efficiency of the Agency's Records Management Program. While many of these improvements are in place, there are even more improvements planned for the near future. This session will discuss some of the initiatives that will be most impactful to the DOTD Records Management Program going forward.

### **Content Management Upgrade**

*Shermaine Haymer, DOTD*

### **Centralized Scanning**

*Claire Dixon, DOTD*

# Speaker Index

## A

Abu-Farsakh, Murad—18  
Adler, Jeff—10  
Aguillard, Barbara—24  
Alaywan, Walid—19  
Albrecht, Paul—24  
Al-kaimakchi, Anwer—17  
Allen, JD—22  
Amer, Ahmad Sharif—15  
Anderson, Eric—24  
Anderson, Rachel—17  
Arcre, Gabriel—13

## B

Ballmer, Dallas—17  
Bedgood, Josh—12  
Bedwell, Jessica—22  
Belitsky, Neal—10  
Benn, Angela—21  
Blache, Corinne—26  
Bonzon, Wade—17  
Boone, Shane—24  
Bordelon, Melanie—25  
Botros, Amir—13  
Boudreaux, Ben—11  
Brabham, Brett—23  
Brasseaux, Doreen—19  
Brauner, Kurt—11  
Breedon, Skip—18, 24  
Brewbaker, Cindy—23  
Brignac, Christina—14  
Brignac, Joyce—21  
Brocato, Sarah—12  
Broemmelsiek, John—11, 25  
Bucci, Mark—19  
Burns, Jason—23

## C

Caillet, David—11  
Calcote, Sharon—22  
Cangelosi, Greg—16  
Cannaday, Chris—16

Carr, Jason—16  
Carr, Stacey—13  
Chauhan, Akhil—15  
Cheek, Mark—13  
Chen, Qiming—13  
Chen, Xingwei—13  
Chenevert, Mark—19  
Coco, Joey—13, 25  
Codjoe, Julius—18, 21  
Cole, Mark—14  
Colvin, Jody—11, 14, 25  
Cooper, III, Samuel—19  
Cox, Stacey—21  
Coxe, Carey—14, 22  
Crampton, Sam—11  
Crothers, Daniel—20  
Crout, Monica—16  
Cummins, Dortha—22

## D

D'Andrea, Artur—11  
Daniels, Jerri—11  
Dasenbrock, Derrick—15  
Davis, Jason—13, 26  
Deroche, Eric—18  
DeVille, Jessica—17  
Ditko, Mark—10  
Dixon, Claire—26  
Doakes, Laronda—21  
Donmyer, M. Todd—12  
Doolittle, Stephanie—11, 15  
Druen, David—16  
Duchesne, Juan—17  
Duet, Jason—16  
Dufrechou, Carlton—16  
Dunlevy, TJ—23  
Duplantis, Josh—23

## E

Elhami, Ray—12  
Erbes, Matthew—14  
Evans, Jan—16

Evans, Scott—20  
Ewing, Chris—24  
**F**  
Faulk, Blanche Z.—21  
Faust, Jeff—24  
Feng, Dana—13  
Ferguson, Nicholas—19  
Fillastre, Chris—12  
Fletcher, Les—17  
Forest, Geoffrey—23  
Fournier, Jerome—18  
Fruge, Nick—20  
Fu, Jenny—25  
Fulcher, Case—11  
Fulcher, Case—15  
Fusilier, Jacob—14

## G

Garland, James—11, 14  
Gaspard, Kevin—18  
Gautreau, Gavin—19  
Gerhart, John—23  
Gierhart, Danny—24, 26  
Gonterwitz, Kyle—14  
Goodman, Randy—12  
Gorbaty, Mike—23  
Gravois, Taylor—22  
Green, Keycha Alexander—21  
Grenfell, Jan—14  
Grisby, Venice—26  
Grubb, Michael—11  
Guard, Julia—14  
Gudiel, Francisco—11  
Gudishala, Ravindra—21  
Guidry, Chris—19

## H

Haight, Roger—17  
Hanifa, Khalil—11  
Hanks, Anna—14, 23  
Harmon, Mo—10

Harris, Joubert—11  
Harrouch, Joshua—25  
Haymer, Shermaine—26  
Helus, Terri—17  
Hicks, Melvin—19  
Hines, Jason—15  
Hingle, Stewart—23  
Hogan, Scott—22  
Holleman, Bradley—26  
Hollins, Josh—16  
Hsu, Paul—17  
Huggins, Daniel—11  
Huval, Jr., David—16

## I

Icenogle, Patrick—15  
Isemann, Robert—23  
Ishman, Naquan—20

## J

Jesclard, Trey—11  
Johns, Matt—25  
Johnson, Brandon—11  
Johnson, Joy—16  
Johnson, Kurt—26  
Jones, Jeff—15  
Jones, Matt—11  
Jones, Matthew—26

## K

Keller, Kevin—12  
Kemp, Kelly—11  
Kenrick, Brian—22  
Khan, Sadik—17  
Knight, William "Bubba"—15  
Knotts, Chris—19  
Kurts, JoAnn—16

## L

Lacombe, Jason—16  
Ledet, Cullen—22  
Lee, Adele—17  
Liang, John—13

# Speaker Index

---

Linton, Juanita—21

Luke, Shawn—18

Lukes, George—10, 12

Lynch, Chad—18

## M

Magallan, Ben—22

Mahdi, Moinul—19

Maher, Claude—18

Major, Dahrlene—19, 23

Marretta, Leo—25

Marsh, Ian—20

Mayeux, Corey—19

McAdams, Mary Jean—22

McCoy, Kendra—17

McGormley, Jonathan—25

McMorris, Chris—22

Melton, Kevin—12

Mergenmeier, Andy—13

Metcalf, William—13

Miles, Jason—25

Milla, Jose—19

Mitchell, Ralph—17

Mitran, Elisabeta—21

Mohammad, Louay—19

Montz, Thomas—20

Moore, Brian—25

Moore, Tanya—16

Moran, Ashley—15, 18

Morna, Deano—18

Morrell, Jason—14

Morris, Justin—11

Muffoletto, Michael—20

Murphy, Yvonne—20

## N

Neyland, Codi—12

Nickel, Charles—23

Nickel, Chris—11

Nickel, Timothy—14

## O

Okeil, Ayman—11

Orr, David—15

Ostuno, Barbara—15

## P

Parker, Chad—18

Paul, Mike—22

Peng, Xin—17

Phelps, Olivia—25

Phil, Eric—23

Pierson, Don—22

Piller, Herb—22

Pope, Heath—24

Prucz, Zolan—19

Putnam, Laura—26

## R

Raghavendra, Amar—15

Rando, Brian—25

Rascoe, Carl—13

Ray, Jared—18

Raymond, John—23

Reid, Jonathan—25

Reiffer, Matt—16

Retterer, Taya—17

Roddy, Paula Merrick—21, 23

Rodriguez, Geoffrey—19

Roesel, Jeff—25

Roth, Patrick—24

Roubique, Chad—12, 19

Ruley, Jennifer—14

Rupnow, Tyson—10

Rybeck, Rick—18

## S

Salari, Saman—13, 19

Sanders, Randy—23

Sarker, Debojit—24

Saunders, William—19

Scheurmann, Ed—16

Schmid, Ann Therese—16

Schmidt, Bob—16

Schneider, Helmut—20

Schutt, Mike—16

Scullion, Tom—18

Seliem, Hatem—19

Sewell, Mike—25

Sirles, Phil—15

Smith, Euphemia—21

Smith, Jay—12

Speck, Jeff—13

Spurlock, D'Ion—20

St. Cyr, Mark—23

Stich, Bethany—12

Stinson, Donna—21

Stokes, TJ—16

Stopher, Peter—20

Strength, Steven—25

Stringfellow, Mary—16, 20

Sturdivant, Phillip—20

## T

Taggart, Stacia—14

Thapa, Raju—21

Thomas, Tim—24

Thompson, Joe—14

Tigelaar, Jaap—25

Toney, Patrick—23

Tourres, Valerie—15

Tramonte, Betsy—11

Tsai, Ching—17

## U

Umeozulu, Joachim (Joe)—14

## V

VanFleet, David—10

Vaught, Paul—11, 15

Verret, Mark—15

Villavaso, Steve—18

Vinik, Paul—19

## W

Wade, Mac—12

Waggenspack, Derek—16

Wallace, Craig—10

Wallace, Rhonda—21

Wang, Jay—24

Ward, Kathy—23

Warren, Lesia—26

Wasiuddin, Nazimuddin—24

Wheat, Garrett—21

Whitchurch, David—11

Whittaker, Ron—24

Wills, Ann—21

Wills, Joe—21

Wilmot, Chester—21

Wilson, Shawn—16

Winchester, Chad—19

Windmann, Andrew—22

Wright, Brian—13, 19

Wu, Zhong—10, 13, 19

## Y

Young, Ana—16

Young, Vick—17

## Z

Zeringue, Kirk—15, 21

Zhang, Doc—19

# Conference Committees

## EXECUTIVE COMMITTEE

Mary Leah Coco, Chair  
 Tyson Rupnow, Co-Chair  
 Doreen Brasseaux (ACEC)  
 Myles Brumfield  
 Samuel Cooper, Jr.  
 Michael Demouy (AGC)  
 Joshua Hollins  
 Todd Jeter (FHWA)  
 Phil Jones  
 Barry Keeling  
 Chris Knotts  
 Vince Latino  
 Bridget LeBlanc  
 Erich Ponti (LAPA)  
 Bill Temple (CAAL) Secretary  
 Shawn Wilson Committee  
 Chairs/Co-Chairs

## INDUSTRY RELATIONS COMMITTEE

Kaitlyn Boudreaux, Chair  
 Emily Wolfe, Co-Chair  
 Brian Buckel  
 Doreen Brasseaux  
 Chris Abadie  
 Jenny Gilbert  
 Suzanne McCain  
 Kimberly McDaniel

## PLANNING COMMITTEE

Theodore Ball  
 Keith Beard, Room Monitor Liaison  
 Kaitlyn Boudreaux (GEC), Industry Relations Chair  
 Michael Boudreaux, Program Co-chair  
 Sandra Brady  
 Layne Brown  
 Brian Buckel (GEC)  
 Mary Leah Coco, Executive Committee Chair  
 Samuel B. Cooper, Jr.  
 John Dean  
 Joe Drago  
 Brad Doucet, Audiovisual/IT Chair  
 Jeff Eichholtz  
 Patrick Frazier  
 Jenny Gilbert  
 VJ Gopu  
 Paul Hendricks  
 Sheri Hughes  
 Heather Huval

## AUDIOVISUAL (AV)/INFORMATION TECHNOLOGY (IT) COMMITTEE

Brad Doucet, Chair  
 Paul Hendricks  
 David Jumper  
 Kim Lanceslin  
 Adele Lee  
 Patrick Mehaffey  
 Todd Stevens

## CONFERENCE OPERATIONS COMMITTEE

Allison Landry, Chair  
 Angela Rovaris, Co-Chair  
 Patrick Frazier  
 Sheri Hughes  
 Kristina Kleinpeter  
 Bridget LeBlanc  
 Melissa Lee  
 Keri Norton

## COMMUNICATIONS COMMITTEE

Philip Macaluso, Chair  
 Donald Bastin  
 Shawn Berg  
 Joe Drago  
 Jimmie Edwards  
 Mitch Fredericks  
 Frank "Gil" Lea  
 Mark Vignes

David Jumper  
 Jenny Kirkland, Publications Chair  
 Kristina Kleinpeter  
 Allison Landry, Conference Operations Chair  
 Bridget Leblanc  
 Melissa Lee  
 Phillip Macaluso, Communications/Transp. Chair  
 Shirley Mamou  
 Patrick Mahaffey  
 Chris Melton  
 Susan Nichols  
 Keri Norton  
 Rebecca Rizzutto, Registration Chair  
 Angela Rovaris, Conference Operations Co-chair  
 Keri Norton  
 Tyson Rupnow  
 Kelvin Stone  
 Garrett Wheat, Program Chair  
 Brenda Wolfe  
 Emily Wolfe, Industry Relations Co-chair

## REGISTRATION COMMITTEE

Rebecca Rizzutto, Chair  
 Layne Brown  
 Sandra Brady  
 John Dean  
 Carmel Dysart  
 Jeff Eichholtz  
 Patrick Frazier  
 Tyra Guthrie  
 Sheri Hughes  
 Heather Huval  
 Jason Hooper  
 Shirley Mamou  
 Yolanda Marshall  
 Susan Nichols  
 Annisia Osborne  
 Nicole Robinson  
 Kelvin Stone  
 Rhea Victorian  
 Brenda Wolfe

## PUBLICATIONS COMMITTEE

Jenny Speights, Chair  
 Jenny Gilbert  
 Chris Melton  
 Emily Wolfe

## PROGRAM COMMITTEE

Garrett Wheat, Chair  
 Michael Boudreaux, Co-Chair  
 Noel Ardoin  
 Keith Beard  
 Connie Betts  
 Molly Bourgoyne  
 Kurt Brauner  
 Skip Breeden  
 Shane Caldwell  
 Jason Chapman  
 Mark Chenevert  
 Jody Colvin  
 Dortha Cummins (LHSC)  
 Artur D'Andrea  
 Michael Demouy (AGC)  
 M. Todd Donmyer  
 Dana Feng  
 Patrick Frazier  
 Jenny Fu  
 Tanya Moore  
 Stephen Glascock  
 Chris Nickel  
 VJ Gopu  
 Brian Owens  
 Chris Guidry  
 Laura Phillips (FHWA)  
 Stewart Hingle  
 Erich Ponti (LAPA)  
 Michelle Horne  
 Paula Roddy  
 Sheri Hughes  
 Geoffrey C. Rodriguez  
 Don Johnson  
 Tyson Rupnow  
 Phil Jones  
 Scott Rundell  
 Kelly Kemp  
 Bob Schmidt (ACECL)  
 Brian Kendrick  
 Dawn Sholmire  
 Pat Landry  
 David Smith  
 Eric Lanier  
 Steven Strength  
 Charles McBride  
 Bill Temple (CAAL)  
 Adriane McRae  
 Paul Vaught  
 Jim Mitchell  
 Mike Vosburg



# Over 30 Years of Excellence

# LTRC *impact*

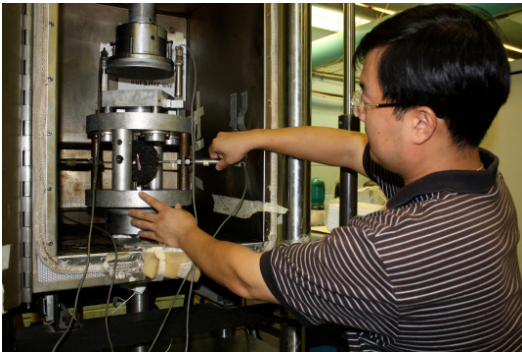

## Who We Are

Created by the Louisiana legislature in 1986, LTRC's mission is to effectively merge the resources of the Department of Transportation and Development (DOTD)/LTRC and state universities to provide transportation-related research, education, and training in a manner that addresses the problems and needs of the transportation industry, supports local government, advances transportation technology, benefits Louisiana's universities, and provides optimal return on taxpayers' dollars.



## What We Do

The **LTRC Research Program** emphasizes applied research and technology to solve transportation problems encountered by DOTD and the general transportation community. Input for research programs is solicited from state and local government, universities, and private industry. This is accomplished through both an in-house and contract research program. Our research program includes Materials, Pavements, Geotechnical, Structures, Traffic and Intelligent Transportation Systems (ITS), Safety, Operations, and Policy, Planning, and Intermodal.



Through the **LTRC Technology Transfer and Training Program**, LTRC answers its broader responsibilities to the transportation community. By means of publications, seminars, courses, workshops, and social media, LTRC creates a communications network for dispersing information and sharing knowledge that spans from emerging research and technology to the grass-roots level of application. LTRC's tech transfer and training functions are accomplished through these primary programs: Structured Training Programs, External Educational Resources, Technology Transfer and Development, Local Technical Assistance Program (LTAP), and Publications and Electronic Media Development Program.

## Facilities

LTRC is comprised of three main facilities: the LTRC building, Transportation Training and Education Center (TTEC), and the Louisiana Pavement Research Facility.



In addition to in-house core asphalt, concrete, soils, and pavements laboratories, LTRC houses wide-ranging testing devices such as an Accelerated Loading Facility (ALF), ATLaS 30, the Engineering Materials Characterization and Research Facility (EMCRF), the Geotechnical Engineering Research Laboratory (GERL), and the Intelligent Transportation Systems (ITS) Laboratory.



## 2020 Louisiana Transportation Conference Documentation of Professional Development Hours

### Print Name

Date and Time	Session Title	PDHs
Sunday, 3/1/2020, 3:30-4:30 p.m., or Wednesday, 3/4/2020, 2:30-3:30 p.m. 1.0 PDH available*	Standards of Practice for Boundary Surveys in Louisiana	
Sunday, 3/1/2020, 4:30 p.m.-5:30 p.m., or Wednesday, 3/4/2020, 1:30 p.m.-2:30 p.m. 1.0 PDH available*	Professionalism & Ethics for Engineers & Land Surveyors	
<b>TOTAL PDHs EARNED IN ETHICS and/or SURVEYING</b>		

Date and Time	Session Title	PDHs
Monday, 3/2/2020 8:30a.m.–11:30 a.m. 2.0 PDHs available*	General Session	
Monday, 3/2/2020 1:00 p.m.–2:45 p.m. 2.0 PDHs available*	1: Tolling: Where Are We Going?	
	2: 3D Design and Project Delivery	
	3: Concrete 1	
	4: Bridge Design Policies and Procedures	
	5: Amite River Numerical Model	
	6: Live from Baton Rouge, It's the Materials Lab	
	7: The Wondrous World of Highway Safety	
	8: FHWA Innovation Highlights	
	9: Management Systems Updates	
	10: District Emergency Projects	
Monday, 3/2/2020 3:15 p.m.–5:00 p.m. 2.0 PDHs available*	11: Innovative Ways of Multimodal Commerce	
	12: Design Developments	
	13: Concrete 2	
	14: Bridge Load Rating and Evaluation	
	15: Pavement Technologies and Safety	
	16: Innovative Materials Testing	
	17: Innovations Showcase	
	18: Environmental	
	19: DOTD's System of Engagement	
	20: Designing for Pedestrians and Bicyclists with Safety in Mind	

Date and Time	Session Title	PDHs
Tuesday, 3/3/2020 8:00 a.m.–9:45 a.m. 2.0 PDHs available*	21: Student Presentations / Awards	
	22: NexGen 911: The Crossroads of Transportation and Telecommunications in Our Near Future	
	23: Alternative Delivery Methods: Mega Projects	
	24: Bridge Funding Programs and Project Selection	
	25: Advanced Geotechnical Exploration Methods (A-GaME)	
	26: E-Construction Initiative (Materials)	
	27: Expanding the Safety Analysis Tool Box	
	28: Technology is the Future of ITS and the Future is NOW	
	29: The Centroid for Enterprise GIS	
	30: ROW Permits, Joint Use Agreements, Utility Relocations, and Innovations in SUE	
Tuesday, 3/3/2020 10:15 a.m.–12:00 p.m. 2.0 PDHs available*	31: Local Public Agencies	
	32: Dispatches from the Front Line of Alternative Delivery and the Future of Transportation Funding	
	33: Smart Travel Choices Using Real-Time Traffic Information	
	34: Nationwide Bridge Projects, Best Practices, and Research	
	35: Geotechnical State of Practice and Research	
	36: E-Construction Initiative (Construction)	
	37: Advancements in Safety Analysis	
	38: Sunshine Bridge Incident: the Impact on Local Emergency Response	
	39: Maintaining Data Sources for Enterprise GIS	
	40: Innovations in Railroad Crossing Safety	

\*2.0 PDH maximum assigned for each session based on anticipated contact time. If contact time is less than scheduled, PDHs are to be adjusted accordingly (50 minutes of contact time = 1PDH).

Date and Time	Session Title	PDHs
Tuesday, 3/3/2020 1:00 p.m.–2:45 p.m. 2.0 PDHs available*	41: Innovative Infrastructure Funding Solutions	
	42: Swamp Tank: Up to Our Ears in Alligators	
	43: Partnering Between DOTD and the Consultant Community (Panel Discussion)	
	44: Bridge Rehab and Construction/ Operations Support	
	45: Construction	
	46: Pavement Preservation Programs	
	47: DOTD Cost Recovery Issues and Emergency Response	
	48: ITS Operations – Traffic Incident Management	
	49: Understanding the Economic Benefits of Public Investment in Transportation Infrastructure	
	50: ADA and Title VI	
Tuesday, 3/3/2020 3:15 p.m.–4:15 p.m. 1.0 PDHs available*	51: Compliance (Panel Discussion)	
	52: Swamp Tank: Digging Out of the Swamp	
	53: Right of Way	
	54: Bridge Projects (Widening and Replacement)	
	55: I-10 Baton Rouge Corridor Improvements	
	56: EDC Initiative: Collaborative Hydraulics: Advancing to the Next Generation of Engineering	
	57: Off the Pavement	
	58: National Public Transportation Safety Program (Panel Discussion)	
	59: Addressing Distracted Driving	
	60: Multimodal Economic Development	

Date and Time	Session Title	PDHs
Wednesday, 3/4/2020 8:00 a.m.–9:45 a.m. 2.0 PDHs available*	61: The Future of Multimodal Transportation	
	62: Roadway Design, Coordination, and Project Delivery	
	63: Consultant Contract and Construction Contract Updates	
	64: Movable Bridges/Lighting Program	
	65: Pavement Research and Implementation	
	66: Bridge Maintenance	
	67: Sunshine Bridge – District Operations Response	
	68: Improving Safety in Workzones	
	69: Louisiana Asphalt Pavement Association 1 – Pavement Preservation	
	70: Funding Sustainability and the TTF	
Wednesday, 3/4/2020 10:15 a.m.–12:00 p.m. 2.0 PDHs available*	71: Metropolitan Planning Organizations	
	72: Innovative Intersection Design	
	73: Traffic Engineering Policies and Procedures	
	74: Sunshine Bridge Emergency Repair	
	75: LTAP Cornucopia! Going Local	
	76: Contract Administration of Local Public Agency Projects	
	77: From Private to Public Sectors, LiDAR Scanning is Revolutionizing the Land Surveying Industry!	
	78: Legal Panel Discussion	
	79: Louisiana Asphalt Pavement Association 2 – PAVExpress	
	80: New Records Management Processes	
<b>TOTAL PDHs EARNED</b>		

\*2.0 PDH maximum assigned for each session based on anticipated contact time. If contact time is less than scheduled, PDHs are to be adjusted accordingly (50 minutes of contact time = 1.0 PDH).

Total PDHs earned through attendance at the 2020 Louisiana Transportation Conference (17.0 available) \_\_\_\_\_

PDHs earned in Professional Ethics at the 2020 Louisiana Transportation Conference (1.0 available) \_\_\_\_\_

PDHs earned in Standards of Practice for Boundary Surveys in Louisiana at the 2020 Louisiana Transportation Conference (1.0 available) \_\_\_\_\_

I hereby attest that I have attended the sessions documented on this form and that the cumulative PDHs total above is accurate.

\_\_\_\_\_  
Signature of Attendee





# **LOUISIANA TRANSPORTATION CONFERENCE**

**March 1-4, 2020**

**Raising Cane's River Center, Baton Rouge**

**[www.ltrc.lsu.edu/ltc\\_20](http://www.ltrc.lsu.edu/ltc_20)**