



LOUISIANA TRANSPORTATION CONFERENCE

*Partnerships for Delivering a
Safe, Equitable, and Sustainable
Transportation System*

MARCH 12-15, 2023
RAISING CANE'S RIVER CENTER
BATON ROUGE, LA

https://www.ltrc.lsu.edu/ltc_23

THANK YOU TO OUR CONFERENCE SPONSORS

Platinum



Gold

AECOM



Coffee Sponsors



Silver



Bronze



Special thanks to the following companies for sponsoring the Sunday evening Speaker Reception:

Ergon Asphalt and Emulsions ~ Diamond B Construction Co., LLC ~ Material Resources, Inc. ~ Brudd Construction
Prairie Contractors, LLC ~ Madden Contracting Co Inc ~ Music Provided by Mobile Beats

CONFERENCE HOSTS



River Center Maps	2	Monday (3:30 p.m.—4:20 p.m.)	12
Conference Information	3	Monday (4:40 p.m.—5:30 p.m.)	14
Downtown Restaurant Map	4	Tuesday (8:00 a.m.—9:45 a.m.)	15
DOTD Business Conference	5	Tuesday (10:15 a.m.—12:00 p.m.)	17
Tabletop Displays	6	Tuesday (1:00 p.m.—1:50 p.m.)	19
LTC App and Social Media	6	Tuesday (2:10 p.m.—3:00 p.m.)	20
Graduate Student Poster Presentations	7	Tuesday (3:30 p.m.—4:20 p.m.)	22
Program At-a-Glance	8	Wednesday (8:00 a.m.—9:45 a.m.)	23
Session Descriptions.....	10	Wednesday (10:15 a.m.—12:00 p.m.)	25
Monday (1:00 p.m.—1:50 p.m.)	10	Speaker Index	27
Monday (2:10 p.m.—3:00 p.m.)	11	PDH Documentation Form.....	31

SHUTTLE SERVICE

Shuttle transportation will be provided between the conference hotels and the Raising Cane's River Center (RCRC) as well as the USS Kidd during the speaker's reception. Please look for conference signage at the conference hotels for designated shuttle pick-up and drop off locations. For the duration of the conference, the designated shuttle pick-up and drop-off location at the RCRC is the Exhibition Hall Lobby Area. Conference signs will include transportation times and maps of the shuttle routes (also printed on back inside cover of the program). Although a schedule has been arranged, shuttle times may vary slightly due to city traffic, peak periods of transport, and unexpected events. However, our goal is to provide service to the RCRC and each conference hotel as quickly as possible. ****Please see inside back cover for maps of the morning and evening shuttle routes.****

Sunday, March 12, 2023—Speaker's Reception

- Shuttles will pick-up from the conference hotels beginning at 4:30 p.m. to drop off at the USS Kidd.
- Speaker Reception: 5:00 p.m. to 7:00 p.m.—*Shuttles will run continuous route until 7:30 p.m.*

Monday, March 13, 2023

AM Shuttle Service:

- 6:30 a.m. until 9:00 a.m.—*Shuttles will run continuous route until 9:00 a.m.*

PM Shuttle Service:

- Exhibitor Reception: 5:30 p.m. until 7:30 p.m.
- Shuttles will leave the RCRC to drop off at hotels beginning at 5:30 p.m.—*Shuttles will run continuous route until 8:15 p.m.*

Tuesday, March 14, 2023

AM Shuttle Service:

- 6:30 a.m. until 9:00 a.m.—*Shuttles will run continuous route until 9:00 a.m.*

PM Shuttle Service:

- Technical sessions end at 4:30 p.m.
- Shuttles will leave the RCRC to drop off at hotels beginning at 4:30 p.m.—*Shuttles will run continuous route until 5:15 p.m.*

Wednesday, March 15, 2023

AM Shuttle Service:

- 6:30 a.m. until 9:00 a.m.—*Shuttles will run continuous route until 9:00 a.m.*

PM Shuttle Service:

- Conference ends at 12:00 p.m.
 - Shuttles will leave the RCRC to drop off at hotels beginning at 12:00 p.m.—*Shuttles will run continuous route until 1:00 p.m.*
- *No shuttle service after the conclusion of the 1:00 p.m. route****

RAISING CANE'S RIVER CENTER MAPS

Second Floor/Level 2

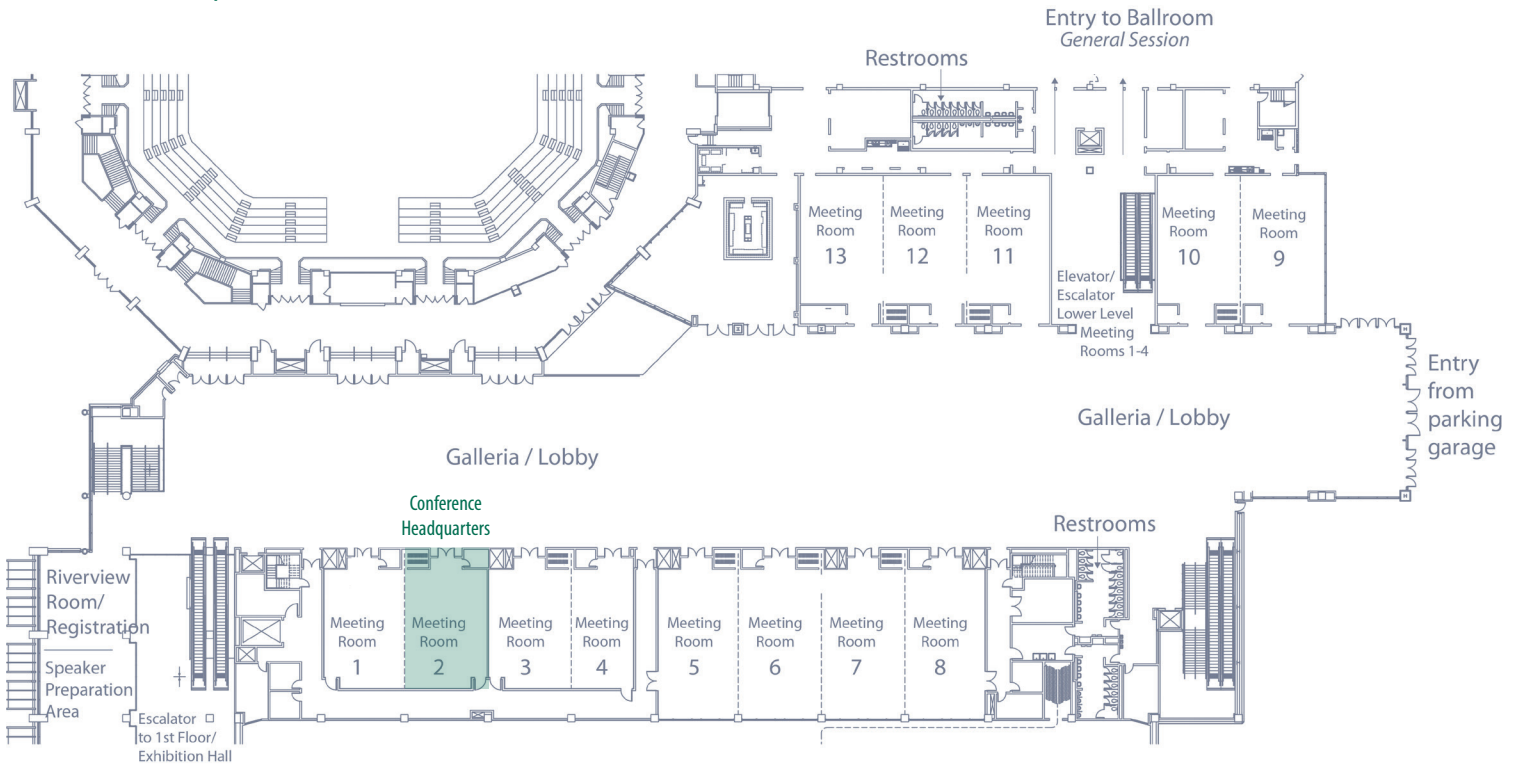

First Floor/ Lower Level Meeting Rooms 1-4

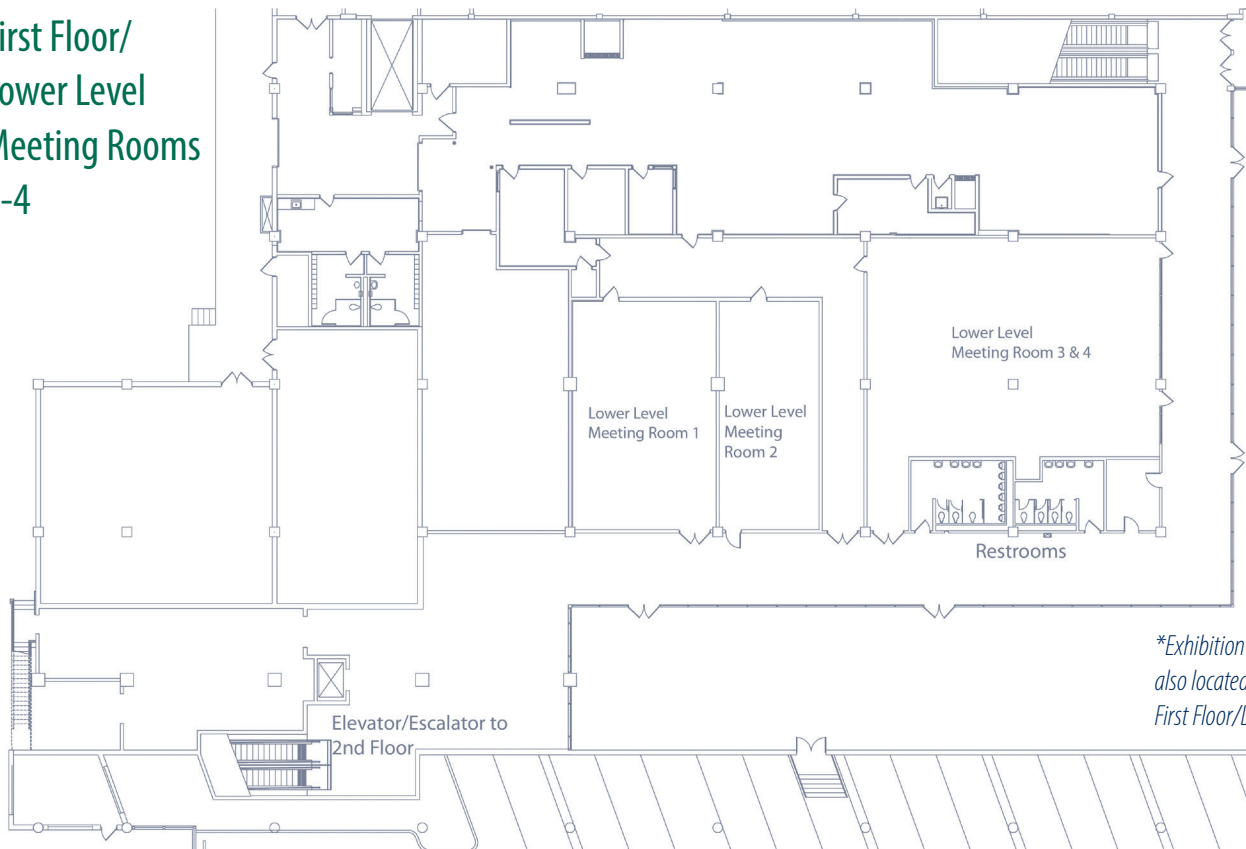

**Exhibition Hall is also located on the First Floor/Lower Level*

CONFERENCE INFORMATION

Conference Headquarters

The 2023 Louisiana Transportation Conference Headquarters is located in Meeting Room 2 on the second floor (Level 2). The Conference Headquarters will be open Sunday, 2 p.m.–5 p.m.; Monday and Tuesday, 7 a.m.–5 p.m.; and Wednesday, 7 a.m.–2 p.m. If you have special needs during the conference, visit the Conference Headquarters and every effort will be made to accommodate your request.

Downtown Dining Options

Please note that Monday and Wednesday lunches are on your own. Tuesday lunch will be provided in the Exhibition Hall. A QR code with a map of restaurants within walking distance is provided on page 4 courtesy of Visit Baton Rouge.

Badge/Name Tag

Please remember to wear your 2023 Louisiana Transportation Conference badge/name tag at all times, as this is your admission to all events.

PDHs for Engineers and Land Surveyors

The program provides abstract information and a schedule of sessions, including the annual engineer/land surveyor license requirement for ethics/boundary surveys. Only the ethics session will be offered twice (on Sunday at 3:30 p.m. and on Wednesday at 1:30 p.m.). Pages 31-32 of this program provide a detachable register to keep track of the sessions that are attended and number of PDHs that are accumulated. *Please note that LTC Conference Management does not verify PDHs; this is up to the attendee to document.*

Industry Exhibits

Exhibits on transportation technologies/products will be displayed during the following times in the River Center Exhibition Hall (ground level):

Monday 3:00 p.m., Exhibit hall will open for afternoon break
5:30 p.m. to 7:30 p.m., Industry Reception

Tuesday 7:00 a.m. to 3:30 p.m.

Speaker Preparation

A laptop and sample room setup will be available in the registration area for speakers to use in preparation for presentations.

Transportation Excellence Awards

An awards ceremony will be held during the General Session on Monday (8:30 a.m.–11:30 a.m.) in the River Center Ballroom.

Conference Evaluation and Presentations

A conference evaluation survey will be sent to you electronically after the conference. Please take a few minutes to respond to the survey, so we can gain your valuable input as we plan the next Louisiana Transportation Conference.



EXPLORE DOWNTOWN BATON ROUGE

Scan the QR code below to discover restaurant options, shopping, nightlife and attractions in Downtown Baton Rouge.



DOTD BUSINESS CONFERENCE

The DOTD Business Conference will be held in conjunction with the LTC on **Tuesday, March 14.**

The Business Conference activities will all take place in Lower Level Meeting Rooms 3 and 4.

8:00 a.m.–9:45 a.m.

Welcome and Introductions, Undersecretary Barry Keeling

Opening Remarks, Don Johnson (Moderator)

Enterprise Support Services, Brad Doucet

- Records Management Improvements
- Decision Support Services

Human Resources, Michelle Sanders

- Employee Assistance Program (EAP)
- Compensation Updates
- PPM Updates

9:45 a.m.–10:15 a.m. | Break

10:15 a.m.–12:00 p.m.

Information Technology, Carryn Sollie

- Overview of OTS in 2023

Audit, Mark St. Cyr

- Audit Issues/Opportunities—LLA
- Consumable Inventory Results and Opportunities

12:00 p.m.–1:00 p.m. | Lunch

1:00 p.m.–3:00 p.m.

Budget, Barbara Aguiard

- Navigating the ZFI1526 for Operating Budget Data

Procurement, Julie Kennison

- Updates since LTC 2020
- Future Hurricane Prep
- Procurement Section Awards and Certifications
- Global Supply Chain Issues, Considerable Price Increases, Excessive Lead Times, Market Volatility

Financial Services, Lesha Woods

- Year-End Close Procedures
- Changes to Card Programs

3:00 p.m.–3:30 p.m. | Break

3:30 p.m.–5:00 p.m.

Panel Discussion

- Financial Services
- Budget
- Audit
- Procurement
- Human Resources
- Office of Technology Services
- Enterprise Support Services

Wrap-Up and Adjournment

TABLETOP DISPLAYS

Visit the following groups on Tuesday, March 14, from 9:45 a.m.–4:00 p.m. in the Exhibition Hall Lobby Area.

Louisiana Transportation Research Center

Staff from LTRC's Technology Transfer and Training section will present the training currently available to employees, answer questions, and provide basic navigation and assistance with the new Success-Factors platform.

Louisiana Local Technical Assistance Program

The Louisiana Local Technical Assistance Program (LTAP) provides training and technical assistance to local public works and transportation agencies across the state. LTAP also administers the Local Road Safety Program and can assist you with crash data analysis, project applications, and field reviews. LTAP is part of the national network of LTAP centers that serve local agencies with training resources, technical information, and innovative solutions that can

help you solve your infrastructure issues. Come by our booth and let's discuss your staff training and technical needs for 2023 and beyond!

Compliance Programs

The Compliance Programs Office will provide information relative to the federal programs we administer: Disadvantaged Business Enterprise Program, Small Business Enterprise Program, Title VI, Labor Compliance, and On-the Job Training.

Highway Safety

Louisiana is driving towards Destination Zero Deaths, with the Strategic Highway Safety Plan (SHSP) as its vehicle to reduce motor vehicle-related fatalities and serious injuries. Stop by our booth today to learn more about the amazing efforts that are happening in our state.

LET'S STAY CONNECTED!

River Center Wi-Fi

LTC Attendees may access wi-fi with the following credentials:

Network name: LTC_Guest

Password: ltc2023

LTC Social Media

Follow Louisiana Transportation Research Center on LinkedIn (<https://www.linkedin.com/company/louisiana-transportation-research-center/>) for real-time conference photos. Use #LTC2023 to share your own posts.

LTC App

We are excited to announce our partnership with Grupio to provide you a unique mobile experience at the LTC. Download the app and access the schedule, sponsors, and exhibitors from your mobile device. *Create a personalized schedule of sessions you want to attend!*

- 1 Search for "Grupio" in the App Store, Android Market, or App World.
- 2 After downloading Grupio, search for event code "ltc23" or find the LTC in the list of available events.
- 3 To log in, your username is your email address you used to register for the LTC. Your password is LTC.

You can also access our mobile website at <https://www.grupio.com/ltc23> or scan the QR code below:

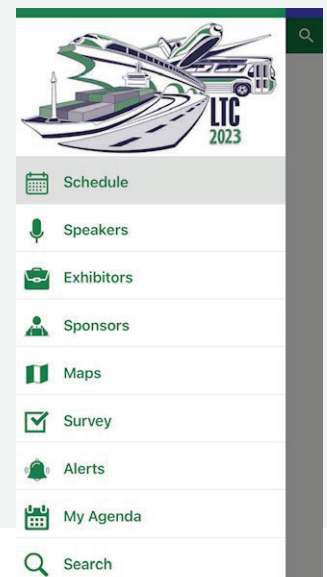

POSTER PRESENTATIONS

Visit the following graduate student projects in the Galleria on Tuesday, March 14, 1:00 p.m.–4:20 p.m.

If you have any questions, please contact Moderator Vijaya (VJ) Gopu, Associate Director, External Programs at V.Gopu@la.gov.

Cellular Core Sandwich Panel Optimization for Bridge Decking Applications

Guillermo Escoto Rodriguez, Mohammad Jamal Khattak, and Tanvir R. Faisal, University of Louisiana at Lafayette

Develop and Evaluate Performance Measures for Intelligent Transportation Systems (ITS) in Louisiana

Kwabena Abedi, Raju Thapa, and Julius Codjoe, University of Louisiana at Lafayette

Development of High Performing Novel Hybrid Hot-Mix Asphalt Mixtures

Muhammad Faizan Asghar, University of Louisiana at Lafayette

Structural Damage Identification for a Pipeline System via Finite Element Model Updating

Huaguan Li and Chao Sun, Louisiana State University

Failure Analysis of Light Poles on Elevated Highway Bridges Exposed to Extreme Winds

Yanlin Chen, Xiangjie Wang, and Chao Sun, Louisiana State University

Investigating Pedestrian-vehicle Crashes on Louisiana Interstate Highways

Ahmed Hossain, Xiaoduan Sun, and Farooq Azam Khanzada, University of Louisiana at Lafayette

Safety Effectiveness of Cable Median Barriers in Louisiana

Safkat Tajwar Ahmed, University of Louisiana at Lafayette

Examining Pedestrian Safety in Urban Arterials in Louisiana

Anish KC and Hany Hassan, Louisiana State University

Evaluating the Safety and Traffic Operation at Cloverleaf Interchanges

Nischal Khadka and Hany Hassan, Louisiana State University

Movimiento Cubano: A Picture of Biking in Cuba

Laura Harris, University of New Orleans

Unsignalized Intersections' Illumination Requirements

Hisham Abdu Kunnah and Hany Hassan, Louisiana State University

The Impacts of Changing Trade Policies on Trade Volumes, Jobs, and Economic Growth in Louisiana Port City Regions and the State of Louisiana

Faisal Mallum, University of New Orleans

Performance Evaluation of Design Methods for Geosynthetic-Reinforced Pile-Supported Embankments

Mohammad Ali Izadifar, Ning Luo, Murad Abu-Farsakh, and Shengli Chen, Louisiana State University

Understanding Phase Separation, Aging Characteristics and SARA Fractions of HDPE, LDPE, and PP Modified Asphalt Binder

S.M. Rahat Rahman, Louisiana Tech

Drivers' Behavior and Preferences towards the Vehicle-to-Infrastructure (V2I) Warning Messages

Taniya Sultana and Hany Hassan, Louisiana State University

PROGRAM AT-A-GLANCE

Sunday, March 12

2:00 p.m.–5:00 p.m.

Conference Registration, *River Center Riverview Room*

3:30 p.m.–4:30 p.m.

Professionalism and Ethics in Engineering

Chris Knotts and Connie Betts, *River Center Meeting Rooms 11, 12, 13*

Monday, March 13

7:00 a.m.–5:00 p.m.

Conference Registration, *River Center Riverview Room*

7:00 a.m.–8:15 a.m.

Continental Breakfast, *River Center Galleria*

7:00 a.m.–8:15 a.m.

Secretary's Breakfast, *River Center Meeting Rooms 6, 7, and 8*
BY INVITATION ONLY

8:30 a.m.–11:30 a.m.

General Session and Transportation Awards Ceremony,
River Center Ballroom

11:30 a.m.–1:00 p.m. | Lunch (on your own)

1:00 p.m.–1:50 p.m.

Concurrent Sessions, *River Center*

1: *Standards of Practice for Boundary Surveys in Louisiana* (Rooms 3-4)

2: *CMAR—Benefits and Lessons Learned on Two Multimodal Projects*
(Rooms 5-6)

3: *EPDs: Like Counting Pavement Calories* (Rooms 7-8)

4: *Diversity, Equity, and Inclusion in Transportation Projects and Programs* (Room 9)

5: *The Pursuit of Concrete Sustainability* (Room 10)

6: *Bridge Design* (Room 11)

7: *Navigating Reimbursement from Declared Disaster Events* (Room 12)

8: *The DOTD FileNet Journey—Past, Present, and Future* (Room 13)

1:50 p.m.–2:10 p.m. | Session Break

2:10 p.m.–3:00 p.m.

Concurrent Sessions, *River Center*

9: *Cultural Resources* (Rooms 3-4)

10: *Planning for Resilience and Sustainability* (Rooms 5-6)

11: *Sustainability Initiatives: How They Benefit Contractors* (Rooms 7-8)

12: *DBE Goal Projects and Estimations* (Room 9)

13: *Active Shooter—Run, Hide, Fight* (Room 10)

14: *UP 101 and Pedestrian Bridge Evaluation* (Room 11)

15: *Local Data Collection Strategies and Uses* (Room 12)

16: *Transportation Innovation and Research Exploration (TIRE)*
Projects—1 (Room 13)

3:00 p.m.–3:30 p.m. | Break, River Center Exhibition Hall

Exhibits open at 3:00 p.m.

3:30 p.m.–4:20 p.m.

Concurrent Sessions, *River Center*

17: *Statewide Flood Control Program* (Rooms 3-4)

18: *District Operations* (Rooms 5-6)

19: *Advancements in Concrete* (Rooms 7-8)

20: *Plan Quality and Publications* (Room 9)

21: *2021/2022 DOTD Emergency Operations Overview* (Room 10)

22: *Long Span Bridges and Sound Barrier* (Room 11)

23: *Elevating Aviation* (Room 12)

24: *Drones and DOTD—The Possibilities* (Room 13)

4:20 p.m.–4:40 p.m. | Session Break

4:40 p.m.–5:30 p.m.

Concurrent Sessions, *River Center*

25: *Amite River Basin Commission Study* (Rooms 3-4)

26: *Trends, Targets, and Tools for Safety Planning* (Rooms 5-6)

27: *Concrete Innovations for Sustainability* (Rooms 7-8)

28: *Transportation Funding for Locals (Existing and New)* (Room 9)

29: *Debris Management at Louisiana DOTD* (Room 10)

30: *Bridge Evaluation/Load Rating* (Room 11)

31: *Port of New Orleans Louisiana International Terminal* (Room 12)

32: *Transportation Innovation and Research Exploration (TIRE)*
Projects—2 (Room 13)

5:30 p.m.–7:30 p.m.

Industry Exhibits/Reception, *River Center Exhibition Hall*

Tuesday, March 14

7:00 a.m.–5:00 p.m.

Conference Registration, *River Center Riverview Room*

7:00 a.m.–8:15 a.m.

Continental Breakfast, *River Center Exhibition Hall*

7:00 a.m.–3:30 p.m.

Industry Exhibits, *River Center Exhibition Hall*

8:00 a.m.–9:45 a.m.

Concurrent Sessions, *River Center*

33: *LA Watershed Initiative Statewide H&H Modeling* (Rooms 3-4)

34: *The Future of Tolling in Louisiana—Leveraging our Partners*
(Rooms 5-6)

35: *Critical Projects—Construction* (Rooms 7-8)

36: *Compliance Programs* (Room 9)

37: *LTAP—Connecting with Safety for Your Locally Owned Roads*
(Room 10)

38: *Bridge Projects* (Room 11)

39: *Coordinating an Informed Approach to C/AV Regulation* (Room 12)

40: *Senior Design Project Presentations and Awards* (Room 13)

9:45 a.m.–10:15 a.m. | Break, River Center Exhibition Hall

**9:45 a.m.–4:00 p.m.**Tabletop Displays, *River Center Exhibition Hall Lobby Area***10:15 a.m.–12:00 p.m.**Concurrent Sessions, *River Center*41: *Innovative Safety Design for All Users* (Rooms 3-4)42: *I-10 Baton Rouge Corridor* (Rooms 5-6)43: *Bridge Rehabilitation Projects* (Rooms 7-8)44: *Applied Geospatial Technology, GIS to Visualize the Seen and Unseen* (Room 9)45: *Oh, No! I Got a Bridge Painting Project!...Why Me?* (Room 10)46: *Geotechnical Data Management Practices* (Room 11)47: *ITS Operations* (Room 12)48: *Transportation Innovation and Research Exploration (TIRE) Projects—3* (Room 13)**12:00 p.m.–1:00 p.m.**Lunch, *River Center Exhibition Hall* (lunch provided)**1:00 p.m.–4:20 p.m.**Graduate Student Poster Presentations, *River Center Galleria/Lobby***1:00 p.m.–1:50 p.m.**Concurrent Sessions, *River Center*49: *Insight from a Forensic Toxicologist: Safety Beyond Infrastructure and Operations* (Rooms 3-4)50: *Federal Funding Transfers and the IIJA Carbon Reduction and PROTECT Programs* (Rooms 5-6)51: *Complete Streets at DOTD* (Rooms 7-8)52: *Advancements in Traffic Data Collection* (Room 9)53: *Innovative Solutions for Soft/Problematic Soils* (Room 10)54: *Evolution of Survey Technology* (Room 11)55: *ITS Maintenance Engineering and Inspection* (Room 12)56: *DOTD Processes* (Room 13)**1:50 p.m.–2:10 p.m. | Session Break****2:10 p.m.–3:00 p.m.**Concurrent Sessions, *River Center*57: *Legal Panel Discussion and 23 USC 407* (Rooms 3-4)58: *IIJA—Bridge and Safety Funding* (Rooms 5-6)59: *Traffic Engineering Signal and Guide Signs* (Rooms 7-8)60: *Management Systems Updates* (Room 9)61: *Concrete Protection and Strengthening Fundamentals, Corrosion Prevention, and Repairs* (Room 10)62: *Utilizing Technology to Aid in Bridge Inspection* (Room 11)63: *Passenger Rail Transportation—Intercity and Local* (Room 12)64: *DOTD Right of Way Permits—Major Project Collaborations* (Room 13)**3:00 p.m.–3:30 p.m. | Break, River Center Exhibition Hall****3:30 p.m.–4:20 p.m.**Concurrent Sessions, *River Center*65: *Legal Topics and Legislative Updates* (Rooms 3-4)66: *HSIP Past, Present, and Future* (Rooms 5-6)67: *DOTD Innovations Showcase—Highlighting Recent Innovation* (Rooms 7-8)68: *Traffic Engineering Study Details and Policy Updates* (Room 9)69: *How to Implement Succession Planning and Counteract “Quiet Quitting”* (Room 10)70: *Bridge Programs* (Room 11)71: *Construction Roundtable* (Room 12)72: *OGFC and Chip Seal Projects* (Room 13)**Wednesday, March 15****7:00 a.m.–12:00 p.m.**Conference Registration, *River Center Riverview Room***7:00 a.m.–8:00 a.m.**Continental Breakfast, *River Center Galleria***8:00 a.m.–9:45 a.m.**Concurrent Sessions, *River Center*73: *GISmos for the Road Ahead* (Rooms 3-4)74: *Electric Vehicle Infrastructure Deployment* (Rooms 5-6)75: *Critical Projects* (Rooms 7-8)76: *Swamp Tank: Draining the Swamp; Making Sense of Research Results* (Room 9)77: *Movable Bridge Projects* (Room 11)78: *LTAP Cornucopia II—Connecting with Local Agency Topics of Interest* (Room 12)79: *Materials Lab: What Can We Do for You?* (Room 13)**9:45 a.m.–10:15 a.m. | Break, River Center Galleria****10:15 a.m.–12:00 p.m.**Concurrent Sessions, *River Center*80: *Roadway Design Projects* (Rooms 3-4)81: *Emergency Bridge Projects* (Rooms 5-6)82: *District Emergency Response Logistics* (Rooms 7-8)83: *Swamp Tank: Return to the Swamp* (Room 9)84: *e-Construction* (Room 11)85: *Transportation Systems Management and Operations (TSMO)* (Room 12)86: *Public Outreach* (Room 13)**12:00 p.m.–1:30 p.m. | Lunch (on your own)****1:30 p.m.–2:30 p.m.**

Professionalism and Ethics in Engineering

Chris Knotts and Connie Betts, *River Center Meeting Rooms 11, 12, 13*

SESSION DESCRIPTIONS

The following pages contain concurrent session titles, a session description, titles of presentations, and names of presenters.

MONDAY 1:00 P.M.–1:50 P.M.

Session 1: Standards of Practice for Boundary Surveys in Louisiana

Moderator: Stan Ard

Meeting Rooms 3–4

Louisiana Standards of Practice for Boundary Surveys is developed to comply with the yearly PDH requirement, set by the LAPELS board, for Professional Land Surveyors in the state of Louisiana.

Louisiana Standards of Practice for Boundary Surveys

Stan Ard, DOTD

Session 2: CMAR—Benefits and Lessons Learned on Two Multimodal Projects

Moderator: Molly Bourgoyne

Meeting Rooms 5–6

Construction Management at Risk or CMAR is “the newest tool in the toolbox” for public agencies to use to plan and construct projects. As with any method, there are good and bad experiences. This session will look at the benefits and lessons learned on using the CMAR process on two dock projects: one at the Lake Charles Port, Harbor and Terminal District and another at the St. Bernard Port, Harbor and Terminal District.

Rehabilitation of 100-year-old Chalmette Slip Dock Sections A & F

Drew Heaphy, St. Bernard Port, Harbor & Terminal District; Janet Evans, Volkert, Inc.; and Ed Scheuermann, Boh Bros, Construction Co

Rehabilitation of the 100-year-old Dock at Berth 2

Nick Pestello, Lake Charles Port, Harbor & Terminal District, and GJ Schexnayder, Boh Bros, Construction Co

Session 3: EPDs: Like Counting Pavement Calories

Moderator: Erich Ponti

Meeting Rooms 7–8

With the passing of the Infrastructure Investment and Jobs Act (IIJA), the Inflation Reduction Act, and the White House Buy Clean Initiative, not only is there a rapidly increased push for decarbonization through public procurement policies requiring Environmental Product Declarations (EPDs), but also increased funding opportunities for states. Learn about what is an EPD, why they are the tool of choice for green public procurement policies, and what states are currently using them and how.

Environmental Product Declaration (EPD)

Nam Tran, National Center for Asphalt Technology

FHWA Climate Change Initiative (EPD Development in Louisiana)

Louay Mohammad, DOTD/LTRC

Session 4: Diversity, Equity, and Inclusion in Transportation Projects and Programs

Moderator: Paula Roddy

Meeting Room 9

This session will detail projects and efforts in Michigan, Tennessee, and Louisiana that are intentional in efforts to ensure coordination with the Equity in Infrastructure Project as well as examine diversity, equity, and inclusion programs in each state’s transportation agency. Other areas of discussion will include minority recruitment in under-represented areas as well as projected programs to include the OJT/Apprenticeship program, in partnership with the foster care and juvenile justice systems.

Equity in Infrastructure Project

Terri Slaughter, Michigan DOT

DE&I in Transit Programs

Vince Malone, Nashville Metro Transit Authority

DE&I in Under-represented Areas; the OJT/Apprenticeship Program

Paula Roddy, DOTD

Session 5: The Pursuit of Concrete Sustainability

Moderator: Amar Raghavendra

Meeting Room 10

What is sustainability and what does it mean for the concrete industry? Cyndi Glascock from Gainey’s Concrete Products, Phil Matisak from Master Builders Solutions, and Tom Diedrich from Holcim will share their thoughts on EPDs (Environmental Product Declarations), GWP (Global Warming Potential), carbon footprint, and ESG (Environmental, Social, and Governance) issues pertaining to the concrete industry.

Tom Diedrich, Holcim

Cyndi Glascock, Gainey’s Concrete

Phil Matisak, MBCC

Session 6: Bridge Design

Moderator: Zhengzheng “Jenny” Fu

Meeting Room 11

Discuss projects to address bridge design challenges.

Evaluation of Elastomeric Bearing Pad Performance

Jon McGormley, Wiss, Janney, Elstner Associates, Inc.

Concrete Material Properties and Camber Data Collection

David Tomley, Gulf Coast Prestress

Session 7: Navigating Reimbursement from Declared Disaster Events

Moderator: Kevin Reed

Meeting Room 12

Presentations by FEMA, FHWA, and DOTD will discuss the rules and processes pertaining to reimbursement of federal funds for declared disaster events.

Transportation Damage Repairs and FEMA Public Assistance

Daniel Crothers, GOHSEP

Louisiana Division FHWA Emergency Relief Program

Daniel Suarez, FHWA

How We Get Our Money Back

Kim Darby, DOTD

Session 8: The DOTD FileNet Journey—Past, Present, and Future

Moderator: Brad Doucet

Meeting Room 13

This session will review some of the most useful user tricks, such as easily finding content with full-text and property search templates. We will show how simple search tips can help you find the content you need when you need it. Then we will provide examples of how current DOTD sections and districts have increased their productivity with enhanced document management and governance. In the “What’s Next” section, we will showcase the new bulk document upload process and some of the exciting document workflow opportunities with an example of an automated email notification when a deadline is approaching.

Day One to Go Live

FileNet Productivity in DOTD Sections and Districts Enhancements and What’s Next

Shermaine Haymer, Access Sciences

MONDAY 2:10 P.M.–3:00 P.M.

Session 9: Cultural Resources

Moderator: Stacie Palmer

Meeting Rooms 3-4

Section 106 of the National Historic Preservation Act applies to all federal undertakings, including DOTD’s federal-aid program. Coastal Environments, Inc. (CEI), was hired by DOTD to perform Phase 1, 2, and 3 cultural resources work in accordance with Section 106 for the I-10 widening project in Calcasieu Parish. CEI will present this work. DOTD owns a number of historic bridges and also funds many off-system bridge projects that involve historic bridges. When these historic bridges need work, DOTD, in coordination with the Federal Highway Administration (FHWA), must comply with Section 106 of

the National Historic Preservation Act. To streamline the process, DOTD, FHWA, the Louisiana State Historic Preservation Officer and the Advisory Council on Historic Preservation entered into a Historic Bridge Programmatic Agreement (PA) in 2015. DOTD’s Environmental Section will present a review of the PA and the ongoing update.

Recent Archaeological Investigations at the Norris Point Site (16CU128)

Sara Hahn, Coastal Environment Inc.

Streamlining Section 106 for Louisiana’s Historic Bridges

Carey Cox, DOTD

Session 10: Planning for Resilience and Sustainability

Moderator: Dawn Sholmire

Meeting Rooms 5-6

This session will feature the Long-Range Transportation Planning Process guide, which is a guided process that will assist local decision-makers in determining the community’s needs, setting goals and objectives for reaching the community’s vision, and developing strategies needed in order to sustain a successful future. This session will also cover how local governments and MPOs are currently planning for resiliency.

Long-Range Transportation Planning Process: A Guide for Smaller Local Public Agencies

Jason Duet, DOTD

Local Planning: City of Gonzales

Jackie Baumann, City of Gonzales

“Put Up the Pirogues Sooner”

Matt Johns, Rapides Area Planning Commission (Alexandria MPO)

Session 11: Sustainability Initiatives: How They Benefit Contractors

Moderator: Erich Ponti

Meeting Rooms 7-8

The White House Buy Clean Initiative provides increased funding for federal and state agencies to purchase construction materials with fewer embodied emissions, including asphalt. Learn how the industry sustainability initiatives and recent research can help asphalt producers and contractors take advantage of these opportunities.

Nam Tran, National Center for Asphalt Technology

Session 12: DBE Goal Projects and Estimations

Moderator: Paula Roddy

Meeting Room 9

This session will discuss how DBE projects start at the construction level and move to the Goal Setting Committee for the final determination of the DBE goal.

Construction Goal Estimates

Mark Chenevert, DOTD

Construction Estimates and DBE Goal Spreadsheet Calculation

Charles Nickel, DOTD

Department Goal; DBE Uniform Report; FHWA CONNECT System; Shortfall Analysis

Paula Roddy, DOTD

Session 13: Active Shooter—Run, Hide, Fight

Moderator: Skip Breeden

Meeting Room 10

Run, Hide, Fight—You may need to use more than one option if you encounter an active shooter situation. Learn how not to be a casualty.

Skip Breeden, DOTD

Session 14: UP 101 and Pedestrian Bridge Evaluation

Moderator: Valerie Tourres

Meeting Room 11

This session will discuss projects with railroad impacts and a unique pedestrian bridge evaluation project.

UP 101: Projects with Railroad Impacts

Paul D. Rathgeber, Union Pacific Railroad

Pedestrian Bridge Evaluation

John Weres, Gresham Smith

Session 15: Local Data Collection Strategies and Uses

Moderator: Chad Parker

Meeting Room 12

Collecting and maintaining local data sources can be a challenge given the many agencies and municipalities involved. This session will explore two strategies to accomplish the end goal of having data available on the entire public road system in Louisiana. Discover how LIDAR technology can be a powerful tool to collect and extract attribute data that can cover many aspects from ground elevations to building footprints and 3D models of cities. Also discover the efforts being taken by DOTD to collaborate with MPOs and Planning Districts to collect, maintain, and share information available on local roads in order to have a comprehensive source of data for use and reporting.

Building a Digital Twin of My Hometown—What I Did with 4,860,090,258 Points

Jeremy Penton, DOTD

Local Government GIS Data Collaboration Initiative

Lucas Denson, DOTD

Session 16: Transportation Innovation and Research Exploration (TIRE) Projects—1

Moderator: VJ Gopu

Meeting Room 13

The presentations in this session deal with projects funded by LTRC's TIRE (Transportation Innovation and Research Exploration) program. TIRE program supports junior faculty at Louisiana universities with engineering programs to conduct small-scale, exploratory research in all fields of transportation science, engineering, and education. The research is characterized by: (1) preliminary work on untested and novel ideas; (2) ventures into emerging research ideas; (3) application of new expertise or new approaches to "old" research topics; (4) multi/cross-disciplinary work crossing LTRC program boundaries; and (5) efforts likely to catalyze rapid and innovative advances.

Understanding Asphalt Binder and Waste Plastic Mixing with Fundamental Polymer Physics

Andrew Peters, LA Tech

Highway Right-of-Way Lands for High-Yield Carbon Dioxide Sequestration Using Managed Reforestation Designs

Mark E. Zappi, ULL

MONDAY 3:30 P.M.–4:20 P.M.

Session 17: Statewide Flood Control Program

Moderator: Patrick Landry

Meeting Rooms 3-4

This session will provide an overview of the Statewide Flood Control Program. It will describe the specific requirements of the program and the program application procedures. This annual funding opportunity is in a strong financial position to fund effective flood control projects.

Funding Opportunities: Statewide Flood Control Program

Billy Williamson, DOTD

Session 18: District Operations

Moderator: Joshua Stutes

Meeting Rooms 5-6

DOTD is comprised of nine districts that maintain infrastructure over 64 parishes. This includes operations such as striping and signals to bridge, road, and drainage maintenance. In-house operations rely on experienced personnel and efficiency and with, unfortunately, very tight yearly budgets. This becomes even more challenging with inflation and materials/resources availability and delays. Projects that can't be done with district forces are naturally contracted out once funding is available. Regardless, each project and scope provides its own unique challenges of constructability and biddability as well as maintenance of traffic. Other projects require emergency attention, funding, and action without the time for proper planning

and design. The topics today are going to touch on those types of scenarios where an expedited process and repair is critical to restore the roadway as well as maintenance of traffic. Each of these topics show a small glimpse into recent challenges that were faced in each respective district and how they were overcome.

Emergency Road/Drainage Repair Projects in District 61 Utilizing Tank Car Culverts

Ryan White, DOTD

LA 10 Embankment Slope Stabilization Project Using Soil Nails

Joshua Stutes, DOTD

Remedial Patching of I-20 Through Bossier City

David North, DOTD

Session 19: Advancements in Concrete

Moderator: Michael Demouy

Meeting Rooms 7-8

These presentations will cover the increasing use of Roller Compacted Concrete across the nation and how some is affecting private industry as well as governmental agencies. In addition, we will also discuss how practices in achieving proper slump utilizing appropriate techniques and various admixtures improve the overall quality of concrete pavements/products and promote better performance throughout the concrete's life cycle.

Roller Compacted Concrete

Tyson Rupnow, DOTD/LTRC

Concrete Slump: Quality Control and Sustainability

Tom Greene, GCP Applied Technologies

Session 20: Plan Quality and Publications

Moderator: Steven Mazur

Meeting Room 9

Section 36 was recently created to focus on Publications, Plan Quality, and Conformity. The new group will continue to perform plan quality checks and be the repository of all Office of Engineering directives, standards, manuals, required forms, mandatory checklists, specifications, and design standards. This session will focus on how Section 36 will assist DOTD staff with requests for Publications, Plan Quality, and Conformity.

How DOTD Staff Can Use Specifications and Publications Application

DOTD Representative

How DOTD Staff Can Use PQU Applications (Requests and Comments)

DOTD Representative

Session 21: 2021/2022 DOTD Emergency Operations Overview

Moderator: Skip Breeden

Meeting Room 10

ESF-1 will be briefing on the Louisiana Repatriation Plan. It is the coordinated evacuations of U.S. citizens, their dependents, and other

authorized persons from outside the continental U.S. due to war, invasion, civil unrest, or similar crisis. DOTD ESF-3 (Public Works and Engineering) will be presenting on the 2021 Hurricane Response and Recovery.

ESF-1

Mike Miller, DOTD

ESF-3

Billy Douglas, DOTD

Session 22: Long Span Bridges and Sound Barrier

Moderator: Chris Guidry

Meeting Room 11

This session will discuss long span bridges and sound barrier.

Long Span Concrete Bridges

Matt Lengyel, Figg Bridge Engineers, Inc.

Sound Barrier

Kelly Kemp, DOTD

Session 23: Elevating Aviation

Moderator: Stephen Holliday

Meeting Room 12

Aviation stakeholders in Louisiana continue to manage a very complex transportation situation impacted by the COVID-19 pandemic. Airports are showing signs of recovery with where they were pre-pandemic, where they are now, and where they expect the industry to go. As Louisiana's airport system approaches recovery of operations, visitors, enplanements, and assets, the challenges that lie ahead in system planning efforts and forecasting infrastructure needs for resiliency and economic growth provides a creative construct for development initiatives. These concepts will guide the discussion that will drive policy reform and are important to understanding airport issues and the state of Louisiana's airport system.

State of the System

Brad Brandt, DOTD

LA Airport Pavement Condition Index Study

Kyle Potvin, Applied Pavement Technology

Session 24: Drones and DOTD—The Possibilities

Moderator: Stanley Ard

Meeting Room 13

Drones have recently been incorporated into the Location and Survey Section at DOTD. LIDAR, Photogrammetry, and Thermal sensors are being flown to capture high quality datasets by licensed Part 107 FAA pilots from the Remote Sensing team. This session will show some of the projects completed thus far, which includes imagery, elevation data, and stockpile volume calculations. Weather and time permitting, a short demo flight (field demonstration) may be given.

Imagery, LIDAR, and Thermal Capabilities

Jeremy Penton and Dustin Smith, DOTD

MONDAY 4:40 P.M.–5:30 P.M.

Session 25: Amite River Basin Commission Study

Moderator: Edward Knight

Meeting Rooms 3-4

This session will provide an overview of the development of the High Definition Flood Inundation Map (HD-FIMv1) for the August 2016 Flood within the Amite River Basin. Updated hydrography, digital terrain model, and control points were employed in conjunction with a high-resolution hindcast simulation (2019, Dewberry Engineers, Inc.) of the August 2016 Flood to create the HD-FIMv1, a “state-of-the-art” and “first-in-the-nation” digital map of a major regional flood.

Amite River Basin Commission 2016 High-Definition Flood Inundation Map (HD-FIM)

Bob Jacobsen, Bob Jacobsen Engineering

Session 26: Trends, Targets, and Tools for Safety Planning

Moderator: James Chapman

Meeting Rooms 5-6

Crash data—What is it telling us in general? What tools do we use for analysis? How do we use those tools to create safety projects? How do we use this analysis to ensure safety when designing projects?

SHSP Update

James Chapman, DOTD

Statewide Data Trends Focus on Infrastructure and Ops (Local and State)

Bryan Costello, DOTD

Data Tools/Example Project Level Analysis

Trey Jesclard and Chip Jesclard, DOTD

Session 27: Concrete Innovations for Sustainability

Moderator: Michael Demouy

Meeting Rooms 7-8

These presentations will discuss the widespread use of various concrete chemical admixtures, both present day and future, which promotes a more durable, longer lasting concrete product that leads to higher sustainability goals. We will also cover the use of High Range Water Reducers (HRWRs) and their effects on CO₂ reduction in concrete.

Chemical Admixture Technology: Past, Present, and Future The Impact of HRWRs and Strength Enhancers on CO₂ Reduction

Tom Greene, GCP Applied Technologies

Session 28: Transportation Funding for Locals (Existing and New)

Moderator: Tanya Moore

Meeting Room 9

On November 15, 2021, the Infrastructure Investment and Jobs Act (IIJA) (Public Law 117-58, also known as the “Bipartisan Infrastructure Law (BIL)”) was signed into law. This new BIL creates more opportunities for local governments and other entities. Many of the new programs include eligibility for local governments, Metropolitan Planning Organizations (MPOs), Tribes, and other public authorities, allowing them to compete directly for funding. This session will focus on transportation funding for locals (existing and new) and how the BIL will impact existing and new programs, including the new Bridge Formula Program.

Bipartisan Infrastructure Law (BIL) for Local Governments

Mary Stringfellow, FHWA

Bridge Formula Program for Local Governments

Amanda Ranck and Sarah Moss, DOTD

Session 29: Debris Management at Louisiana DOTD

Moderator: Skip Breeden

Meeting Room 10

An overview of the process and impacts of debris operations and DOTD’s response. What were the impacts over the last two years and what was the response?

Debris Operations: The Aftermath of Disaster

Seth Matherne, DOTD

Session 30: Bridge Evaluation/Load Rating

Moderator: Dana Feng

Meeting Room 11

This session will discuss bridge evaluation/load rating projects.

Continuous Stringer Load Rating

Billy Metcalf, DOTD

CIP Concrete Culvert Load Rating

Mohsen Shahawy, SDR

Session 31: Port of New Orleans Louisiana International Terminal

Moderator: Molly Bourgoyne

Meeting Room 12

To meet the growing needs of the shipping industry, the Port of New Orleans is investing in a new \$1.5 billion container terminal project on the lower Mississippi River—the Louisiana International Terminal. The terminal will create family-supporting jobs, generate new opportunities throughout the state, and keep Louisiana competitive among the neighboring ports of Houston, Gulfport, and Mobile. The

roughly 400-acre terminal is being designed to handle a throughput of 1.2 million containers per year and will include a 3,600-ft. wharf capable of berthing ultra-large container ships as well as river barges, three 1,600-ft.-long ramps over the Mississippi River levee, a modern 160-acre container yard, intermodal railyard, maintenance facilities, and administration areas, incorporating the latest security, communications, and terminal operating systems. Conference attendees will gain an appreciation of the importance of the terminal to the movement of goods throughout the central United States through connections with six Class-I railroads, four interstate highways, and the Mississippi River and its tributaries. The projected long-term economic benefits to the state will be presented along with the projected economic consequences of the no-build option. The environmental permitting process will be discussed, along with development of the engineering design and early contractor involvement. We will also cover efforts toward sustainability and resiliency such as investment in shore power for berthed ships and all-electric terminal equipment, as well as involvement in world-wide organizations and grant programs that support green initiatives. The presentation will also include an overview of coordinated efforts by the Port of New Orleans and the Regional Planning Commission to study and plan for improvements to the rail and roadway transportation corridors to support the terminal as well as the long-term growth of the parish.

The Port of New Orleans' Louisiana International Terminal

Andrew Thiess, HDR, Inc.

Session 32: Transportation Innovation and Research Exploration (TIRE) Projects—2

Moderator: VJ Gopu

Meeting Room 13

The presentations in this session deal with projects funded by LTRC's TIRE (Transportation Innovation and Research Exploration) program. TIRE program supports junior faculty at Louisiana universities with engineering programs to conduct small-scale, exploratory research in all fields of transportation science, engineering, and education. The research is characterized by: (1) preliminary work on untested and novel ideas; (2) ventures into emerging research ideas; (3) application of new expertise or new approaches to "old" research topics; (4) multi/cross-disciplinary work crossing LTRC program boundaries; and (5) efforts likely to catalyze rapid and innovative advances.

Development of Green Concrete Reinforced with Renewable Chitin Nanowhiskers

Dilip Depan, ULL

Achieving Superhydrophobic Surfaces via Air-assisted Electrospray

Ling Fei, ULL

TUESDAY 8:00 A.M.–9:45 A.M.

Session 33: LA Watershed Initiative Statewide H&H Modeling

Moderator: Jie Gu

Meeting Rooms 3-4

This session will focus on the statewide H&H modeling under development through the Louisiana Watershed Initiative and DOTD. Each presenter will provide a 25-minute presentation on their efforts under the LWI Statewide H&H Modeling Program, with each providing a unique perspective of different aspects of the effort.

Region 7: Use Cases From the Amite River Numerical Model

Sam Crampton, Dewberry

Region 2: Modeling the Three Rivers

Jeremy Dixon, Freese & Nichols

Region 4: Surveying Methods for H&H Modeling

Austin Doucet, C.H. Fenstermaker

Regional H&H Modeling Panel

Panel Discussion

Session 34: The Future of Tolling in Louisiana—Leveraging our Partners

Moderator: Scott Rundell

Meeting Rooms 5-6

DOTD Director of Tolling Operations Scott Rundell will present a slide show and discuss the new Safety Corridor Project on the Atchafalaya Basin section of Interstate 10 between Lafayette and Baton Rouge. What is a safety corridor and what is its purpose? How will it work and what are the end goals? Rundell will also moderate a discussion with tolling experts. Topics of discussion will include possible new projects on the horizon in Louisiana, recent changes in how we collect tolls (no toll booth), and the advantages to toll accounts and toll-by-plate options, as well as new trends in tolling across the United States.

I-10 Atchafalaya Basin "Safety Corridor"—Reducing Traffic-Related Deaths Through the Use of Tolling Technology

Scott Rundell, DOTD

Toll Talk

Scott Rundell, DOTD

Session 35: Critical Projects—Construction

Moderator: Corey Landry

Meeting Rooms 7-8

The Critical Projects Division is responsible for the management and delivery of the Department's most high profile and high priority projects. This session will showcase a few of those project that are currently under construction.

- Loyola Dr./I-10 Interchange is a \$128.2 million Design Build project in Jefferson Parish.
- Belle Chasse Bridge and Tunnel Replacement is a \$170 Public Private Partnership (P3) project in Plaquemines Parish.
- I-220/I-20 Interchange Improvement and BAFB Access is an \$80.5 million Design Build project in Bossier Parish.

Loyola Interchange

Cindy Hall, Stantec

P3—Belle Chase

Dennis Coventon, Plenary Infrastructure Belle Chase (PIBC)

Barksdale

Gordon Nelson, Volkert, Inc., and Justin Peltier, Huval & Associates

Session 36: Compliance Programs

Moderator: Paula Roddy

Meeting Room 9

This session will give a brief overview of the DOTD Compliance Programs—Contract Compliance, Labor Compliance, the OJT Program, the ADA/Title VI Program, and the DBE/SBE Program. In addition, demonstrations from the ADA community will be presented.

DBE Program Outreach

Paula Roddy, DOTD

Contract Compliance

Juanita Linton, DOTD

Labor Compliance

Angela Benn, DOTD

On-the-Job (OJT) Program

Joyce Brignac, DOTD

DBE Overview

Rhonda Wallace, DOTD

DBE/SBE Intake, Annual Affidavits, Decerts

Megan Gullett, DOTD

DBE/SBE Certification

Shirley Ard, DOTD

DBE/SBE Interstates/Business Expansion

Warren Morgan, DOTD

DBE/SBE Contract Administration

Keycha Green, DOTD

Sublets and Agreements

Judy Halloran, DOTD

ADA/Title VI Program and ADA Demonstrations

Cynthia Douglas, DOTD

The Practical Challenges Facing the Mobility Challenged

Joe Wills, DOTD Retiree, and Ann Wills, DOTD

Orientation and Mobility, Navigating Life!

Blanche Faulk and LaRonda Doakes, LSVI

Session 37: LTAP—Connecting with Safety for Your Locally Owned Roads

Moderator: Courtney Dupre

Meeting Room 10

Local Road Safety is a cornerstone of the LTAP Program nationally and within Louisiana. Participants in this session will learn about getting your agency involved in promoting and practicing local road safety awareness, complying with new MUTCD standards for pavement marking visibility, taking advantage of new tools available to our locals for developing safety projects, and making your safety program responsive to the safety issues being experienced in your community.

Make It Fun: Out and About with an Eye for Safety

Rudynah Capone, DOTD/LTRC

"Do Not Go Gentle"—Updated MUTCD Retroreflectivity Standards for Pavement Markings

Steven Strength, DOTD/LTRC

2021: A Safety Odyssey—Updating the Local Road Safety Profiles for the Next 5 years

Leo Marretta, DOTD/LTRC, and Peter Allain, LTAP

A Question of Priorities: Choosing Locally Owned Roads for Safety Improvements

Leo Marretta, DOTD/LTRC

Session 38: Bridge Projects

Moderator: Mark Bucci

Meeting Room 11

This session will cover three major bridge projects on I-10, I-49, and LA 1, which are in various project development stages (environmental, design, and construction). These projects utilize different delivery methods (Design-Bid-Build, CMAR, and Design-Build) and various bridge structure types. Design development, project challenges, and lessons learned in these major bridge projects will be presented.

I-10 Widening in Baton Rouge (CMAR)

Justin Peltier, Huval & Associates

LA 1, Phase 2—Project Overview and Design Challenges

Dusty Bastion, HNTB

I-49 Connector Project

Gary Maji, AECOM

Session 39: Coordinating an Informed Approach to C/AV Regulation

Moderator: Alaa Shams

Meeting Room 12

The excitement around the opportunities for C/AVs remains high; however, there still are many more questions than answers as the technologies continues to advance. The panel will provide an overview of the national regulatory landscape for C/AVs through a lens focused on use cases, including on-demand passenger movement, commercial goods movement, and transit. The discussion will focus on use cases that challenge existing governance and regulatory structures and opportunities to improve efficiencies within the transportation system. Truck platooning has been identified as a possible application of using the connected vehicle technology. A truck platoon is a group of trucks that travel closely together and communicate with each other via electronic data transmission. The deployment and operations of truck platooning have a number of benefits for the commercial freight industry. These benefits include the improvement of fuel savings and the reduction of greenhouse gas emissions; the improvement of throughput, mobility, and road efficiency; and the reduction of operating costs.

C/AV Landscape, Use Cases, and Policy and Regulatory Approaches

Greg Rodriguez, Stantec

C/AV Landscape, Lessons Learned from Policy and Regulatory Focused Projects, Goods Movement

Jackie Beckwith, Stantec

Maryland Department of Transportation State Highway Administration 2022 Public Survey around Self-driving Vehicles Focused on Understanding User Modal Decision-making

Mohammed Raqib, Maryland SHA

Perspectives around the Advancement of Automation for Commercial Goods Movement and Industry Priorities to Support Continued National Deployment

Sam Loesche, Waabi

Truck Platooning and Smart Mobility: Powering the Future of Freight Transportation

Hany Hassan and Mohamed Mohamed, LSU

Session 40: Senior Design Project Presentations and Awards

Moderator: VJ Gopu

Meeting Room 13

Teams of civil engineering students from Louisiana universities will present their senior design projects. These projects receive support from DOTD through its Support Program for Civil Engineering Studies.

TUESDAY 10:15 A.M.–12:00 P.M.

Session 41: Innovative Safety Design for All Users

Moderator: Jessica DeVille

Meeting Rooms 3-4

Join us to hear about the latest efforts in transforming roadways to be safe and accessible for all users. Back by popular demand, FHWA's design expert Brooke Struve will discuss the latest and greatest countermeasures for safety-minded facilities. Then learn from a peer DOT about a case study involving a corridor outgrowing its context and classification. Lastly, hear how the LSU AgCenter is aiming to influence policy and assist DOTD with local coordination and planning.

SHSP Update/VRU

Jessica DeVille, DOTD

Speed Management and Innovative Intersections

Brooke Struve, FHWA

Southern Boulevard (Montgomery, Alabama): Abstraction to Application

Aaron White, Alabama DOT

Partnering with Locals for Safer Streets

Justin Lemoine, Atchafalaya National Heritage Area

Session 42: I-10 Baton Rouge Corridor

Moderator: Nicholas Olivier

Meeting Rooms 5-6

I-10 includes widening and reconstruction from six to eight lanes, including bridge replacement and rehabilitation, interchange and ramp modifications, shoulder widening, and auxiliary lanes from LA 415 to Essen Lane. Phase I includes the limits of west of Washington Street to Essen Lane, and Phase II includes the limits of LA 415 to west of Washington Street. Phase I is divided into segments. Segment 1 is currently under design development including the limits of west of Washington St. to Acadian Thruway, including the Acadian Thruway Interchange. The I-10/I-12 WB College Drive Exit project, a preliminary piece of the widening project, is currently underway as a design-build project designed and constructed by the Gulf Engineers and Consulting (GEC) and Boh Brothers Construction Co, LLC.

I-10 Baton Rouge Corridor

Bob Schmidt, Huval & Associates, and Sherri LeBas, GEC

I-10 and I-12 College Drive Exit Improvements

GJ Schexnayder, Boh Bros, Construction Co

Session 43: Bridge Rehabilitation Projects

Moderator: Andrew Windmann

Meeting Rooms 7-8

This session will discuss bridge rehabilitation projects.

Bayou Ramos Bridge Rehabilitation

Sam Sherry, Wiss, Janney, Elstner Associates, Inc.

LA 47: IWGO Bridge Rehabilitation

Durk Krone and Michael Paul, TRC

Overlay Challenges for Orthotropic Deck Bridges (Danziger and Luling)

Jon McGormley, Wiss, Janney, Elstner Associates, Inc.

Session 44: Applied Geospatial Technology, GIS to Visualize the Seen and Unseen

Moderator: Jason Carr

Meeting Room 9

Nearly everything in the transportation industry can be geospatially located. In this session, the Enterprise GIS Unit aims to demonstrate how GIS technology is and can be used to visualize data, analyze, and report information, as well as provide access to DOTD's data. With modern technology, there are limitations as well. We'll also discuss how we receive, investigate, and respond to inquiries and reported problems with the Enterprise GIS.

EOC Enterprise Apps

Monica Crout and Chris Cannaday, DOTD

Bridging the Future and A Deep Dive for Imagery/LIDAR Needs

Brett Weidman and Clinton Cooper, DOTD

Chasing the Rabbit: Help Ticketing

Chris Cannaday and Derek Waggenspack, DOTD

Don't be Trashy

Ana Young and Juliana Delgado, DOTD

Session 45: Oh, No! I Got a Bridge Painting Project!... Why Me?

Moderator: Francisco Gudiel

Meeting Room 10

Coatings provide two purposes: aesthetics and corrosion resistance. Both aspects will be developed and illustrated. Factors affecting these attributes will also be presented and explained. Some of these factors include color, gloss, film thickness, resin chemistry, surface preparation, and environmental conditions. Now that the cleaning and painting contract has let, what happens next? What is expected during the painting operations, and the common challenges that may be encountered? This session will cover the available resources to successfully navigate a coatings project as well as: a short review of laboratory test methodology; test results and performance comparisons between HPCs and current AML systems; and coating systems cost comparison and life cycle cost when using HPCs.

The Value and Purpose of Bridge Coatings

Paul Vinik, GPI

What to Do When you are Assigned a Bridge Painting Project

Tim Thomas, GPI

DOTD High Performance Coatings (HPC) Evaluation Result

Francisco Gudiel, DOTD

Session 46: Geotechnical Data Management Practices

Moderator: Miranda Perkins

Meeting Room 11

As our wealth of geotechnical data increases, it is important that we manage it properly and make the most efficient use of it. This session will shed light on how DOTD is managing and using its data, along with a glimpse into potential future applications.

DOTD's Data Management Practices

Jesse Rauser, DOTD

Geotechnical Data Visualization and Analytics

Xin Peng, Geosyntec

DOTD Geotechnical Asset Management

Gavin Gautreau, DOTD/LTRC

Session 47: ITS Operations

Moderator: Lucy Kimbeng

Meeting Room 12

The ITS Operations involves Traffic Incident Management (TIM), using ITS devices installed on our roadways. TIM is a planned and coordinated multidisciplinary process to monitor, detect, respond to, and clear roadway incidents as safely and quickly as possible, in order to restore operations to normal conditions. This session will discuss how the current Traffic Management Center (TMC) and Motorist Assistance Patrol (MAP) statewide operations work to manage traffic incidents and the advantages/benefits of having one contractor handling both contracts; the benefits of ITS deployment on roadway operations and safety (before and after study of an ITS deployment project); and the I-10 WBR Queue Warning System project.

The Benefits of ITS Deployment on Roadway Operations and Safety

Stephen Mensah, Stantec

Current TMC and MAP Operations Statewide and the Benefits of Having One Contractor Handling Both Contracts

Scott Evans, Gordon Mcconnell, Richard Ardis, Serco

The DOTD I-10 WBR Queue Warning Project

Katherine Thimmesch, Stantec

Session 48: Transportation Innovation and Research Exploration (TIRE) Projects—3

Moderator: VJ Gopu

Meeting Room 13

The presentations in this session deal with projects funded by LTRC's TIRE (Transportation Innovation and Research Exploration) program. TIRE program supports junior faculty at Louisiana universities with engineering programs to conduct small-scale, exploratory research in all fields of transportation science, engineering, and education. The research is characterized by: (1) preliminary work on untested and novel ideas; (2) ventures into emerging research ideas; (3) application of new expertise or new approaches to "old" research topics; (4) multi/cross-disciplinary work crossing LTRC program boundaries; and (5) efforts likely to catalyze rapid and innovative advances.

Exploring the impacts of Vehicle-to-Infrastructure (V2I) Technologies on Drivers' Behaviors and Traffic Safety

Hany Hassan, LSU

Assessing and improving Equity in Post-hurricane Accessibility to Essential Services in Southeast Louisiana

Sabarethinam Kameshwar, LSU

Driver Drowsiness Detection Using Fixed and Dynamic Thresholding

Yasser Ismail, SUBR

Stabilizing Blended Calcium Sulfate (BCS) and Fine-Grained Soil Using Bio-Mediated Soil Improvement

Hai (Thomas) Lin, LSU

[1:00 P.M.–4:20 P.M.]

**Graduate Student Poster Presentations
(River Center Galleria/Lobby)**

Moderator: VJ Gopu

Please refer to page 7 for poster titles and authors.

TUESDAY 1:00 P.M.–1:50 P.M.

Session 49: Insight from a Forensic Toxicologist: Safety Beyond Infrastructure and Operations

Moderator: Autumn Goodfellow-Thompson

Meeting Rooms 3-4

With fatalities reaching a historic high, it seems Louisiana has been traveling in the wrong direction along the safety highway. The recent update of the Louisiana strategic highway safety plan will be serving as our roadmap of response to the tragedies occurring on our roadways. With several factors contributing to this crisis, it takes several areas of expertise to combat against it. Forensic toxicology is one of those fields, and it is taking center stage on the analysis and identification of any substance detected in an impaired driver. The right solution isn't possible without the accurate definition of the problem, and when lives are at stake, the success of our mission cannot be an option because failure becomes fatal.

SHSP Update

Autumn Goodfellow-Thompson, DOTD

Insight from a Forensic Toxicologist

Joseph Jones, North Louisiana Criminalistics Laboratory

Session 50: Federal Funding Transfers and the IIJA Carbon Reduction and PROTECT Programs

Moderator: Mary Elliott

Meeting Rooms 5-6

This session will show how DOTD federal fund transfers compare to other states and some of the whys from the case studies during the FAST Act. It will provide an overview of two new programs estab-

lished under the IIJA. The Carbon Reduction Program provides funds for projects designed to reduce transportation emissions, defined as carbon dioxide (CO₂) emissions, from on-road highway sources. The PROTECT Formula Program provides funds to help make surface transportation more resilient to natural hazards, including climate change, sea level rise, flooding, extreme weather events, and other natural disasters through support of planning activities, resilience improvements, community resilience and evacuation routes, and at-risk coastal infrastructure.

How Does Your DOT's Federal Transfer Compare to Other DOTs?

Sherri LeBas, GEC

IIJA Carbon Reduction Program

Mary Stringfellow, FHWA

IIJA PROTECT Program

Jacquole Johnson, FHWA

Session 51: Complete Streets at DOTD

Moderator: Hadi Shirazi

Meeting Room 7-8

This presentation will discuss the findings for the recent Louisiana Complete Streets Policy Evaluation that was performed; maintaining pedestrian and bike facilities during construction projects, including a discussion of available solutions and requirements for maintaining facilities; and the introduction of the in-development DOTD Complete Streets Course—a half-day course that will explain Complete Streets through applicable resources and real examples. The desired outcome is to both increase the usability of facilities and reduce repeat comments on plan reviews to result in a more efficient path to plan approval.

Evaluation the Impacts of Complete Streets Policy in Louisiana

Tara Tolford, UNO Transportation Institute

Maintaining Pedestrian and Bike Facilities During Construction

Chris FaKouri and Andre Fillastre, DOTD

DOTD Complete Streets Course

Chris FaKouri and Lacey Fish, DOTD

Session 52: Advancements in Traffic Data Collection

Moderator: George Chike

Meeting Room 9

This session will focus on the data collection techniques and traffic data systems in use at DOTD. Presentations will cover the latest advancements in automated, video-based vehicle count and classification machines, making use of machine learning software to decipher vehicles from video images and can be installed without interfering with traffic flow. Also discover alternative methods of collecting weight data on traveling vehicles using portable WIM (Weigh-In-Motion) technology. In addition, see software demonstration on how this data is stored and accessed for DOTD use and federal reporting.

Video AI Detection for Automated Vehicle Classification

Terry Lee, Leetron Vision

TTI Portable WIM Technology

Lubinda Walubita, Texas A&M Transportation Institute

MS2 Traffic Count Database System

Jeffery Rice, MS2

Session 53: Innovative Solutions for Soft/Problematic Soils

Moderator: Derek Paille

Meeting Room 10

Slopes, embankments, and retaining wall structures for infrastructure projects frequently must be constructed on sites with less than ideal soil conditions. When unsuitable soils are encountered, the goal of the geotechnical engineer is to provide low risk, cost-effective solutions to remedy issues related to embankment settlement and stability. The presenters will provide examples of innovative solutions to repair/prevent these failures from occurring.

DOTD Case Studies Utilizing Soil Nails and Shotcrete to Repair Geohazards

William Brantly, GeoStabilization International

Geotechnical Applications for Expanded Clay and Shale Lightweight Aggregates

Jack Moore, Arcosa Lightweight

Session 54: Evolution of Survey Technology

Moderator: Barrett Smith

Meeting Room 11

Disruptive technology can advance, destroy, or comprehensively change what we believe is or should be constant. The survey profession will have to deal with change due to disruptors more than any profession. Learn about these technologies and the effects they will have across the entire transportation industry.

Disruptive Technology in the Survey Profession

Joey Coco and Brad Holleman, Forte and Tablada

Session 55: ITS Maintenance Engineering and Inspection

Moderator: Tony St. Philip

Meeting Room 12

Over the past decade, Louisiana DOTD has deployed Intelligent Transportation Systems (ITS) communications and field devices throughout the state. As part of this growth, ITS maintenance engineering and inspection (ME&I) becomes a high-priority area as inadequate maintenance could lead to increased device downtime, increased responsive maintenance cost, decreased functionality, and safety concerns. On the other hand, the benefits of efficient and timely ME&I of the ITS network include improved monitoring, lower life-cycle cost, faster incident response, reduction in secondary crashes, and improved driver safety. This session covers pre-

sentations on ITS ME&I program delivery, innovative methods, and keeping future maintenance needs in mind (site access, electrical components, future upgrades, etc.) during design and construction of a project.

Key Components for Successful Implementation of an ITS ME&I Program

Jeff Jones, Arcadis

New Solutions to Fixing Old Equipment

Clarke Chauvin, ITS

Incorporating Maintenance Needs during Design and Construction

Michael Taylor, Ozark

Session 56: DOTD Processes

Moderator: Beau Achord

Meeting Room 13

Like most organizations, DOTD has many processes that must be followed in order to efficiently deliver projects. This session will focus on the Design Exception process as well as dos and don'ts for revisions and change orders.

Design Exceptions

Robert Isemann, DOTD

How to...A Discussion on Revisions and Change Orders

Blake Coffey, DOTD

TUESDAY 2:10 P.M.-3:00 P.M.

Session 57: Legal Panel Discussion and 23 USC 407

Moderator: Wick Cooper

Meeting Rooms 3-4

This session will include a panel discussion with DOTD Legal and the Attorney General's Office covering topics such as litigation support, the use of safety data under 23 USC 407, and public information requests.

Panel Discussion

Geoff Rodriguez, DOTD

Barb Pilat, Attorney General's Office

Kathi Logan, Attorney General's Office

Session 58: IIJA—Bridge and Safety Funding

Moderators: Mary Elliott

Meeting Rooms 5-6

This session will provide an overview of the Bridge Formula Program established under the IIJA to provide funding for replacement, rehabilitation, preservation, protection, and construction of highway bridges. This session will also cover the Highway Safety Improvement Program and the changes to the program enacted by IIJA.

IJA Bridge Program

Mary Stringfellow, FHWA

IJA Safety Program

Betsey Tramonte, FHWA

Session 59: Traffic Engineering Signal and Guide Signs

Moderator: Todd Humphreys

Meeting Rooms 7-8

This presentation will go over the recent changes related to the Roadside Sign Standard Details including a discussion of when to use particular supports. This presentation will also discuss how DOTD's Traffic Control Program is focusing in on traffic signals, guide signs, and pavement markings.

Roadside Sign Standard Detail Update

Robert Willie and Andre Fillastre, DOTD

The Infinite Game of Traffic Signal, Guide Sign, and Pavement Markings

Andre Fillastre and Robert Willie, DOTD

Session 60: Management Systems Updates

Moderator: Christophe Fillastre

Meeting Room 9

State DOTs are required to develop, implement, and advance a risk-based transportation asset management plan (TAMP). The cornerstone of the recent 2022 TAMP was to continue the transition to a performance and outcome-based program that achieves and sustains a state of good repair over the life cycle of the assets to preserve and improve the condition of the National Highway System, and its certification by FHWA. DOTD developed a fully functional AASHTOWare BrM model which supported the 2022 TAMP bridge performance measure target selection. See the latest bridge modeling advancements focusing on Life Cycle Cost Analysis to develop bridge specific Life Cycle Plans to find the lowest bridge life cycle cost. DOTD's pavement management processes, data collection, and project selection are designed to meet performance measure goals. Discover the project selection process, new tools in pavement management, and how they help to decide performance targets.

Overview of the DOTD 2022 TAMP Certification

Randy Goodman, DOTD

Optimizing Bridge Life Cycle Costs

Ray Elhami, DOTD

Incorporating Pavement Process into Performance Measure

Christophe Fillastre, DOTD

Session 61: Concrete Protection and Strengthening Fundamentals, Corrosion Prevention, and Repairs

Moderator: Francisco Gudiel

Meeting Room 10

Successful corrosion mitigation projects will be presented and why they are successful. The reasons why traditional repairs suffer short durability will be explained. Also, the different techniques and ma-

terials available to mitigate corrosion will also be discussed. These items will include design, construction, maintenance, cathodic protection, alternative reinforcements, and carbon fiber wrapping. Also to be discussed are when carbon fiber wraps are a good repair and how they can be installed to restore strength to an already degraded element.

Paul Vinik and Ramon E. Pelaez, GPI

Session 62: Utilizing Technology to Aid in Bridge Inspection

Moderator: Haylye Brown

Meeting Room 11

Innovative Technologies for Underwater Inspection

Heath Pope, Consor Engineers

The Application of Nondestructive Evaluation and Structural Monitoring for Asset Management and Preservation in Louisiana

Shane Boone, Bridge Diagnostics, Inc.

Emerging Technologies for Bridge Inspection

Bradley Mistich, DOTD

Session 63: Passenger Rail Transportation—Intercity and Local

Moderator: Molly Bourgoyne

Meeting Room 12

The speakers will discuss ongoing efforts in Louisiana to implement new intercity passenger rail service and how the New Orleans streetcar system has developed a compliant and effective Safety Program.

New Opportunities to Implement New Passenger Rail Service in Louisiana

Kevin Keller, HDR, Inc.

Building a Compliant Safety Management System (SMS) for Multimodal Public Transit

Mike Smith, New Orleans Regional Transit Authority

Session 64: DOTD Right of Way Permits—Major Project Collaborations

Moderator: Toby Picard

Meeting Room 13

The DOTD Right-of-Way Permit Unit is responsible for regulation of non-DOTD facilities and non-DOTD projects falling within and impacting state highway right-of-way. This session will briefly overview the right-of-way permitting process and highlight DOTD collaborations including CPRA's Mid-Barataria and Mid-Breton Sediment Diversions.

DOTD Permit Process

Bryan Hitt, DOTD

Mid Barataria Sediment Diversion Project

Jonathan McDowell, AECOM

TUESDAY 3:30 P.M.–4:20 P.M.

Session 65: Legal Topics and Legislative Updates

Moderator: Wick Cooper

Meeting Rooms 3–4

The Legal Section will lead a panel discussion on topics including road transfers, utility relocation and delay claims, damage claims, and legislative updates. This is designed to address hot topics of interest related to recent litigation and legislation passed recently.

Road Transfers

Laura Ellender, DOTD

Utilities Relocation

Olivia Marchand, Geoff Rodriguez, and Andrew Barry, DOTD

Session 66: HSIP Past, Present, and Future

Moderator: Laura Riggs

Meeting Rooms 5–6

The state's latest SHSP has been completed. In this session, we will provide an update on what has changed in the document and focus on projects that been developed to address two of the Infrastructure and Operations Emphasis Areas, Vulnerable Road Users, and Roadway Departure.

SHSP Update

Laura Riggs, DOTD

Vulnerable Road User Projects in Practice

Mark Morvant, DOTD

Roadway Departure

Jessica DeVille, DOTD

Session 67: DOTD Innovations Showcase—Highlighting Recent Innovations

Moderator: Jeffery Brown

Meeting Rooms 7–8

The DOTD Innovations Showcase was implemented in 2017 with the purpose is to identify, recognize, and share the best innovations around the Department. The showcase is open to all full-time DOTD employees within the Office of Operations. There were 29 total innovation applications submitted in the 2021 and 2022 Innovations Showcases; this session will highlight some of the top innovations amongst the group.

Guardrail Calculator Excel File

Phillip Sturdivant, DOTD

Rut Buster Hot Mix Gate

Dwayne Dugas, DOTD

Swivel Beacon Lights

Dwayne Dugas, DOTD

Corrugated Culvert Straightener

Joseph Trahan, DOTD

Session 68: Traffic Engineering Study Details and Policy Updates

Moderator: Keira Williams

Meeting Room 9

This presentation will go over different levels of studies, including a discussion about different tools at various details depending on the situation being studied. This presentation will also highlight recent and coming changes for Traffic Engineering Policies with a focus on the Traffic Engineering Manual.

DOTD Traffic Study Details

Ryan Hoyt, DOTD

DOTD Traffic Engineering Policy Updates

Andre Fillastre and Ryan Hoyt, DOTD

Session 69: How to Implement Succession Planning and Counteract “Quiet Quitting”

Moderator: Marcus Sylvas

Meeting Room 10

As experienced employees are retiring and as incoming employees seek a more work-life integration lifestyle, organizations are concerned with overall employee output. This session will highlight an underutilized but highly effective strategy that will identify high performing employees, retain them, and counteract “quiet quitting.”

Marcus Sylvas, DOTD/LTRC

Session 70: Bridge Programs

Moderator: Amanda Ranck

Meeting Room 11

This session will discuss the on-system bridge program and the off-system bridge program.

On-System Bridge Program Overview

Andrew Windmann, DOTD

Off-System Bridge Program Overview (Regular and IJA)

Barbara Ostuno and Sarah Moss, DOTD

Session 71: Construction Roundtable

Moderator: Mike Vosburg

Meeting Room 12

The mission of the Construction Section is to develop, administer, and regulate the Department's construction certification areas of asphalt concrete paving, Portland cement concrete paving, embankment and base course, and structures as well as all aspects of transportation construction not covered by these areas including fabrication, e-Construction, work zones, contractor payments, and final audit of construction documentation.

Do's and Don'ts

Matt Jones, DOTD

Policy/Spec Updates

Matt Jones and Brian Owens, DOTD

Q&A with DOTD Construction

Mike Vosburg, Brian Owens, Matt Jones, Dallas Ballmer, Greg Coco, and Patrick Icenogle, DOTD

Session 72: OGFC and Chip Seal Projects

Moderator: Saman Salari

Meeting Room 13

This session will present ongoing asphalt research projects regarding open graded friction courses (OGFC) and emerging technologies in asphalt mix production.

Optimizing the Durability and Functionality of OGFC Mixtures

Mostafa Elseifi, LSU

Using FT-IR for Quantifying RAP Percentages or Quantifying SBS

Nazimuddin Wasiuddin, LA Tech

WEDNESDAY 8:00 A.M.–9:45 A.M.

Session 73: GISmos for the Road Ahead

Moderator: Chris Cannaday

Meeting Rooms 3–4

As with any technology, Geographic Information Systems will see significant changes in the future. How DOTD utilizes and implements that technology will also have significant impacts; the change ought to be a good one for DOTD staff and the citizens of Louisiana. This session will cover the future of roads and highways, DOTD's Enterprise Roadway Data Source of Record, Modernization of Legacy Applications, and a GIS Program Management Plan that should serve to guide DOTD forward in navigating the virtual digital space of technology and its influence on Louisiana's transportation system.

Map to the Future: the Path for Roads and Highways and Migrating R&H to ArcPro

Jason Carr, DOTD, and Jennifer Berthuaime, Arcadis

FLAME: Burning Outdated Processes and Modernizing Legacy Applications

David Druen and Jared Andre, DOTD

A Project vs. a Program and Moving Forward after the System of Engagement

Jason Carr and Juliana Delgado, DOTD

Session 74: Electric Vehicle Infrastructure Deployment

Moderator: Kevin Reed

Meeting Rooms 5–6

Over the next five years, Louisiana will receive approximately \$73 million for electric vehicle (EV) infrastructure through President Biden's Infrastructure Investment and Jobs Act (IIJA). The Louisiana

DOTD plans to administer the deployment of electric vehicle charging station infrastructure throughout the state. This session will provide information about the grant program DOTD will administer to build out the charging station infrastructure, as well as provide other general information about EVs and EV charging infrastructure.

DOTD's NEVI Plan and EV Program, Social Pinpoint Demo

Joy Johnson, DOTD

Overview of EVs, CSE Data, Workforce Development

Ann Vail, Louisiana Clean Fuels

Equity, Application Process, and Selection Criteria

Cedric Grant, Grant Management Group, LLC

Electric Vehicle Overview—What's on the Market?

Tyler Herrmann, Louisiana Clean Fuels

Session 75: Critical Projects

Moderator: Kurt Brauner

Meeting Rooms 7–8

The I-49 South Corridor will convert 160 miles of U.S. 90/167 from Lafayette to New Orleans into an interstate-quality roadway. Louisiana DOTD is continuing to look into innovative ways to design, fund, and construct in a timely manner infrastructure improvements for the public. An overview of three large projects: I-49 Lafayette Connector, I-49 at Ambassador Caffery, and I-49 at Verot School Road on the corridor will be presented. Additionally, this session will present on the recently let LA 1 Phase 2, which consists of approximately 8.3 miles of elevated bridge structure connecting Leesville and Golden Meadow. This mega project required innovative approaches to project funding as well as innovative construction methodology in the environmentally sensitive wetlands.

LA 1—Phase 2

Ryan Morvant, DOTD

I-49 Connector

Tim Nickel, DOTD

I-49 South: Ambassador Caffery Interchange

Ryan Morvant, DOTD

I-49 South at Verot School Road Interchange

Thomas Gattle, Huval & Associates

Session 76: Swamp Tank: Draining the Swamp—Making Sense of Research Results

Moderator: Tyson Rupnow

Meeting Rooms 9–10

This session will be a fast-paced session focusing on recently completed or ongoing LTRC materials, pavements, and geotechnical research. Presentations will be in the format of a Shark Tank pitch with each presentation being no more than 6–8 minutes in length. Presentations will highlight the Departmental need for the research, provide a high-level overview of the results, and conclude with recommendations from the project.

A Case Study on Impact of Flooding and Inundation on Pavement Performance

Qiming Chen, DOTD/LTRC

Assessment of the Zero-speed Profiler for Roughness Measurements under Low-speed Conditions

Moses Akentuna, DOTD/LTRC

Develop Machine Learning (ML) Models for Estimating the Ultimate Pile Capacity from Cone Penetration Test (CPT)

Murad Abu-Farsakh, DOTD/LTRC

Geotechnical Database IV

Gavin Gautreau, DOTD/LTRC

Evaluation of Saturates/Aromatics/Resins/Asphaltenes (SARA) Fractionation of Asphalt Binders in Louisiana

Saman Salari, DOTD/LTRC

MASH TL-4 Engineering Analyses and Detailing of 36-inch and 42-inch High Median Barriers for DOTD

Walid Alaywan, DOTD/LTRC

Maintenance of Roadway Edge Drop-Off Utilizing Readily Available Materials

Nicholas Ferguson, DOTD/LTRC

Investigation of In Situ Thermal Properties and Early-Age Pavement Behavior in the Design and Performance Evaluation of RCC Pavements

Moinul Mahdi, DOTD/LTRC

Performance Evaluation of Preservation Asphalt Overlays in Louisiana

Zhong Wu, DOTD/LTRC

Use of Infrared Thermography for Soil Moisture Detection in Highway Embankment and Dam Inspection

Qiming Chen, DOTD/LTRC

Asphalt Pavement Sustainability: Increased RAP Levels within BMD Framework

Louay Mohammad, DOTD/LTRC

LTRC Overview

Tyson Rupnow, DOTD/LTRC

Session 77: Movable Bridge Projects

Moderator: Fallon Farber

Meeting Room 11

This session will discuss movable bridge projects.

Danziger Lift Bridge—Investigation and Emergency Repairs for a Problem Structure

John Williams, Wiss, Janney, Elstner Associates, Inc.

Barataria Swing Bridge

Andrew Michael and Jeff Hastings, DOTD

SR 968/SW 1st Street Bridge Replacement

Rob Vicedo, Hardesty & Hanover, LLC

Session 78: LTAP Cornucopia II—Connecting with Local Agency Topics of Interest

Moderator: Steve Strength

Meeting Room 12

Following up on LTAP's wildly popular Cornucopia Session from LTC 2020, you will learn how LTAP partners with DOTD, FHWA, and others to meet the needs of local agencies across Louisiana. Highlights include a discussion on how locals can take advantage of LTAP's Pavement Preservation initiative to make their own programs more cost-effective, what local agencies can do to keep their bridges in top shape, and ideas local government can adopt to maintain a well trained and motivated workforce for maintaining and operating infrastructure.

Introduction to LTAP's Work Plan 2023 and How it Fits with Your Plans

Steven Strength, DOTD/LTRC

Training is the Key to Where You Want to Be

Courtney Dupre, DOTD/LTRC

Pavement Preservation Programs for Local Agencies

Nicholas Verret, City of Natchitoches

Where the Gray Squirrel Runs: Key Topics in Bridge Maintenance and Repair

Jim Ferguson, Veteran Inspections and Assessments, LLC

Session 79: Materials Lab: What Can We Do for You?

Moderator: Amar Raghavendra

Meeting Room 13

The Materials Lab is the Department's central laboratory, but what services does it provide? This session provides a look at the variety of laboratory functions and how the lab personnel support construction operations. From durability and strength to visibility and chemistry, join us to learn about the ways the Materials Lab can provide assistance.

Chemical Testing

Michael Grubb, DOTD

Independent Assurance/Asphalt Testing

Jason Davis, DOTD

Sign Sheeting/NTPEP

Jason Davis and Daniel Huggins, DOTD

Aggregate/Soils Testing

Brandon Johnson and Faren Spooner, DOTD

Cementitious and Metals Testing

Bruce Miu and Justin Morris, DOTD

WEDNESDAY 10:15 A.M.–12:00 P.M.

Session 80: Roadway Design Projects

Moderator: Ryan Nolan

Meeting Rooms 3–4

This session will showcase three Design Projects on the state's high-way system. The focus of each presentation will be on unique design aspects of each project and challenges through the delivery process.

I 10: Texas State Line to Coone Gully

Andrew Judice, DOTD

I 10: LA 108 to I210 Interchange

Sarah Ballmer, DOTD

LA 30 Roundabouts at Tanger Mall and I-10

Jesse Tisssdale, Stanley Group

Session 81: Emergency Bridge Projects

Moderator: Kelly Kemp

Meeting Rooms 5–6

This session will discuss emergency bridge projects.

Sunshine Bridge Vertical Member Crack Repair

Jon McGormley, Wiss, Janney, Elstner Associates, Inc.

I-20 MS River Bridge at Vicksburg: Pier Movement and Bridge Modifications

Jason Miles, Modjeski and Masters, Inc.

Geotechnical Instrumentation Monitoring of the I-20 Bridge in Vicksburg, MS

Megan Bourgeois, Ardaman Associates, Inc.

Session 82: District Emergency Response Logistics

Moderator: Billy Douglas

Meeting Room 7–8

South Louisiana is certainly no stranger to responding to hurricanes. However, every hurricane is different and presents its own unique set of circumstances that must be overcome. DOTD district personnel face many challenges prior to, during, and after these severe weather events in order to maintain services to the public. These challenges require careful coordination with other sections within the Department, local entities, elected officials, and the public. These coordination efforts are sometimes required to continue long after the initial impacts from the storm.

DOTD Hurricane Pre- and Post-Storm District Operations

Nick Chachere and Seth Woods, DOTD

Generating a Recovery

Larry Sharp, DOTD

Hurricane IDA Impacts to Kerner Bridge and Surrounding Areas

Chris Morvant, DOTD

Session 83: Swamp Tank: Return to the Swamp

Moderator: Tyson Rupnow

Meeting Rooms 9–10

This session will be a fast-paced session focusing on recently completed or ongoing LTRC planning, intelligent transportation systems, and safety research. Presentations will be in the format of a Shark Tank pitch with each presentation being no more than 6–8 minutes in length. Presentations will highlight the Departmental need for the research, provide a high level overview of the results, and conclude with recommendations from the project.

Safety Effectiveness of Cable Median Barriers in Louisiana

Elisabeta Mitran, DOTD/LTRC

An Assessment of Louisiana's Freight Operations Goals

Julius Codjoe, DOTD/LTRC

Human Mobility for Active Transportation Planning in Louisiana

Rebecca Bian, DOTD/LTRC

Evaluation of Traffic Crash Characteristics on Elevated Sections of Interstates in Louisiana

Ashifur Rahman, DOTD/LTRC

Improved Incident Response through Coordinated, Interoperable Communications

Milhan Moomen, DOTD/LTRC

Field Monitoring and Measurement in Civil Engineering Education

VJ Gopu, DOTD/LTRC

Big Data and Technology in Transportation Planning

Robert Kohler, DOTD

Overview of the RITIS Platform and Causes of Congestion in Louisiana

Rick Ayers, UMD

LTRC Overview

Tyson Rupnow, DOTD/LTRC

Session 84: e-Construction

Moderator: Brian Owens

Meeting Room 11

The world is in the information age where data is at our fingertips nearly all the time. Construction projects create a tremendous amount of data that has been captured and transferred via paper for too long. E-Construction is an initiative to migrate these data exchanges to a digital platform through the use of technology like virtual field books, electronic transfer of batch tickets and certificates, and automated data capture with smart equipment.

Introducing the DOTD e-Construction Unit

Patrick Icenogle and Les Fletcher, DOTD

Headlight Implementation

George White, Headlight, Phillip Graves, Headlight, and Les Fletcher, DOTD

e-Ticketing

Patrick Icenogle, DOTD, and Brandon Hundley, HaulHub

Session 85: Transportation Systems Management and Operations: How it Fits into within the Vision of the Transportation Agency

Moderator: Alaa Shams

Meeting Room 12

Transportation Systems Management and Operations is defined simply as a way to address reliability, mobility, and congestion by utilizing strategies rather than building our way out of congestion by adding capacity (lanes). Typically, TSMO and ITS technology-based solutions are combined together as being one and the same. However, ITS based solutions are just one component of a TSMO framework for managing the transportation system. Traffic Engineering, Safety, and the entire project development process fit under the TSMO umbrella. By encompassing a TSMO structure into the business practices of a transportation agency, the agency can better implement TSMO strategies that maximize the operation of the transportation system from the initial planning phase to the maintenance and operation of the system.

Focusing on ALDOT TSM&O Program

Chris Hilyer, Arcadis

Focusing on TxDOT TSM&O Program

Koushik Arunachalam, Arcadis

Focusing on GDOT TSM&O Program

Matt Glasser, Arcadis

TSMO Implementation Plan for Louisiana

Joshua Harrouch, DOTD

Session 86: Public Outreach

Moderator: Noel Ardoin

Meeting Room 13

In their short and long range planning processes, the Acadiana Metropolitan Planning Organization (MPO) used ESRI Storymaps to convey project information such as project limits, costs, traffic, and other vital information to the public. Storymaps have been vital to ensuring compliance with the 2021 Executive Order Advancing Racial Equity and Support for Underserved Communities Through the Federal Government. The maps demonstrate the equitable distribution of transportation investments in Acadiana and the benefits to underserved communities. The Acadiana MPO will present their work using Storymaps. Franklin Associates will present their experiences with various techniques, both traditional and non-traditional, used to engage the public and stakeholders. They successfully used these methods on a number of DOTD projects. The Alexandria Pineville MPO will present a framework for flexible public involvement. The Alexandria Pineville MPO developed a cost effective online mapping tool. This tool makes it easy and convenient for the public to provide feedback on important issues such as transit gaps and safety concerns. The Alexandria Pineville MPO also deployed the online tool using tablets at kiosks. During development of their long range plan, these kiosks served as public comment stations.

Visualizing Project Development and Transportation Equity through the Use of Storymaps

Ashley Moran, Acadiana Planning Commission

Maps, Machines and Minds: The Intersection of People and Technology in Public Involvement

Risa Mueller and James Taylor, Franklin Associates

Flexible Public Involvement Framework

Jonathan Bolen, Rapides Area Planning Commission, and Matt Johns, Alexandria Pineville MPO

NOTES

SPEAKER INDEX

A

Abu-Farsakh, Murad—24
Akentuna, Moses—24
Alaywan, Walid—24
Allain, Peter—16
Andre, Jared—23
Ard, Shirley—16
Ard, Stan—10
Ardis, Richard—18
Arunachalam, Koushik—26
Ayers, Rick—25

B

Ballmer, Dallas—23
Ballmer, Sarah—25
Barry, Andrew—22
Bastion, Dusty—16
Baumann, Jackie—11
Beckwith, Jackie—17
Benn, Angela—16
Berthuaime, Jennifer—23
Betts, Connie—8, 9
Bian, Rebecca—25
Bolen, Jonathan—26
Boone, Shane—21
Bourgeois, Megan—25
Brandt, Brad—13
Brantly, William—20
Breedon, Skip—12
Brignac, Joyce—16

C

Cannaday, Chris—18
Capone, Rudynah—16
Carr, Jason—23
Chachere, Nick—25
Chapman, James—14
Chauvin, Clarke—20
Chen, Qiming—24
Chenevert, Mark—12
Coco, Greg—23
Coco, Joey—20

Codjoe, Julius—25
Coffey, Blake—20
Cooper, Clinton—18
Costello, Bryan—14
Coventon, Dennis—16
Coxe, Carey—11
Crampton, Sam—15
Crothers, Daniel—11
Crout, Monica—18

D

Darby, Kim—11
Davis, Jason—24
Delgado, Juliana—18, 23
Denson, Lucas—12
Depan, Dilip—15
DeVill, Jessica—17, 22
Diedrich, Tom—10
Dixon, Jeremy—15
Doakes, LaRonda—16
Doucet, Austin—15
Douglas, Billy—13
Douglas, Cynthia—16
Druen, David—23
Duet, Jason—11
Dugas, Dwayne—22
Dupre, Courtney—24

E

Elhami, Ray—21
Ellender, Laura—22
Elseifi, Mostafa—23
Evans, Janet—10
Evans, Scott—18

F

FaKouri, Chris—19
Faulk, Blanche—16
Fei, Ling—15
Ferguson, Jim—24
Ferguson, Nicholas—24
Fillastre, Andre—19, 21, 22

Fillastre, Christophe—21
Fish, Lacey—19
Fletcher, Les—25

G

Gattle, Thomas—23
Gautreau, Gavin—18, 24
Glascock, Cyndi—10
Glasser, Matt—26
Goodfellow-Thompson, Autumn—19
Goodman, Randy—21
Gopu, VJ—25
Grant, Cedric—23
Graves, Phillip—25
Green, Keycha—16
Greene, Tom—13, 14
Grubb, Michael—24
Gudiel, Francisco—18
Gullett, Megan—16

H

Hahn, Sara—11
Hall, Cindy—16
Halloran, Judy—16
Harrouch, Joshua—26
Hassan, Hany—17, 19
Hastings, Jeff—24
Haymer, Shermaine—11
Heaphy, Drew—10
Herrmann, Tyler—23
Hilyer, Chris—26
Hitt, Bryan—21
Holleman, Brad—20
Hoyt, Ryan—22
Huggins, Daniel—24
Hundley, Brandon—25

I

Icenogle, Patrick—23, 25
Iseman, Robert—20
Ismail, Yasser—19

J

Jacobsen, Bob—14
Jesclard, Chip—14
Jesclard, Trey—14
Johns, Matt—11, 26
Johnson, Brandon—24
Johnson, Jacquole—19
Johnson, Joy—23
Jones, Jeff—20
Jones, Joseph—19
Jones, Matt—23
Judice, Andrew—25

K

Kameshwar, Sabarethinam—19
Keller, Kevin—21
Kemp, Kelly—13
Knotts, Chris—8, 9
Kohler, Robert—25
Krone, Durk—18

L

LeBas, Sherri—17, 19
Lee, Terry—20
Lemoine, Justin—17
Lengyel, Matt—13
Lin, Hai—19
Linton, Juanita—16
Loesche, Sam—17
Logan, Kathi—20

M

Mahdi, Moinul—24
Maji, Gary—16
Malone, Vince—10
Marchand, Olivia—22
Marretta, Leo—16
Matherne, Seth—14
Matisak, Phil—10
McConnell, Gordon—18
McDowell, Jonathan—21
McGormley, Jon—10

SPEAKER INDEX

McGormley, Jon—18, 25
Mensah, Stephen—18
Metcalf, Billy—14
Michael, Andrew—24
Miles, Jason—25
Miller, Mike—13
Mistich, Bradley—21
Mitran, Elisabeta—25
Miu, Bruce—24
Mohamed, Mohamed—17
Mohammad, Louay—10, 24
Moomen, Milhan—25
Moore, Jack—20
Moran, Ashley—26
Morgan, Warren—16
Morris, Justin—24
Morvant, Chris—25
Morvant, Mark—22
Morvant, Ryan—23
Moss, Sarah—14, 22
Mueller, Risa—26

N

Nelson, Gordon—16
Nickel, Charles—12
Nickel, Tim—23
North, David—13

O

Ostuno, Barbara—22
Owens, Brian—23

P

Paul, Michael—18
Pelaiez, Ramon—21
Peltier, Justin—16
Peng, Xin—18
Penton, Jeremy—12, 13
Pestello, Nick—10
Peters, Andrew—12
Pilat, Barb—20
Pope, Heath—21
Potvin, Kyle—13

R

Rahman, Ashifur—25
Ranck, Amanda—14
Raqib, Mohammed—17
Rathgeber, Paul—12
Rauser, Jesse—18
Rice, Jeffery—20
Riggs, Laura—22
Roddy, Paula—10, 12, 16
Rodriguez, Geoff—20, 22
Rodriguez, Greg—17
Rundell, Scott—15
Rupnow, Tyson—13, 24, 25

S

Salari, Saman—24
Scheuermann, Ed—10
Schexnayder, GJ—10, 17
Schmidt, Bob—17
Shahawy, Mohsen—14
Sharp, Larry—25
Sherry, Sam—18
Slaughter, Terri—10
Smith, Dustin—13
Smith, Mike—21
Spooner, Faren—24
Strength, Steven—16, 24
Stringfellow, Mary—14, 19, 21
Struve, Brooke—17
Sturdivant, Phillip—22
Stutes, Joshua—13
Suarez, Daniel—11
Sylvas, Marcus—22

T

Taylor, James—26
Taylor, Michael—20
Thiess, Andrew—15
Thimmesch, Katherine—18
Thomas, Tim—18
Tissdale, Jesse—25

Tolford, Tara—19
Tomley, David—10
Trahan, Joseph—22
Tramonte, Betsey—21
Tran, Nam—10, 11

V

Vail, Ann—23
Verret, Nicholas—24
Vicedo, Rob—24
Vinik, Paul—18, 21
Vosburg, Mike—23

W

Waggenspack, Derek—18
Wallace, Rhonda—16
Walubita, Lubinda—20
Wasiuddin, Nazimuddin—23
Weidman, Brett—18
Weres, John—12
White, Aaron—17
White, George—25
White, Ryan—13
Williams, John—24
Williamson, Billy—12
Willie, Robert—21
Wills, Ann—16
Wills, Joe—16
Windmann, Andrew—22
Woods, Seth—25
Wu, Zhong—24

Y

Young, Ana—18

Z

Zappi, Mark—12

CONFERENCE COMMITTEES

EXECUTIVE COMMITTEE

Mary Leah Coco, Chair
Tyson Rupnow, Co-Chair
Kaitlyn Boudreaux (GEC)
Brad Doucet
Vince Latino
Erich Ponti (LAPA)
Brian Buckle (GEC)
Phil Jones
Philip Macaluso
Rebecca Rizzutto
Samuel Cooper, Jr.
Barry Keeling
Darhlene Major
Algy Semien
Samuel Cooper, III
Joshua McNemar
Garrett Wheat
Michael Demouy (CAAL)
Chris Knotts
Ken Naquin (AGC)
Emily Wolfe
Barker Dirmann (ACECL)
Allison Landry
Melissa Neyland
Secretary Shawn Wilson
M. Todd Donmyer
Renee Lapeyrolerie
Edward Ofori (FHWA)

PUBLICATIONS COMMITTEE

Emily Wolfe, Chair
Jenny Gilbert
Chris Melton

PROGRAM COMMITTEE

Garrett Wheat, Chair
Samuel Cooper, III, Co-Chair
Stan Ard
VJ Gopu
Adriane McRae
Bob Schmidt (ACECL)
Noel Ardoin
Joshua Harrouch
David Miller
Dawn Sholmire
Connie Betts
Michelle Horne
Tanya Moore
David Smith
Mary Elliott Bergeron
Ryan Hoyt
Ken Naquin (AGC)
Renee Smith
Jamie Boullion
Sheri Hughes
Melissa Neyland
Steven Strength
Skip Breeden
Robert Isemann
Chris Nickel
Joshua Stutes
Jason Chapman
Trey Jesclard
Nicholas Olivier
Daniel Suarez (FHWA)
Mark Chenevert
Don Johnson

Brian Owens
Marcus Sylvas
Mary Leah Coco
Phil Jones
Peggy Jo Paine
Paul Vaught
Wick Cooper
Chris Knotts
Erich Ponti (LAPA)
Mike Vosburg
Dortha Cummins (LHSC)
Pat Landry
Michael Proctor
Kristopher Wascom
Michael Demouy (CAAL)
Renee Lapeyrolerie
Kevin Reed
Bill Williamson
M. Todd Donmyer
Michael LeBlanc
Paula Roddy
Andrew Windmann
Patrick Frazier
Robert Lott
Geoffrey Rodriguez
Randall Withers
Jenny Fu
Darhlene Major
Scott Rundell
Vertie Gary
Charles McBride
Tyson Rupnow

REGISTRATION COMMITTEE

Rebecca Rizzutto, Chair
Ted Ball
John Dean
Sheri Hughes
Susan Nichols
Sandra Brady
Claire Dixon
Heather Huval
Nicole Robinson
Charlene Brigola
Carmel Dysart
Yolanda Jolivet
Marcus Sylvas
Layne Brown
Jennifer Farlough
Kimberly Jones
Kirk Wales
Kasey Browning
Tyra Guthrie
Kristina Kleinpeter
Jennifer Walker
Dimetrie Chopin
Jason Hooper
Jennifer Mizzell
Brenda Wolfe

AUDIOVISUAL (AV)/INFORMATION TECHNOLOGY (IT) COMMITTEE

Brad Doucet, Chair
Kevin Cicero
Paul Hendricks
David Jumper
Kim Lanceslin
Patrick Mehaffey
Todd Stevens
Les Summers

INDUSTRY RELATIONS COMMITTEE

Kaitlyn Boudreaux, Co-Chair
Emily Wolfe, Co-Chair
Chris Abadie
Brian Buckel (GEC)
Barker Dirmann (ACECL)
Kimberly McDaniel
Jenny Gilbert

CONFERENCE OPERATIONS COMMITTEE

Allison Landry, Chair
Patrick Frazier
Sheri Hughes
Kristina Kleinpeter
Melissa Lee
Melissa Neyland

COMMUNICATIONS/ TRANSPORTATION COMMITTEE

Philip Macaluso, Chair
Donald Bastin
Shawn Berg
Frank "Gil" Lea

PLANNING COMMITTEE

Ted Ball
Samuel Cooper, III
Heather Huval
Melissa Neyland
Don Bastin
John Dean
David Jumper
Susan Nichols
Kaitlyn Boudreaux (GEC)
Claire Dixon
Rebecca Rizzutto

Sandra Brady
Brad Doucet
Kristina Kleinpeter
Tyson Rupnow
Layne Brown
Patrick Frazier
Allison Landry
Marcus Sylvas
Brian Buckel (GEC)
Jenny Gilbert
Melissa Lee
Kirk Wales

Mary Leah Coco
VJ Gopu
Philip Macaluso
Garrett Wheat
Dimetrie Chopin
Paul Hendricks
Patrick Mehaffey
Brenda Wolfe
Samuel Cooper, Jr.
Sheri Hughes
Chris Melton
Emily Wolfe

WELCOME TO BATON ROUGE!



SCAN TO SEE ALL THERE IS TO EXPLORE.

Visit **BATON
ROUGE**

#EXPLOREBATONROUGE

2023 Louisiana Transportation Conference Documentation of Professional Development Hours

Print Name _____

Date and Time	Session Title	PDHs
Sunday, 3/12/2023, 3:30-4:30 p.m., or Wednesday, 3/15/2023, 1:30-2:30 p.m. 1.0 PDH available*	Professionalism and Ethics in Engineering	
TOTAL PDHs EARNED IN ETHICS		

Date and Time	Session Title	PDHs
Monday, 3/13/2023 8:30 a.m.–11:30 a.m.	General Session	
Monday, 3/13/2023 1:00 p.m.–1:50 p.m. 1.0 PDH available*	1: Standards of Practice for Boundary Surveys in Louisiana	
	2: CMAR—Benefits and Lessons Learned on Two Multimodal Projects	
	3: EPDs: Like Counting Pavement Calories	
	4: Diversity, Equity, and Inclusion in Transportation Projects and Programs	
	5: The Pursuit of Concrete Sustainability	
	6: Bridge Design	
	7: Navigating Reimbursement from Declared Disaster Events	
	8: The DOTD FileNet Journey—Past, Present, and Future	
Monday, 3/13/2023 2:10 p.m.–3:00 p.m. 1.0 PDH available*	9: Cultural Resources	
	10: Planning for Resilience and Sustainability	
	11: Sustainability Initiatives: How They Benefit Contractors	
	12: DBE Goal Projects and Estimations	
	13: Active Shooter—Run, Hide, Fight	
	14: UP 101 and Pedestrian Bridge Evaluation	
	15: Local Data Collection Strategies and Uses	
	16: Transportation Innovation and Research Exploration (TIRE) Projects–1	

Monday, 3/13/2023 3:30 p.m.–4:20 p.m. 1.0 PDH available*	17: Statewide Flood Control Program	
	18: District Operations	
	19: Advancements in Concrete	
	20: Plan Quality and Publications	
	21: 2021/2022 DOTD Emergency Operations Overview	
	22: Long Span Bridges and Sound Barrier	
	23: Elevating Aviation	
	24: Drones and DOTD—The Possibilities	
Monday, 3/13/2023 4:40 p.m.–5:30 p.m. 1.0 PDH available*	25: Amite River Basin Commission Study	
	26: Trends, Targets, and Tools for Safety Planning	
	27: Concrete Innovations for Sustainability	
	28: Transportation Funding for Locals (Existing and New)	
	29: Debris Management at Louisiana DOTD	
	30: Bridge Evaluation/Load Rating	
	31: Port of New Orleans Louisiana International Terminal	
	32: Transportation Innovation and Research Exploration (TIRE) Projects–2	

Date and Time	Session Title	PDHs
Tuesday, 3/14/2023 8:00 a.m.–9:45 a.m. 2.0 PDHs available*	33: LA Watershed Initiative Statewide H&H Modeling	
	34: The Future of Tolling in Louisiana—Leveraging our Partners	
	35: Critical Projects—Construction	
	36: Compliance Programs	
	37: LTAP—Connecting with Safety for Your Locally Owned Roads	
	38: Bridge Projects	
	39: Coordinating an Informed Approach to C/AV Regulation	
	40: Senior Design Project Presentations and Awards	

*2.0 PDH maximum assigned for each session based on anticipated contact time. If contact time is less than scheduled, PDHs are to be adjusted accordingly (50 minutes of contact time = 1.0 PDH).

Date and Time	Session Title	PDHs
Tuesday, 3/14/2023 10:15 a.m.–12:00 p.m. 2.0 PDHs available*	41: Innovative Safety Design for All Users	
	42: I-10 Baton Rouge Corridor	
	43: Bridge Rehabilitation Projects	
	44: Applied Geospatial Technology, GIS to Visualize the Seen and Unseen	
	45: Oh, No! I Got a Bridge Painting Project!?!...Why Me?	
	46: Geotechnical Data Management Practices	
	47: ITS Operations	
	48: Transportation Innovation and Research Exploration (TIRE) Projects–3	
Tuesday, 3/14/2023 1:00 p.m.–1:50 p.m. 1.0 PDH available*	49: Insight from a Forensic Toxicologist: Safety Beyond Infrastructure and Operations	
	50: Federal Funding Transfers and the IIJA Carbon Reduction and PROTECT Programs	
	51: Complete Streets at DOTD	
	52: Advancements in Traffic Data Collection	
	53: Innovative Solutions for Soft/ Problematic Soils	
	54: Evolution of Survey Technology	
	55: ITS Maintenance Engineering and Inspection	
Tuesday, 3/14/2023 2:10 p.m.–3:00 p.m. 1.0 PDH available*	56: DOTD Processes	
	57: Legal Panel Discussion and 23 USC 407	
	58: IIJA—Bridge and Safety Funding	
	59: Traffic Engineering Signal and Guide Signs	
	60: Management Systems Updates	
	61: Concrete Protection and Strengthening Fundamentals, Corrosion Prevention and Repairs	
	62: Utilizing Technology to Aid in Bridge Inspection	
	63: Passenger Rail Transportation— Intercity and Local	
	64: DOTD Right of Way Permits—Major Project Collaborations	

Date and Time	Session Title	PDHs
Tuesday, 3/14/2023 3:30 p.m.–4:20 p.m. 1.0 PDH available*	65: Legal Topics and Legislative Updates	
	66: HSIP Past, Present, and Future	
	67: DOTD Innovations Showcase— Highlighting Recent Innovations	
	68: Traffic Engineering Study Details and Policy Updates	
	69: How to Implement Succession Planning and Counteract “Quiet Quitting”	
	70: Bridge Programs	
	71: Construction Roundtable	
	72: OGFC and Chip Seal Projects	

Date and Time	Session Title	PDHs
Wednesday, 3/15/2023 8:00 a.m.–9:45 a.m. 2.0 PDHs available*	73: GISmos for the Road Ahead	
	74: Electric Vehicle Infrastructure Deployment	
	75: Critical Projects	
	76: Swamp Tank: Draining the Swamp; Making Sense of Research Results	
	77: Movable Bridge Projects	
	78: LTAP Cornucopia II—Connecting with Local Agency Topics of Interest	
	79: Materials Lab: What Can We Do for You?	
Wednesday, 3/15/2023 10:15 a.m.–12:00 p.m. 2.0 PDHs available*	80: Roadway Design Projects	
	81: Emergency Bridge Projects	
	82: District Emergency Response Logistics	
	83: Swamp Tank: Return to the Swamp	
	84: e-Construction	
	85: Transportation Systems Management and Operations (TSMO)	
	86: Public Outreach	
TOTAL PDHs EARNED		

**2.0 PDH maximum assigned for each session based on anticipated contact time. If contact time is less than scheduled, PDHs are to be adjusted accordingly (50 minutes of contact time = 1.0 PDH).*

Total PDHs earned through attendance at the 2023 Louisiana Transportation Conference (15.0 available) _____
 PDHs earned in Professional Ethics at the 2023 Louisiana Transportation Conference (1.0 available) _____

I hereby attest that I have attended the sessions documented on this form and that the cumulative PDHs total above is accurate.

SIGNATURE OF ATTENDEE

COMPLIMENTARY SHUTTLE BUS SERVICE

Louisiana Transportation Conference | March 12–15, 2023

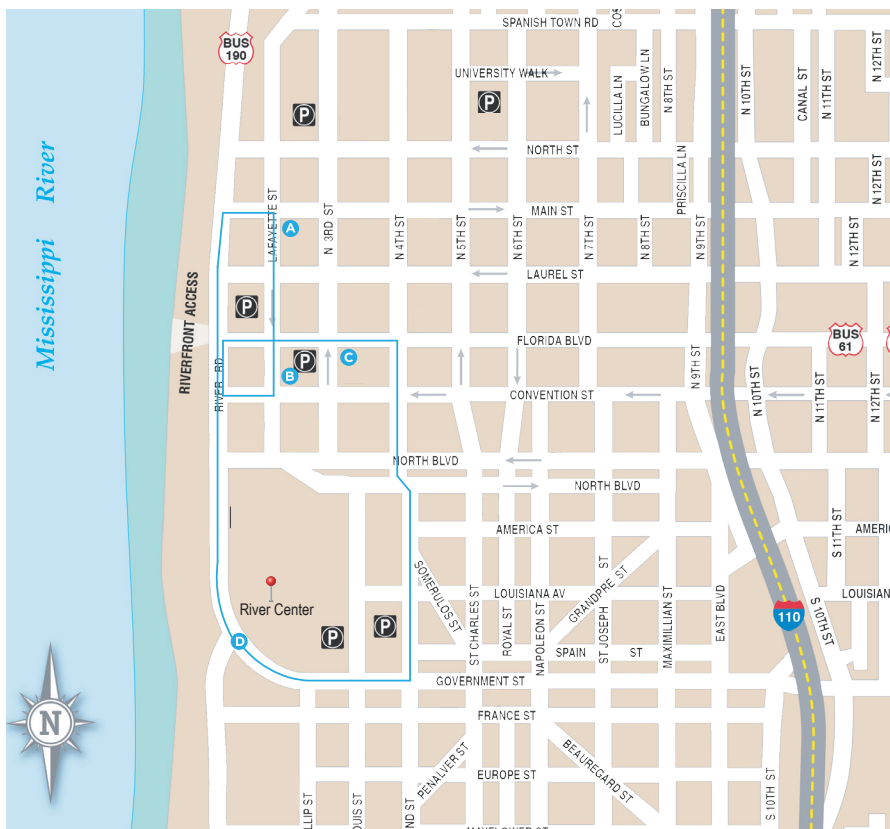

MORNING ROUTE

- A** Hampton Inn & Suites
(Bus will pick up on Lafayette Street.)
- B** Hotel Indigo & Hilton Baton Rouge Capitol Center
(Bus will pick up between hotels on Lafayette Street.)
- C** Courtyard by Marriott Baton Rouge Downtown
(Bus will pick up at the entrance closer to Florida Boulevard.)
- D** Raising Cane's River Center

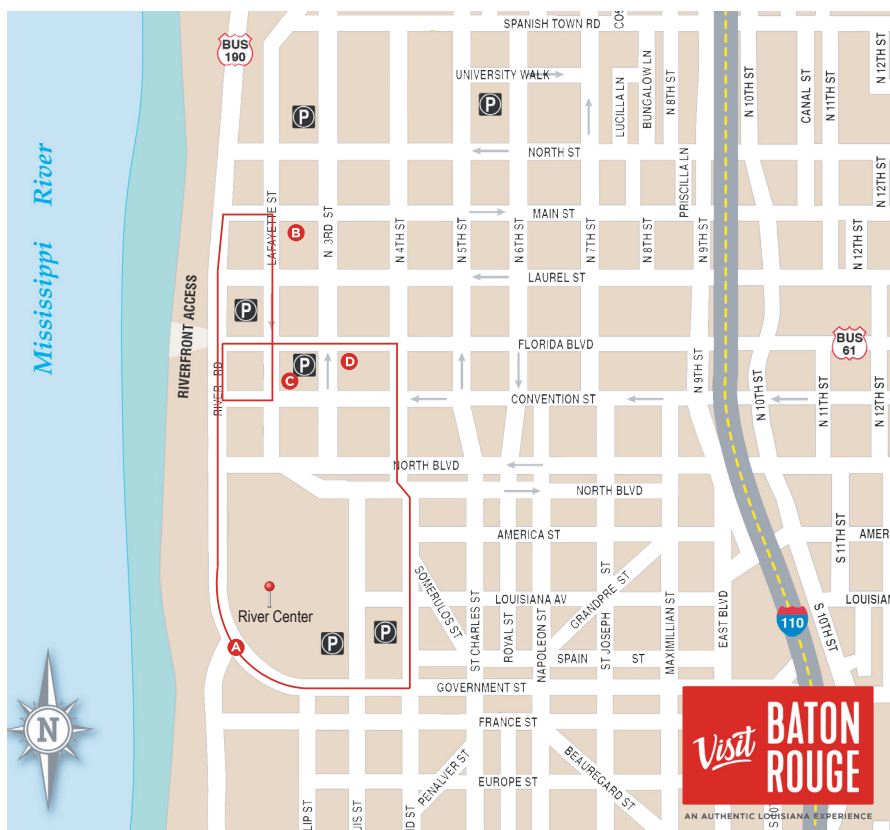

EVENING ROUTE

- A** Raising Cane's River Center
- B** Hampton Inn & Suites
(Bus will drop off on Lafayette Street.)
- C** Hotel Indigo & Hilton Baton Rouge Capitol Center
(Bus will drop off between hotels on Lafayette Street.)
- D** Courtyard by Marriott Baton Rouge Downtown
(Bus will drop off at the entrance closer to Florida Boulevard.)





LOUISIANA TRANSPORTATION CONFERENCE

MARCH 12–15, 2023
RAISING CANE'S RIVER CENTER
BATON ROUGE, LA

https://www.ltrc.lsu.edu/ltc_23